

**METRIC**  
ALL DIMENSIONS IN MILLIMETRES

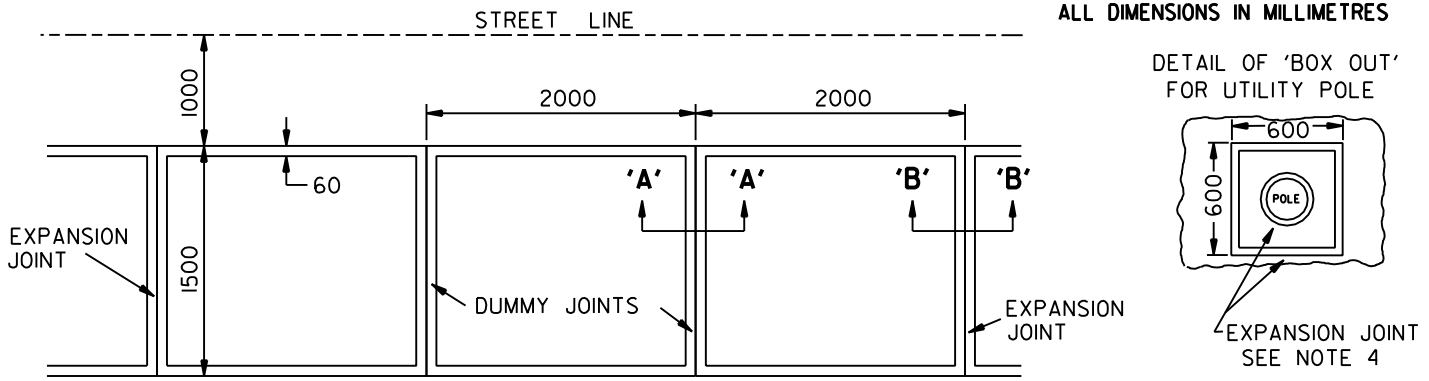

**PLAN VIEW**

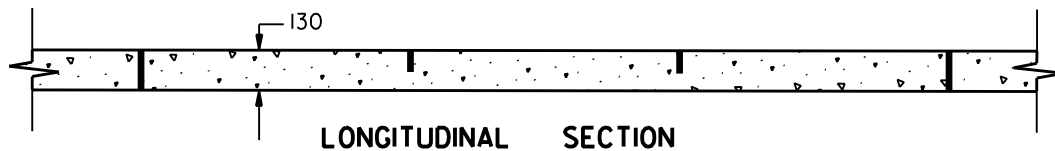

**LONGITUDINAL SECTION**

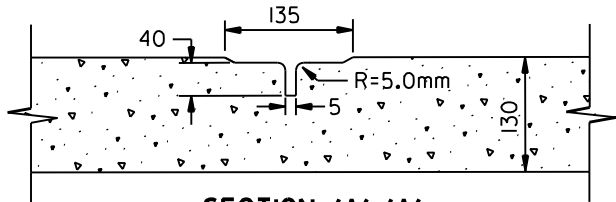

**SECTION 'A'-'A'  
DUMMY JOINT DETAIL**

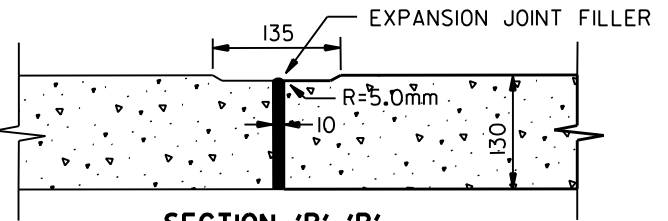

**SECTION 'B'-'B'  
EXPANSION JOINT DETAIL**

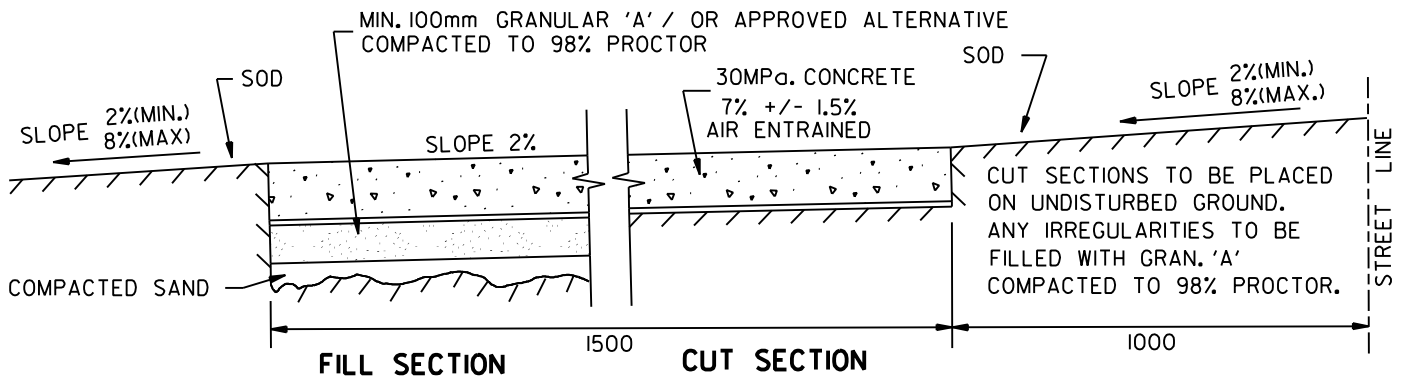

**NOTES:**

1. DEPTH OF SIDEWALK TO BE 180mm AT COMMERCIAL OR INDUSTRIAL DRIVEWAYS
2. ALL FILL SECTIONS UNDER GRAN 'A' TO BE COMPACTED SAND
3. EXPANSION JOINTS ARE REQUIRED IN SIDEWALK AT 6000mm INTERVALS AND:
  - a) BETWEEN SIDEWALK AND ABUTTING CURB
  - b) ADJACENT TO EXISTING STRUCTURES (WALKS, CURBS, UTILITY POLES, HYDRANTS, MANHOLES, ETC.) OR AT THE DISCRETION OF THE COMMISSIONER OF TRANSPORTATION AND WORKS
4. DUMMY JOINTS SHALL HAVE STANDARD SPACING OF 2000mm AND WILL BE FORMED AFTER THE CONCRETE HAS RECEIVED ITS INITIAL SET
5. WHEN SIDEWALKS ARE ADJACENT TO CURBS, EXPANSION JOINTS SHALL COINCIDE WITH THE CURB EXPANSION JOINTS
6. AGGREGATE MATERIALS CONTAINING RECLAIMED PORTLAND CEMENT AND/OR RECLAIMED ASPHALT PAVEMENT MAY ONLY BE USED IN NON-LOAD BEARING AREAS. THE FINAL BLEND SHALL NOT CONTAIN MORE THAN 30% PERCENT BY MASS OF ASPHALT COATED PARTICLES AS DETERMINED BY PERCENTAGE OF ASPHALT COATED PARTICLES, LS621.



**STANDARD  
CONCRETE SIDEWALK**

EFF. DATE	2002-01-01	SCALE	N.T.S.
REV.	3	STANDARD No.	2240.010