

## STACKED PLANK CONSTRUCTION

- Stacked plank, or plank-on-plank construction is not common in Ontario
- This building technique uses rough cut planks about 1 1/2 inches to 2 inches thick, by about 8 inches wide, laid one atop the other and slightly offset to produce a rough surface or keys for plaster



- There are 14 known stacked plank houses in the Village
- This is the highest concentration of plank houses known in Ontario – a very distinct fact about the Village and a reflection of its sawmill history and significant heritage

# PROPERTY ALTERATIONS

- There are 59 residential properties in the Village
- Since 1980:
  - 8 full demolitions
  - 13 partial demolitions
  - 18 new construction
- There are only 13 properties which have had no alteration (23%)
- Change does and has occurred in the Village – but not to the detriment of the HCD

Carefully managed change can complement the Village character

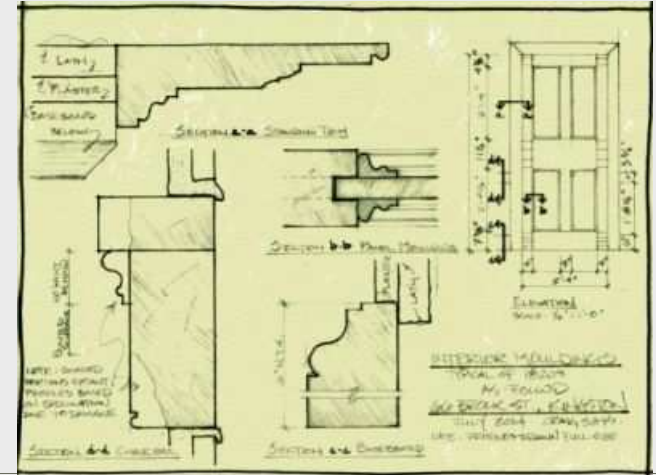

## NATURAL HERITAGE

- Natural and cultural heritage resources are fully integrated and should not be segregated or managed separately
- The Credit River provided a travel corridor and subsistence for Aboriginals as it did for the first settlers
- The river continues to provide a corridor for wildlife to travel its 90km from Orangeville to Lake Ontario
- There are both flora and fauna species specific to this area of the Credit
  - as well as endangered species to be protected
- The Meadowvale Conservation Area should seamlessly blend with the Village from both a natural heritage and cultural heritage perspective



# CVC LANDS AND THE HCD BOUNDARY EXTENSION

- The area known as the Meadowvale Conservation Area was part of the 1856 Barstow survey
- These lands were planned for development which was never realized
- They contain remnants of the grist mill, saw mill, mill pond which were the economic basis for the village for over 100 years
- Today the natural heritage element of these lands along with their associative history can be protected and interpreted as part of the HCD
- The CVC has been consulted and is supportive of adding these lands to the HCD

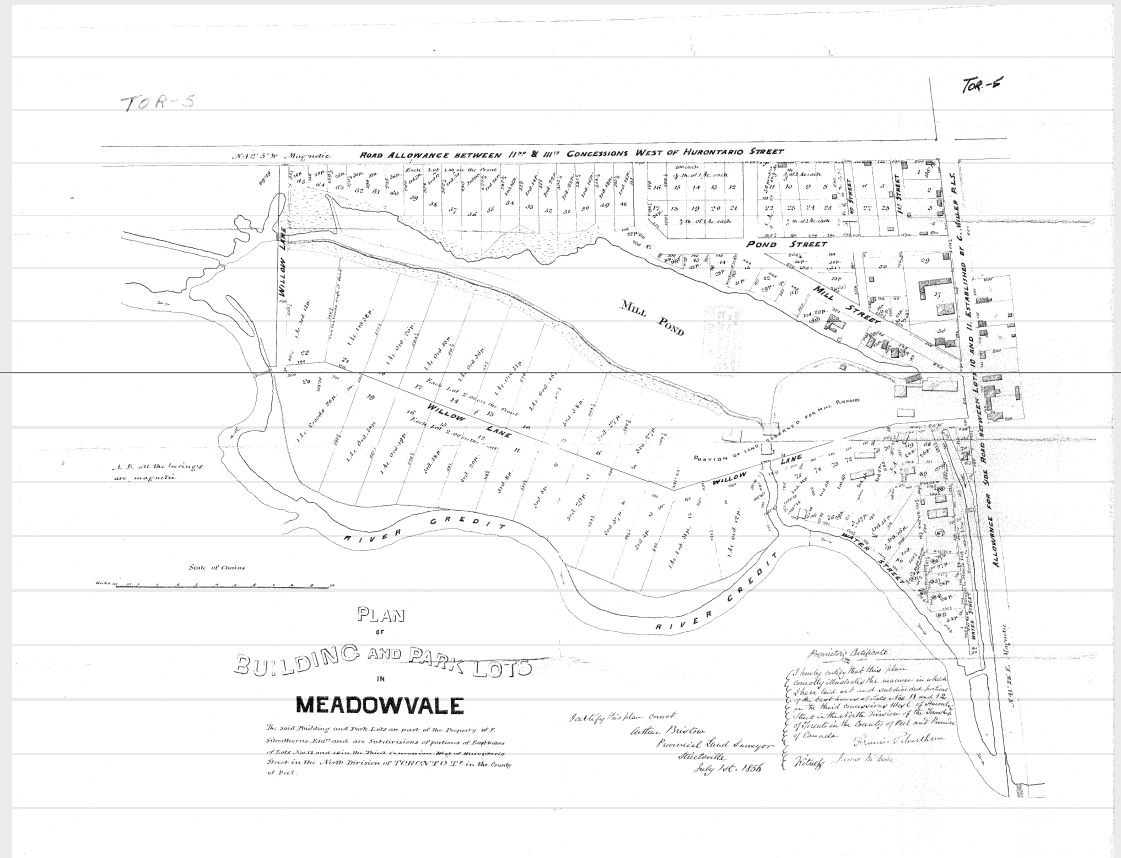

# PROPOSED BOUNDARY



## LIST OF PROPERTIES

- Each property in the Village has been researched and documented – includes private and public lands
- The full document is over 200 pages and is available on-line at: .....
- We are looking for feedback on the DRAFT document to ensure it is as accurate as possible
- The document, along with the History document will form the background and supporting documents to the final Meadowvale Village HCD Plan

