

ADDITIONAL AGENDA



TRAFFIC SAFETY COUNCIL THE CORPORATION OF THE CITY OF MISSISSAUGA WEDNESDAY, APRIL 25, 2012 - 5:00 P.M.

PRESENTATIONS/ DEPUTATIONS

MATTERS TO BE CONSIDERED

12. Site Inspection Reports – St. Vincent de Paul Catholic School, Ward 3

Site Inspection Reports for the inspections conducted on April 5, 2012 and April 17, 2012 to review the warrants for removing a Crossing Guard from the intersection of Rathburn Road and Willowbank Trail for students attending St. Vincent de Paul Catholic School, 665 Willowbank Trail.

RECOMMENDATION

1. That the Crossing Guard currently located at the intersection of Rathburn Road and Willowbank Trail for students attending St. Vincent de Paul Catholic School, 665 Willowbank Trail, be removed in June 2012 at the end of the 2012 school year as the warrants for a Crossing Guard are no longer met and turning traffic is light.
2. That the Transportation and Works Department be requested to re-paint the crosswalk lines at the intersection of Rathburn Road and Willowbank Trail.
3. That the Principal of St. Vincent de Paul Catholic School be requested to notify the affected students and parents of the removal of the Crossing Guard at the end of the school year, June 29, 2012.

RECOMMEND APPROVAL

13. Site Inspection Reports – St. Basil Catholic School, Ward 3

Site Inspection Reports for the inspections conducted on April 10, 2012 and April 19, 2012 to review the warrants for removing a Crossing Guard from the intersection of Rathburn Road and Golden Orchard Drive for students attending St. Basil Catholic School, 4235 Golden Orchard Drive.

RECOMMENDATION

1. That the Crossing Guard currently located at Golden Orchard Drive and Rathburn Road be retained for students attending St. Basil Catholic School, 4235 Golden Orchard Drive, as the warrants for placement of a Crossing Guard are met.
2. That the Site Inspection Subcommittee of Traffic Safety Council be requested to conduct a site inspection in September 2012 to review the warrants for removing the Crossing Guard currently located at Golden Orchard Drive and Rathburn Road as the volume of turning traffic between the site inspections conducted at Golden Orchard Drive and Rathburn Road on April 10, 2012 and April 19, 2012 is inconsistent when students are crossing.

RECOMMEND APPROVAL14. Site Inspection Report – St. Valentine Catholic School, Ward 6

Site Inspection Report for the inspection conducted on April 11, 2012 to review the warrants for placing a Crossing Guard at the intersection of Bristol Road and Heatherleigh Avenue, for students attending St. Valentine Catholic School, 5610 Heatherleigh Avenue.

RECOMMENDATION

1. That the request for a Crossing Guard at the intersection of Bristol Road and Heatherleigh Avenue for students attending St. Valentine Catholic School 5610 Heatherleigh Avenue be denied as Traffic Safety Council does not recommend a Crossing Guard at this location until traffic controls are installed for through traffic on Bristol Road and for turning traffic from Heatherleigh Road on the north side of the intersection.
2. That the Site Inspection Subcommittee of Traffic Safety Council be requested to re-inspect the intersection of Bristol Road and Heatherleigh Avenue after Bristol Road is re-configured to a two lane road with bike lanes and a centre turning lane.
3. That Student Transportation of Peel Region (STOPR) be requested to retain bussing for students living south of Bristol Road until road improvements have been completed and the Site Inspection Subcommittee of Traffic Safety Council has had the opportunity to re-inspect the intersection of Bristol Road and Heatherleigh Avenue.

RECOMMEND APPROVAL

15. Site Inspection Report – Queenston Drive Public School, Ward 6

Site Inspection Report for the inspection conducted on April 18, 2012 to review pedestrian safety at the intersection of Burnhamthorpe Road and Creditview Road/ Central Parkway West and along the walking route from the intersection to Queenston Drive Public School, 3520 Queenston Drive.

RECOMMENDATION

1. That the warrants are not met for placement of a Crossing Guard at the intersection of Burnhamthorpe Road and Creditview Road/ Central Parkway West as students from Queenston Drive Public School, 3520 Queenston Drive, who are crossing at the intersection are in grades seven (7) and eight (8) and are therefore outside of Traffic Safety Council's mandate to place Crossing Guards for students in kindergarten to grade five (5).
2. That the Principal of Queenston Drive Public School, direct students to do the following:
 - a. Cross the road at the intersection of Burnhamthorpe Road and Creditview Road/ Central Parkway West during construction which is taking place on the north side of Burnhamthorpe Road at the Go Station.
 - b. To use the sidewalk on the south side of Burnhamthorpe Road to access The Credit Woodlands and Queenston Drive Public School as the sidewalk is in good repair.

RECOMMEND APPROVAL16. Site Inspection Report – Plum Tree Park Public School, Ward 9

Site Inspection Report for the inspection conduction on April 24, 2012 to review traffic congestion along Plum Tree Crescent for students attending Plum Tree Park Public School, 6855 Tenth Line West.

RECOMMENDATION

1. That the Transportation and Works Department be requested to review the signage along Plum Tree Crescent and remove the Emergency No Parking signs on the boulevard on the east side of Plum Tree Crescent.
2. That the School Zone Safety (Kiss and Ride) Subcommittee of Traffic Safety Council be requested to meet with Dave Marcotte, Supervisor, Preventative Maintenance, Peel District School Board at a Peel District School Board Maintenance meeting to review the School Zone Safety (Kiss and Ride) configuration at Plum Tree Park Public School, 6855 Tenth Line West.
3. That the Walk to School subcommittee of Traffic Safety Council be requested to work with Plum Tree Park Public School to implement the School Walking Routes Program at the school.
4. That once signage is installed along Plum Tree Crescent, Parking Enforcement be requested to conduct a multi day blitz to enforce parking infractions along Plum Tree Crescent between 8:45 a.m. and 9:10 a.m. and 3:30 p.m. and 3:50 p.m.

RECOMMEND APPROVAL

17. Site Inspection Request – Settler's Green

Email dated April 23, 2012 from Kathryn Wigham, Principal, Settler's Green Public School, requesting a site inspection to review the warrants for placing a Crossing Guard in front Settler's Green Public School, 5800 Montevideo Road.

RECOMMENDATION

1. That the email dated April 23, 2012 from Kathryn Wigham, Principal, Settler's Green Public School, requesting a site inspection to review the warrants for placing a Crossing Guard in front of Settler's Green Public School be received.
2. That the site inspection subcommittee of Traffic Safety Council be requested to conduct a site inspection to review the warrants for placing a Crossing Guard in front of Settler's Green Public School, 5800 Montevideo Road.
3. That the School Zone Safety (Kiss and Ride) subcommittee of Traffic Safety Council be requested to conduct an inspection of the School Zone Safety (Kiss and Ride) Lanes at Settler's Green Public School.

RECOMMEND APPROVAL18. Memorandum dated April 20, 2012 from the Legislative Coordinator

Memorandum dated April 20, 2012 from the Legislative Coordinator outlining expenditures incurred in 2012 by the Walk to School Subcommittee of Traffic Safety Council for the implementation of the School Walking Routes Program.

RECOMMENDATION

That the Memorandum dated April 20, 2012 from the Legislative Coordinator outlining expenditures incurred in 2012 by the Walk to School Subcommittee of Traffic Safety Council for the implementation of the School Walking Routes Program be received.

RECOMMEND RECEIPT19. Email dated April 19, 2012 from Sheelagh Duffin, Crossing Guard Supervisor

Email dated April 19, 2012, from Sheelagh Duffin, Crossing Guard Supervisor requesting that School Walking Routes promotional t-shirts be ordered for the Walk to School Subcommittee of Traffic Safety Council to replenish the stock.

RECOMMENDATION

1. That the email dated April 19, 2012, from Sheelagh Duffin, Crossing Guard Supervisor requesting that School Walking Routes promotional t-shirts be ordered for the Walk to School Subcommittee of Traffic Safety Council be received.
2. That the Walk to School subcommittee of Traffic Safety Council be authorized to use up to \$4000.00 of the Walk To School Subcommittee's budget allocation in the 2012 Traffic Safety Council Budget for the purchase of School Walking Routes promotional t-shirts.

RECOMMEND APPROVAL

20. Email dated April 19, 2012 from Sheelagh Duffin, Crossing Guard Supervisor

Email dated April 19, 2012, from Sheelagh Duffin, Crossing Guard Supervisor requesting that forty (40) We Are a Walking School signs be printed and laminated for use by the Walk to School Subcommittee of Traffic Safety Council.

RECOMMENDATION

1. That the email dated April 19, 2012, from Sheelagh Duffin, Crossing Guard Supervisor requesting that forty (40) We Are a Walking School signs be printed and laminated for use by the Walk to School Subcommittee of Traffic Safety Council be received.
2. That the Walk to School subcommittee of Traffic Safety Council be authorized to use up to \$150.00 of the Walk To School Subcommittee's budget allocation in the 2012 Traffic Safety Council Budget to produce forty (40) We are a Walking School sings.

RECOMMEND APPROVAL

21. Traffic Safety Council Site Inspection Calendar – May 2012

RECOMMENDATION

That the Traffic Safety Council Site Inspection Calendar for May 2012 and associated site inspection packages be received.

RECOMMEND RECEIPT

22. Email dated April 10, 2012 from Stephanie Smith, Legislative CoordinatorRECOMMENDATION

That the email dated April 10, 2012 from Stephanie Smith, Legislative Coordinator with respect to Traffic Safety Council's participation in the Road Safety Show on July 1, 2012 from 1:00 p.m. to 4:00 p.m. be received.

RECOMMEND RECEIPT23. Transportation and Works Department – Action Items (March 2012)RECOMMENDATION

That the report dated March 2012 from the Transportation and Works Department advising of the actions taken regarding recommendations from Traffic Safety Council be received.

RECOMMEND RECEIPT

Date of Next Meeting – May 23, 2012 at 5:00 p.m.

OTHER BUSINESSADJOURNMENT

Site Inspection Report - Traffic Safety Council

Observers

Complete All Questions

File Number:

RT.10. St. Vincent de Paul Catholic

File Number:

RT.10.

Ward

3

12

Observed By:

E. Lethbridge

S. Duffin

D. Fryers (AM)

B. Swedak (PM)

D. Pest

Traffic Safety Committee

Date of Inspection:

2012 04 05

Inspection Time:

8:30 AM

3:30 PM

APR 25 2012

Requested By:

Crossing Guard Supervisor

Prepared By:

Request For:

Remove Guard

Weather Conditions: ☒ Dry ☒ Sunny ☐ Rain ☐ Snow ☐ Other: Sunny in the P.M.

Site

School:

St. Vincent de Paul Catholic

Address:

665 Willowbank Trail

School Times:

9:00

AM 3:30

PM

Student Population:

No. of School Buses:

School:

Address:

School Times:

AM

PM

Student Population:

No. of School Buses:

School:

Address:

School Times:

AM

PM

Student Population:

No. of School Buses:

Location: (Please identify the location with reference to nearest intersection. Indicate nearest school and address.)

Rathburn Rd & Willowbank Trail

Type of Crossing: ☒ 4 Way Intersection ☐ 3 Way Intersection ☐ Midblock (i.e., not at Intersection)Type of Control: ☒ Traffic Lights ☐ Yield Signs ☐ No Control☐ Stop Signs (Traffic is stopped on one street only) ☐ All Way Stop (Traffic is stopped in all directions)

Part 1 Site Conditions

School Signs:

☐ School Area Signs☐ School crossing Signs☐ Parking/Stopping Prohibition

Posted Speed Limit:

☐ 40 km/hr☒ 50 km/hr☐ 60 km/hr☐ Other

km/hr

Visibility of Crossing Pedestrians:

☐ Poor☐ Fair☒ Good

Sight Obstructions:

☐ Hedges☐ Trees☐ Fences☐ Bus Shelter☐ Newspaper Boxes☐ Other (Specify)

Road Grade:

☒ Flat☐ Incline☐ Decline

Road Geometrics:

☒ Straight☐ Curved

Road Width: N/A

☐ Feet☐ Metres

Curb to Curb:

☐ Feet☐ Metres

Curb to Median:

☐ Feet☐ Metres

Road Conditions:

☒ Dry☐ Wet☐ Snow Covered☐ Ice

Sidewalks:

☐ Not Present☒ North☒ South☒ East☒ West

Proximity to School:

☐ In Front of☒ Within 100☐ Feet☒ Metres

Route Survey:

☐ Shopping Area☐ Construction☐ Driveway☐ Other (Specify)

Road Geometrics:

☐ Transit Bus Stop☐ Underpass☐ Parked Vehicles Within☐ Feet☐ Metres

Warrant Survey

Check Appropriate Box For The Access Required

Location:

12a

Rathburn Rd & Willowbank Trail

SAFE GAP TIME (W/3.5+4) = N/A SEC.

Morning Intervals

No.

Peds.: Time:

Gaps:

		East Leg	South Leg	Peds. South	# of Gaps	# of Conflicts
0	8:30-8:35	0,0,0	0	0		
0	8:35-8:40	/,/,0	2,0,0	0		
0	8:40-8:45	/,/	0,0	0		
3	8:45-8:50	/,/,/	0,0	0		
5	8:50-8:55	/,/,/,/,/	/,/,0,0	0		
4	8:55-9:00	/,/,/,/,/	/,/,0	0		

Afternoon Intervals

No./

Peds.: Time:

Gaps:

		East Leg	South Leg	Peds (South)
6	3:30-3:35	/,/,/,2	/,/,/,/,/	2
15	3:35-3:40	2,3,0	0,/,0,3,2	2
0	3:40-3:45	0,0,0	2,/,5	0
1	3:45-3:50	0,0,/	3,0,3	1
0	3:50-3:55	/,/,2	/,3,3	0
0	3:55-4:00	0,0,/	2,2,2	0

Comments/Conflicts

St. Vincent de Paul student population = 226. Turning traffic was light. Younger students crossed with adults. No conflicts were observed. Motorists were courteous to crossing pedestrians. Entry and dismissal times for John Cabot Secondary School are offset at 8:15 a.m. and 2:50 p.m. and therefore do not impact school entry and dismissal at St. Vincent de Paul.

Recommendations

Please see second site inspection conducted on April 17, 2012 for recommendation.

Observations

A) Volume of Traffic: (See Intersection Plan)

B) Number of Crossing Pedestrians

☐ Heavy ☒ Light ☐ Intermittent

12 AM 27 PM

Site Inspection Report - Traffic Safety Council

12b

Observers

Complete All Questions

File Number:

RT.10. St. Vincent de Paul Catholic

File Number:

RT.10.

Ward

3

Observed By:

Date of Inspection:

2012 04 17

Inspection Time:

8:30 AM

3:30 PM

Requested By:

Crossing Guard Supervisor

Prepared By:

Request For:

Removal of Guard

Weather Conditions: ☐ Dry ☐ Sunny ☐ Rain ☐ Snow ☐ Other:**Site**

School:

St. Vincent de Paul Catholic

Address:

665 Willowbank Trail

School Times:

9:00

AM 3:30

PM

Student Population:

No. of School Buses:

School:

Address:

School Times:

AM

PM

Student Population:

No. of School Buses:

School:

Address:

School Times:

AM

PM

Student Population:

No. of School Buses:

Location: (Please identify the location with reference to nearest intersection. Indicate nearest school and address.)

Rathburn Road and Willowbank TrailType of Crossing: ☐ 4 Way Intersection ☐ 3 Way Intersection ☐ Midblock (i.e., not at Intersection)Type of Control: ☐ Traffic Lights ☐ Yield Signs ☐ No Control☐ Stop Signs (Traffic is stopped on one street only) ☐ All Way Stop (Traffic is stopped in all directions)**Part 1 Site Conditions**

School Signs:

☐ School Area Signs☐ School crossing Signs☐ Parking/Stopping Prohibition

Posted Speed Limit:

☐ 40 km/hr☒ 50 km/hr☐ 60 km/hr☐ Other

km/hr

Visibility of Crossing Pedestrians:

☐ Poor☐ Fair☐ Good

Sight Obstructions:

☐ Hedges☐ Trees☐ Fences☐ Bus Shelter☐ Newspaper Boxes☐ Other (Specify)

Road Grade:

☒ Flat☐ Incline☐ Decline

Road Geometrics:

☒ Straight☐ Curved

Road Width: N/A

☐ Feet☐ Metres

Curb to Curb:

☐ Feet☐ Metres

Curb to Median:

☐ Feet☐ Metres

Road Conditions:

☒ Dry☐ Wet☐ Snow Covered☐ Ice

Sidewalks:

☐ Not Present☒ North☒ South☒ East☒ West

Proximity to School:

☐ In Front of☒ Within 100☐ Feet☒ Metres

Route Survey:

☐ Shopping Area☐ Construction☐ Driveway☐ Other (Specify)

Road Geometrics:

☐ Transit Bus Stop☐ Underpass☐ Parked Vehicles Within☐ Feet☐ Metres

Warrant Survey

Check Appropriate Box For The Access Required

Location:

12c

Rathburn Road and Willowbank Trail

SAFE GAP TIME (W/3.5+4) = SEC.

Morning Intervals

No.

Peds.: Time:

Gaps:

		East Leg	South Leg	Peds. South	# of Gaps	# of Conflicts
0	8:30-8:35	0,1,0	0,2,0	0		
1	8:35-8:40	0	0	0		
0	8:40-8:45	1,3,2	0,0,0	0		
4	8:45-8:50	1,1	0,0	2		
6	8:50-8:55	0,3,4	1,0,1	0		
2	8:55-9:00	0,1,2	1,2,1			

Afternoon Intervals

No./

Peds.: Time:

Gaps:

		East Leg	South Leg	Peds. South
9	3:30-3:35	0,1,1,2	1,2,1,1	0
5	3:35-3:40	1,4,0	2,0,3,1	0
0	3:40-3:45	2,0,2,3,0	0,2,1,2	0
0	3:45-3:50	1,1	2,1	0
0	3:50-3:55	0,0,1	1,0,1	0
0	3:55-4:00	0,0,2	1,0	0
	4:00-4:05			
	4:05-4:10			
	4:10-4:15			
	4:10-4:15			
	4:20-4:25			
	4:25-4:30			

Comments/Conflicts

No Conflicts were observed. Turning traffic was light and drivers were courteous to crossing pedestrians. Younger students crossed with parents and traffic control signals provide protection for crossing students.

Recommendations

1. That the Crossing Guard currently located at the intersection of Rathburn Road and Willowbank Trail for students attending St. Vincent de Paul Catholic School, 665 Willowbank Trail be removed in June 2012 at the end of the 2012 school year as the warrants for a Crossing Guard are no longer met and turning traffic is light. 2. That the Transportation and Works Department be requested to re-paint the crosswalk lines at the intersection of Rathburn Road and Willowbank Trail. 3. That the Principal of St. Vincent de Paul Catholic School be requested to notify the affected students and parents of the removal of the Crossing Guard at the end of the school year, June 29, 2012.

Observations

A) Volume of Traffic: (See Intersection Plan)

B) Number of Crossing Pedestrians

☐ Heavy ☒ Light ☐ Intermittent

13 AM 14 PM

RATHBURN RD & WILLOWBANK TR. APRIL 5 @ 830 & 330

Laura Wilson

From: Sheelagh Duffin
Sent: March 26, 2012 3:29 PM
To: Laura Wilson
Subject: Site Inspection Requests
Attachments: Sheelagh Duffin.vcf

12d

Hi Laura,

We have been monitoring the number of student walkers at several Mississauga school crossings. They are schools with fairly low student populations. We have noticed that the number of walkers has dropped significantly as has the amount of turning traffic. Therefore we would like to request that Traffic Safety review the following intersections :

~~1) Confederation Parkway & Fairview Road West for the students of Fairview Public School & St. Philip Catholic School (316 students). The times for the inspections would be 8:00 - 8:50 am and 3:00 to 3:50 pm.~~

* 2) Rathburn Road & Willowbank Trail for the students of St. Vincent de Paul Catholic School (226 students). The * times for the Site Inspection would be 8:30 - 9:00 am and 3:30 - 4:00 pm.

~~3) Rathburn Road & Golden Orchard Drive for the students of St. Basil Catholic School (295 students). The times for the Site Inspection would be 8:15 - 8:45 am and 3:15 - 3:45 pm.~~

Would you kindly schedule 2 Site Inspections in April for each of the 3 locations with a view to possible crossing guard removal at the end of the school year, June 30, 2012.

Thank you.

Sheelagh
5167

Sheelagh Duffin

City of Mississauga
Supervisor, Crossing Guards

(905) 896-5167 Fax 896-5583 Work
sheelagh.duffin@mississauga.ca

3185 Mavis Road
Mississauga ON L5C 1T7

12e

RATHBURN RD & WILLOWBANK TR APRIL 5 & 17 @ 830 & 330

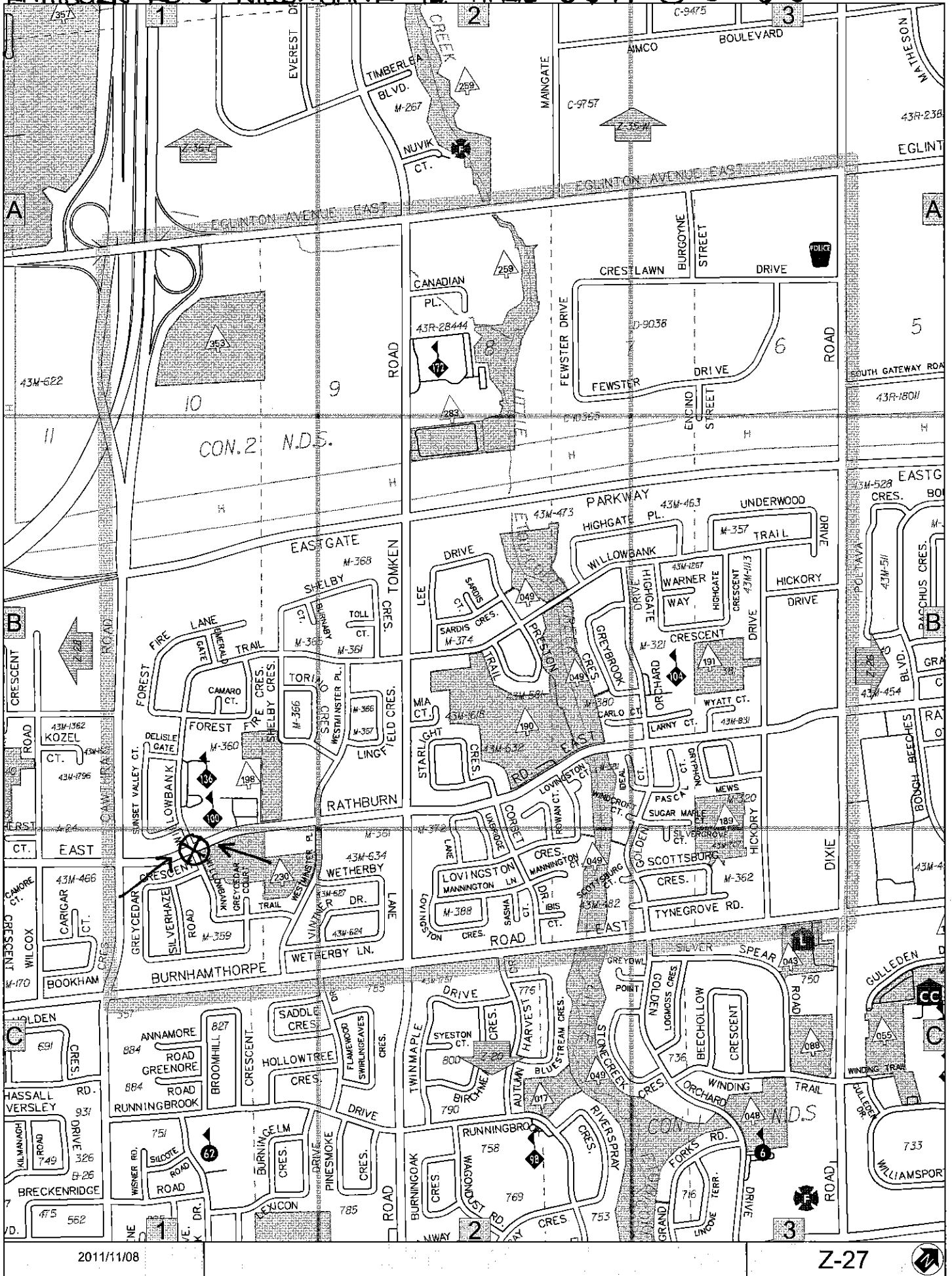

Site Inspection Report - Traffic Safety Council

13

Observers

Complete All Questions

File Number:

RT.10. St. Basil Catholic School

File Number:

RT.10.

Ward

3

Traffic Safety Committee

Observed By:

D. Duffin

P. Westbrook

D. Yaunan

APR 25 2012

D. Fryers

Date of Inspection:

2012 04 10

Inspection Time:

8:30 AM

3:30 PM

Requested By:

Crossing Guard Supervisor

Prepared By:

P. Westbrook

Request For:

Removal of Crossing Guard

Weather Conditions: ☒ Dry ☐ Sunny ☐ Rain ☐ Snow ☐ Other:

Site

School:

St. Basil Catholic School

Address:

4235 Golden Orchard Drive

School Times: 9:00 AM 3:30 PM

Student Population:

No. of School Buses:

School:

Address:

School Times: AM PM

Student Population:

No. of School Buses:

School:

Address:

School Times: AM PM

Student Population:

No. of School Buses:

Location: (Please identify the location with reference to nearest intersection. Indicate nearest school and address.)

Rathburn Road and Golden Orchard Drive

Type of Crossing: ☒ 4 Way Intersection ☐ 3 Way Intersection ☐ Midblock (i.e., not at Intersection)

Type of Control: ☒ Traffic Lights ☐ Yield Signs ☐ No Control

☐ Stop Signs (Traffic is stopped on one street only) ☐ All Way Stop (Traffic is stopped in all directions)

Part 1 Site Conditions

School Signs:

☐ School Area Signs

☐ School crossing Signs

☐ Parking/Stopping Prohibition

Posted Speed Limit:

☐ 40 km/hr

☒ 50 km/hr

☐ 60 km/hr

☐ Other

km/hr

Visibility of Crossing Pedestrians: ☐ Poor

☐ Fair

☒ Good

Sight Obstructions:

☐ Hedges

☐ Trees

☐ Fences

☐ Bus Shelter

☐ Newspaper Boxes

☐ Other (Specify)

Road Grade:

☐ Flat

☒ Incline

☐ Decline

Road Geometrics:

☒ Straight

☐ Curved

Road Width: N/A

☐ Feet

☐ Metres

Curb to Curb:

☐ Feet

☐ Metres

Curb to Median:

☐ Feet

☐ Metres

Road Conditions:

☒ Dry

☐ Wet

☐ Snow Covered

☐ Ice

Sidewalks:

☐ Not Present

☒ North

☒ South

☒ East

☒ West

Proximity to School:

☐ In Front of

☐ Within 200

☐ Feet

☒ Metres

Route Survey:

☐ Shopping Area

☐ Construction

☐ Driveway

☐ Other (Specify)

Road Geometrics:

☐ Transit Bus Stop

☐ Underpass

☐ Parked Vehicles Within

☐ Feet

☐ Metres

Warrant Survey

Check Appropriate Box For The Access Required

Location:

13a

Rathburn Road and Golden Orchard Drive

SAFE GAP TIME (W/3.5+4) = N/A SEC.

Morning Intervals

No.

Peds.: Time:

Gaps:

		East Leg	South Leg	Peds (S Leg)	# of Gaps	# of Conflicts
0	8:15-8:20	2,2	2,1	0		
0	8:20-8:25	3,1,1	2,0,0	0		
0	8:25-8:30	1,1,3	0,0,1	0		
0	8:30-8:35	5,4,4	1,0,0	0		
3	8:35-8:40	1,1,0	1,1,0	0		
7	8:40-8:45	2,2,2	0,4,3	2		
0	8:45-8:50	2	0	0		
	8:55-9:00					

Afternoon Intervals

No./

Peds.: Time:

Gaps:

		East Leg	South Leg	Peds (S Leg)
	3:15-3:20	2	0	0
1	3:20-3:25	5,1	0,1	0
5	3:25-3:30	2,0,1	1,0,1	2
0	3:30-3:35	2	2	0
	3:35-3:40			
	3:40-3:45			
	3:45-3:50			
	3:50-3:55			

Comments/Conflicts

St. Basil Catholic School student population = 295. No conflicts were observed. Turning Traffic was courteous to pedestrians. 60% of students crossing were younger and crossed with parents. 40% of students crossing were older students.

Recommendations

See second site inspection conducted on April 19, 2012 for recommendations

Observations

A) Volume of Traffic: (See Intersection Plan)

B) Number of Crossing Pedestrians

☐ Heavy ☐ Light ☒ Intermittent

e10 & s2 AM e6 & s2 PM

Site Inspection Report - Traffic Safety Council

13b

Observers

Complete All Questions

File Number:

File Number:

Ward

RT.10. St. Basil Catholic School

RT.10.

3

Observed By:

D. Yaunan

S. Duffin

E. Lethbridge

P. Westbrook (PM)

D. Fryers

Date of Inspection:

2012 04 19

Inspection Time:

8:30 AM

3:30 PM

Requested By:

Crossing Guard Supervisor

Prepared By:

Request For:

Removal of Crossing Guard

Weather Conditions: ☐ Dry ☒ Sunny ☐ Rain ☐ Snow ☒ Other: +15 degrees cel. in A.M.**Site**

School:

St. Basil Catholic School

Address:

4235 Golden Orchard Drive

School Times:

9:00

AM 3:30

PM

Student Population:

No. of School Buses:

School:

Address:

School Times:

AM

PM

Student Population:

No. of School Buses:

School:

Address:

School Times:

AM

PM

Student Population:

No. of School Buses:

Location: (Please identify the location with reference to nearest intersection. Indicate nearest school and address.)

Rathburn Road and Golden Orchard DriveType of Crossing: ☒ 4 Way Intersection ☐ 3 Way Intersection ☐ Midblock (i.e., not at Intersection)Type of Control: ☒ Traffic Lights ☐ Yield Signs ☐ No Control☐ Stop Signs (Traffic is stopped on one street only) ☐ All Way Stop (Traffic is stopped in all directions)**Part 1 Site Conditions**

School Signs:

☐ School Area Signs☐ School crossing Signs☐ Parking/Stopping Prohibition

Posted Speed Limit:

☐ 40 km/hr☒ 50 km/hr☐ 60 km/hr☐ Other

km/hr

Visibility of Crossing Pedestrians:

☐ Poor☐ Fair☒ Good

Sight Obstructions:

☐ Hedges☐ Trees☐ Fences☐ Bus Shelter☐ Newspaper Boxes☐ Other (Specify)

Road Grade:

☐ Flat☒ Incline☐ Decline

Road Geometrics:

☒ Straight☐ Curved

Road Width: N/A

☐ Feet☐ Metres

Curb to Curb:

☐ Feet☐ Metres

Curb to Median:

☐ Feet☐ Metres

Road Conditions:

☒ Dry☐ Wet☐ Snow Covered☐ Ice

Sidewalks:

☐ Not Present☒ North☒ South☒ East☒ West

Proximity to School:

☐ In Front of☒ Within 200☐ Feet☒ Metres

Route Survey:

☐ Shopping Area☐ Construction☐ Driveway☐ Other (Specify)

Road Geometrics:

☐ Transit Bus Stop☐ Underpass☐ Parked Vehicles Within☐ Feet☐ Metres

Location: 13c

Rathburn Road and Golden Orchard Drive

Morning Intervals

No.
Peds.: Time: Gaps:

		East Leg	South Leg	Peds (S. Leg)	# of Gaps	# of Conflicts
0	8:15-8:20	1,3	2,4	0		
0	8:20-8:25	5,3	1,4	0		
2	8:25-8:30	0	3	2		
3	8:30-8:35	2,2,3	1,1,1	0		
3	8:35-8:40	2,6,3	1,0	2		
3	8:40-8:45	3,4,6	3,0,3	2		

No./ Peds.:	Time:	Gaps: East Leg	South Leg	Peds (S. Leg)
0	3:15-3:20	///,///	///	0
8	3:20-3:25	///,////,/	///,/	4
0	3:25-3:30	/,/	/,///	0
0	3:30-3:35	/,///,///	0,///,/	0
0	3:35-3:40	/,/	/,0,0	0
0	3:40-3:45	///,0,/	0,///	0

Recommendations

1. That the Crossing Guard currently positioned at Golden Orchard Drive and Rathburn Road be retained for students attending St. Basil Catholic School, 4235 Golden Orchard Drive, as the warrants for placement of a Crossing Guard are met. 2. That the Site Inspection Subcommittee of Traffic Safety Council be requested to conduct a site inspection in September 2012 to review the warrants for removing the Crossing Guard currently positioned at Golden Orchard Drive and Rathburn Road as the volume of turning traffic between the site inspections conducted at Golden Orchard Drive and Rathburn Road on April 10, 2012 and April 19, 2012 are inconsistent when students are crossing.

A) Volume of Traffic: (See Intersection Plan)

☐ Heavy ☐ Light ☒ Intermittent

B) Number of Crossing Pedestrians

s6 & e11 AM s4 & e8 PM

Laura Wilson

13d

From: Sheelagh Duffin
Sent: March 26, 2012 3:29 PM
To: Laura Wilson
Subject: Site Inspection Requests
Attachments: Sheelagh Duffin.vcf

Hi Laura,

We have been monitoring the number of student walkers at several Mississauga school crossings. They are schools with fairly low student populations. We have noticed that the number of walkers has dropped significantly as has the amount of turning traffic. Therefore we would like to request that Traffic Safety review the following intersections :

~~1) Confederation Parkway & Fairview Road West for the students of Fairview Public School & St. Philip Catholic School (316 students). The times for the inspections would be 8:00 - 8:50 am and 3:00 to 3:50 pm.~~

~~2) Rathburn Road & Willowbank Trail for the students of St. Vincent de Paul Catholic School (226 students). The times for the Site Inspection would be 8:30 - 9:00 am and 3:30 - 4:00 pm.~~

* 3) Rathburn Road & Golden Orchard Drive for the students of St. Basil Catholic School (295 students). The times for the Site Inspection would be 8:15 - 8:45 am and 3:15 - 3:45 pm. *

Would you kindly schedule 2 Site Inspections in April for each of the 3 locations with a view to possible crossing guard removal at the end of the school year, June 30, 2012.

Thank you.

Sheelagh
5167

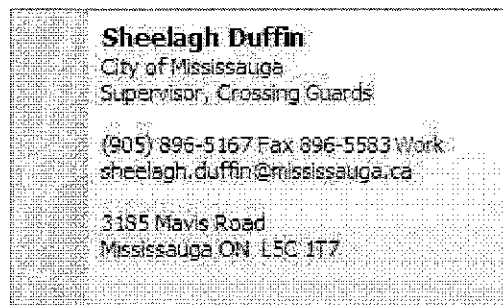

RATHBURN RD & GOLDEN ORCHARD APRIL 10 & 19 @ 815 & 315

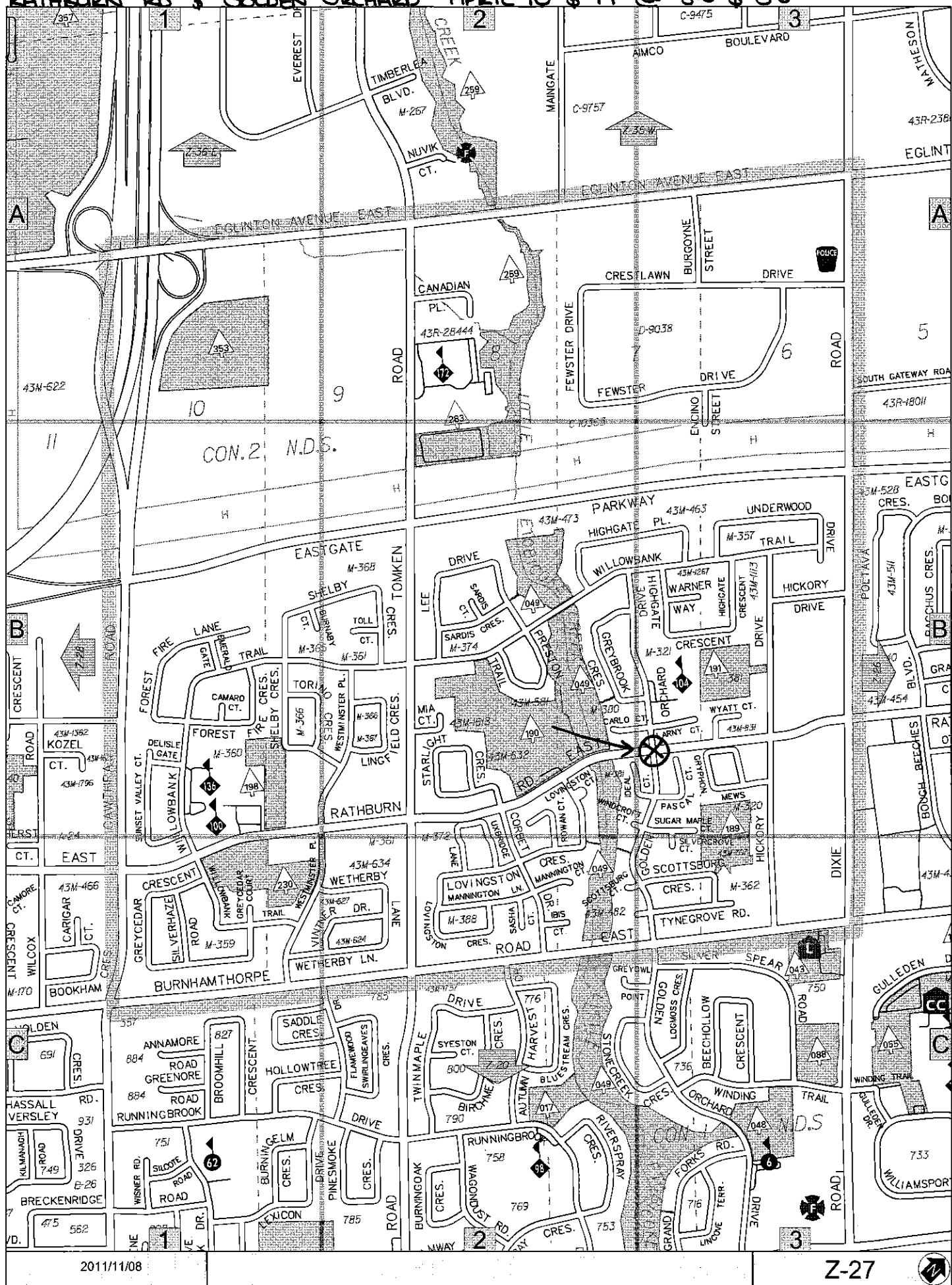

Site Inspection Report - Traffic Safety Council

14

Observers

Complete All Questions

File Number:

RT.10. St. Valentine Catholic School

File Number:

RT.10.

Ward

6

Observed By:

D. Fryers

D. Pest

B. Swedak (PM) Traffic Safety Committee

S. Duffin

APR 25 2012

Date of Inspection:

2012 04 11

Inspection Time:

8:00 AM

3:00 PM

Requested By:

STOPR

Prepared By:

D. Fryers

Request For:

Crossing Guard

Weather Conditions: ☒ Dry ☐ Sunny ☐ Rain ☐ Snow ☐ Other:

Site

School:

St. Valentine Catholic School

Address:

5610 Heatherleigh Ave

School Times: 8:30 AM 3:00 PM

Student Population:

No. of School Buses:

School:

Address:

School Times: AM PM

Student Population:

No. of School Buses:

School:

Address:

School Times: AM PM

Student Population:

No. of School Buses:

Location: (Please identify the location with reference to nearest intersection. Indicate nearest school and address.)

Heatherleigh Avenue & Bristol Road

Type of Crossing: ☒ 4 Way Intersection ☐ 3 Way Intersection ☐ Midblock (i.e., not at Intersection)

Type of Control: ☐ Traffic Lights ☐ Yield Signs ☐ No Control

☒ Stop Signs (Traffic is stopped on one street only) ☐ All Way Stop (Traffic is stopped in all directions)

Part 1 Site Conditions

School Signs:

☐ School Area Signs

☐ School crossing Signs

☐ Parking/Stopping Prohibition

Posted Speed Limit:

☐ 40 km/hr

☒ 50 km/hr

☐ 60 km/hr

☐ Other

km/hr

Visibility of Crossing Pedestrians:

☐ Poor

☐ Fair

☒ Good

Sight Obstructions:

☐ Hedges

☐ Trees

☐ Fences

☐ Bus Shelter

☐ Newspaper Boxes

☐ Other (Specify)

Road Grade:

☒ Flat

☐ Incline

☐ Decline

Road Geometrics:

☒ Straight

☐ Curved

Road Width: 75

☐ Feet

☐ Metres

Curb to Curb:

☐ Feet

☐ Metres

Curb to Median:

☐ Feet

☐ Metres

Road Conditions:

☒ Dry ☐ Wet

☐ Snow Covered

☐ Ice

Sidewalks:

☐ Not Present

☒ North

☐ South

☒ East

☒ West

Proximity to School:

☐ In Front of

☒ Within 1000

☐ Feet ☐ Metres

Route Survey:

☐ Shopping Area

☒ Construction

☐ Driveway

☐ Other (Specify)

Road Geometrics:

☐ Transit Bus Stop

☐ Underpass

☐ Parked Vehicles Within

☐ Feet

☐ Metres

Warrant Survey

Check Appropriate Box For The Access Required

Location: 14a

Heatherleigh Avenue & Bristol Road

SAFE GAP TIME (W/3.5+4) = 25 SEC.

Morning Intervals

No.
Peds.: Time: Gaps:

			# of Gaps	# of Conflicts
0	8:00-8:05	158 Cars (1, 38 second gap due to school bus drop off)		0
0	8:05-8:10	128 Cars	0	0
0	8:10-8:15	215 Cars	0	0
0	8:15-8:20	160 Cars	0	0
0	8:20-8:25	163 Cars	0	0
0	8:25-8:30	134 Cars	0	0

Afternoon Intervals

No./
Peds.: Time: Gaps:

0	3:00-3:05	93 Cars, 56 Cars, 25 Second Gap, 37 Cars	1	0
0	3:05-3:10	64 Cars, 32 Second Gap	1	0
0	3:10-3:15	99 Cars	0	0
0	3:15-3:20	79 Cars	0	0
0	3:20-3:25	112 Cars, 35 Artificial Second Gap for School Bus	0	0
0	3:25-3:30	87 Cars	0	0

Comments/Conflicts

3:20 - 12 students were dropped off by school bus on the south side to go into the new subdivision at the south west corner. No students will be crossing here until September 2012 when bussing will be removed. Traffic was heavy - all four lanes and moving at an average speed higher than the posted speed limit of 50 km/ hour.

Recommendations

1. That the request for a Crossing Guard at the intersection of Bristol Road and Heatherleigh Avenue for students attending St. Valentine Catholic School 5610 Heatherleigh Avenue be denied as Traffic Safety Council does not recommend a Crossing Guard at this location until traffic controls are installed for through traffic on Bristol Road and turning traffic from Heatherleigh Road on the north side. 2. That the Site Inspection Subcommittee of Traffic Safety Council be requested to re-inspect the intersection of Bristol Road and Heatherleigh Avenue when Bristol Road is re-configured to a two lane road with bike lanes and a centre turning lane. 3. That Student Transportation of Peel Region (STOPR) be requested to retain bussing for students living south of Bristol Road until road improvements have been completed and the Site Inspection Subcommittee of Traffic Safety Council has had the opportunity to re-inspect the intersection of Bristol Road and Heatherleigh Avenue.

Observations

A) Volume of Traffic: (See Intersection Plan)

B) Number of Crossing Pedestrians

☒ Heavy ☐ Light ☐ Intermittent

0 AM 0 PM

BRISTOL RD & HEATHERLEIGH AVE. APRIL 11 @ 8⁰⁰ & 3⁰⁰

Laura Wilson

Subject: FW: St Valentine - New Streets Bristol & Heatherleigh

14b

From: Sheelagh Duffin [mailto:Sheelagh.Duffin@mississauga.ca]

Sent: Thursday, January 12, 2012 9:52 AM

To: Gentile, Anna

Cc: Laura Wilson

Subject: RE: St Valentine - New Streets Bristol & Heatherleigh

Hi Anna,

Yes, because Bristol Road is a busy road it would be a good idea to do a Site Inspection this Spring to determine if the traffic warrants are met for the placement of a crossing guard for September 2012. If met, the guard would be placed in September and the warrants reviewed once there are students crossing. By copy of this email to Laura Wilson, I am requesting that a Site inspection be scheduled for March after March Break or April.

The times for the Site Inspection would be:

8:00 - 8:30 am and 3:00 - 3:30pm for the students of St. Valentine Catholic School

Thank you.

Sheelagh

Sheelagh Duffin
Supervisor, Crossing Guards
City of Mississauga
3185 Mavis Road
Mississauga ON L5C 1T7
Phone 905 896-5167
Fax 905 896-5583
sheelagh.duffin@mississauga.ca

From: Gentile, Anna [mailto:Anna.Gentile@dpcdsb.org]

Sent: 2012/01/10 12:35 PM

To: Sheelagh Duffin

Subject: St Valentine - New Streets Bristol & Heatherleigh

Hi Sheelagh!

I have a question regarding the new subdivision south of Bristol at Heatherleigh. Students moving into those new streets will attend St Valentine School. All grades 1 to 8 students (as well as a handful of kindergarten students) will be within walking distance to the school. We will temporarily bus them for now, until the end of June 2012, however we need to know if there is a possibility of getting a Crossing Guard at Bristol & Heatherleigh beginning September 2012.

I know site inspections are usually done after school starts...but because we are temporarily bussing for this year, would it possible to get a preliminary site inspection done now, just so we have an idea of how to proceed for September.

Let me know what you think.

Please and thanks,

Anna

14C

BRISTOL RD 3 HEATHERLEIGH AVE APRIL 11 @ 800 & 330

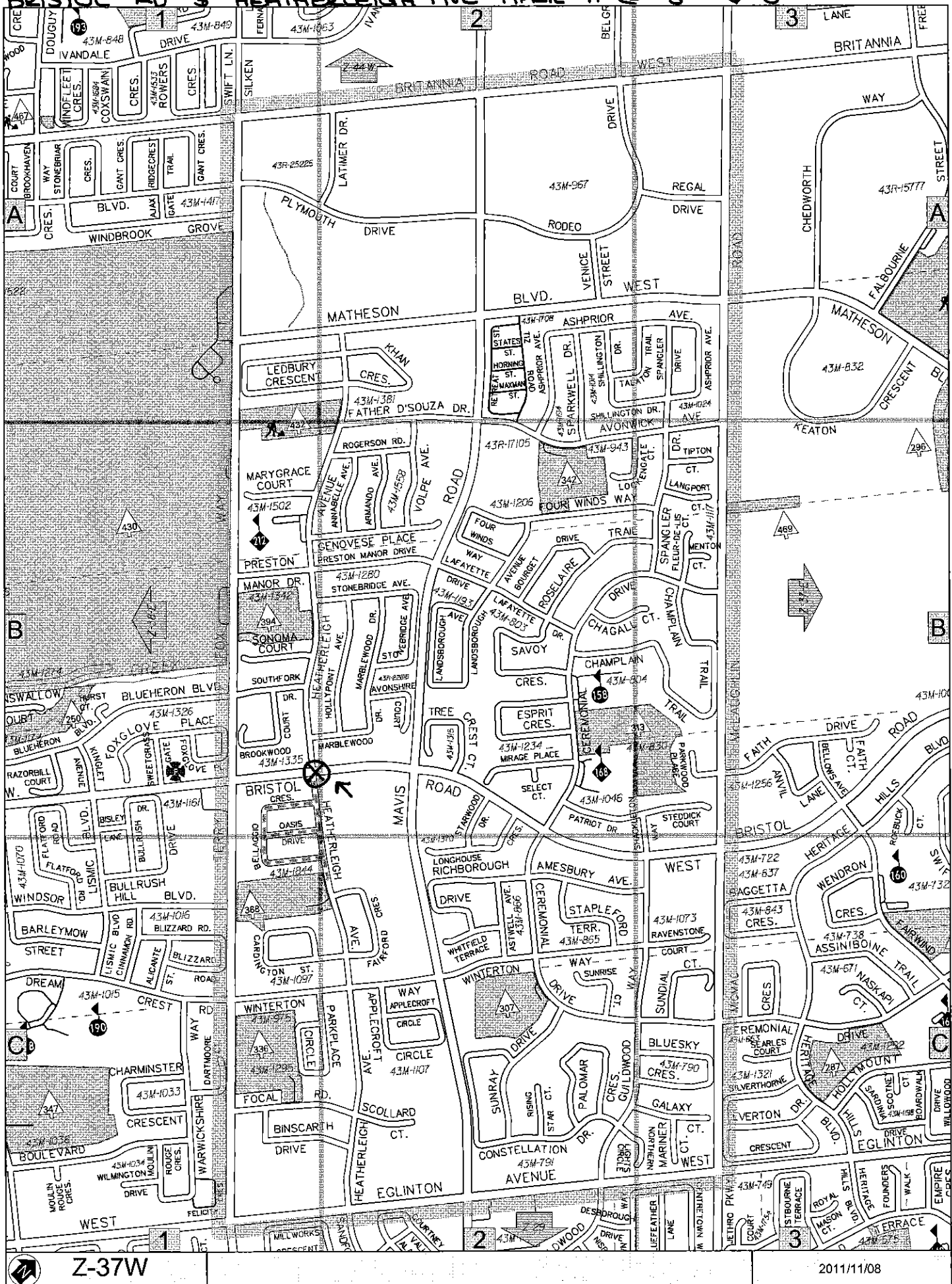

Site Inspection Report - Traffic Safety Council

15

Observers Complete All Questions		Ward	Traffic Safety Committee APR 25 2012
File Number: RT.10. Queenston Drive Public School	File Number: RT.10.		
Observed By: S. Duffin	D. Castronovo	D. Brown	
D. Yaunan	D. Suess		
Date of Inspection: 2012 04 18	Inspection Time: 8:30 AM 3:30 PM		
Requested By: Resident	Prepared By: S. Duffin	Request For: Review Pedestrian Safety	

Weather Conditions: ☒ Dry ☒ Sunny ☐ Rain ☐ Snow ☐ Other:

Site

School: Queenston Drive Public School	Address: 3520 Queenston Drive	School Times: 9:00 AM 3:30 PM Student Population: No. of School Buses:
School:	Address:	School Times: AM PM Student Population: No. of School Buses:
School:	Address:	School Times: AM PM Student Population: No. of School Buses:

Location: (Please identify the location with reference to nearest intersection. Indicate nearest school and address.)

Intersection of Burnhamthorpe Rd and Creditview Rd/ Central Pkwy AND pedestrian safety along walking route from Burnhamthorpe Rd & Creditview Rd. to Queenston Drive Public School

Type of Crossing: ☒ 4 Way Intersection ☐ 3 Way Intersection ☐ Midblock (i.e., not at Intersection)
 Type of Control: ☒ Traffic Lights ☐ Yield Signs ☐ No Control
☐ Stop Signs (Traffic is stopped on one street only) ☐ All Way Stop (Traffic is stopped in all directions)

Part 1 Site Conditions

School Signs: ☐ School Area Signs ☐ School crossing Signs ☐ Parking/Stopping Prohibition

Posted Speed Limit: ☐ 40 km/hr ☐ 50 km/hr ☒ 60 km/hr ☐ Other km/hr

Visibility of Crossing Pedestrians: ☐ Poor ☐ Fair ☒ Good

Sight Obstructions: ☐ Hedges ☐ Trees ☐ Fences ☐ Bus Shelter
☐ Newspaper Boxes ☐ Other (Specify)

Road Grade: ☐ Flat ☐ Incline ☐ Decline

Road Geometrics: ☐ Straight ☐ Curved

Road Width: ☐ Feet ☐ Metres Curb to Curb: ☐ Feet ☐ Metres Curb to Median: ☐ Feet ☐ Metres

Road Conditions: ☒ Dry ☐ Wet ☐ Snow Covered ☐ Ice

Sidewalks: ☐ Not Present ☒ North ☒ South ☒ East ☒ West

Proximity to School: ☐ In Front of ☒ Within 2000 ☐ Feet ☒ Metres

Route Survey: ☒ Shopping Area ☐ Construction ☐ Driveway ☐ Other (Specify)

Road Geometrics: ☒ Transit Bus Stop ☐ Underpass ☐ Parked Vehicles Within ☐ Feet ☐ Metres

Warrant Survey

Check Appropriate Box For The Access Required

Location: 15a

Intersection of Burnhamthorpe Rd and Creditview Rd/ Central Pkwy AND pedestrian safety along walking route from Burnhamthorpe Rd & Creditview Rd. to Queenston Drive Public School

SAFE GAP TIME (W/3.5+4) = N/A SEC.

Morning Intervals

No.
Peds.: Time: Gaps:

	E Turning Traffic	S Turning Traffic.	# of Gaps	# of Conflicts
8:30-8:35	////,///,////,////,	////,////		
8:35-8:40	////,////,////,////,////	///,////,////		
8:40-8:45	////,////,////,	////, ,////,////,////		
8:45-8:50	////,////,////,////,	////,////,////,////,		
8:50-8:55	////,////, ,////,	////,////,////,////,////,		
8:55-9:00	////,////, ,////,	////,////,////,////,////,		

Afternoon Intervals

No./	E. Turning Traffic	S Turning Traffic
Peds.: Time: Gaps:		
3:30-3:35	////, ,////,////,	////,////, ,////
3:35-3:40	////,////, ,	////, ,////,
3:40-3:45	////,////, ,////,	////,////,////,
3:45-3:50	////,////	///,////
3:50-3:55	////,////, ,////,	, ,0
3:55-4:00	////,////, ,////,	////, ,

Comments/Conflicts

25 grade 7 & 8 Queenston Drive students not accommodated in regular school bussing for 2011-2012 school year. The intersection functions well and no conflicts were observed. Traffic is courteous to crossing pedestrians. Zebra stripes & advance turning arrows provide protection for crossing pedestrians. Many adult pedestrians and some private school students cross the intersection. Some of the 25 grade 7 & 8 students have been accommodated on courtesy bussing either a.m. or p.m.

Recommendations

1. That the warrants are not met for placement of a Crossing Guard at the intersection of Burnhamthorpe Road and Creditview Road/ Central Parkway West as students from Queenston Drive Public School, 3520 Queenston Drive, who are crossing at the intersection are in grades seven (7) and eight (8) and are therefore outside of Traffic Safety Council's mandate to place Crossing Guards for students in kindergarten to grade five (5).
2. That the Principal of Queenston Drive Public School, direct students to do the following: a. Cross the road at the intersection of Burnhamthorpe Road and Creditview Road/ Central Parkway West during construction which is taking place on the north side of Burnhamthorpe Road at the Go Station.
b. To use the sidewalk on the south side of Burnhamthorpe Road to access The Credit Woodlands and Queenston Drive Public School as the sidewalk is in good repair.

Observations

A) Volume of Traffic: (See Intersection Plan)

B) Number of Crossing Pedestrians

☒ Heavy ☐ Light ☐ Intermittent

0 AM 0 PM

Warrant Survey

Check Appropriate Box For The Access Required

Location:

15b

Intersection of Burnhamthorpe Rd and Creditview Rd/ Central Pkwy AND pedestrian safety along walking route from Burnhamthorpe Rd & Creditview Rd. to Queenston Drive Public School

SAFE GAP TIME (W/3.5+4) = N/A SEC.

Morning Intervals

No.

Peds.: Time: Gaps:

	W Turning Traffic	N Turning Traffic	# of Gaps	# of Conflicts
8:30-8:35	////,////			
8:35-8:40	////,////,////			
8:40-8:45	//////////			
8:45-8:50	//////////			
8:50-8:55	////,////			
8:55-9:00	////////,////////			
9:00-9:05	////////			

Afternoon Intervals

No./

Peds.:	Time:	Gaps:	W Turning Traffic	North Turning Traffic
	3:30-3:35	////,////,////	/,0	
	3:35-3:40	10,/	5,9	
	3:40-3:45	16,//	19,2	
4	3:45-3:50	9,9	12,14	
1	3:50-3:55	9,7	10,13,5	
	3:55-4:00	8,7,11	12,11	

Comments/Conflicts

25 grade 7 & 8 Queenston Drive Dtudents not accomodated in regular school bussin for 2011-2012 school year. The intersection functions well and no conflicts were observed. Traffic is courteous to crossing pedestrians. Zebra stripes & advance turning arrows provide protection for crossing pedestrians. Many adult pedestrians and some private school students cross the intersection. Some of the 25 grade 7 & 8 students have been accommodated on courtesy bussin either a.m. or p.m.

Recommendations

1. That the warrants are not met for placement of a Crossing Guard at the intersection of Burnhamthorpe Road and Creditview Road/ Central Parkway West as students from Queenston Drive Public School, 3520 Queenston Drive, who are crossing at the intersection are in grades seven (7) and eight (8) and are therefore outside of Traffic Safety Council's mandate to place Crossing Guards for students in kindergarten to grade five (5).
2. That the Principal of Queenston Drive Public School, direct students to do the following: a. Cross the road at the intersection of Burnhamthorpe Road and Creditview Road/ Central Parkway West during construction which is taking place on the north side of Burnhamthorpe Road at the Go Station.
b. To use the sidewalk on the south side of Burnhamthorpe Road to access The Credit Woodlands and Queenston Drive Public School as the sidewalk is in good repair.

Observations

A) Volume of Traffic: (See Intersection Plan)

B) Number of Crossing Pedestrians

☒ Heavy ☐ Light ☐ Intermittent

w0 & n0 AM w3 & n0 PM



April 12, 2012

To: Principal
Queenston Drive Public School
3520 Queenston Drive
Mississauga, ON

Re: Request for bussing – Queenston Drive Public School

Reference: TSC-0031-2012/ GC-0241-2012
TSC-0058-2012/ GC-0268-2012

Traffic Safety Council on March 28, 2012 considered the above captioned matters and recommended the following:

TSC-0031-2012

That the letter dated March 28, 2012, from Tom Howe, Manager, Student Transportation of Peel Region, with respect to bussing for students attending Queenston Drive Public School, 3520 Queenston Drive, be added to the March 28, 2012 Traffic Safety Council Agenda.

TSC-0058-2012

1. That the letter dated March 28, 2012 from Tom Howe, Manager, Student Transportation of Peel Region, with respect to bussing for students attending Queenston Drive Public School, 3520 Queenston Drive, be received.
2. That the Site Inspection subcommittee of Traffic Safety Council be requested to conduct a site inspection to review pedestrian safety at the intersection of Burnhamthorpe Road and Creditview Road/ Central Parkway and along the school walking route from the area of Burnhamthorpe Road and Creditview Road to Queenston Drive Public School for students attending Queenston Drive Public School, 3520 Queenston Drive.

April 12, 2012

Principal
Queenston Drive Public School

Page 2

These recommendations were approved at General Committee on April 4, 2012 and subsequently adopted at Council, on April 11, 2012.



Laura Wilson,
Legislative Coordinator
(905) 615-3200 ext. 5425

cc. B. Dechert, MP, Mississauga - Erindale (via email)
J. S. Gill, Controller, Facilities & Transportation, Peel District School Board
J. White, Trustee, Peel District School Board
A. Bate, Supervisor, Traffic Operations (via email)
S. Duffin, Crossing Guard Supervisor (via email)
J. McCann, Resident (via email)
E. Gallivan, Resident (via email)
Councillor R. Starr, Ward 6

Encl. Letter dated March 28, 2012, from Tom Howe, Manager, Student Transportation
of Peel Region

STUDENT TRANSPORTATION OF PEEL REGION STOPR

PEEL DISTRICT SCHOOL BOARD AND THE
DUFFERIN-PEEL CATHOLIC DISTRICT SCHOOL BOARD
Keaton Centre, 5685 Keaton Crescent, Mississauga, ON L5R 3H5

East: 905 890-6000

West: 905 890-0614

Special Education: 905 890-6362

800 668-1140

Fax: 905 890-6033

March 28, 2012

Mississauga Traffic Safety Council
City of Mississauga
300 City Centre Drive
Mississauga, ON L5B 3C1

Attention: Laura Wilson, Legislative Coordinator

Re: Bussing for Queenston Drive Public School
Reference: TSC-0001-2012/GC-0077-2012

Dear Laura,

Thank you for your correspondence of February 28, 2012 requesting that STOPR review Queenston Drive Public School bus routes to determine if any available seating exists for ineligible students.

We have reviewed all four buses serving this school. Three of the buses are at capacity and a number of Courtesy (ineligible) riders are already assigned to these buses. The fourth bus has some unused capacity but is not in the service demand area and cannot be rerouted.

Please advise should you require further information or clarification. Thank you for the continuing assistance provided by Mississauga Traffic Safety Council.

Sincerely,

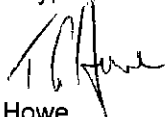

Tom Howe
Manager, STOPR

TH:km

cc D. Neale, Controller, Corporate Support Services, Peel District School Board
J. White, Trustee, Peel District School Board
R. Starr, Councillor, Ward 6

Site Inspection Report - Traffic Safety Council

4
15f

Observers Complete All Questions

File Number: RT.10. Queenston Drive Public School

Ward
6

Traffic Safety Council
NOV 23 2011

Observed By: D. Brown	S. Duffin	J. White
D. Yaunan	E. Lethbridge	D. Fryers
Date of Inspection: 2011 11 1	Inspection Time: 8:30 AM 3:30 PM	
Requested By: Resident	Prepared By:	Request For: Review Pedestrian Safety

Weather Conditions: ☒ Dry ☒ Sunny ☐ Rain ☐ Snow ☐ Other:

Site

School: Queenston Drive Public School	Address: 3520 Queenston Drive	School Times: 9:00 AM 3:30 PM Student Population: No. of School Buses:
School:	Address:	School Times: AM PM Student Population: No. of School Buses:
School:	Address:	School Times: AM PM Student Population: No. of School Buses:

Location: (Please identify the location with reference to nearest intersection. Indicate nearest school and address.)

Intersection of Burnhamthorpe Rd and Creditview Rd/ Central Pkwy AND pedestrian safety along walking route from Burnhamthorpe Rd & Creditview Rd. to Queenston Drive Public School

Type of Crossing: ☒ 4 Way Intersection ☐ 3 Way Intersection ☐ Midblock (i.e., not at Intersection)
Type of Control: ☒ Traffic Lights ☐ Yield Signs ☐ No Control
☐ Stop Signs (Traffic is stopped on one street only) ☐ All Way Stop (Traffic is stopped in all directions)

Part 1 Site Conditions

School Signs: ☐ School Area Signs ☐ School crossing Signs ☐ Parking/Stopping Prohibition

Posted Speed Limit: ☐ 40 km/hr ☐ 50 km/hr ☒ 60 km/hr ☐ Other km/hr

Visibility of Crossing Pedestrians: ☐ Poor ☐ Fair ☒ Good

Sight Obstructions: ☐ Hedges ☐ Trees ☐ Fences ☐ Bus Shelter
☐ Newspaper Boxes ☐ Other (Specify)

Road Grade: ☒ Flat ☐ Incline ☐ Decline

Road Geometrics: ☒ Straight ☐ Curved

Road Width: N/A ☐ Feet ☐ Metres Curb to Curb: ☐ Feet ☐ Metres Curb to Median: ☐ Feet ☐ Metres

Road Conditions: ☒ Dry ☐ Wet ☐ Snow Covered ☐ Ice

Sidewalks: ☐ Not Present ☒ North ☒ South ☒ East ☒ West

Proximity to School: ☐ In Front of ☒ Within 2000 ☐ Feet ☒ Metres

Route Survey: ☒ Shopping Area ☐ Construction ☐ Driveway ☐ Other (Specify)

Road Geometrics: ☒ Transit Bus Stop ☐ Underpass ☐ Parked Vehicles Within ☐ Feet ☐ Metres

4a 159 Warrant Survey

Check Appropriate Box For The Access Required

Location:

Intersection of Burnhamthorpe Rd and Creditview Rd/ Central Pkwy AND pedestrian safety along walking route from Burnhamthorpe Rd & Creditview Rd. to Queenston Drive Public School

SAFE GAP TIME (W/3.5+4) = SEC.

Morning Intervals

No.

Peds.: Time:

Gaps:

of Gaps

of Conflicts

Turning Traffic North Leg

8:20-8:25 //, //, //, //

8:25-8:30 //, //, //, //, //

8:30-8:35 //, //, //

8:35-8:40 //, //, //, //, //, //, //, //

8:40-8:45 //, //, //, //

8:45-8:50 //, //, //, //

8:50-8:55 //, //, //, //, //

Afternoon Intervals

No./

Peds.: Time:

Gaps:

3:30-3:35 //, //, //, //, //

3:35-3:40 //, //, //, //

3:40-3:45 //, //, //, //

3:45-3:50 //, //, //, //, //

3:50-3:55 //, //, //, //

3:55-4:00 //, //, //, //

Comments/Conflicts

No conflicts were observed. Traffic was courteous to crossing students. 25 grade 7 and 8 students live north of Burnhamthorpe Road are not able to be fully accommodated on courtesy bussing for the 2011-2012 school year. Parents are concerned with these students having to cross at the intersection of Burnhamthorpe Road and Creditview Road/ Central Parkway and with students using the route along Burnhamthorpe Road to the Creditwoodlands. There are no concerns with the physical conditions of the walking route from Burnhamthorpe Road and Creditview Road/ Central Parkway to The Creditwoodlands. The intersection of Burnhamthorpe Road and Creditview Road/ Central Parkway functions well, the crosswalks are clearly marked with Zebra Stripes, and there is a significant volume of adult pedestrians using the intersection.

Recommendations

Observations

A) Volume of Traffic: (See Intersection Plan)

B) Number of Crossing Pedestrians

☒ Heavy ☐ Light ☐ Intermittent

1 AM 4 PM

Warrant Survey

Check Appropriate Box For The Access Required

Location:

Intersection of Burnhamthorpe Rd and Creditview Rd/ Central Pkwy AND pedestrian safety along walking route from Burnhamthorpe Rd & Creditview Rd. to Queenston Drive Public School

SAFE GAP TIME (W/3.5+4) = SEC.

Morning Intervals

No.

Peds.: Time:

Gaps:

of Gaps

of Conflicts

Turning Traffic South Leg

8:20-8:25

8:25-8:30 // // // //, // // //, // // //, //

8:30-8:35 // // // //, // // //, //

8:35-8:40 // // //, // // //, // // //, //

1 8:40-8:45 // // //, // // //, // // //, // // //, //

8:45-8:50 // // //, // // //, // // //, //

8:50-8:55 // // //, // // //, //

8:55-9:00 // // //, // // //, // // //, //

Afternoon Intervals

No./

Peds.: Time:

Gaps:

3:30-3:35 // // //, //

3:35-3:40 // // //, // // //, //

3:40-3:45 // // //, // // //, //

3:45-3:50 // // //, // // //, //

3:50-3:55 // // //, // //

1 3:55-4:00 // // //, // // //, // // //, //

Comments/Conflicts

No conflicts were observed. Traffic was courteous to crossing students. 25 grade 7 and 8 students live north of Burnhamthorpe Road are not able to be fully accommodated on courtesy bussing for the 2011-2012 school year. Parents are concerned with these students having to cross at the intersection of Burnhamthorpe Road and Creditview Road/ Central Parkway and with students using the route along Burnhamthorpe Road to the Creditwoodlands. There are no concerns with the physical conditions of the walking route from Burnhamthorpe Road and Creditview Road/ Central Parkway to The Creditwoodlands. The intersection of Burnhamthorpe Road and Creditview Road/ Central Parkway functions well, the crosswalks are clearly marked with Zebra Stripes, and there is a significant volume of adult pedestrians using the intersection.

Recommendations

Observations

A) Volume of Traffic: (See Intersection Plan)

B) Number of Crossing Pedestrians

☒ Heavy ☐ Light ☐ Intermittent

1 AM 1 PM

4c 15i Warrant Survey

Check Appropriate Box For The Access Required

Location:

Intersection of Burnhamthorpe Rd and Creditview Rd/ Central Pkwy AND pedestrian safety along walking route from Burnhamthorpe Rd & Creditview Rd. to Queenston Drive Public School

SAFE GAP TIME (W/3.5+4) = SEC.

Morning Intervals

No.
Peds.: Time: Gaps:

of Gaps # of Conflicts

Turning Traffic East Leg

8:20-8:25
8:25-8:30
8:30-8:35
8:35-8:40
8:40-8:45
8:45-8:50
8:50-8:55
8:55-9:00

Afternoon Intervals

No./
Peds.: Time: Gaps:
3:30-3:35
3:35-3:40
3:40-3:45
3:45-3:50
3:50-3:55
1 3:55-4:00

Comments/Conflicts

No conflicts were observed. Traffic was courteous to crossing students. 25 grade 7 and 8 students live north of Burnhamthorpe Road are not able to be fully accommodated on courtesy bussing for the 2011-2012 school year. Parents are concerned with these students having to cross at the intersection of Burnhamthorpe Road and Creditview Road/ Central Parkway and with students using the route along Burnhamthorpe Road to the Creditwoodlands. There are no concerns with the physical conditions of the walking route from Burnhamthorpe Road and Creditview Road/ Central Parkway to The Creditwoodlands. The intersection of Burnhamthorpe Road and Creditview Road/ Central Parkway functions well, the crosswalks are clearly marked with Zebra Stripes, and there is a significant volume of adult pedestrians using the intersection.

Recommendations

Observations

A) Volume of Traffic: (See Intersection Plan)

B) Number of Crossing Pedestrians

☒ Heavy ☐ Light ☐ Intermittent

1 AM 1 PM

Warrant Survey

Check Appropriate Box For The Access Required

Location:

Intersection of Burnhamthorpe Rd and Creditview Rd/ Central Pkwy AND pedestrian safety along walking route from Burnhamthorpe Rd & Creditview Rd. to Queenston Drive Public School

SAFE GAP TIME (W/3.5+4) = SEC.

Morning Intervals

No.

Peds.: Time:

Gaps:

of Gaps

of Conflicts

Turning Traffic West Leg

8:20-8:25 //,///,///

8:25-8:30 //,///,///

8:30-8:35 //,///,///

8:35-8:40 //,///,///,///

8:40-8:45 //,///,///,///

8:45-8:50 //,///,///,///,///

8:50-8:55 //,///,///

8:55-9:00 //,///,///

Afternoon Intervals

No./

Peds.: Time:

Gaps:

1 3:30-3:35 //,///,///,///

3:35-3:40 //,///,///,///,///

3:40-3:45 //,///,///,///,///,///,///

3:45-3:50 //,///,///,///

3:50-3:55 //,///,///,///,///,///,///,///

3 3:55-4:00 //,///,///

Comments/Conflicts

No conflicts were observed. Traffic was courteous to crossing students. 25 grade 7 and 8 students live north of Burnhamthorpe Road are not able to be fully accommodated on courtesy bussing for the 2011-2012 school year. Parents are concerned with these students having to cross at the intersection of Burnhamthorpe Road and Creditview Road/ Central Parkway and with students using the route along Burnhamthorpe Road to the Creditwoodlands. There are no concerns with the physical conditions of the walking route from Burnhamthorpe Road and Creditview Road/ Central Parkway to The Creditwoodlands. The intersection of Burnhamthorpe Road and Creditview Road/ Central Parkway functions well, the crosswalks are clearly marked with Zebra Stripes, and there is a significant volume of adult pedestrians using the intersection.

Recommendations

Observations

A) Volume of Traffic: (See Intersection Plan)

B) Number of Crossing Pedestrians

☒ Heavy ☐ Light ☐ Intermittent

1 AM 4 PM

4e 15k TUES. NOV. 1 @ 8³⁰ AM \$ 3³⁰ PM

Laura Wilson

From: Sacha Smith on behalf of Traffic Safety
Sent: October 11, 2011 12:07 PM
To: Laura Wilson
Subject: FW: safety concern for students of Queenston Drive Public School
Attachments: letter re Riley on bus Sept 11.doc

Follow Up Flag: Follow up
Flag Status: Flagged

Categories: TSC

From: Jane McCann
Sent: October 7, 2011 11:43 AM
To: Traffic Safety
Subject: safety concern for students of Queenston Drive Public School

I am the mother of 2 children currently attending Queenston Drive Public School. My daughter, now in grade 7, no longer qualifies for the bus. The school usually follows a "fill up the bus" system and by this time usually the grade 7 and 8 students are accepted onto the bus. It sounds like this will not happen this year for approximately 15 students. I am very concerned about this as the route to school is not safe and crosses 2 very busy roads (Burnhamthorpe, Creditview). I have attached the letter I provided to the school several weeks ago which outlines my concerns. I am wondering if the traffic safety council can help investigate my concern. There are many other parents who are equally concerned and will be following up with the school, the Peel School Board, the police, local councilors, etc.

Looking forward to hearing from you,

Jane McCann

September 19, 2011

Mrs. Powell, Mrs. Gittings

This letter is to request permission that Riley McCann be allowed to take the bus to and from school this year. Although she is in grade 7 and no longer qualifies, I request that she take the bus to accompany her younger sister, Abigail in grade 3.

I have the following concerns with the bus policy:

- Siblings going to the same school should not be leaving the house and arriving home at different times. This is not safe. Siblings going to the same school should travel to and from the school together. They are taught to look out for each other.
- The route my children would take to school is not safe. They must cross Creditview and Burnhamthorpe; both are very busy roads with many traffic accidents.
- The route to school takes them along Burnhamthorpe Road which is very busy, and is not in a residential area. There is a lane for cars to pull over and wait to pick up people getting off the Go Trains and buses, which is another safety concern.
- The children in my neighbourhood are aware of a short cut which takes them across the train tracks where there is no crossing. These tracks are very busy as they are utilized by frequent morning and afternoon GO trains as well as other trains. While my children know not to take this short cut, many children do cross the tracks illegally in order to get to school on time and get home more quickly. This is a serious concern and should be taken into account for children living outside of the Queenston/Credit Woodlands area.
- The walk takes at least 30 minutes. Children these days are given a lot of homework forcing them to carry many books and text books back and forth. In the older grades students are also assigned musical instruments which they must carry to and from school.

I understand that children in grades 7 and 8 fall under a different bus policy, but this policy does not make sense for a K to 8 school. Also, conditions noted above should be taken into account so that exceptions can be made when there are considerable safety concerns. I will be following up with the Peel School Board and will copy you on the letter.

I would appreciate it if you could follow up with me as soon as Riley is able to take the bus. Please contact me at the number below.

Sincerely,

Jane McCann

4g 15m

Laura Wilson

From: Sacha Smith on behalf of Traffic Safety
Sent: October 17, 2011 10:22 AM
To: Laura Wilson
Subject: FW:

Follow Up Flag: Follow up
Flag Status: Flagged

Categories: TSC

—Original Message—

From: Edel Gallivan [mailto:edgallivan@cityofedmonton.ca]
Sent: October 15, 2011 9:13 AM
To: Traffic Safety
Subject: Review process

before we start a review process and waste your time -how far does an intersection have to be from a school?
are there a minimum number of kids that need to cross in order to qualify?

here is the scenario:

the school in the credit woodlands area-Queenston drive and kids in grade 7 and 8 that live in the Deer run area no longer qualify for bussing-the school and school board wants these kids to cross Burnamthorpe at Creditview not once but twice(going West on Burnamthorpe and south on Creditview/Central parkway) and then the same in reverse at the end of the day. There is only about 10 kids who do this-so would the city even consider 2 crossing guards for these few kids at said location?

I look forward to your reply.

Thank you ,

Edel Gallivan-concerned Mum.

15n 4h

RECEIVED

REGISTRY No.

DATE OCT 24 2011

FILE No.

CLERK'S DEPARTMENT

Traffic Safety Council

OCT 26 2011

October 24, 2011

TO: Mississauga Traffic Safety Council

RE: Safety concerns associated with Queenston Drive Public School

Members of MTSC:

Please be advised that I am concerned about the safety of the walk for many of the students attending Queenston Drive Public School and request an evaluation by MTSC.

STOPR has been contacted by a representative of parents in the school, and we are waiting for their assessment.

These students encounter several dangerous situations on their walk as follows:

- Crossing the intersection of Creditview and Burnhamthorpe
 - o 8 lanes of heavy traffic; no crossing guard
- Crossing the intersection of Creditview and Rathburn
 - o Entrance to Erindale GO Station
- In addition, these students are separated from their school by train tracks servicing both commercial and GO trains many times per day
- Walking route from Burnhamthorpe and Creditview to The Credit Woodlands involves passing a long stretch of uninhabited property
- Major and ongoing construction at the Erindale GO station, restricting the use of the north sidewalk
- This construction will open up a second entry point for GO traffic, meaning a continued and added safety concern

I would appreciate your review of this situation.

Thank you for your ongoing concern and consideration for the safety of all our students.

Sue Lawton
Sue Lawton, Trustee
Peel District School Board
Wards 3 and 4

Cc: Ron Starr, Councillor Ward 6
Jeff White, PDSB Trustee Ward 6
Rick Williams, PDSB Trustee Ward 5, MTSC Committee Member
Deborah Powell, Principal, Queenston Drive Public School
Sue Gittings, Vice Principal, Queenston Drive Public School
Jane McCann, Parent, Queenston Drive Public School
Dr. Sanja Pajovic, Parent, Queenston Drive Public School

4i 150

Have a great day ~

Marcy Macina

Operations Officer, East Area

Student Transportation of Peel Region

Peel District School Board / Dufferin-Peel Catholic District School Board



Tel: 905-890-6000 or 1-800-668-1140

www.stopr.ca

From: Sheelagh Duffin [mailto:Sheelagh.Duffin@mississauga.ca]

Sent: Thursday, October 13, 2011 4:32 PM

To: Macina, Marcy

Cc: Laura Wilson

Subject: Queenston Drive PS

Hi Marcy,

Traffic Safety is going to be scheduling a Site Inspection at Burnhamthorpe Road & Creditview and walking the route along Burnhamthorpe Road that the students who are not able to be accommodated by Courtesy bussing must take to access Queenston Drive PS.

Would you kindly provide the numbers and ages of the Queenston Drive PS students living north of Burnhamthorpe Road that are not able to be accommodated on the bus.

Thanks!

Sheelagh
5167

Sheelagh Duffin
Supervisor, Crossing Guards
City of Mississauga
3185 Mavis Road
Mississauga ON L5C 1T7
Phone 905 896-5167
Fax 905 896-5583
sheelagh.duffin@mississauga.ca

From: Macina, Marcy
Sent: October 14, 2011 12:31 PM
To: Sheelagh Duffin
Cc: Laura Wilson
Subject: RE: Queenston Drive PS

Hi Sheelagh,

There are a total of 25 walkers living North of Burnhamthorpe that currently walk - 15 in grade 7 and 10 in grade 8. Please let me know if you need further information.

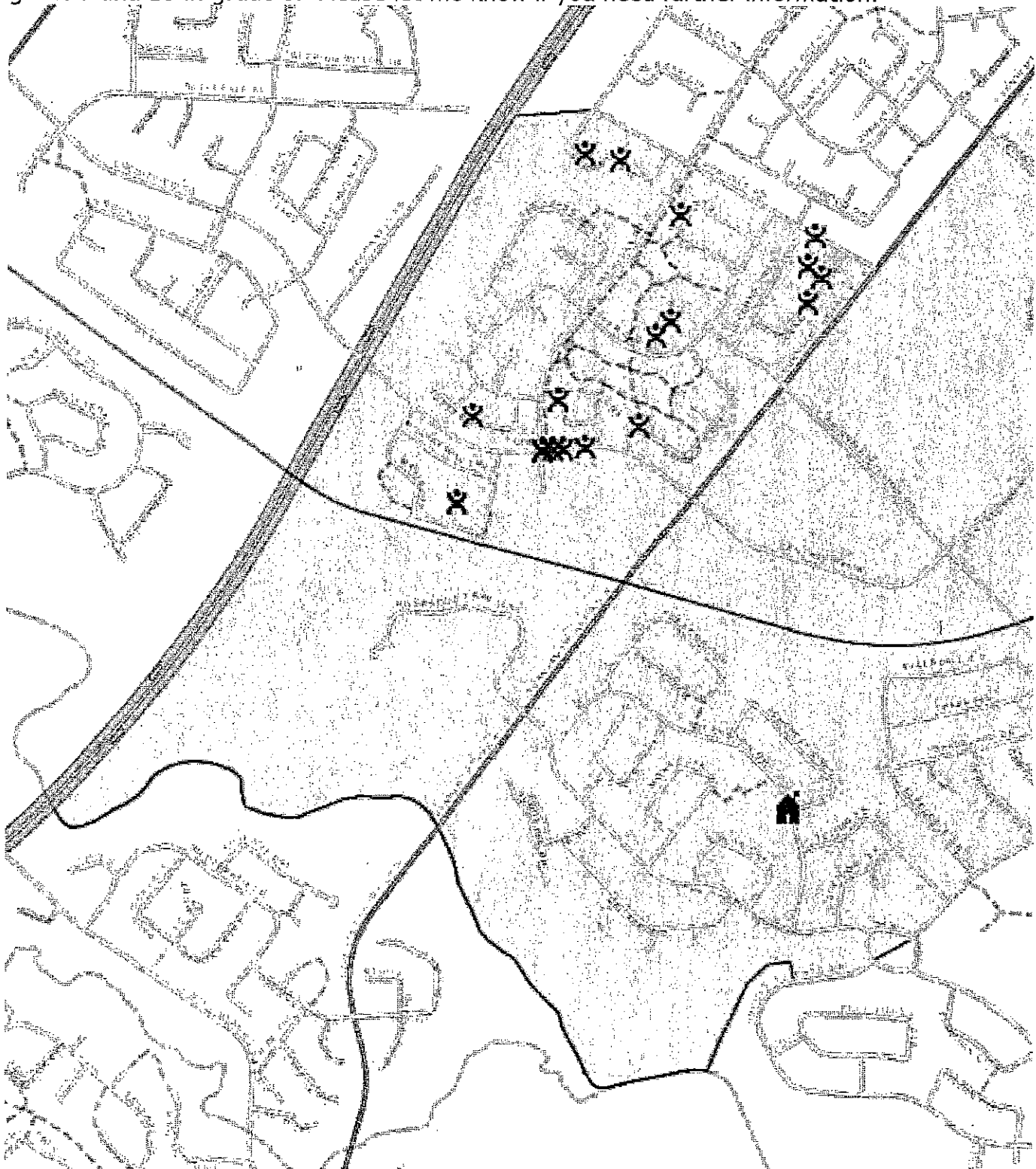

150 APRIL 18 @ 830 & 330
4K

BURNHAMTHORPE RD & CREDITVIEW RD.

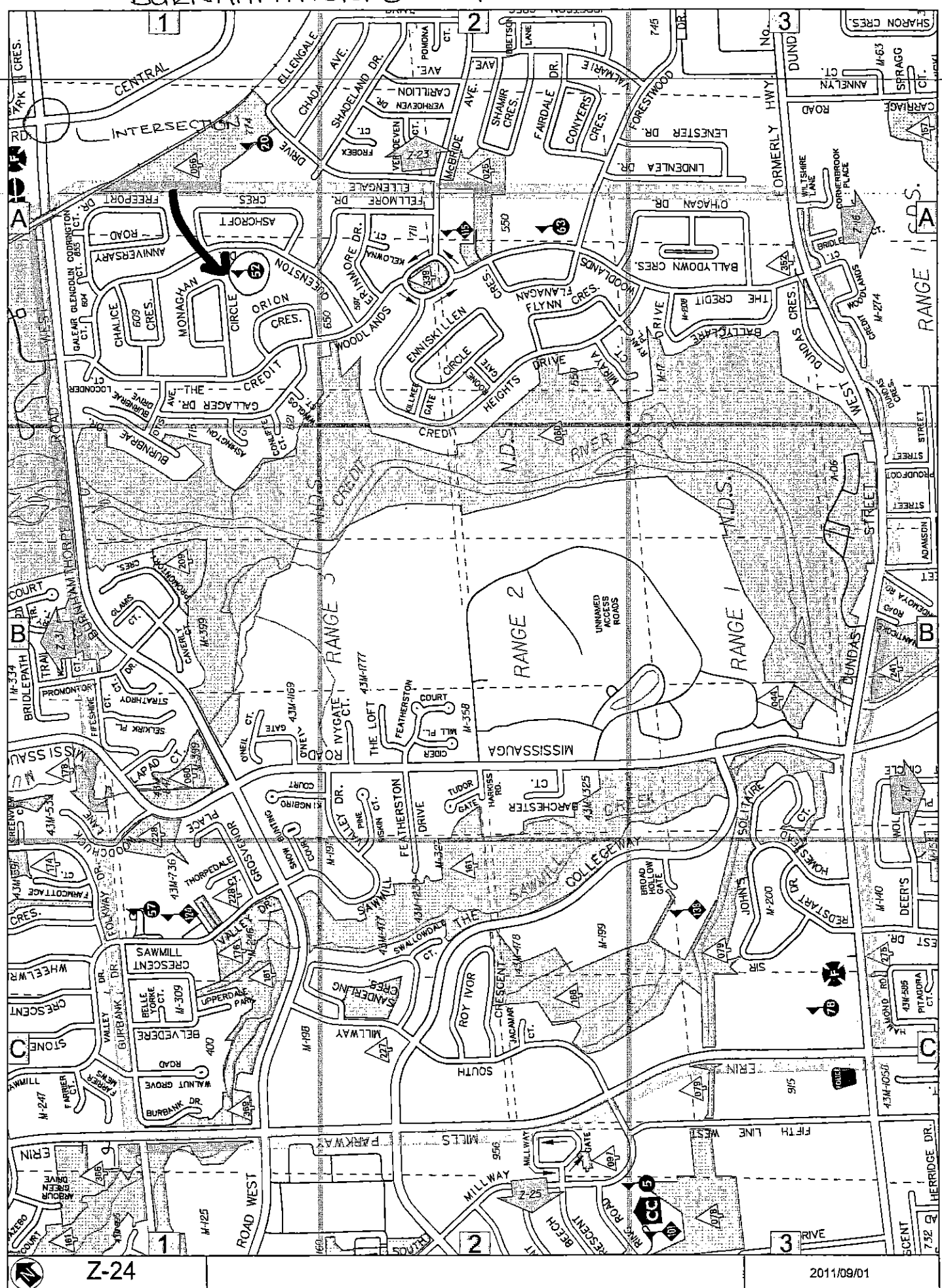

Site Inspection Report - Traffic Safety Council

Traffic Safety Committee

16

Observers Complete All Questions

File Number:

RT.10. Plum Tree Park

File Number:

RT.10.

Ward

9

APR 25 2012

Observed By:

Councillor P. Saito (AM)**Luisa Morrone (AM)****D. Fryers****S. Duffin & L. Goegan****D. Yaunan & B. Swedak (P.M)****D. Castronovo (AM) & D. Suess**

Date of Inspection:

2012 04 24

Inspection Time:

8:40 AM**3:40 PM**

Requested By:

Councillor Saito

Prepared By:

S. Duffin

Request For:

Assess Traffic CongestionWeather Conditions: ☒ Dry ☒ Sunny ☐ Rain ☐ Snow ☐ Other:**Site**

School:

Plum Tree Park

Address:

6855 Tenth Line W

School Times:

9:10**AM 3:40****PM**

Student Population:

710

No. of School Buses:

5

School:

Address:

School Times:

AM**PM**

Student Population:

No. of School Buses:

School:

Address:

School Times:

AM**PM**

Student Population:

No. of School Buses:

Location: (Please identify the location with reference to nearest intersection. Indicate nearest school and address.)

Plum Tree CrescentType of Crossing: ☐ 4 Way Intersection ☐ 3 Way Intersection ☐ Midblock (i.e., not at Intersection)Type of Control: ☐ Traffic Lights ☐ Yield Signs ☒ No Control☐ Stop Signs (Traffic is stopped on one street only) ☐ All Way Stop (Traffic is stopped in all directions)**Part 1 Site Conditions**

School Signs:

☐ School Area Signs☐ School crossing Signs☐ Parking/Stopping Prohibition

Posted Speed Limit:

☐ 40 km/hr☒ 50 km/hr☐ 60 km/hr☐ Other

km/hr

Visibility of Crossing Pedestrians: ☐ Poor☐ Fair☐ Good

Sight Obstructions:

☐ Hedges☐ Trees☐ Fences☐ Bus Shelter☐ Newspaper Boxes☐ Other (Specify)

Road Grade:

☐ Flat☐ Incline☐ Decline

Road Geometrics:

☐ Straight☒ Curved

Road Width:

☐ Feet☐ Metres

Curb to Curb:

☐ Feet☐ Metres

Curb to Median:

☐ Feet☐ Metres

Road Conditions:

☒ Dry☐ Wet☐ Snow Covered☐ Ice

Sidewalks:

☐ Not Present☐ North☐ South☒ East☒ West

Proximity to School:

☒ In Front of☐ Within☐ Feet ☐ Metres

Route Survey:

☐ Shopping Area☐ Construction☐ Driveway☐ Other (Specify)

Road Geometrics:

☐ Transit Bus Stop☐ Underpass☐ Parked Vehicles Within☐ Feet☐ Metres

169 Warrant Survey

Location:

Check Appropriate Box For The Access Required

Plum Tree Crescent

SAFE GAP TIME (W/3.5+4) = n/a SEC.

Morning Intervals

No.

Peds.: Time:

Gaps:

of Gaps

of Conflicts

OBSERVATION OF CONGESTION ON PLUM TREE CRES.

NO GAP STUDY REQUIRED

Afternoon Intervals

No./

Peds.: Time:

Gaps:

OBSERVATION OF CONGESTION ON PLUM TREE CRES.

NO GAP STUDY

Comments/Conflicts

Construction of new gym and Kiss and Ride Lanes to be completed for September 2012. Many parents drop off and pick up their children on Plum Tree Crescent at the back of the school in the A.M. and pick them up in the P.M. Parents are parking in No Stopping Zones and in front of private driveways. Signage was replaced incorrectly after construction on Plum Crescent. The school operates the Kiss and Ride in the A.M. but there is no Dismissal program in the P.M.

Recommendations

1. That the Transportation and Works Department be requested to review the signage along Plum Tree Crescent and remove the Emergency No Parking signs on the boulevard on the east side of Plum Tree Crescent. 2. That the School Zone Safety (Kiss and Ride) Subcommittee of Traffic Safety Council be requested to meet with Dave Marcotte, Supervisor, Preventative Maintenance, Peel District School Board at a Peel District School Board Maintenance meeting to review the School Zone Safety (Kiss and Ride) configuration at Plum Tree Park Public School, 6855 Tenth Line West. 3. That the Walk to School subcommittee of Traffic Safety Council be requested to work with Plum Tree Park Public School to implement the School Walking Routes Program at Plum Tree Park Public School. 4. That once signage is installed along Plum Tree Crescent, Parking Enforcement be requested to conduct a multi day blitz to enforce parking infractions along Plum Tree Crescent between 8:45 a.m. and 9:10 a.m. and 3:30 p.m. and 3:50 p.m.

Observations

A) Volume of Traffic: (See Intersection Plan)

B) Number of Crossing Pedestrians

☐ Heavy

☐ Light

☐ Intermittent

AM

PM

PLUM TREE CRES. APRIL 24 @
Laura Wilson 840 3 3:40

16b

From: Pat Saito
Sent: March 20, 2012 10:59 AM
To: Laura Wilson
Subject: ACTION: Plum Tree Crescent, ...

Good morning Laura,

Please bring the below issue to the Traffic Safety Council for review and action.

Ref:

"Is tired of parents dropping off their children who attend Plum Tree Public School using Plum Tree Crescent. Parents block driveways and a path leading to the school. This street should not be used to drop off students, parents are using Plum Tree Crescent and they should not be."

Luisa Morrone

Executive Assistant to
Councillor Patricia (Pat) Saito, Ward 9
300 City Centre Drive
Mississauga, Ontario L5B 3C1
Telephone: 905-896-5900
Fax: 905-896-5863

Sign up for the Ward9 e-Newsletter at www.ward9.ca
Check out Ward 9 events on [YouTube](#)
Follow Councillor Pat Saito on [Facebook](#)
Join the conversation on [Twitter](#)

"This e-mail may not be forwarded to anyone for any reason without express written permission of the author."

PLUM TREE CRES. APRIL 24 @ 840 & 340

PLUM TREE CRES. APRIL 24 @ 840 & 340

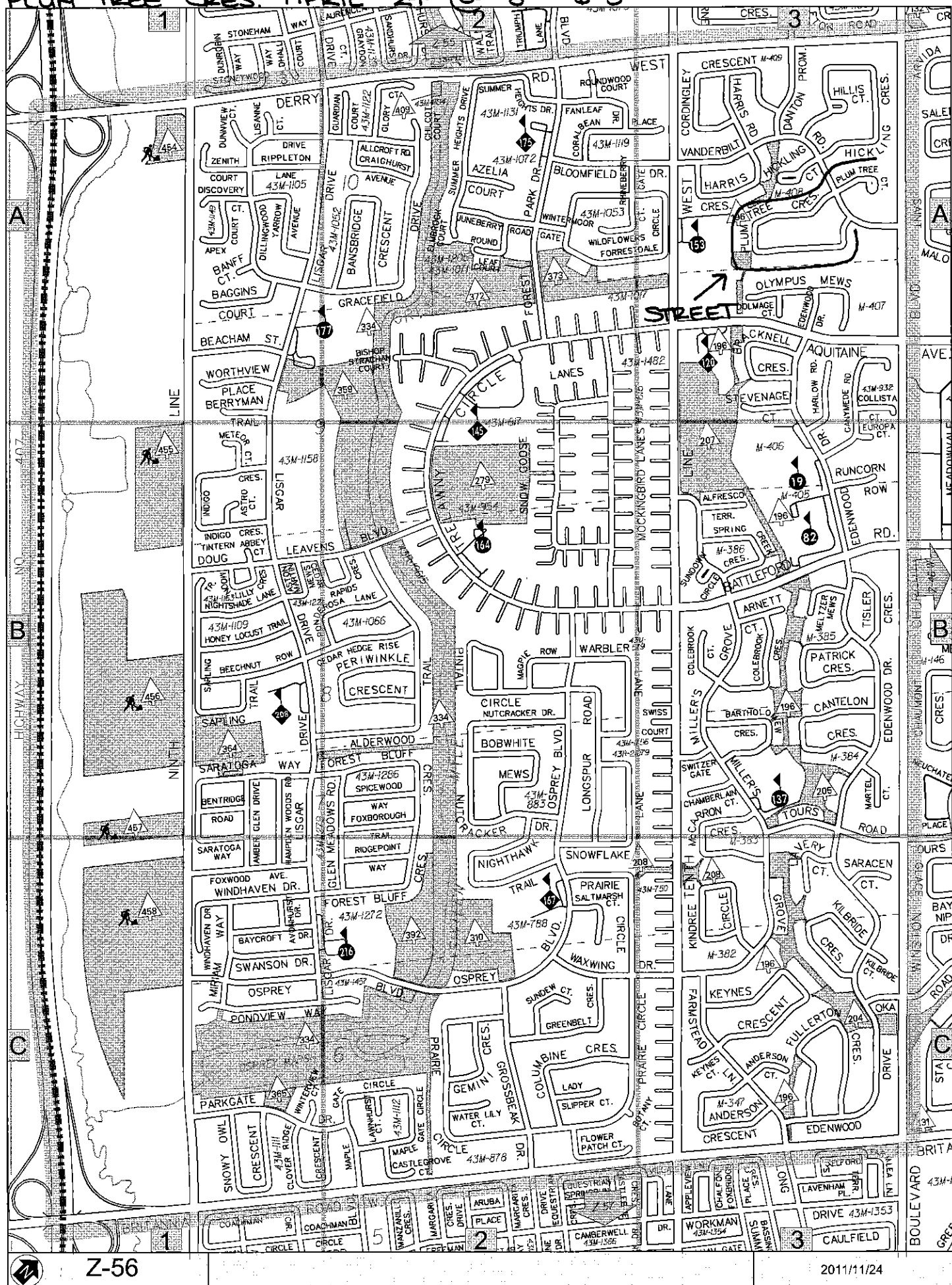

2011/11/24

Laura Wilson

17

From: Wigham, Kathryn [kathryn.wigham@peelsb.com]
Sent: April 23, 2012 10:42 AM
To: Laura Wilson
Cc: Wigham, Kathryn
Subject: Assessment for a Crossing Guard

Traffic Safety Committee

APR 25 2012

Hi Laura,

As I mentioned in our discussion, I have some concerns regarding the flow of the Kiss 'N Ride and the congestion at the front of the school at the beginning of the day and the end of the day. We recently had a child hit by a car and we request an assessment to determine whether the criteria are met to warrant a crossing guard. In addition, any feedback that could be provided in regards to Kiss N Ride and parking controls would be greatly appreciated.

Thank you in advance

Kathryn Wigham

Principal
Settler's Green P.S.
Phone 905-826-4947
Fax 905-826-9966

Memorandum



Traffic Safety Committee

APR 25 2012

TO: Chair and Members of Traffic Safety Council

FROM: Laura Wilson, Legislative Coordinator

DATE: April 19, 2012

SUBJECT: Expenditures for the Walk to School Subcommittee of Traffic Safety Council

Please be advised of the following expenditures of the Walk to School Subcommittee, spent in 2012 for the implementation of the School Walking Routes Program:

Promotional Items for School Walking Routes Baskets	\$ 291.62	
-Water Bottles (x100), Frisbees (x100), Tote Baskets (x29), Ribbon (x5), Gift Bags (x100)		
School Walking Routes Promotional Pencils	\$ 1,932.85	
-6900 pencils with artwork		
Frequent Walker Cards	\$ 215.00	
-4000		
Promotional Cardboard Busses	\$ 980.00	(approx.)
-7000 Mi Way Mississauga City Transit Cardboard Busses		
Total	\$ 3,419.47	(approx.)

Laura Wilson
Legislative Coordinator
(905) 615-3200 ext. 5425

APPROVED TRAFFIC SAFETY COUNCIL NON-DEPARTMENTAL BUDGET 2012
Resolution 0029-2012

Total Budget Allocated = \$84,000.00

<u>School Board/City Directories</u>	<u>Allocated</u>
City of Mississauga Street Guides (25 x \$6.00)	\$150.00
<u>Crossing Guards</u>	
Appreciation Day - June	\$2,000.00
Appreciation Dinner Gifts - December	\$1,300.00
Appreciation Dinner Awards - December	\$2,100.00
Promotional Items	\$2,000.00
<u>Kiss & Ride Program</u>	
Equipment (cones, stop signs, weights)	\$3,000.00
Safety Vests (orange & green)	\$2,000.00
Promotional items	\$1550.00
Volunteer Recognition – June (4 schools @ \$500/school)	\$2,000.00
<u>Walking to School Program</u>	
Walking School Routes Program Implementation	\$11,500.00
<u>Membership</u> – Ontario Traffic Council	\$300.00
<u>Conferences</u> - Ontario Traffic Conference 2012	\$5,700.00
<u>TSC Christmas Dinner</u>	
Appreciation Dinner/Meeting - December	\$2,000.00
Appreciation Gifts for TSC Members (35 x \$20.00)	\$700.00
<u>Printing/Creative Services</u> (pamphlets, brochures)	\$500.00
<u>TSC Promotional Items</u>	\$3,700.00
<u>Mileage</u>	\$8,500.00
<u>TOTAL</u>	<u>\$49,000.00</u>

***Please note: the following was allocated for a special project namely the Traffic Safety Council Instructional DVD and is not included in the regular Traffic Safety Council budget.*

*****TSC Instructional DVD** **\$35,000.00**

Total Including Instructional DVD allocation **\$84,000.00**

****Please note: that \$200.00 per year can be awarded by the Traffic Safety Council for the Dr. Arthur Wood Safety Award and \$2,075.00 in sympathy contributions is being held in reserve for this purpose.*

Laura Wilson

Subject: FW: Green T shirts

-----Original Message-----

From: Sheelagh Duffin
Sent: April 19, 2012 3:14 PM
To: Laura Wilson
Subject: Green T shirts

Traffic Safety Committee

APR 25 2012

Hi Laura,

I just picked up the last box of Adult X large T shirts (72 t shirts) and the second last box of Youth Large T shirts (48 per box) from Central Stores. We will need to order more before September.

Thanks.
Sheelagh
5167

Laura Wilson

From: Sheelagh Duffin
Sent: April 19, 2012 2:39 PM
To: Laura Wilson
Subject: We are a Walking School Signs
Attachments: Sheelagh Duffin.vcf; School Rout-WalkingSchool_05.pdf

Traffic Safety Committee

APR 25 2012

Hi Laura,

We have given out the last of the "We are a Walking School" signs to the new schools that we are launching the School Walking Routes program at this Spring.

Would you kindly have 40 signs printed and laminated as per the attached pdf. We receive requests throughout the year from the schools that are in the program for additional or replacement signs and, as well, we will hopefully be launching 2 new schools in the program in the fall so will require signs for them.

Thank you.

Sheelagh
5167

Sheelagh Duffin

City of Mississauga
Supervisor, Crossing Guards

(905) 896-5167 Fax 896-5583 Work
sheelagh.duffin@mississauga.ca

3185 Mavis Road
Mississauga ON L5C 1T7

May 2012 Site Inspection Calendar

Sun.	Mon.	Tue.	Wed.	Thu.	Fri.	Sat.
	1 8:00-8:30 & 3:00-3:30 Divine Mercy Catholic School (W9) Hazelton Place and Plantation Place Placement of Guard	2 8:30-9:00 & 3:30-4:00 Janet McDougald Public School (W1) Cawthra Road and Atwater Ave. Placement of Guard	3 8:40 – 9:10 & 3:40 – 4:10 Plum Tree Park Public School (W9) Plum Tree Cres. Review Traffic Congestion	4 PA Day – PDSB & DPCDSB Elementary & Peel District Secondary Schools	5	
6 7	8 8:45 – 9:15 & 3:45 – 4:15 St. Jerome Catholic School (W7) Paisley Blvd. West & Pollard Dr. Placement of Guard	9 8:30 – 9:00 & 3:30 – 4:00 Thorn Lodge Public School (W2) Thorn Lodge Drive (in front of school) Review Traffic Congestion	10	11	12	
13	14 15	16	17	18	19	
20	21 Victoria Day	22	23	24	25	26
27	28	29	30	31		

Traffic Safety Committee

APR 25 2012

TUES. MAY 1 @ HAZELTON PL. & PLANTATION PL @ 8-8³⁰ 219
Laura Wilson 3-3³⁰

Subject: FW: ACTION:: SR# 1833119 - RE: Action: Traffic Safety concerns intersection: Hazleton
PI and Plantation PL -
Attachments: Sheelagh Duffin.vcf

From: Sheelagh Duffin
Sent: April 13, 2012 2:56 PM
To: Zvonimir Miller; John Clarke
Cc: Laura Wilson
Subject: RE: ACTION:: SR# 1833119 - RE: Action: Traffic Safety concerns intersection: Hazleton PI and Plantation PL - ref. Hirsch

Hi Zvon,

By copy of this e-mail to Laura Wilson, Mississauga Traffic Safety Council Coordinator I am requesting that she schedule a Site Inspection at the intersection of Hazleton Place and Plantation Place for the students of Divine Mercy Catholic School. The Site Inspection and Gap study are the studies used by most municipalities in North America to determine crossing guard placement.

The times of the Site Inspection at Plantation Place and Hazleton Place for the students of Divine Mercy Catholic School would be 8:00 - 8:30 am and 3:00 - 3:30 pm.

Thank you.

Sheelagh



From: Zvonimir Miller
Sent: 13-Feb-12 8:51 AM
To: Pat Saito
Cc: John Clarke; Andy Bate; Kimberley Leslie; Yelena Adamopoulos; Al Sousa; Debbie Foley; Michelle Stefancic
Subject: FW: SR# 1833119 - RE: Action: Traffic Safety concerns intersection: Hazleton PI and Plantation PL - ref. Hirsch

Dear Councillor Saito,

Staff of the Transportation and Works Department have reviewed the residents request for a traffic control signal at the subject intersection and offer the following information.

In order to determine if the subject intersection warrants signalization, studies have been scheduled. Once we have received the study results and have reviewed them, we will update your office with the results.

The City of Mississauga uses technical warrants, as outlined by the Ministry of Transportation to determine whether traffic control signals would benefit the overall operation of an intersection.

21b

We trust that this information is satisfactory, however, if you require further information feel free to contact me directly.

Thanks,

Zvonimir J. Miller, C.E.T.
Traffic Signal Technologist, Traffic Signals & Systems
City of Mississauga
Transportation and Works Department
3185 Mavis Road
Mississauga, ON
L5C 1T7
905-615-3200 ext. 5976
Fax 905-896-5166
Email zvonimir.miller@mississauga.ca

From: Pat Saito
Sent: 2012/01/27 11:40 AM
To: Yelena Adamopoulos
Subject: Action: Traffic Safety concerns intersection: Hazleton PI and Plantation PL - ref.

Hello,
Please have staff investigate and provide a response to this office.
Your assistance is appreciated.

Ref.

RE: a stop light at the intersection of Hazleton PI and Plantation PL just behind St Aloysius Gonzaga High School North of Eglinton Ave. As I mentioned last night, since our local elementary school Blessed Trinity Catholic School on Credit Valley Road closed, our children now attend Divine Mercy Catholic Elementary on Duncairn Drive- North of Eglinton. As a result, my husband drives the children to school each morning and for the past two years he has also watched the high school children cross Hazleton PI. His shock at the dangerous situation these children are facing is horrifying; children dodging cars, cars not stopping or stopping midway in the intersection and blocking oncoming traffic. It is only a matter of time before something tragic occurs and I think we both know that by then it will be too late. Crossing a 2 lane roadway is difficult enough but 4 lanes is just dangerous and irresponsible.

A new subdivision is currently being built at the corner of Winston Churchill and Hazleton Place and over time this will increase the traffic flow to an even more dangerous level.

Could you please have someone look into the installation of a proper traffic light at this intersection. I'm not sure if one has been proposed as a result of the new subdivision but regardless of the timing for that, one is needed there today.

Thank you kindly,
Michelle
Administrative Assistant
Ward 9 Councillor Pat Saito

Patricia (Pat) Saito
Councillor Ward 9
City of Mississauga/Region of Peel
Tel: 905-896-5900
Fax: 905-896-5863
pat.saito@mississauga.ca

Sign up for the Ward9 e-Newsletter at www.ward9.ca

Site Inspection Report - Traffic Safety Council

21c

Observers

Complete All Questions

File Number:

RT.10. Divine Mercy Catholic School

File Number:

RT.10.

Ward

9

Observed By:

Date of Inspection:

2012 05 01

Inspection Time:

8:00 AM

3:00 PM

Requested By:

Ward Councillor

Prepared By:

Request For:

CrossingGuard

Weather Conditions: ☐ Dry ☐ Sunny ☐ Rain ☐ Snow ☐ Other:**Site**

School:

Divine Mercy Catholic School

Address:

2840 Duncairn Drive

School Times:

8:30

AM 3:00

PM

Student Population:

No. of School Buses:

School:

Address:

School Times:

AM

PM

Student Population:

No. of School Buses:

School:

Address:

School Times:

AM

PM

Student Population:

No. of School Buses:

Location: (Please identify the location with reference to nearest intersection. Indicate nearest school and address.)

Hazelton Place and Plantation PlaceType of Crossing: ☐ 4 Way Intersection ☐ 3 Way Intersection ☐ Midblock (i.e., not at Intersection)Type of Control: ☐ Traffic Lights ☐ Yield Signs ☐ No Control☐ Stop Signs (Traffic is stopped on one street only) ☐ All Way Stop (Traffic is stopped in all directions)**Part 1 Site Conditions**

School Signs:

☐ School Area Signs☐ School crossing Signs☐ Parking/Stopping Prohibition

Posted Speed Limit:

☐ 40 km/hr☐ 50 km/hr☐ 60 km/hr☐ Other

km/hr

Visibility of Crossing Pedestrians:

☐ Poor☐ Fair☐ Good

Sight Obstructions:

☐ Hedges☐ Trees☐ Fences☐ Bus Shelter☐ Newspaper Boxes☐ Other (Specify)

Road Grade:

☐ Flat☐ Incline☐ Decline

Road Geometrics:

☐ Straight☐ Curved

Road Width:

☐ Feet ☐ Metres

Curb to Curb:

☐ Feet ☐ Metres

Curb to Median:

☐ Feet ☐ Metres

Road Conditions:

☐ Dry☐ Wet☐ Snow Covered☐ Ice

Sidewalks:

☐ Not Present☐ North☐ South☐ East☐ West

Proximity to School:

☐ In Front of☐ Within☐ Feet ☐ Metres

Route Survey:

☐ Shopping Area☐ Construction☐ Driveway☐ Other (Specify)

Road Geometrics:

☐ Transit Bus Stop☐ Underpass☐ Parked Vehicles Within☐ Feet ☐ Metres

210

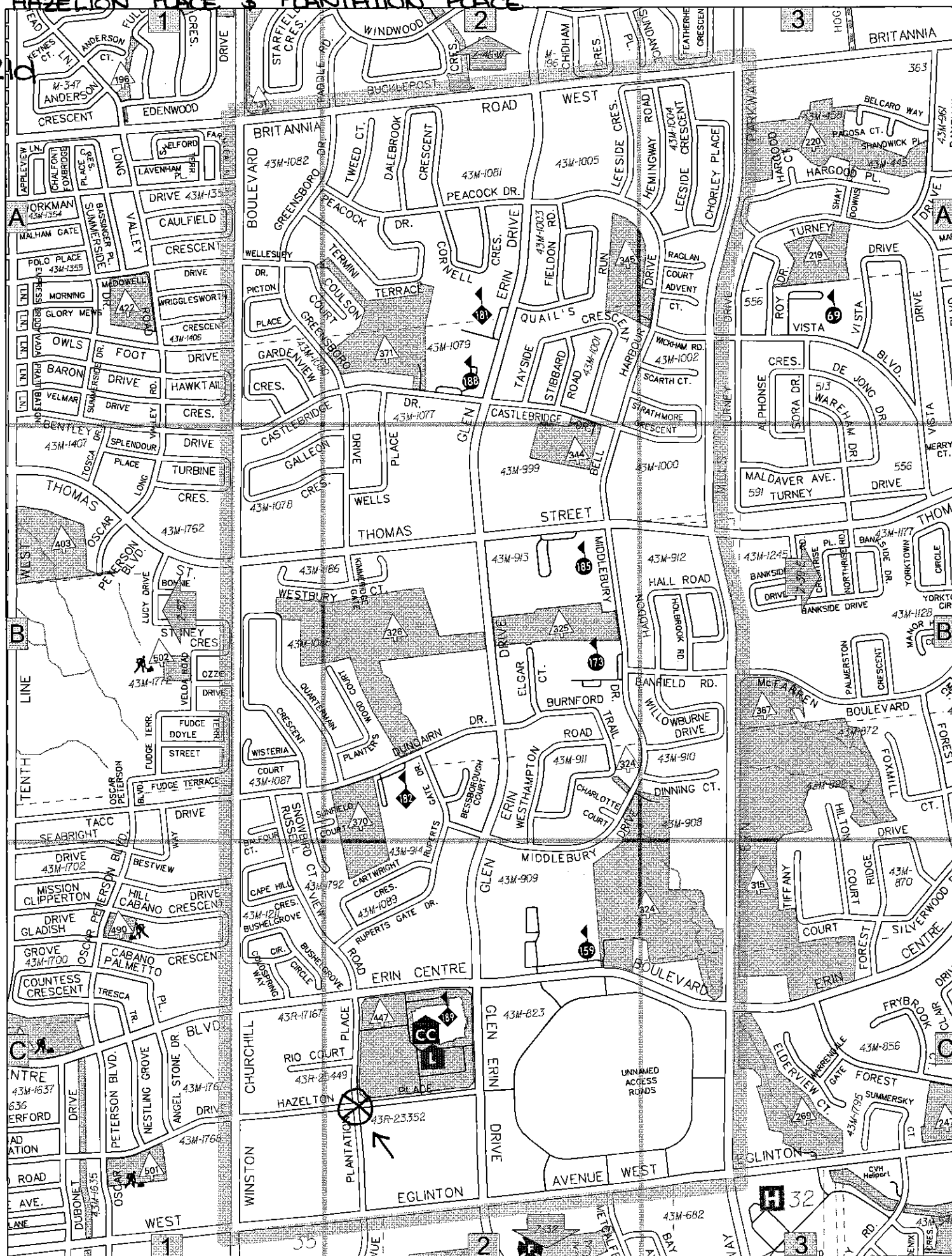

JANET. I. MCDUGALD P.S - MAY 3 @ 8³⁰-9⁰⁰ & 3³⁰-4⁰⁰
Laura Wilson @ CAWTHRA RD & ATWATER AVE

21e

Subject: FW: Transportation Eligibility reassessment Janet McDougald P.S.
Attachments: JANET MCDUGALD K TO 5 NUMBERS.png; Sheelagh Duffin.vcf; Sheelagh Duffin.vcf

-----Original Message-----

From: Sheelagh Duffin

Sent: April 18, 2012 4:45 PM

To: Laura Wilson

Subject: FW: Transportation Eligibility reassessment Janet McDougald P.S.

Hi Laura,

Would you kindly schedule a Site Inspection as soon as possible at the intersection of Cawthra Road and Atwater Avenue for the students of Janet McDougald Public School. The Site Inspection would be to determine if there is a warrant for a crossing guard based solely on traffic as students will not be crossing here until September 2012, the start of the new school year, when the new Janet McDougald Public School will be ready for students. The times for the inspection would be 8:30 - 9:00 am and 3:30 - 4:00 pm.

Thank you.

Sheelagh
Supervisor, Crossing Guards
City of Mississauga

21f Site Inspection Report - Traffic Safety Council

Observers

Complete All Questions

File Number:

RT.10. Janet I. McDougald Public

File Number:

RT.10.

Ward

1

Observed By:

Date of Inspection:

2012 05 03

Inspection Time:

8:30 AM

3:30 PM

Requested By:

Crossing Guard Supervisor

Prepared By:

Request For:

Placement of Crossing Guard

Weather Conditions: ☐ Dry ☐ Sunny ☐ Rain ☐ Snow ☐ Other:

Site

School:

Janet I. McDougald Public School

Address:

1500 Ogden Avenue

School Times: 9:00 AM 3:30 PM

Student Population:

No. of School Buses:

School:

Address:

School Times: AM PM

Student Population:

No. of School Buses:

School:

Address:

School Times: AM PM

Student Population:

No. of School Buses:

Location: (Please identify the location with reference to nearest intersection. Indicate nearest school and address.)

CAWTHRA RD. / ATWATER AVE.

Type of Crossing: ☐ 4 Way Intersection ☐ 3 Way Intersection ☐ Midblock (i.e., not at Intersection)

Type of Control: ☐ Traffic Lights ☐ Yield Signs ☐ No Control

☐ Stop Signs (Traffic is stopped on one street only) ☐ All Way Stop (Traffic is stopped in all directions)

Part 1 Site Conditions

School Signs:

☐ School Area Signs

☐ School crossing Signs

☐ Parking/Stopping Prohibition

Posted Speed Limit:

☐ 40 km/hr

☐ 50 km/hr

☐ 60 km/hr

☐ Other

km/hr

Visibility of Crossing Pedestrians: ☐ Poor

☐ Fair

☐ Good

Sight Obstructions:

☐ Hedges

☐ Trees

☐ Fences

☐ Bus Shelter

☐ Newspaper Boxes

☐ Other (Specify)

Road Grade:

☐ Flat

☐ Incline

☐ Decline

Road Geometrics:

☐ Straight

☐ Curved

Road Width:

☐ Feet

☐ Metres

Curb to Curb:

☐ Feet

☐ Metres

Curb to Median:

☐ Feet

☐ Metres

Road Conditions:

☐ Dry

☐ Wet

☐ Snow Covered

☐ Ice

Sidewalks:

☐ Not Present

☐ North

☐ South

☐ East

☐ West

Proximity to School:

☐ In Front of

☐ Within

☐ Feet ☐ Metres

Route Survey:

☐ Shopping Area

☐ Construction

☐ Driveway

☐ Other (Specify)

Road Geometrics:

☐ Transit Bus Stop

☐ Underpass

☐ Parked Vehicles Within

☐ Feet

☐ Metres

JANET MCDOUGALD PS
East of Cawthra Rd

Purple - walkers

K - 3 = 50

4 - 5 = 26

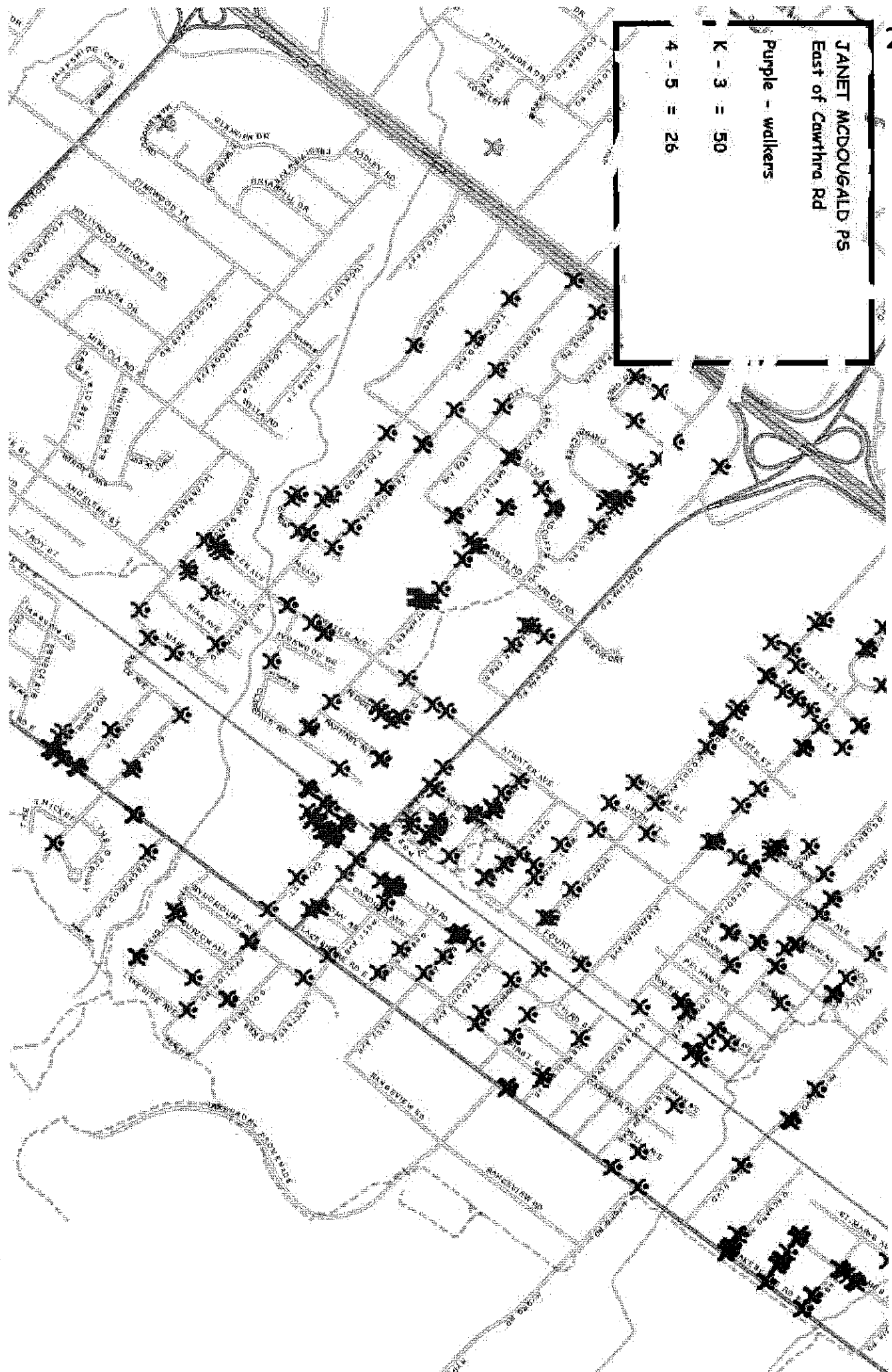

21h

Corporate Services Department
Legislative Services Division
Office of the City Clerk

City of Mississauga
300 City Centre Drive
MISSISSAUGA ON L5B 3C1



Leading today for tomorrow

FAX: 905-615-4181
www.mississauga.ca

November 26, 2010

Principal
Hartsdale Avenue Public School
1500 Ogden Avenue
Mississauga, ON

Re: Removal of Crossing Guard – Hartsdale Avenue Public School (Ward 1)
Reference: TSC-0241-2010/ Resolution 0274-2010
File: RT.10.Hartsdale (W1)

Traffic Safety Council on November 17, 2010, considered the above captioned matter and recommended the following:

TSC-0241-2010

That the crossing guard at the intersection of Cawthra Road and Atwater Avenue for the students attending Hartsdale Avenue Public School, 1500 Ogden Avenue be removed as of December 20, 2010, as the warrants are no longer met and no students in kindergarten up to grades 5 cross at this intersection.

This recommendation was adopted by City Council on November 24, 2010.

A handwritten signature in black ink, appearing to read "S. Smith".

Sacha Smith
Legislative Coordinator
(905) 615-3200 ext. 4516

cc: Mr. J. S. Gill Controller, Facilities & Transport, Peel District School Board
Ms. J. McDougald, Trustee, Peel District School Board
Mr. A. Bate, Supervisor, Traffic Operations (via email)
Ms. S. Duffin, Crossing Guard Supervisor (via email)
Councillor C. Corbasson, Ward 1

Site Inspection Report - Traffic Safety Council

211

7

Observers

Complete All Questions

File Number:

File Number:

Ward

RT.10. Hartsdale Public School

RT.10.

Observed By:

S. Duffin

D. Castronova

Traffic Safety Council

P. Westbrook

NOV 17 2010

Date of Inspection:

2010 09 13

Inspection Time:

8:25 AM

3:30 PM

Requested By:

TSC

Prepared By:

S. Duffin/P. Westbrook

Request For:

Remove a crossing guard

Weather Conditions: ☒ Dry ☐ Sunny ☐ Rain ☐ Snow ☐ Other:

Site

School:

Hartsdale Public School

Address:

1500 Ogden Avenue

School Times: 9:00 AM 3:30 PM

Student Population:

No. of School Buses:

School:

Address:

School Times: AM PM

Student Population:

No. of School Buses:

School:

Address:

School Times: AM PM

Student Population:

No. of School Buses:

Location: (Please identify the location with reference to nearest intersection. Indicate nearest school and address.)

CAWTHRA RD. / ATWATER AVE.

Type of Crossing: ☒ 4 Way Intersection ☐ 3 Way Intersection ☐ Midblock (i.e., not at Intersection)

Type of Control: ☒ Traffic Lights ☐ Yield Signs ☐ No Control

☐ Stop Signs (Traffic is stopped on one street only) ☐ All Way Stop (Traffic is stopped in all directions)

Part 1 Site Conditions

School Signs:

☐ School Area Signs

☐ School crossing Signs

☐ Parking/Stopping Prohibition

Posted Speed Limit:

☐ 40 km/hr

☐ 50 km/hr

☐ 60 km/hr

☐ Other

km/hr

Visibility of Crossing Pedestrians:

☐ Poor

☐ Fair

☒ Good

Sight Obstructions:

☐ Hedges

☐ Trees

☐ Fences

☐ Bus Shelter

☐ Newspaper Boxes

☐ Other (Specify)

Road Grade:

☒ Flat

☐ Incline

☐ Decline

Road Geometrics:

☒ Straight

☐ Curved

Road Width:

☐ Feet

☐ Metres

Curb to Curb:

☐ Feet

☐ Metres

Curb to Median:

☐ Feet

☐ Metres

Road Conditions:

☐ Dry

☒ Wet

☐ Snow Covered

☐ Ice

Sidewalks:

☐ Not Present

☒ North

☒ South

☒ East

☒ West

Proximity to School:

☐ In Front of

☐ Within

☐ Feet ☐ Metres

Route Survey:

☐ Shopping Area

☐ Construction

☐ Driveway

☐ Other (Specify)

Road Geometrics:

☐ Transit Bus Stop

☐ Underpass

☐ Parked Vehicles Within

☐ Feet

☐ Metres

7a) 21j
Warrant Survey

Location:

Check Appropriate Box For The Access Required

CAWTHRA RD. / ATWATER AVE.

SAFE GAP TIME (W/3.5+4) = **n/a** SEC.

Morning Intervals

No.
 Peds.: Time: Gaps:

		# of Gaps	# of Conflicts
8:20-8:25	TURNING TRAFFIC ONLY		
8:25-8:30			
8:30-8:35			
8:35-8:40			
8:40-8:45			
8:45-8:50			
8:50-8:55			
8:55-9:00			

Afternoon Intervals

No./
 Peds.: Time: Gaps:

3:30-3:35	
3:35-3:40	
3:40-3:45	
3:45-3:50	
3:50-3:55	
3:55-4:00	

Comments/Conflicts

High school students crossing here or mid-block.

Recommendations

See Oct. 19th inspection for recommendations

Observations

A) Volume of Traffic: (See Intersection Plan)

B) Number of Crossing Pedestrians

☐ Heavy ☐ Light ☒ Intermittent

0 AM 0 PM

Site Inspection Report - Traffic Safety Council

7b)
21K

Observers

Complete All Questions

File Number:

RT.10. Hartsdale Public School

File Number:

RT.10.

Ward

1

Observed By:

S. Duffin

D. Yaunan

P. Westbrook

E. Lethbridge

Date of Inspection:

2010 09 29

Inspection Time:

8:25 AM

3:30 PM

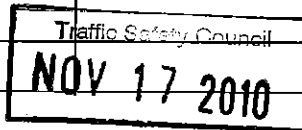

Requested By:

TSC

Prepared By:

S. Duffin

Request For:

Remove a crossing guard

Weather Conditions: ☒ Dry ☐ Sunny ☐ Rain ☐ Snow ☐ Other:

Site

School:

Hartsdale Public School

Address:

1500 Ogden Avenue

School Times:

9:00

AM 3:30

PM

Student Population:

No. of School Buses:

School:

Address:

School Times:

AM

PM

Student Population:

No. of School Buses:

School:

Address:

School Times:

AM

PM

Student Population:

No. of School Buses:

Location: (Please identify the location with reference to nearest intersection. Indicate nearest school and address.)

CAWTHRA RD. / ATWATER AVE.

Type of Crossing: ☒ 4 Way Intersection ☐ 3 Way Intersection ☐ Midblock (i.e., not at Intersection)

Type of Control: ☒ Traffic Lights ☐ Yield Signs ☐ No Control

☐ Stop Signs (Traffic is stopped on one street only) ☐ All Way Stop (Traffic is stopped in all directions)

Part 1 Site Conditions

School Signs:

☐ School Area Signs

☐ School crossing Signs

☐ Parking/Stopping Prohibition

Posted Speed Limit:

☐ 40 km/hr

☐ 50 km/hr

☐ 60 km/hr

☐ Other

km/hr

Visibility of Crossing Pedestrians: ☐ Poor

☐ Fair

☒ Good

Sight Obstructions:

☐ Hedges

☐ Trees

☐ Fences

☐ Bus Shelter

☐ Newspaper Boxes

☐ Other (Specify)

Road Grade:

☒ Flat

☐ Incline

☐ Decline

Road Geometrics:

☒ Straight

☐ Curved

Road Width:

☐ Feet

☐ Metres

Curb to Curb:

☐ Feet

☐ Metres

Curb-to Median:

☐ Feet

☐ Metres

Road Conditions:

☒ Dry ☐ Wet

☐ Snow Covered

☐ Ice

Sidewalks:

☐ Not Present

☒ North

☒ South

☒ East

☒ West

Proximity to School:

☐ In Front of

☐ Within

☐ Feet ☐ Metres

Route Survey:

☐ Shopping Area

☐ Construction

☐ Driveway

☐ Other (Specify)

Road Geometrics:

☐ Transit Bus Stop

☐ Underpass

☐ Parked Vehicles Within

☐ Feet

☐ Metres

70) 211

Warrant Survey

Check Appropriate Box For The Access Required

Location:

CAWTHRA RD. / ATWATER AVE.

SAFE GAP TIME (W/3.5+4) = n/a SEC.

Morning Intervals

No.
Peds.: Time: Gaps:

		# of Gaps	# of Conflicts
8:20-8:25	TURNING TRAFFIC		
8:25-8:30			
8:30-8:35			
8:35-8:40			
8:40-8:45			
8:45-8:50			
8:50-8:55			
8:55-9:00			

Afternoon Intervals

No./
Peds.: Time: Gaps:

3:30-3:35	
3:35-3:40	
3:40-3:45	
3:45-3:50	
3:50-3:55	
1 3:55-4:00	

Comments/Conflicts

Recommendations

See Oct. 19th inspection for recommendations

Observations

A) Volume of Traffic: (See Intersection Plan) B) Number of Crossing Pedestrians

☐ Heavy ☐ Light ☒ Intermittent 0 AM 1 PM

Site Inspection Report - Traffic Safety Council

21m

7d)

Observers

Complete All Questions

File Number:

RT.10. Hartsdale Public School

File Number:

RT.10.

Ward

1

Observed By:

S. Duffin

D. Castronova

Traffic Safety Council

P. Westbrook

E. Lethbridge

NOV 17 2010

Date of Inspection:

2010 10 19

Inspection Time:

8:25 AM

3:30 PM

Requested By:

TSC

Prepared By:

P. Westbrook

Request For:

Remove a crossing guard

Weather Conditions: ☒ Dry ☐ Sunny ☐ Rain ☐ Snow ☐ Other:

Site

School:

Hartsdale Public School

Address:

1500 Ogden Avenue

School Times:

9:00

AM 3:30

PM

Student Population:

No. of School Buses:

School:

Address:

School Times:

AM

PM

Student Population:

No. of School Buses:

School:

Address:

School Times:

AM

PM

Student Population:

No. of School Buses:

Location: (Please identify the location with reference to nearest intersection. Indicate nearest school and address.)

CAWTHRA RD. / ATWATER AVE.

Type of Crossing: ☒ 4 Way Intersection ☐ 3 Way Intersection ☐ Midblock (i.e., not at Intersection)

Type of Control: ☒ Traffic Lights ☐ Yield Signs ☐ No Control

☐ Stop Signs (Traffic is stopped on one street only) ☐ All Way Stop (Traffic is stopped in all directions)

Part 1 Site Conditions

School Signs:

☐ School Area Signs

☐ School crossing Signs

☐ Parking/Stopping Prohibition

Posted Speed Limit:

☐ 40 km/hr

☐ 50 km/hr

☐ 60 km/hr

☐ Other

km/hr

Visibility of Crossing Pedestrians: ☐ Poor

☐ Fair

☒ Good

Sight Obstructions:

☐ Hedges

☐ Trees

☐ Fences

☐ Bus Shelter

☐ Newspaper Boxes

☐ Other (Specify)

Road Grade:

☒ Flat

☐ Incline

☐ Decline

Road Geometrics:

☒ Straight

☐ Curved

Road Width:

☐ Feet

☐ Metres

Curb to Curb:

☐ Feet

☐ Metres

Curb to Median:

☐ Feet

☐ Metres

Road Conditions:

☒ Dry ☐ Wet

☐ Snow Covered

☐ Ice

Sidewalks:

☐ Not Present

☒ North

☒ South

☒ East

☒ West

Proximity to School:

☐ In Front of

☐ Within

☐ Feet ☐ Metres

Route Survey:

☐ Shopping Area

☐ Construction

☐ Driveway

☐ Other (Specify)

Road Geometrics:

☐ Transit Bus Stop

☐ Underpass

☐ Parked Vehicles Within

☐ Feet

☐ Metres

7e) 21n
Warrant Survey

Location:

Check Appropriate Box For The Access Required

CAWTHRA RD. / ATWATER AVE.

SAFE GAP TIME (W/3.5+4) = n/a SEC.

Morning Intervals

No.
 Peds.: Time: Gaps:

		# of Gaps	# of Conflicts
8:20-8:25			
8:25-8:30			
8:30-8:35			
8:35-8:40			
8:40-8:45			
8:45-8:50			
8:50-8:55			
8:55-9:00			

Afternoon Intervals

No./
 Peds.: Time: Gaps:

3:25-3:30	
3:30-3:35	
3:35-3:40	
3:40-3:45	
3:45-3:50	
3:50-3:55	
1 3:55-4:00	

Comments/Conflicts

Recommendations

That the crossing guard at the intersection of Cawthra Road and Atwater Avenue for the students attending Hartsdale Public School, 1500 Ogden Avenue be removed as of December 20, 2010, as the warrants are no longer met and no students in kindergarten up to grades 5 cross at this intersection.

Observations

A) Volume of Traffic: (See Intersection Plan)

B) Number of Crossing Pedestrians

☐ Heavy ☐ Light ☒ Intermittent

0 AM 0 PM



May 14, 2010

Principal
Lynwood Public School
498 Hartsdale Ave.
Mississauga, ON

Principal
Neil C. Matheson Public School
1500 Ogden Ave.
Mississauga, ON

Re: Crossing Guard Location Changes- Byngmount Beach Public School/ Principal
Lynwood Public School/ Neil C. Matheson Public School (Ward 1)
Reference: TSC-0116-2010/ GC-0363-2010
TSC-0118-2010/ GC-0365-2010
File: RT.10.Byngmount Beach/RT.10.Lyndwood/RT.10.Neil C. Matheson (W1)

Traffic Safety Council on April 28, 2010, considered the above captioned matters and recommended the following:

TSC-0116-2010

That the email correspondence dated April 15, 2010 from Sheelagh Duffin, Crossing Guard Supervisor regarding school closures of Byngmount Beach Public School and Lyndwood Public School, which will affect the current crossing guard locations be received.

TSC-0118-2010

1. That a crossing guard be implemented at the intersection of Cawthra Road and Atwater Avenue in September 2010 as the warrants have been met due to the school boundary change that would require Lynwood Public School, 498 Hartsdale Avenue students to attend Neil C. Matheson Public School, 1500 Ogden Avenue, while Lynwood Public School is under construction.
2. That the Site Inspection Subcommittee of Traffic Safety Council be requested to re-inspect the intersection of Cawthra Road and Atwater Avenue during the second and fourth weeks of September 2010, and the third week of October 2010, to determine if the warrants for a crossing guard are still being met,

.../2

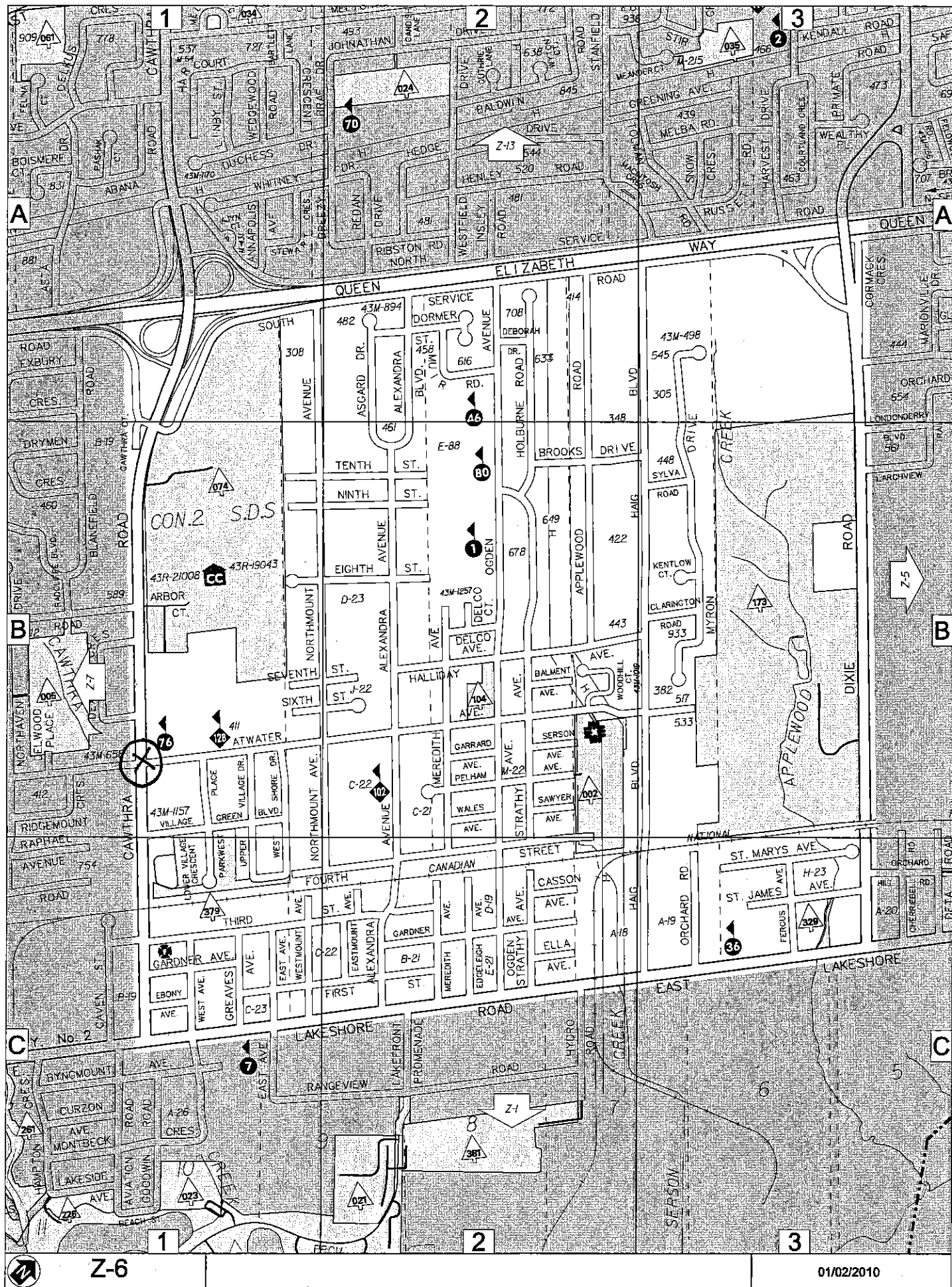



ST. JEROME CATHOLIC SCHOOL @
PAISLEY BLVD. WEST & POLLARD DR
MAY 8



845 & 345 Leading today for tomorrow

December 15, 2011

To: Principal
St. Jerome Catholic School
790 Paisley Boulevard West
Mississauga, ON

Re: Request for Crossing Guard
Reference: TSC-0216-2011/GC-0828-2011

Traffic Safety Council on November 23, 2011, considered the above captioned matter and recommended the following:

TSC-0216-2011

1. That the request for a Crossing Guard at the intersection of Paisley Boulevard West and Pollard Drive, for students attending St. Jerome Catholic School, 790 Paisley Boulevard West be denied as the warrants have not been met and that the Site Inspection Subcommittee of Traffic Safety Council be requested to re-inspect this location in April 2012.
2. That the Dufferin- Peel Catholic District School Board be requested to review the feasibility of installing a No Left Turn sign at the exit driveway of St. Jerome Catholic School.

This recommendation was approved at General Committee on December 7, 2011 and subsequently adopted at Council, on December 14, 2011.

Laura Wilson
Legislative Coordinator
(905) 615-3200 ext. 4525

cc: B. Bjarnason, Manager of Planning, Dufferin-Peel Catholic School Board
D. Lucas, Projects Coordinator, Dufferin-Peel Catholic School Board
B. Iannicca, Trustee, Dufferin-Peel District Catholic School Board
S. Duffin, Crossing Guard Supervisor (via email)
Councillor N. Iannicca, Ward 7

Site Inspection Report - Traffic Safety Council

215

Observers

Complete All Questions

File Number:

RT.10. St. Jerome Catholic School

File Number:

RT.10.

Ward

7

Observed By:

Date of Inspection:

2012 05 08

Inspection Time:

8:45 AM

3:45 PM

Requested By:

Crossing Guard Supervisor

Prepared By:

Request For:

Place a crossing guard

Weather Conditions: ☒ Dry ☐ Sunny ☐ Rain ☐ Snow ☐ Other:**Site**

School:

St. Jerome Catholic School

Address:

790 Paisley Blvd.

School Times:

9:15

AM 3:45

PM

Student Population:

No. of School Buses:

School:

Address:

School Times:

AM

PM

Student Population:

No. of School Buses:

School:

Address:

School Times:

AM

PM

Student Population:

No. of School Buses:

Location: (Please identify the location with reference to nearest intersection. Indicate nearest school and address.)

Paisley Blvd. W. & Pollard Drive

Type of Crossing: ☐ 4 Way Intersection ☒ 3 Way Intersection ☐ Midblock (i.e., not at Intersection)Type of Control: ☐ Traffic Lights ☐ Yield Signs ☐ No Control☒ Stop Signs (Traffic is stopped on one street only) ☐ All Way Stop (Traffic is stopped in all directions)**Part 1 Site Conditions**

School Signs:

☒ School Area Signs☐ School crossing Signs☐ Parking/Stopping Prohibition

Posted Speed Limit:

☒ 40 km/hr☐ 50 km/hr☐ 60 km/hr☐ Other

km/hr

Visibility of Crossing Pedestrians:

☐ Poor☐ Fair☒ Good

Sight Obstructions:

☐ Hedges☐ Trees☐ Fences☐ Bus Shelter☐ Newspaper Boxes☐ Other (Specify)

Road Grade:

☒ Flat☐ Incline☐ Decline

Road Geometrics:

☐ Straight☒ Curved

Road Width:

☐ Feet☐ Metres

Curb to Curb:

☐ Feet☐ Metres

Curb to Median:

☐ Feet☐ Metres

Road Conditions:

☒ Dry☐ Wet☐ Snow Covered☐ Ice

Sidewalks:

☐ Not Present☒ North☒ South☐ East☐ West

Proximity to School:

☐ In Front of☐ Within☐ Feet ☐ Metres

Route Survey:

☐ Shopping Area☐ Construction☐ Driveway☒ Other (Specify)

Road Geometrics:

☐ Transit Bus Stop☐ Underpass☐ Parked Vehicles Within☐ Feet☐ Metres

21+

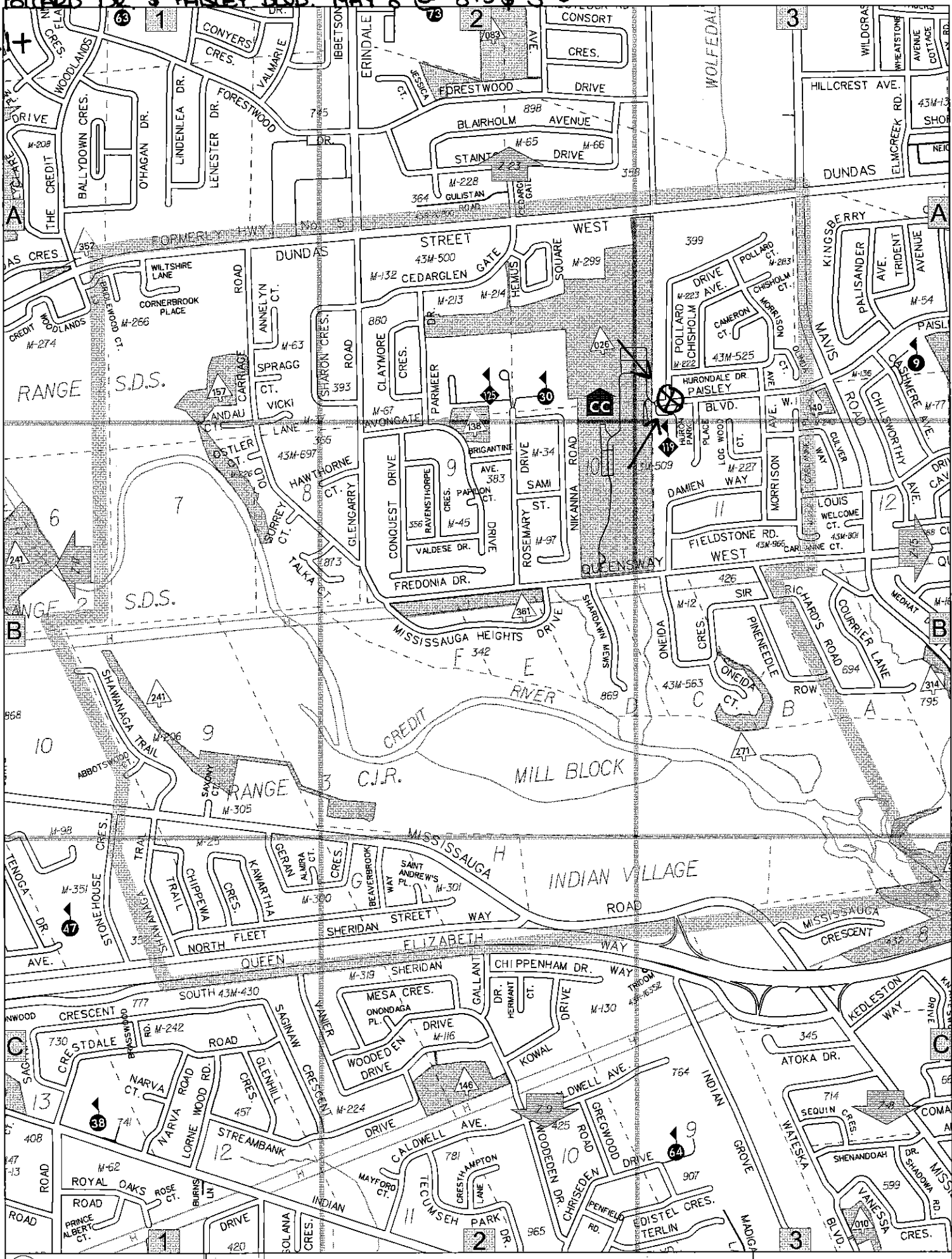

TUES. NOV. 17 @ 845 \$ 345

214

Laura Wilson PAISLEY BLVD. WEST \$ POLLARD DR.

From: Sheelagh Duffin
Sent: November 4, 2011 10:23 AM
To: Laura Wilson
Cc: Zvonimir Miller
Subject: FW: St. Jerome

Hi Laura,

Would you kindly schedule a Site Inspection to determine if the warrants are met for the implementation of a crossing guard at the intersection of Paisley Boulevard West and Pollard Drive for the students of St. Jerome Catholic School. Traffic Safety has conducted Site Inspections at this location in previous years, probably the most recent would be 3 or 4 years ago. The times for the inspection would be 8:45 - 9:15 am and 3:45 - 4:15 pm.

Thank you.

Sheelagh
5167

Sheelagh Duffin
Supervisor, Crossing Guards
City of Mississauga
3185 Mavis Road
Mississauga ON L5C 1T7
Phone 905 896-5167
Fax 905 896-5583
sheelagh.duffin@mississauga.ca

From: Zvonimir Miller
Sent: 2011/11/04 10:03 AM
To: Sheelagh Duffin
Cc: John Clarke
Subject: RE: St. Jerome

SR#115286

Elizabeth Tiburcio #905-615-1727

Hi Sheelagh...As discussed Elizabeth has a concern regarding pedestrians crossing Paisley in the vicinity of St Jerome. We have the IPS studies results back. An IPS remains unwarranted. I have let the resident know that an IPS remains unwarranted, however that the City will be performing a Site Inspection.

I will be closing my Hansen item, however can you get back to the resident with the results of the Site Inspection once complete.

Thanks,

Zvon

From: Sheelagh Duffin
Sent: 2011/11/03 2:38 PM
To: Zvonimir Miller
Subject: St. Jerome

Hi Zvon,

21v

Would you kindly forward me a copy of the request for stop signs/IPS/Crossing guards from the resident requesting same. We need the background info for our Site Inspection.

Thanks!!

Sheelagh
5167

Sheelagh Duffin
Supervisor, Crossing Guards
City of Mississauga
3185 Mavis Road
Mississauga ON L5C 1T7
Phone 905 896-5167
Fax 905 896-5583
sheelagh.duffin@mississauga.ca

Site Inspection Report - Traffic Safety Council

Observers

Complete All Questions

File Number:

RT.10. St. Jerome Catholic School

File Number:

RT.10.

Ward

7

Observed By:

S. Duffin

D. Yaunan

E. Lethbridge

D. Fryers

Date of Inspection:

2011 11 17

Inspection Time:

8:45 AM

3:45 PM

Requested By:

Crossing Guard Supervisor

Prepared By:

E. Lethbridge/ D. Fryers

Request For:

Place a crossing guard

Weather Conditions: ☒ Dry ☐ Sunny ☐ Rain ☐ Snow ☐ Other:

Site

School:

St. Jerome Catholic School

Address:

790 Paisley Blvd.

School Times:

9:15

AM

3:45

PM

Student Population:

No. of School Buses:

School:

Address:

School Times:

AM

PM

Student Population:

No. of School Buses:

School:

Address:

School Times:

AM

PM

Student Population:

No. of School Buses:

Location: (Please identify the location with reference to nearest intersection. Indicate nearest school and address.)

Paisley Blvd. W. & Pollard Drive

Type of Crossing: ☐ 4 Way Intersection ☒ 3 Way Intersection ☐ Midblock (i.e., not at Intersection)Type of Control: ☐ Traffic Lights ☐ Yield Signs ☐ No Control☒ Stop Signs (Traffic is stopped on one street only) ☐ All Way Stop (Traffic is stopped in all directions)

Part 1 Site Conditions

School Signs:

☒ School Area Signs☐ School crossing Signs☐ Parking/Stopping Prohibition

Posted Speed Limit:

☒ 40 km/hr☐ 50 km/hr☐ 60 km/hr☐ Other

km/hr

Visibility of Crossing Pedestrians:

☐ Poor☐ Fair☒ Good

Sight Obstructions:

☐ Hedges☐ Trees☐ Fences☐ Bus Shelter☐ Newspaper Boxes☐ Other (Specify)

Road Grade:

☒ Flat☐ Incline☐ Decline

Road Geometrics:

☐ Straight☒ Curved

Road Width:

☐ Feet☐ Metres

Curb to Curb:

☐ Feet☐ Metres

Curb to Median:

☐ Feet☐ Metres

Road Conditions:

☒ Dry☐ Wet☐ Snow Covered☐ Ice

Sidewalks:

☐ Not Present☒ North☒ South☐ East☐ West

Proximity to School:

☐ In Front of☐ Within☐ Feet☐ Metres

Route Survey:

☐ Shopping Area☐ Construction☐ Driveway☒ Other (Specify)

Road Geometrics:

☐ Transit Bus Stop☐ Underpass☐ Parked Vehicles Within☐ Feet☐ Metres

21x Warrant Survey

Location:

Check Appropriate Box For The Access Required

Paisley Blvd. W. & Pollard Drive

SAFE GAP TIME (W/3.5+4) = 21 SEC.

Morning Intervals

No.

Peds.: Time: Gaps:

		# of Gaps	# of Conflicts
	8:45-8:50 34/23/IIII, I27,43,57/24/	9	
	8:50-8:55 34/II50/II36,30,25,24/II,40/	11	
	8:55-9:00 I26/26/IIII, IIII22,21/IIII, I48/IIII, IIII, I	6	
3	9:00-9:05 IIII33/IIII, IIII, IIII, IIII, III	1	
8	9:05-9:10 IIII, IIII, IIII, IIII21/IIII, IIII, IIII, IIII, I24/IIII,	2	
3	9:10-9:15 II36/IIII, IIII, IIII, IIII, IIII, IIII, II21	2	
	9:15-9:20		

Afternoon Intervals

No./

Peds.: Time: Gaps:

5	3:45-3:50 I34, IIII, IIII, II38/II22/IIII, II	4	
16	3:50-3:55 II, IIII, III29,28/IIII36/IIII, II	4	
	3:55-4:00 34/25,46/IIII, II45/II42/	9	
	4:00-4:05 I23,40/II22/42,32,31,25/45	12	
	4:05-4:10 50/32/30,44	7	
	4:10-4:15		
	4:10-4:15		
	4:20-4:25		
	4:25-4:30		

Comments/Conflicts

No conflicts were observed. Drivers ewre couteous to crossing pedestrians. In the afternoon a number of studetns were crossing with parents to cars. Meian in roadway allows crossing pedestrians to cross the road in segments.

Recommendations

1. That the request for a Crossing Guard at the intersection of Paisley Boulevard West and Pollard Drive, for students attending St. Jerome Catholic School, 790 Paisley Boulevard West be denied as the warrants have not been met and that the Site Inspection Subcommittee of Traffic Safety Council be requested to re-inspect this location in April 2012. 2. That the Dufferin- Peel Catholic District School Board be requested to review the feasibility of installing a No Left Turn sign at the exit driveway of St. Jerome Catholic School.

Observations

A) Volume of Traffic: (See Intersection Plan)

B) Number of Crossing Pedestrians

☐ Heavy ☒ Light ☐ Intermittent

14 AM 21 PM

Site Inspection Report - Traffic Safety Council

214

Observers

Complete All Questions

File Number:

RT.10. St. Jerome Catholic School

File Number:

RT.10.

Ward

7

Observed By:

S. Duffin

D. Yaunan

Date of Inspection:

2011 11 21

Inspection Time:

8:45 AM

3:45 PM

Requested By:

Crossing Guard Supervisor

Prepared By:

D. Yaunan

Request For:

Place a crossing guard

Weather Conditions: ☒ Dry ☐ Sunny ☐ Rain ☐ Snow ☐ Other:

Site

School:

St. Jerome Catholic School

Address:

790 Paisley Blvd.

School Times:

9:15

AM

3:45

PM

Student Population:

No. of School Buses:

School:

Address:

School Times:

AM

PM

Student Population:

No. of School Buses:

School:

Address:

School Times:

AM

PM

Student Population:

No. of School Buses:

Location: (Please identify the location with reference to nearest intersection. Indicate nearest school and address.)

Paisley Blvd. W. & Pollard Drive

Type of Crossing: ☐ 4 Way Intersection ☒ 3 Way Intersection ☐ Midblock (i.e., not at Intersection)

Type of Control: ☐ Traffic Lights ☐ Yield Signs ☐ No Control

☒ Stop Signs (Traffic is stopped on one street only) ☐ All Way Stop (Traffic is stopped in all directions)

Part 1 Site Conditions

School Signs:

☒ School Area Signs

☐ School crossing Signs

☐ Parking/Stopping Prohibition

Posted Speed Limit:

☒ 40 km/hr

☐ 50 km/hr

☐ 60 km/hr

☐ Other

km/hr

Visibility of Crossing Pedestrians: ☐ Poor

☐ Fair

☒ Good

Sight Obstructions:

☐ Hedges

☐ Trees

☐ Fences

☐ Bus Shelter

☐ Newspaper Boxes

☐ Other (Specify)

Road Grade:

☒ Flat

☐ Incline

☐ Decline

Road Geometrics:

☐ Straight

☒ Curved

Road Width:

☐ Feet

☐ Metres

Curb to Curb:

☐ Feet

☐ Metres

Curb to Median:

☐ Feet

☐ Metres

Road Conditions:

☒ Dry

☐ Wet

☐ Snow Covered

☐ Ice

Sidewalks:

☐ Not Present

☒ North

☒ South

☐ East

☐ West

Proximity to School:

☐ In Front of

☐ Within

☐ Feet

☐ Metres

Route Survey:

☐ Shopping Area

☐ Construction

☐ Driveway

☒ Other (Specify)

Road Geometrics:

☐ Transit Bus Stop

☐ Underpass

☐ Parked Vehicles Within

☐ Feet

☐ Metres

212 Warrant Survey

Location:

Check Appropriate Box For The Access Required

Paisley Blvd. W. & Pollard Drive

SAFE GAP TIME (W/3.5+4) = 23 SEC.

Morning Intervals

No.
Peds.: Time: Gaps:

			# of Gaps	# of Conflicts
	8:45-8:50	55,30/45///48/	7	
	8:50-8:55	28///89,49	7	
1	8:55-9:00	/29,39,31///29,23//	6	
2	9:00-9:05	26///27/37///29///,/29///	6	
6	9:05-9:10	/23///,///,///,///,///,///28///,///	2	
6	9:10-9:15	//36///,///33///,///,///,///	3	
	9:15-9:20			

Afternoon Intervals

No./
Peds.: Time: Gaps:

5	3:45-3:50	/34,///,///,///38//22///,//	4	
16	3:50-3:55	//,///,///29,28///36///,//	4	
	3:55-4:00	34/25,46///,//45//42/	8	
	4:00-4:05	/23,40///22/42,32,31,25/45	11	
	4:05-4:10	50/32/30,44	6	
	4:10-4:15			
	4:10-4:15			
	4:20-4:25			
	4:25-4:30			

Comments/Conflicts

No conflicts were observed. Drivers were courteous to crossing pedestrians. In the afternoon a number of students were crossing with parents to cars. Median in roadway allows crossing pedestrians to cross the road in segments.

Recommendations

1. That the request for a Crossing Guard at the intersection of Paisley Boulevard West and Pollard Drive, for students attending St. Jerome Catholic School, 790 Paisley Boulevard West be denied as the warrants have not been met and that the Site Inspection Subcommittee of Traffic Safety Council be requested to re-inspect this location in April 2012. 2. That the Dufferin- Peel Catholic District School Board be requested to review the feasibility of installing a No Left Turn sign at the exit driveway of St. Jerome Catholic School.

Observations

A) Volume of Traffic: (See Intersection Plan)

B) Number of Crossing Pedestrians

☐ Heavy ☒ Light ☐ Intermittent

15 AM 18 PM

2730 THORN LODGE DR. IN FRONT OF SCHOOL @ 830 & 330 ON

Laura Wilson MAY 31

21aa

From: Gill, Soni [soni.gill@peelsb.com]
Sent: March 23, 2012 4:30 PM
To: Laura Wilson
Subject: Thorn Lodge PS - Kiss and Ride

Hi Laura,

Traffic Safety Council was at Thorn Lodge PS on November 23rd, 2011. Although suggestions were made they do not address the concern of the congested traffic entering Thorn Lodge all at the same time.

For example, when three buses come to our school all at the same time, two buses come into the bus lane and the other bus waits near the entrance of the driveway (not blocking it). However, this causes a traffic jam on the street. Cars waiting to come into the parking lot are waiting behind the bus. At times they try to pass the bus but do it cautiously so they do not interfere with ongoing traffic (an accident waiting to happen).

Also the Mississauga Transit bus comes near our school at the same time the buses arrive to our school. The bus stop also is very close to our school driveway. On many mornings, cars drive very quickly on Thorn Lodge Drive (both sides). I fear that an accident is waiting to happen. Also my parent community is not happy or pleased.

I do wish that someone could come in to examine the traffic issues and stand where I do each morning.

Soni Gill
Principal
Thorn Lodge Public School
905-822-5481

NOTE: This e-mail message is intended for the named recipient(s) above, and may contain information that is privileged, confidential and/or exempt from disclosure under applicable law. If you have received this message in error, or are not the named recipient(s), please do not read the content. Instead, immediately notify the sender and delete this e-mail message. Any unauthorized use, disclosure or distribution is prohibited. The Peel District School Board and sender assume no responsibility for any errors or omissions in the content or transmission of this email.

21bb Site Inspection Report - Traffic Safety Council

Observers

Complete All Questions

File Number:

RT.10. Thorn Lodge Drive Public

File Number:

RT.10.

Ward

2

Observed By:

Date of Inspection:

2012 05 31

Inspection Time:

8:30 AM

3:30 PM

Requested By:

Principal

Prepared By:

Request For:

Review pedestrian safety

Weather Conditions: ☐ Dry ☐ Sunny ☐ Rain ☐ Snow ☐ Other:

Site

School:

Thorn Lodge Drive Public School

Address:

2730 Thorn Lodge Drive

School Times:

9:00

AM

3:30

PM

Student Population:

No. of School Buses:

School:

Address:

School Times:

AM

PM

Student Population:

No. of School Buses:

School:

Address:

School Times:

AM

PM

Student Population:

No. of School Buses:

Location: (Please identify the location with reference to nearest intersection. Indicate nearest school and address.)

In front of Thorn Lodge Public School

Type of Crossing: ☐ 4 Way Intersection ☐ 3 Way Intersection ☐ Midblock (i.e., not at Intersection)

Type of Control: ☐ Traffic Lights ☐ Yield Signs ☐ No Control

☐ Stop Signs (Traffic is stopped on one street only) ☐ All Way Stop (Traffic is stopped in all directions)

Part 1 Site Conditions

School Signs:

☐ School Area Signs

☐ School crossing Signs

☐ Parking/Stopping Prohibition

Posted Speed Limit:

☐ 40 km/hr

☐ 50 km/hr

☐ 60 km/hr

☐ Other

km/hr

Visibility of Crossing Pedestrians:

☐ Poor

☐ Fair

☐ Good

Sight Obstructions:

☐ Hedges

☐ Trees

☐ Fences

☐ Bus Shelter

☐ Newspaper Boxes

☐ Other (Specify)

Road Grade:

☐ Flat

☐ Incline

☐ Decline

Road Geometrics:

☐ Straight

☐ Curved

Road Width:

☐ Feet

☐ Metres

Curb to Curb:

☐ Feet

☐ Metres

Curb to Median:

☐ Feet

☐ Metres

Road Conditions:

☐ Dry

☐ Wet

☐ Snow Covered

☐ Ice

Sidewalks:

☐ Not Present

☐ North

☐ South

☐ East

☐ West

Proximity to School:

☐ In Front of

☐ Within

☐ Feet

☐ Metres

Route Survey:

☐ Shopping Area

☐ Construction

☐ Driveway

☐ Other (Specify)

Road Geometrics:

☐ Transit Bus Stop

☐ Underpass

☐ Parked Vehicles Within

☐ Feet

☐ Metres

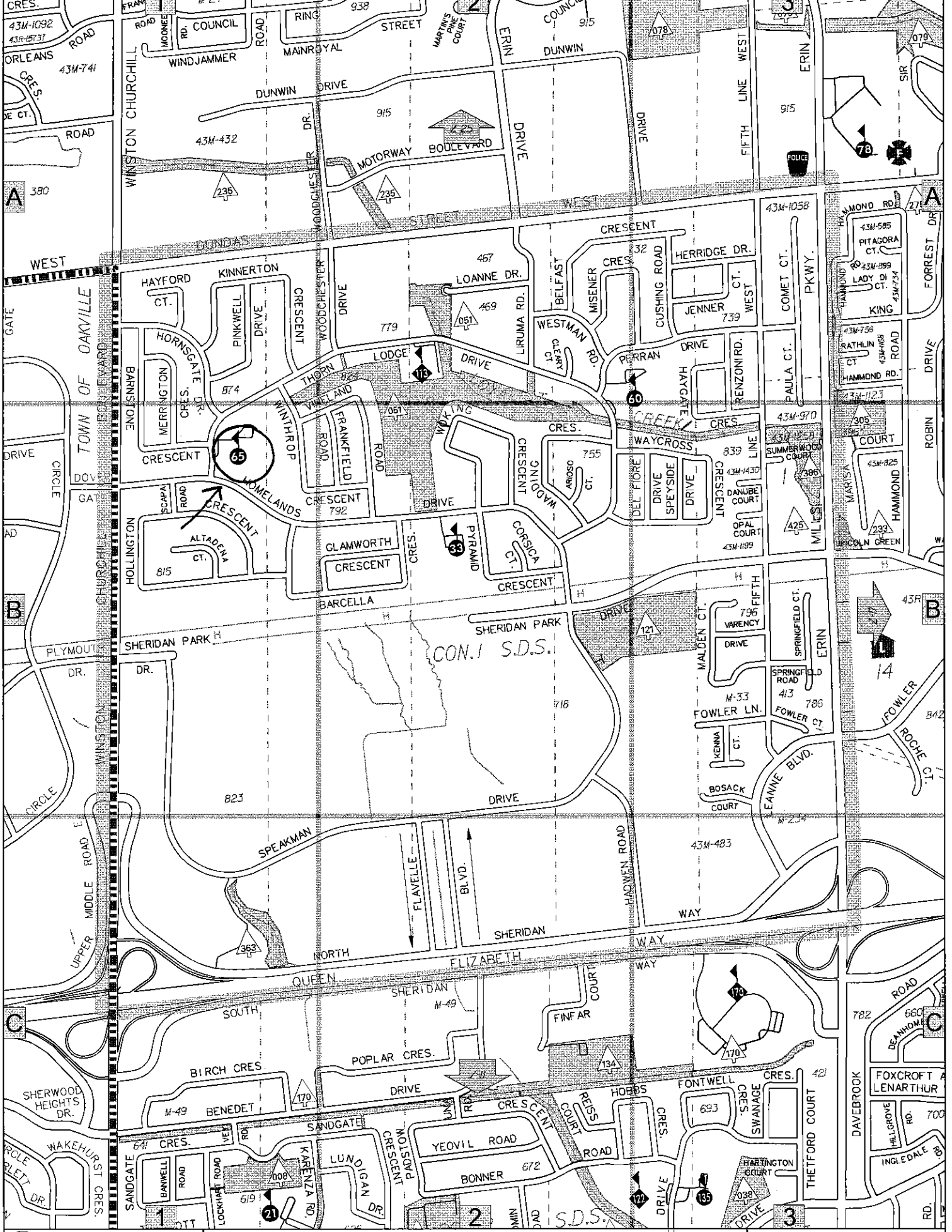

From: Sacha Smith on behalf of Traffic Safety
Sent: April 10, 2012 10:50 AM
To: Laura Wilson
Subject: FW: Road Safety Show on Canada Day
Attachments: Vendor Insurance Information 2012.pdf; Canada Day Vendor Guidelines.pdf; Liability and Waiver Form 2012.pdf

From: Stephanie Smith
Sent: April 10, 2012 10:05 AM
To: [REDACTED]
[REDACTED]
[REDACTED]
[REDACTED]
[REDACTED]

Subject: Road Safety Show on Canada Day

Please advise if your agency is interested in participating with the 2012 Road Safety Show on Canada Day, July 1st 2012.

The Show will operate from 1:00pm through 4:30pm.

The site for the Show will be on Living Arts Centre Drive and Princess Royal.

Your arrival to the Show site would be 11:00am for check in and set up.

I require your response confirming participation by 4:30pm on Friday April 20th 2012.

Documentation for liability insurance/waiver forms will be required by **April 27th 2012** for persons and/or agencies who confirm their participation.

Many thanks for your interest in Road Safety.

Stephanie Smith
Legislative Coordinator
Office of the City Clerk
905-615-3200 ext. 3795

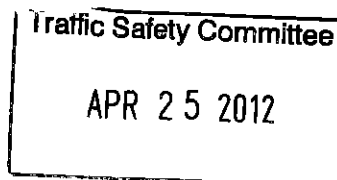

TRAFFIC SAFETY COUNCIL
Transportation and Works - Action Items

Mar-12			
Reference	School / Location	Item	Action
TSC-0032-2012	Shelter Bay Public School 6735 Shelter Bay Road Mississauga, ON	3. That the Transportation and Works Department be requested to review the placement of the No Stopping and No U-turn signs on the north side of Shelter Bay Road.	stakeout(s) required to accommodate request
TSC-0038-2012	Dunrankin Public School 3700 Dunrankin Drive Mississauga ON	That the Transportation and Works Department be requested to review the feasibility of installing No Parking signs along Dunrankin Drive, opposite to Dunrankin Public School, 3700 Dunrankin Drive	stakeout(s) required to accommodate request
TSC-0044-2012	St. Luke Catholic School 1280 Cobalt Street Mississauga ON	1. That the Transportation and Works Department review the No Stopping and No Parking signs on Cobalt Street and Indian Road in the vicinity of St. Luke Catholic School, 1280 Cobalt Street.	adequate signage
TSC-0045-2012	St. Gertrude Catholic School 815 Ceremonial Drive Mississauga ON	1. That the Transportation and Works department review the signage along Mirage Place, Esprit Crescent and Patriot Drive in the vicinity of St. Gertrude Catholic School, 815 Ceremonial Drive.	Work Order Issued