

2005 Mississauga URBAN DESIGN Awards

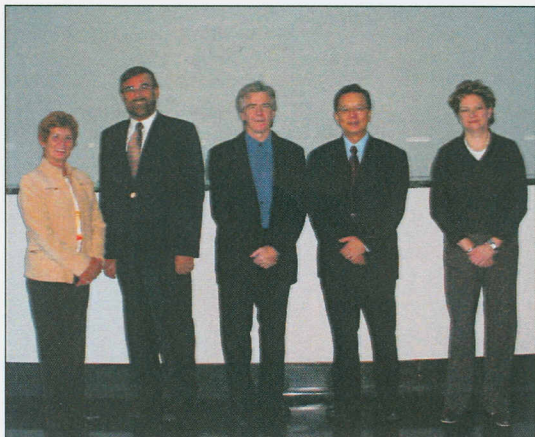

JURY REPORT



2005 Mississauga Urban Design Awards Jury Members

Katie Mahoney, Councillor, Ward 8,
City of Mississauga

Edward R. Sajecki, Commissioner of Planning and Building
City of Mississauga

Barry Sampson, Principal, Baird Sampson Neuert Architects

Jason Wu, Associate Principal, Walker Nott Dragicevic Associates

Laura Starr, Principal, Starr Landscape Inc.



Award of Excellence

Davies Smith Developments
Peel Condominium Corporation #731
Quadrangle Architects Limited
Alexander Budrevics & Associates Limited

CityGate is an exceptionally designed building where careful attention to detail has contributed to the creation of a distinct landmark development within Mississauga's City Centre. The slender point towers combined with a tall, urbane podium create an appropriately scaled development to the wide Burnhamthorpe Road right-of-way. The combination of two unit types, including double height lofts and single storey apartments is quite innovative in the residential market place and allows for more dynamic design expression of building fenestrations. CityGate's roof-scape makes a bold statement, particularly at night, when the tops of the two point towers dramatically light up the skyline of the Mississauga City Centre. CityGate is a positive model for Mississauga's downtown and helps to raise the bar for design excellence in Mississauga.



Award of Merit for Context and Execution

AstraZeneca Canada Inc.
WZMH Architects
Envision - The Hough Group Limited

The second phase of the AstraZeneca development is a face lifting one which contributes a positive visual experience to this stretch of the Queensway. Better built form relationship and good quality streetscape helps enliven the street. The architecture of the building is well executed and is well integrated with the site. Site works are excellent and particular recognition should be given to the Landscape Architect who designed elements reflective of the historical landscape. This project serves as an excellent example of how to improve and strengthen an existing streetscape and how to integrate site works and building design to create a high quality project.



Award of Merit for Innovation and City-Wide Significance

Peel Regional Municipality
City of Mississauga
Radeff Architect Ltd.
Baker Turner Inc.

BraeBen is the culmination of years of careful planning. Environmentally, the BraeBen golf course provides an exceptional example of how to re-use a de-commissioned landfill site for the betterment of the community. The course has been carefully sculpted over many years into what has become an exceptionally well-executed golf course. The golf course site not only offers a great active amenity for residents of Mississauga, but has also become an attractive visual terminus to many neighbouring streets and offers some of the most spectacular views of the city and the rapidly changing City Centre skyline. This highly innovative project serves as an example to the rest of the Province as to how to responsibly plan for the future to make the best use of sites which offer limited re-development opportunities.



Award of Merit for Architectural Innovation and Building Execution

2725312 Canada Inc.
Microsoft Canada
Sweeny Sterling Finlayson & Co Architects Inc.
Adamson Associates Architects

Architecturally, the Microsoft building is well executed and serves as an excellent example of how to design buildings in an environmentally responsible way. Parking has been strategically lowered to focus attention on the building. The terrace has been designed as a significant congenial feature for the employees of the building. The environmental agenda could have been strengthened through exterior landscape treatments and it is hoped that over time this aspect of the project can be enhanced so that Mississauga can point to the Microsoft project as an exemplary model for sustainable design.



Award of Merit for Community Context, Significance and Execution

Region of Peel Housing Development
Levitt Goodman Architects Ltd.

The Peel Youth Centre has taken advantage of an underutilized site to create a building that is very beneficial to the community. This infill building has not only responded well to its context, but has actually improved it by acting as a visual moderator to the larger background buildings. The strength of this project is in its simplicity. Economical, durable and practical materials have been used in ways that create a simple, clean site design with rich, active spaces. The site design works in a very harmonious manner with the building design and the ground floor reads in a very elegant fashion with the front door positioned to be accessible to pedestrians. Overall this project is well thought out and supports the design notion that sometimes less is more.



Award of Merit for Community Significance

70 & 80 Port Street East, and Port Street Market - 125, 129, 139 Lakeshore Road East

FRAM Building Group\Slokker Canada
Peel Standard Condominium #411
Peel Standard Condominium #316
Giannone Associates Architects Inc.
Baker Turner Inc.

The strengths of the 70 Port Street, 80 Port Street and the Port Street Market submissions are not necessarily in any one individual project, but rather in the combined place-making impact of all three. Good attention to detail, particularly the innovative way of dealing with parking and landscape islands is quite successful. In addition, details within the public square such as the corrugated steel planters are well executed and quite innovative. The mix of uses around the square will work well to animate the square and further the dramatic transformation that is currently well under way in the Village of Port Credit.

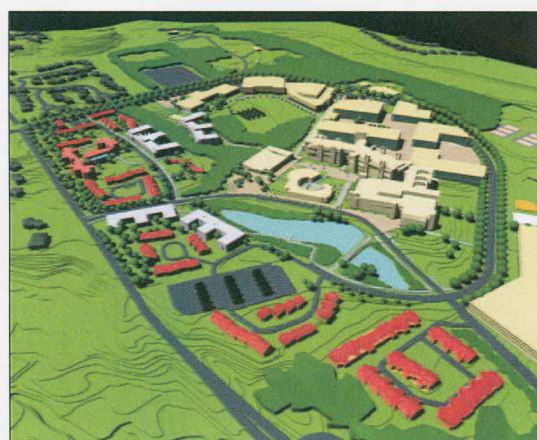

Award of Merit for Community Significance

University of Toronto at Mississauga
Sweeny Sterling Finlayson & Co Architects
Gunta Mackars Landscape Architect

The University of Toronto at Mississauga is to be commended for undertaking the arduous task of preparing a master plan to guide future campus development. The master plan thoughtfully organizes buildings along a central pedestrian spine and seeks to employ traditional campus elements such as the five minute walk and the quadrangle as organizing elements. The master plan will provide necessary guidance to the University as it continues to evolve as one of the City's key educational and cultural assets.

2005 Mississauga Urban Design Awards Nominations

AstraZeneca Canadian Business Centre,
Phase 2 - Amenities Facility,
1004 Middlegate Road
BraeBen Golf Course,
5700 Terry Fox Way
Canyon Creek Chophouse - Patio Addition,
299 Rathburn Road West
CityGate - Phase 1,
3939 Duke of York
Colalillo Automotive Multiple Use Building,
626 Burnhamthorpe Road West
Dream Crest Plaza,
1010 Dream Crest Road
Gigliotti Residence,
2400 Doulton Drive
KMH Research Centre,
2075 Hadwen Road
Microsoft Canada Headquarters,
1950 Meadowvale Boulevard
Monte Carlo Corporate Centre,
7045 Edwards Boulevard
Old Barber House - Addition,
5155 Mississauga Road
Ovation at City Centre - Phase I,
3880/3888 Duke of York Boulevard
Peel Youth Village,
99 Acorn Place
Port Street Market,
125, 129, 139 Lakeshore Road East
R.R. Enterprises Corporate Offices, 2
855 Speakman Drive
Rotherglen School, Gooderham Mansion
Campus - Addition,
929 Old Derry Road
Saviour of the World Chinese Catholic
Mission Church,
20 Bristol Road
Subaru of Mississauga,
6160 Mavis Road
The Bungalow Garden Homes of Old
Carriage Road,
2417 Old Carriage Road
University of Toronto at Mississauga Campus
Master Plan,
3359 Mississauga Road North

Thanks to Our Sponsors



Daniels
love where you live



**URBAN
STRATEGIES
INC.**

