

METRIC

ALL DIMENSIONS IN MILLIMETRES

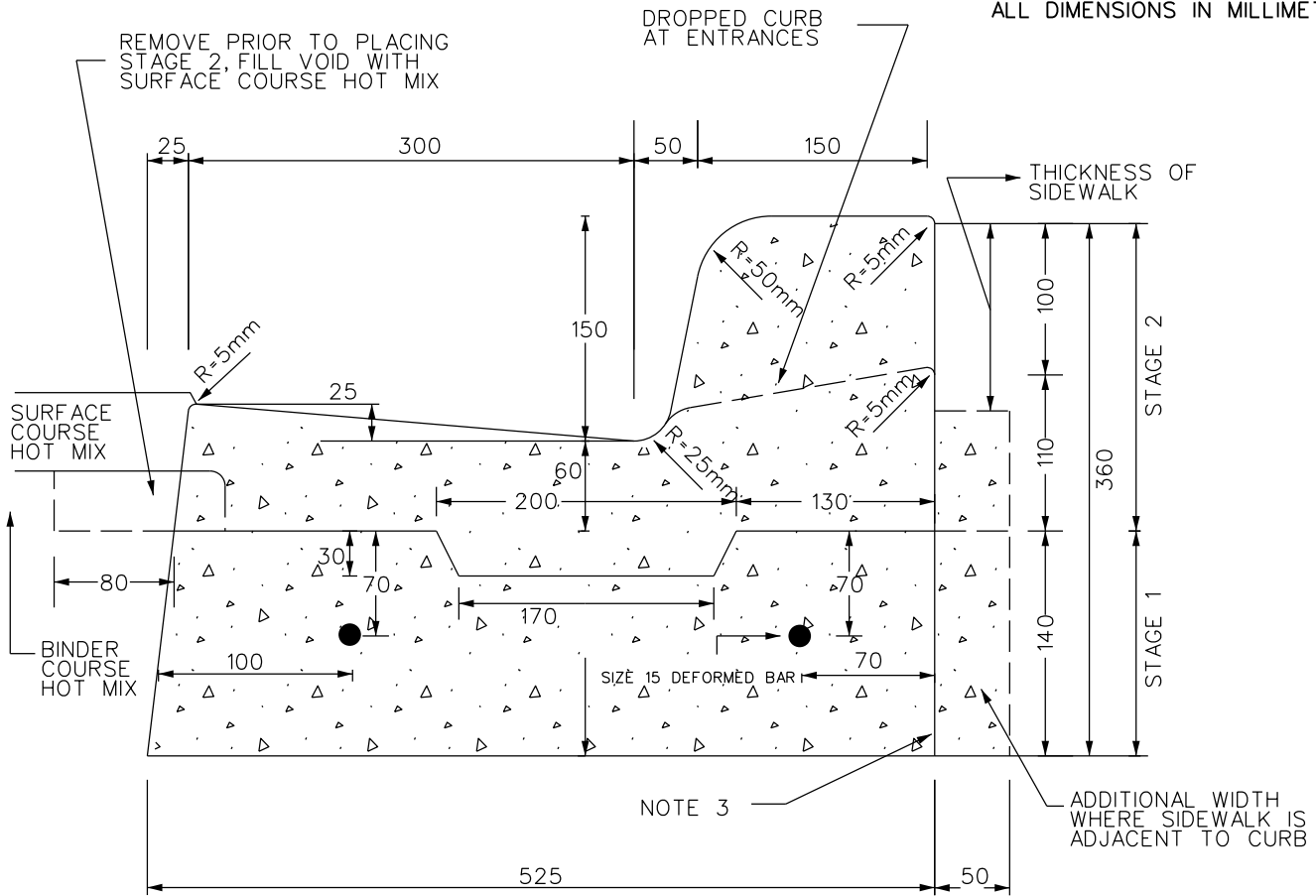

STAGE ONE- TEMPORARY HOT MIX FILLER AROUND CATCH BASIN

STAGE TWO- REMOVE ASPHALT FILLER AND COMPLETE CURB IN ONE POUR

REBAR TO TERMINATE FLUSH WITH THE END OF INITIAL POUR

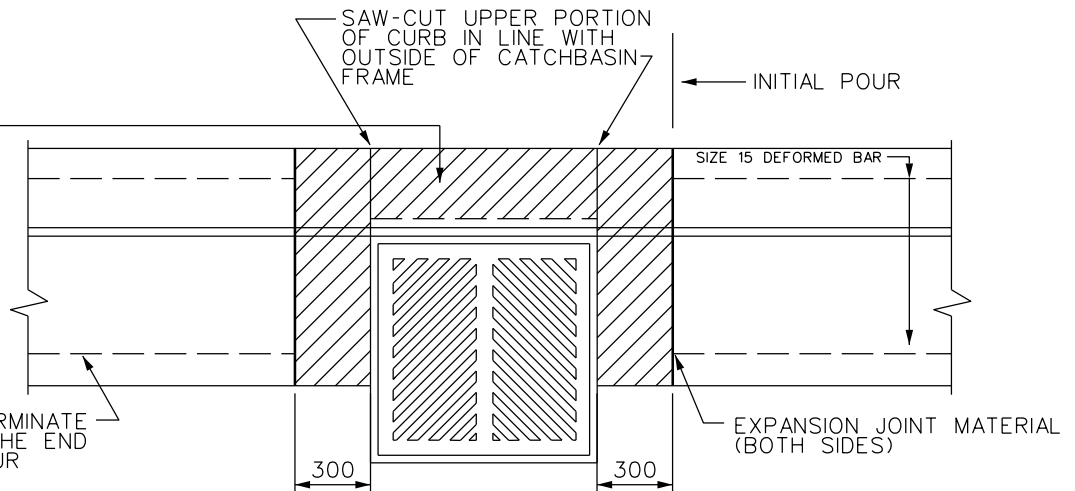

NOTES:

1. FLEXIBLE AND COMPOSITE PAVEMENT SHALL BE 5mm ABOVE THE ADJACENT EDGE OF GUTTER.
2. WHERE THE SIDEWALK IS CONTINUOUS TO THE CURB, AT ENTRANCES LOWER THE HEIGHT OF THE ADDITIONAL CONCRETE AT THE REAR OF THE CURB TO 150mm.
3. FOR SLIPFORMING PROCEDURE, A 5% BATTER IS ACCEPTABLE.
4. TREATMENT AT ENTRANCES SHALL CONFORM WITH OPSD-351.01.
5. OUTLET TREATMENT SHALL CONFORM WITH OPSD-610 SERIES.
6. THE LENGTH OF TRANSITION FROM ONE CURB TYPE TO ANOTHER SHALL BE 3.0m, EXCEPT IN CONJUNCTION WITH GUIDE RAIL, IT SHALL CONFORM TO OPSD-900 SERIES.
7. ALL DIMENSIONS ARE IN MILLIMETERS UNLESS OTHERWISE SHOWN.
8. BASE CURB IS TO BE FLUSHED THEN BLOWN OFF WITH HIGH PRESSURE AIR TO ENSURE A CLEAN DRY SURFACE.
9. ALL CONCRETE CSA, C-2, 32MPa.



MISSISSAUGA

**STANDARD
CONCRETE BARRIER CURB
WITH STANDARD GUTTER
TWO STAGE CONSTRUCTION**

EFF. DATE	2015-12-11	SCALE	N.T.S.
REV.	2016-09-21	STANDARD No.	2230.010