

Type "A"
Quadruple Concrete Pad

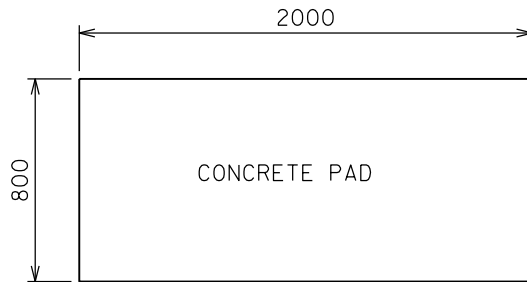

Type "B"
Triple Concrete Pad

DETAIL OF 'BOX OUT'
FOR UTILITY STRUCTURE

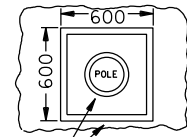

EXPANSION JOINT

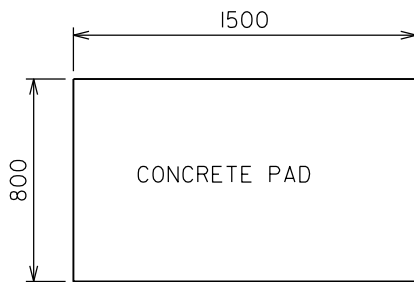

Type "C"
Double Concrete Pad

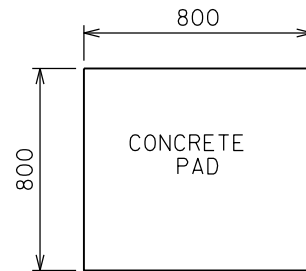

Type "D"
Single Concrete Pad

NOTES

1. CONCRETE TO BE IN ACCORDANCE WITH OPSS 351. REFER ALSO TO CITY STANDARD 2.02.03
2. ALL PADS TO BE SLOPED 2% TOWARDS THE ROAD OR AS OTHERWISE DIRECTED
3. THE SURFACE ELEVATION OF THE PAD MUST MATCH/BE EQUAL TO THE SURFACE ELEVATION OF ADJACENT GRADE (SIDEWALK OR BOULEVARD)
4. CONCRETE THICKNESS TO BE 130mm



MISSISSAUGA

STANDARD
TYPICAL CONCRETE
PAD FOR
NEWSPAPER BOX APPLICATION

EFF. DATE	2002-01-01	SCALE	N.T.S.
REV.	3	2015-06-03	STANDARD No. 2240.070