



Rathburn Road East and Ponytrail Drive Integrated Road Project

Public Information Centre #2 (ONLINE)

June 9, 2021



STUDY PURPOSE

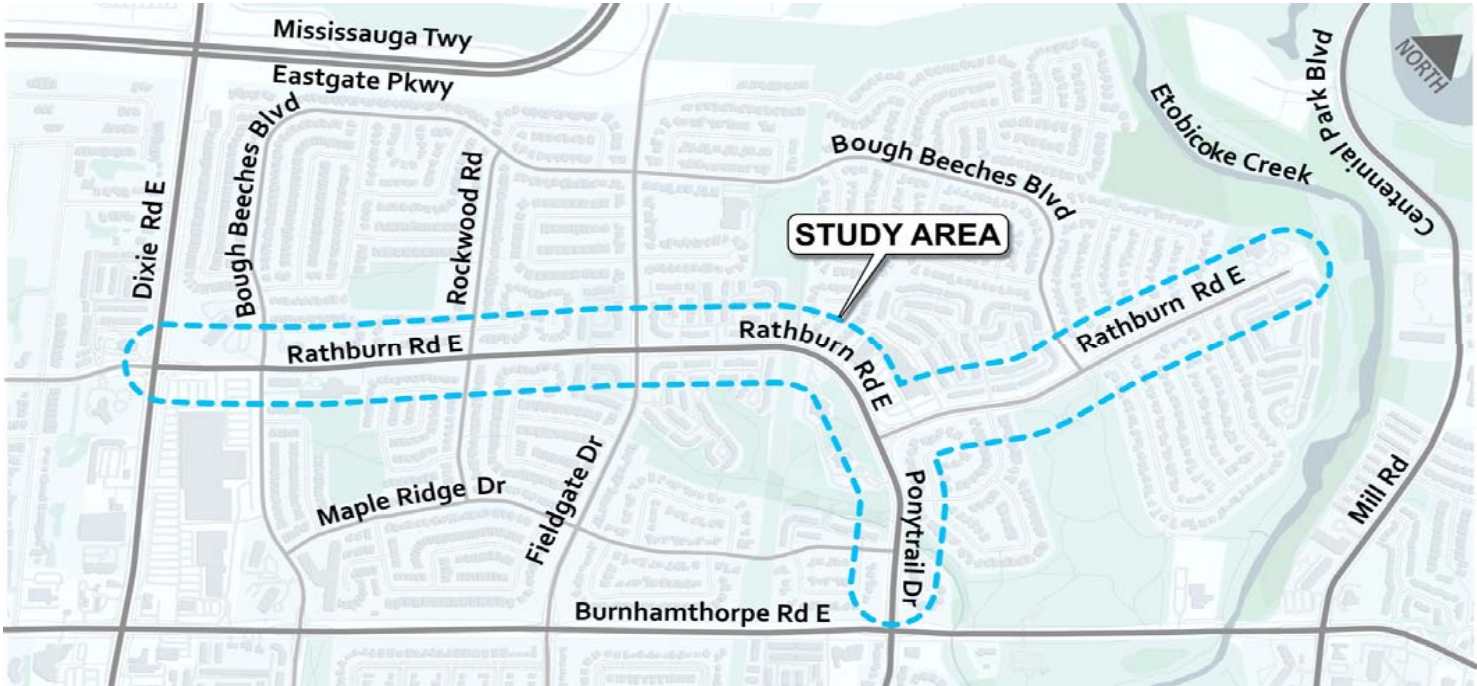

Why Are We Here?

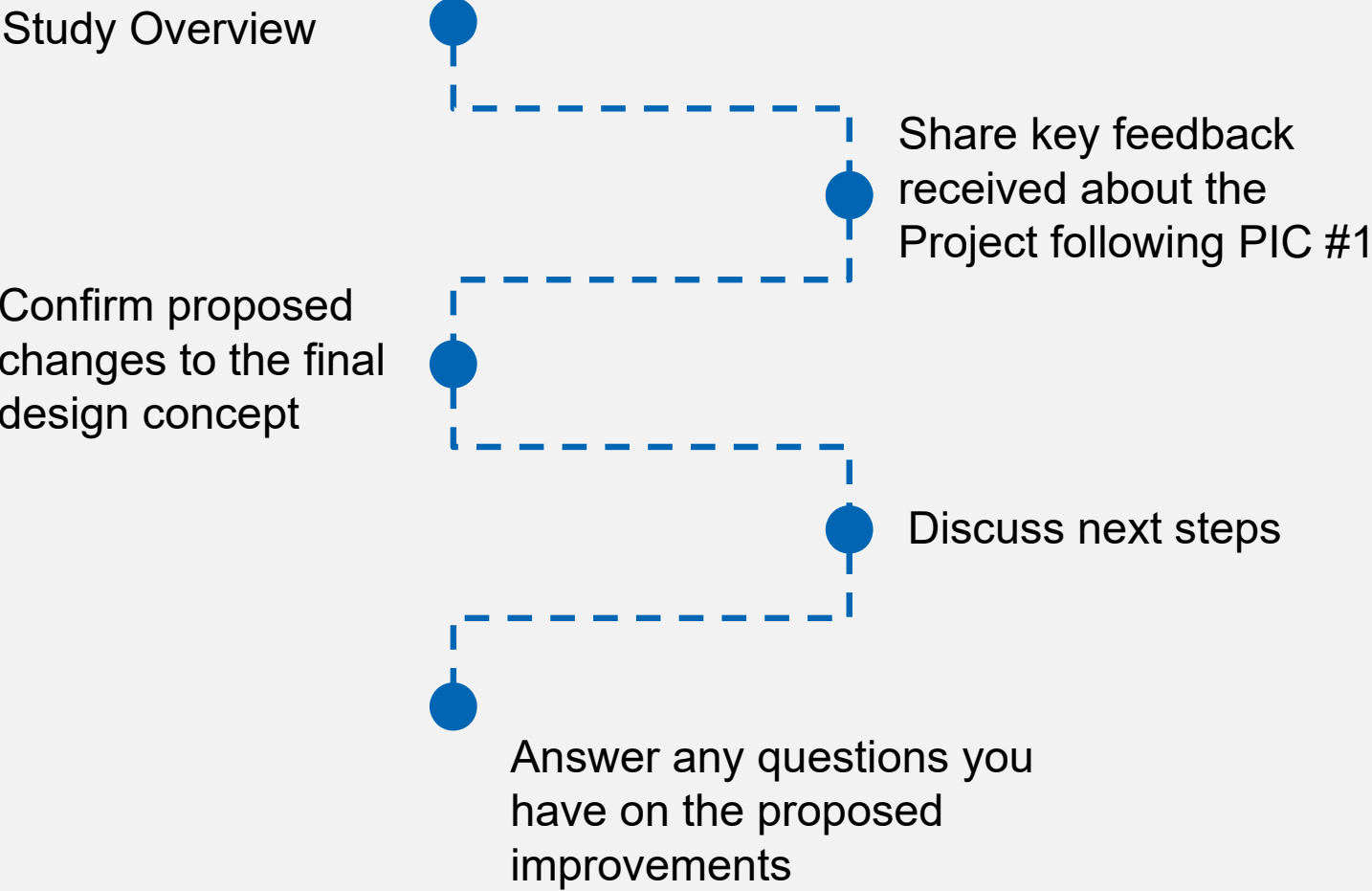

SUMMARY OF PIC #1



Study Area



Existing Conditions



Planning and
Policy
Context



Opportunities and
Considerations



Opportunities for
Improvements



Design
Concepts
Alternatives

PIC #1 PRELIMINARY DESIGN CONCEPTS

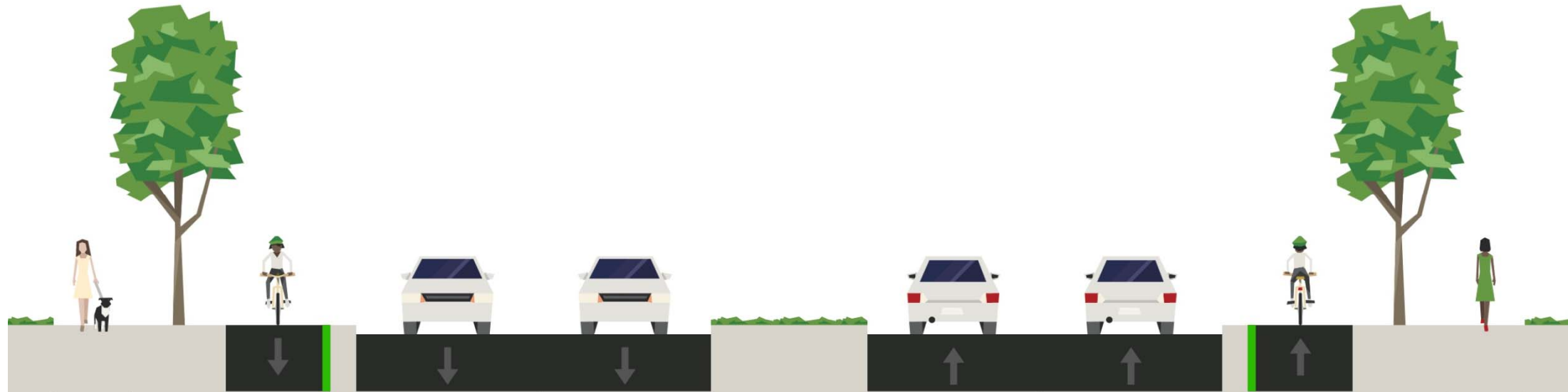

Dixie Road to Burnhamthorpe Road

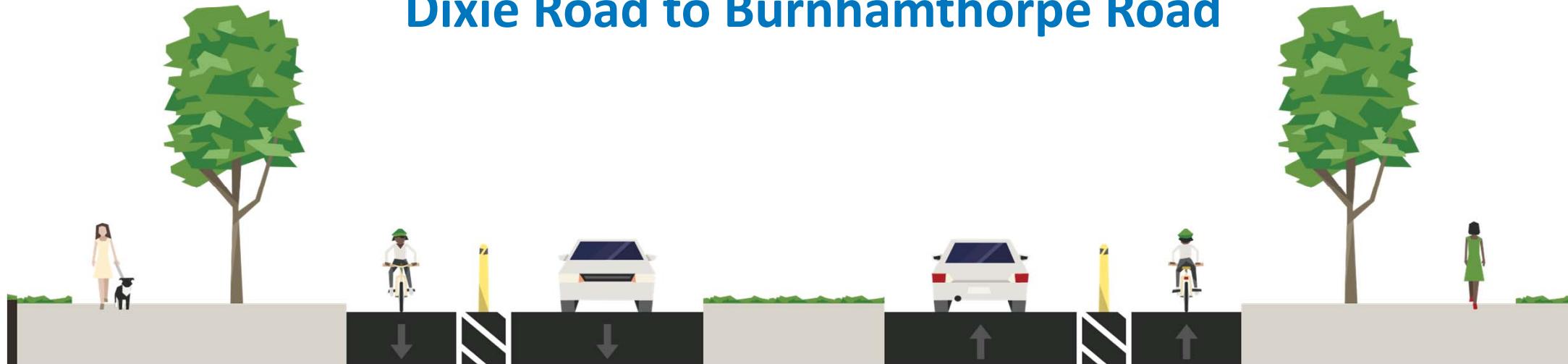

Ponytrail to Cul De Sac

WHAT WE HEARD AT PIC #1



Both support and concerns about new active transportation facilities
How will they benefit the community



Inquiries about future landscape and aesthetic of corridor
How will the City beautify Rathburn Road East



Traffic operational concerns and enquiries
How will traffic operate after the improvements



Pedestrian safety and pedestrian crossing locations
Requests for additional pedestrian crossing facilities

PLANNING AND POLICY CONTEXT

Provincial Plans



Regional Plans

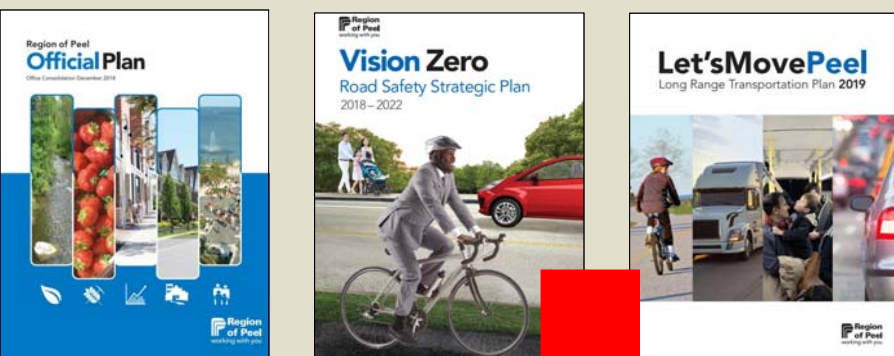

Municipal Plans



ROAD SAFETY – VISION ZERO



Vision Zero Principles:

Prioritize the safety and access of our most vulnerable road users

Eliminate all serious injury and fatal collisions

Zero = No loss of life or serious injury is acceptable in Mississauga

ROAD SAFETY – VISION ZERO



The City's Transportation Master Plan (TMP) sets out action items to help guide city staff to achieve our Vision Zero goal.



Prioritize the safety and access of our most vulnerable road users.



Everyone has a role to play in keeping each other safe on our network.

ROAD SAFETY – VISION ZERO

Paradigm Shift:

Traditional Prevailing	Vision Zero
Preventing all collisions	Preventing fatalities and serious injuries
Deaths are inevitable	Deaths are preventable
Perfecting human behaviour	Designing a road system that accounts for human error
Individual road users	Shared: road users and system designers

ROAD SAFETY

Measures to Decrease Collisions and Lower Risks of Injury for Rathburn Road and Ponytrail Drive



Promote Speed
Reduction



Separate vulnerable road
users from vehicle traffic
through time



Separate vulnerable road
users from vehicle traffic
through space



Support vulnerable user
and driver decision-
making

RATHBURN ROAD EAST

(Ponytrail Drive to End of Cul-de-sac)

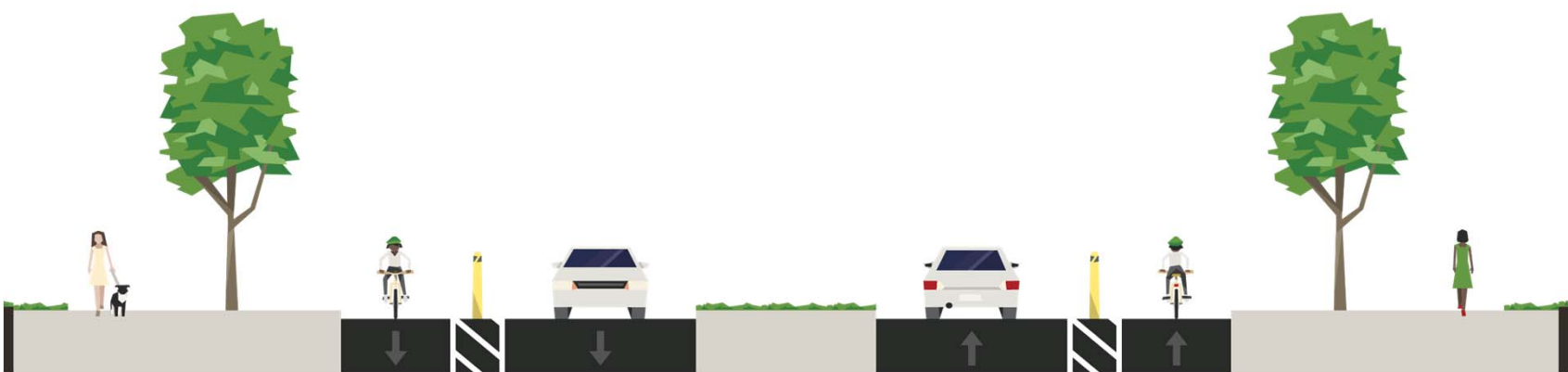

Separated Bike Lanes (PIC#1)



Two Way Cycle Track



TRAFFIC ANALYSIS

Existing

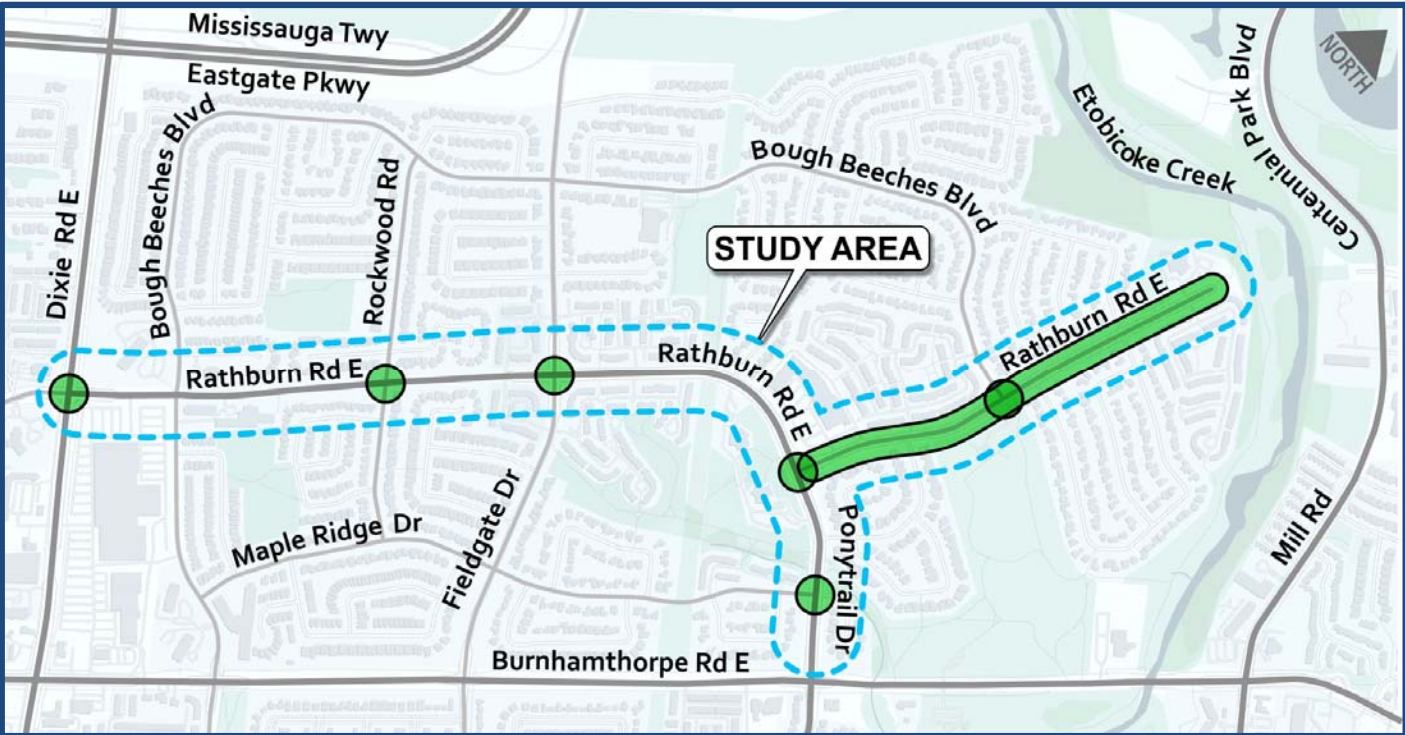

Future Conditions (2041)

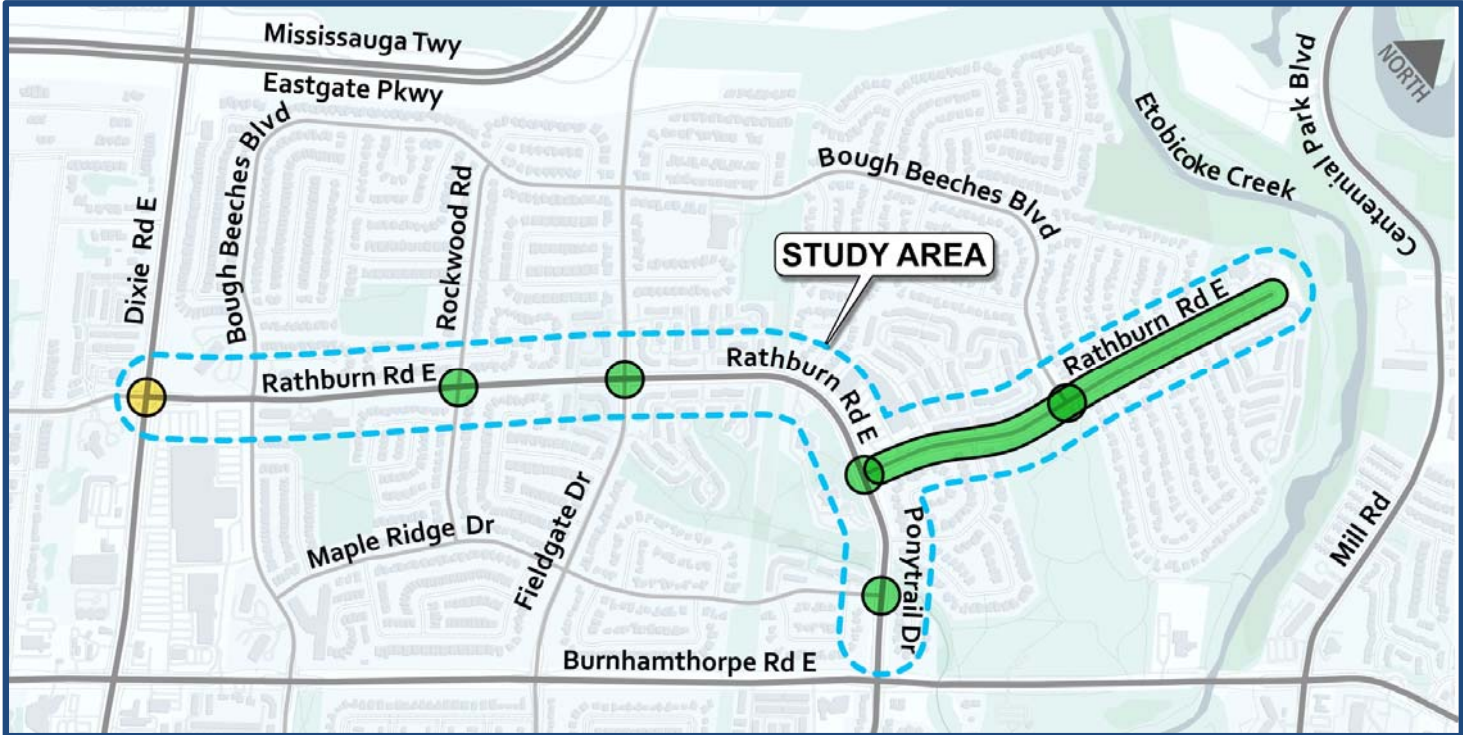

INTERSECTION OPERATIONS

Rathburn Road East / Ponytrail Drive

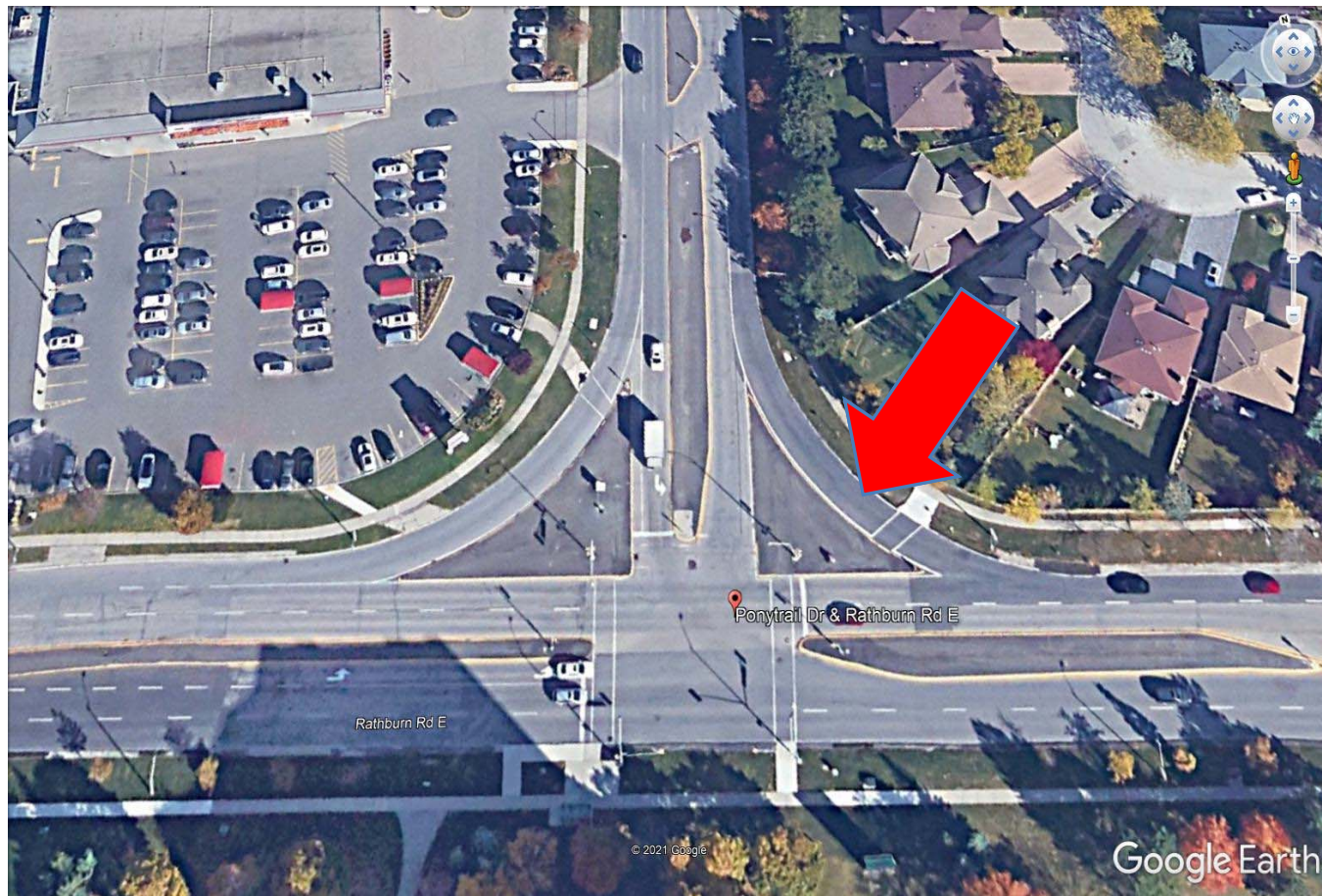

LEGEND:

- EXISTING CONCRETE SIDEWALK
- PROPOSED CONCRETE SIDEWALK/ BUS PAD
- PROPOSED ONE AND TWO WAY CYCLE TRACKS
- PROPOSED EDGE OF PAVEMENT/ CURB LINE

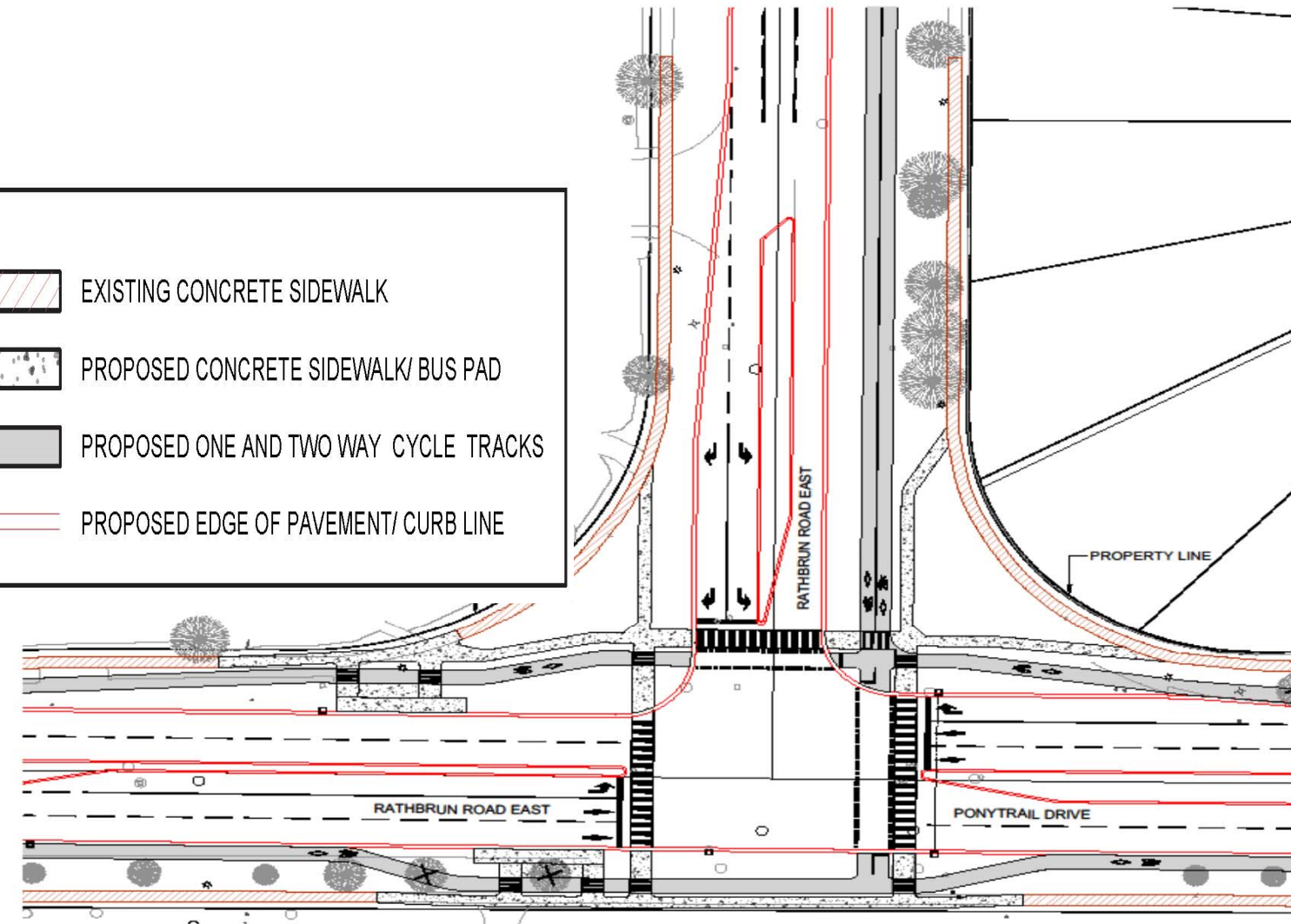

PEDESTRIAN CROSSING OPTIONS

Refuge Island/Raised Crosswalk

Pedestrians have to wait for a gap in traffic to cross.



Pedestrian Crossover

Pedestrians have priority in the crossing, and vehicles must yield to them.



Signalized Crossing



Pedestrians have a traffic signal to give them priority when crossing.



PEDESTRIAN CROSSING IMPROVEMENTS

Rathburn Road East / Ponytrail Drive (Dixie Road to Burnhamthorpe Road)

LEGEND

-  Existing Pedestrian Crossing
-  New Pedestrian Crossing
-  Improved Pedestrian Crossing

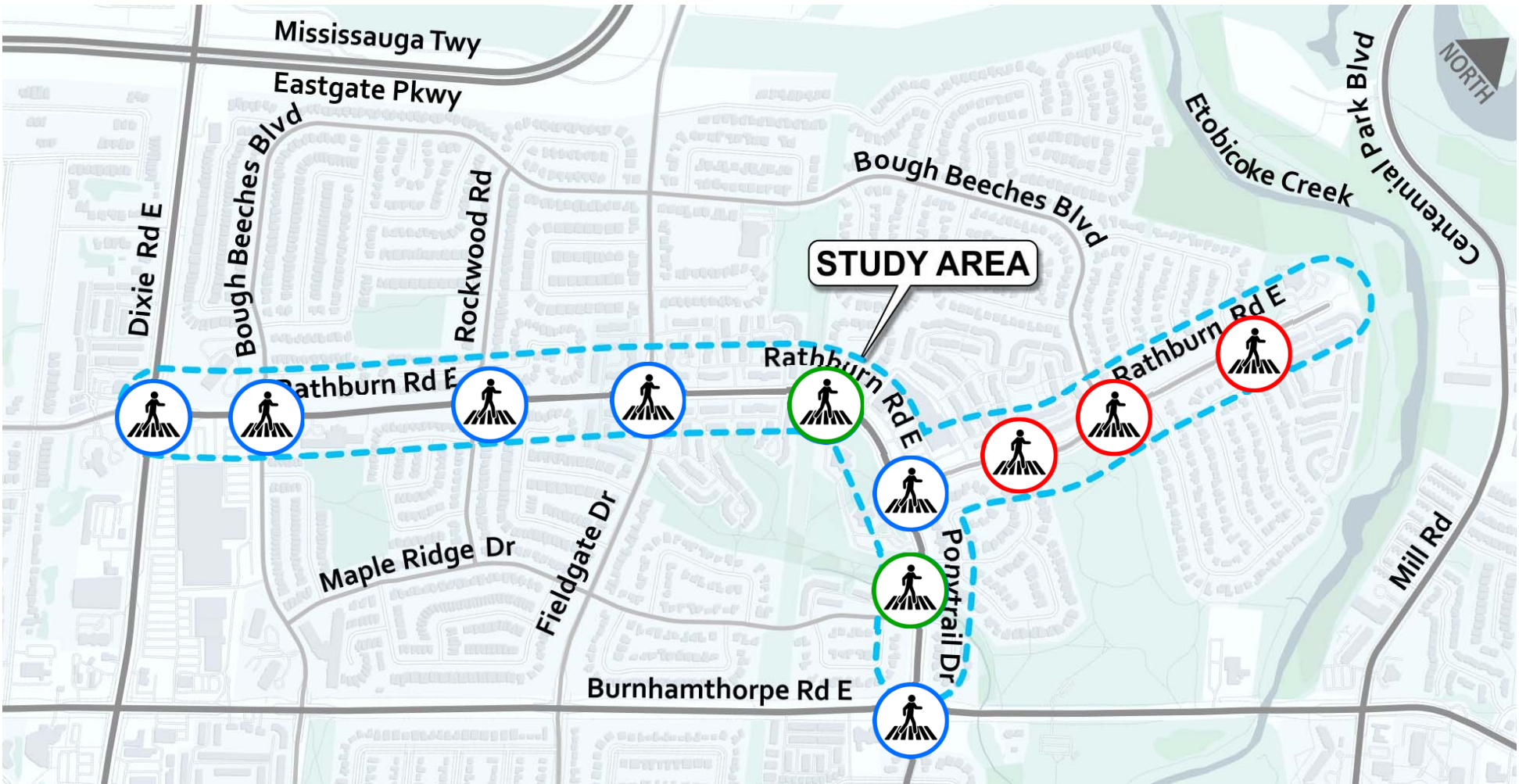

PREFERRED DESIGN CONCEPT

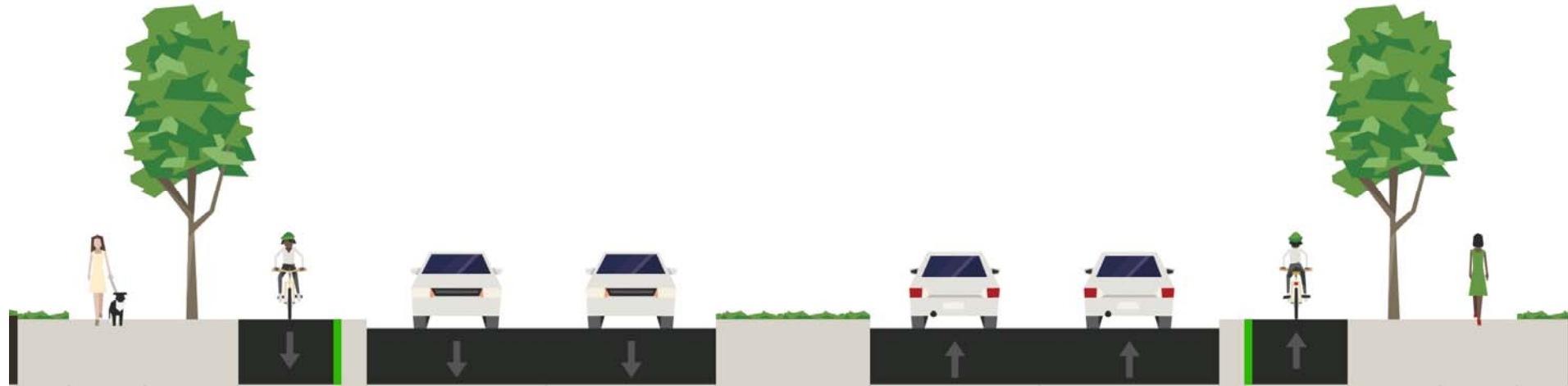

RATHBURN ROAD EAST / PONYTRAIL DRIVE (Dixie Road to Burnhamthorpe Road)



RATHBURN ROAD EAST (Ponytrail Drive to End of Cul-de-sac)

NEXT STEPS

Following this meeting the Project Team will:

Finalize the preferred plan



Initiate the Detailed Design and Tender Documentation process



Construction timing will be subject to funding availability and priorities