

5081 HURONTARIO STREET - PHASE II - PROPOSED MIXED-USE DEVELOPMENT

TYPICAL PARKING FLOOR PLAN

DRAWN: PLOT DATE: 11/6/2020 3:03:19 PM CHECKED:

A301

PARKING LEGEND
MISSISSAUGA ZONING BY-LAW - NO. 0225-2007, PART 3
PARKING SPACE DIMENSION (3.1.1.4)

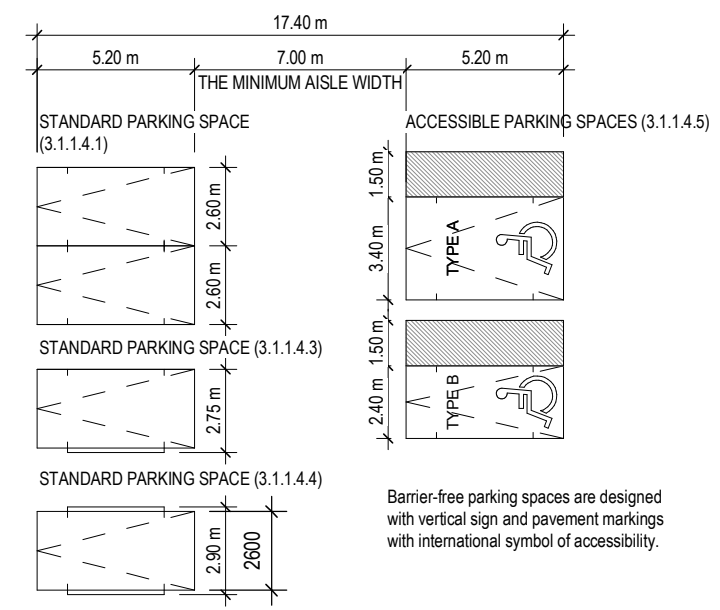

GENERAL TYPICAL FLOOR NOTES

- SHADED AREA DENOTES BULKHEADS AND DROP CEILINGS AT ALL RESIDENTIAL UNITS. SEE MECHANICAL DRAWINGS FOR COVERING OF HVAC DUCTS, DROP CEILINGS AND FURRING AS REQUIRED FOR INSTALLATION AND ENCLOSURE OF MECHANICAL AND ELECTRICAL SERVICES.
 - REFER TO INTERIOR DESIGN DRAWINGS FOR INTERIOR FINISHES AND SPECIFICATIONS.
 - BALCONY SLABS AND CONCRETE SILL CONDITIONS TO BE SLOPED AWAY FROM BUILDING FOR DRAINAGE. PROVIDE SCUPPER DRAIN FOR BALCONIES WITH CURBS. ALL TERRACES TO HAVE SCUPPERS, OR AREA DRAINS. SEE PLANS FOR LOCATIONS.
 - PROVIDE APPROVED SOUND INSULATION FOR HORIZONTAL AND VERTICAL PIPES THROUGH WALL AND FLOOR PENETRATION AS REQUIRED. REFER TO MECHANICAL DRAWINGS & ACoustICAL REPORT PREPARED BY HIG ENGINEERING.
 - REFER TO WINDOW SCHEDULE FOR LOCATION OF WINDOW OPENING SECTION AND INSECT SCREEN.
 - PROVIDE ALL FURRING SPACE AS REQUIRED FOR ELECTRICAL PANELS. REFER TO ELECTRICAL DRAWINGS FOR LOCATION AND DETAILS.
 - COORDINATE WITH MECHANICAL AND ELECTRICAL DRAWINGS FOR ALL PIPE AND SHAFT SLEEVE REQUIREMENTS.
 - ALL BATHROOM CEILINGS TO BE CONSTRUCTED AS PER DETAIL C18/A8.03. PROVIDE ADJUSTABLE BATTS IN ALL BATHROOM PIPE SPACES. SEE DETAIL C18/A8.03.
 - AT ALL STAIR PRESSURIZATION SHAFT ENCLOSURES, NO SERVICES SHALL BE ALLOWED TO PENETRATE, OR PASS THRU THIS ENCLOSURE.
 - ELEVATOR
- ELEVATOR SHAFT DIMENSIONS PROVIDED BY THE ELEVATOR CONSULTANT. SOBERMAN ENGINEERING. A COPY OF THIS REPORT CAN BE OBTAINED FROM THE OWNER. COORDINATE SHAFT SIZE AND REQUIREMENTS WITH REVIEWED ELEVATOR SHOP DRAWINGS.**
- ELEVATOR PIT LADDERS TO BE CO-ORDINATED WITH ELEVATOR SUPPLIER.**
- ELEVATOR SHAFT WALLS TO BE CONSTRUCTED TO ACHIEVE A MIN. FIRE RESISTANCE RATING OF 90 MIN.**
- AN APPROVED FIRE STOP MATERIAL IS TO BE USED TO SEAL INTERSECTION TOP OF CONCRETE BLOCK AT FLOOR SLABS.**
- ELEVATOR PIT LADDERS TO BE GALVANIZED STEEL AND EXTEND 100mm ABOVE SILL. LADDERS TO BE SUPPLIED & INSTALLED BY GENERAL CONTRACTOR.**
- LOCKER ROOM NOTES:**
ALL LOCKER AISLES WIDTH TO BE 1100mm (TYP). LOCKERS TO BE CONSTRUCTED WITH 6x6" WIRE MESH PARTITIONS MINIMUM 2100mm HIGH. PROVIDE WIRE MESH DOOR AND CEILING. ALL WIRE MESH CEILINGS TO BE 450mm BELOW SPRINKLER DEFLECTOR THROUGHOUT.
REVIEW LOCKER ROOM LAYOUT PREPARED BY ARCHITECT AND INSTALLER TO PROVIDE INSTALLATION SHOP DRAWINGS FOR REVIEW BY OWNER AND ARCHITECT.
- BICYCLE SPACE NOTES:**
ALL BICYCLE SPACES TO COMPLY WITH TORONTO BICYCLE BYLAW STANDARDS:
HORIZONTAL RACKING 600w x 1800d x 1900h
VERTICAL RACKING 600w x 1800d x 2540h
600w x 1200d x 1900h
NOTE: MINIMUM 1800mm WALKWAY WHERE BICYCLE PARKING IS REQUIRED IN THIS ENCLOSURE.
BICYCLE LOCKER NOTES:
REFER TO TYPICAL BICYCLE LOCKER DETAIL ON A2 SERIES DRAWINGS

GENERAL NOTES LEGEND

- 0.000 TOP OF CONCRETE SLAB - LOW POINT
- 0.000 TOP OF CONCRETE BEAM
- 0.000 TOP OF CONCRETE WALL
- 0.000 TOP OF CONCRETE CURB
- 0.000 TOP OF CONCRETE SLAB
- XXX SPRINKLER WINDOW ASSEMBLY
- Denotes CHAIN LINK FENCE
- EXISTING SPOT ELEVATION
- PROPOSED FINISHED SPOT ELEVATION
- PROPOSED FINISHED SPOT ELEVATION RELATIVE TO GROUND FLOOR ELEVATION
- PROPOSED LANDSCAPE ELEVATION
- WALL TYPE & FIRE RATING (SEE AS-SCHEDULES & A7-DETAILS)
- WINDOW TYPE (SEE AS-SCHEDULES & A7-DETAILS)
- XXX BARRIER FREE

- XXX ROOM NUMBER (SEE AS-SCHEDULES FOR ROOM FINISH SCHEDULES)
- FLOOR/CEILING ASSEMBLY TYPE (SEE AS-SCHEDULES & A7-DETAILS)
- DOOR NUMBER (SEE AS-SCHEDULES FOR DOOR & FRAME SCHEDULES)
- RAILING TYPE (SEE A7 SECTIONS FOR DETAILS)
- HATCH DENOTES SUSPENDED GYP BOARD CEILING, UNLESS OTHERWISE NOTED. REFER TO DETAIL C14/A8.03. (REFER TO PLANS & SECTIONS FOR EXTENT.)
- HATCH DENOTES THERMAL INSULATION AND HEATED PEX/PEM TO US OF SLAB. REFER TO DETAIL C14/A8.03. (REFER TO PLANS AND SECTIONS FOR EXTENT.)
- HATCH DENOTES THERMAL INSULATION TO US OF SLAB. REFER TO DETAIL C2/A8.03.
- HATCH DENOTES ACOUSTIC CEILING TO US OF SLAB. FER TO DETAIL A1/X/A8.03. (REFER TO PLANS AND SECTIONS FOR EXTENT.)
- HATCH DENOTES HORIZONTAL FIRE RATED ENCLOSURE. REFER TO DETAIL SVA/A8.03. REFER TO PROPERTY STANDARDS. (REFER TO PLANS FOR EXTENT.)
- BARRIER FREE

ABBREVIATIONS

- AD AREA DRAIN
- AFF ABOVE FINISH FLOOR
- AO AUTOMATIC DOOR OPERATOR
- AP ACOUSTIC PANEL
- ARC ARCHITECTURAL PRECAST CONCRETE
- APPROX APPROXIMATE
- AT APPROXIMATE
- AVB ABRASIVE BARRIER
- BF BARRIER FREE
- CACF CENTRAL ALARM CONTROL FACILITY
- CB CATCH BASIN
- DIP CAST-IN-PLACE CONCRETE CONSTRUCTION JOINT
- CMU CONCRETE MASONRY UNIT
- CL CLOSET
- COL CARBON MONOXIDE DETECTOR
- COL COLUMN
- CRG CURB
- CP CONTROL PANEL
- CRD CATCH READER
- DN DOWN
- DN DOWN
- ELEV ELEVATOR
- EDS EDGE OF SLAB
- EP ELECTRICAL PANEL
- EXT EXTERIOR
- FAP FIRE ALARM PULL
- FD FLOOR DRAIN
- FIC FIRE EXTINGUISHER CABINET
- FEL FINISH FLOOR LEVEL
- FH FIRE HYDRANT
- FHC FIRE HOSE CABINET
- FL FLOOR
- FRE FIRE RESISTANCE RATING
- GRB GRAF BAR
- HP HIGH POINT
- HR HOUR
- INT INTERIOR
- JAN JANITOR
- LAV LAVATORY
- LP LOW POINT
- LV LOW VOLTAGE
- MN MINIMUM
- OC ON CENTRE
- OP OPERABLE PANEL
- PB PUSH BUTTON
- RM ROOM
- RO ROUGH OPENING
- RWL RAIN WATER LEADER
- SA SMOKE ALARM
- SD SCUPPER DRAIN
- STC SOUND TRANSMISSION CLASSIFICATION TYPICAL
- US UNDERSIDE
- VEST VESTIBULE
- WC WATER CLOSET
- WDR WALKWAY
- WIC WALK IN CLOSET
- WR WASTE RECEPTACLE

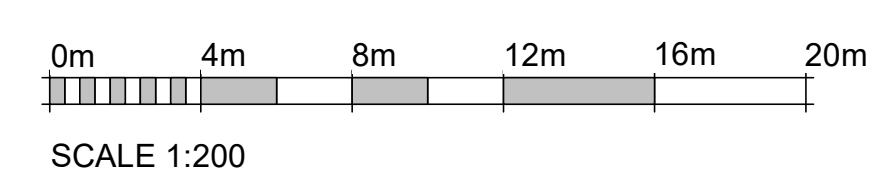
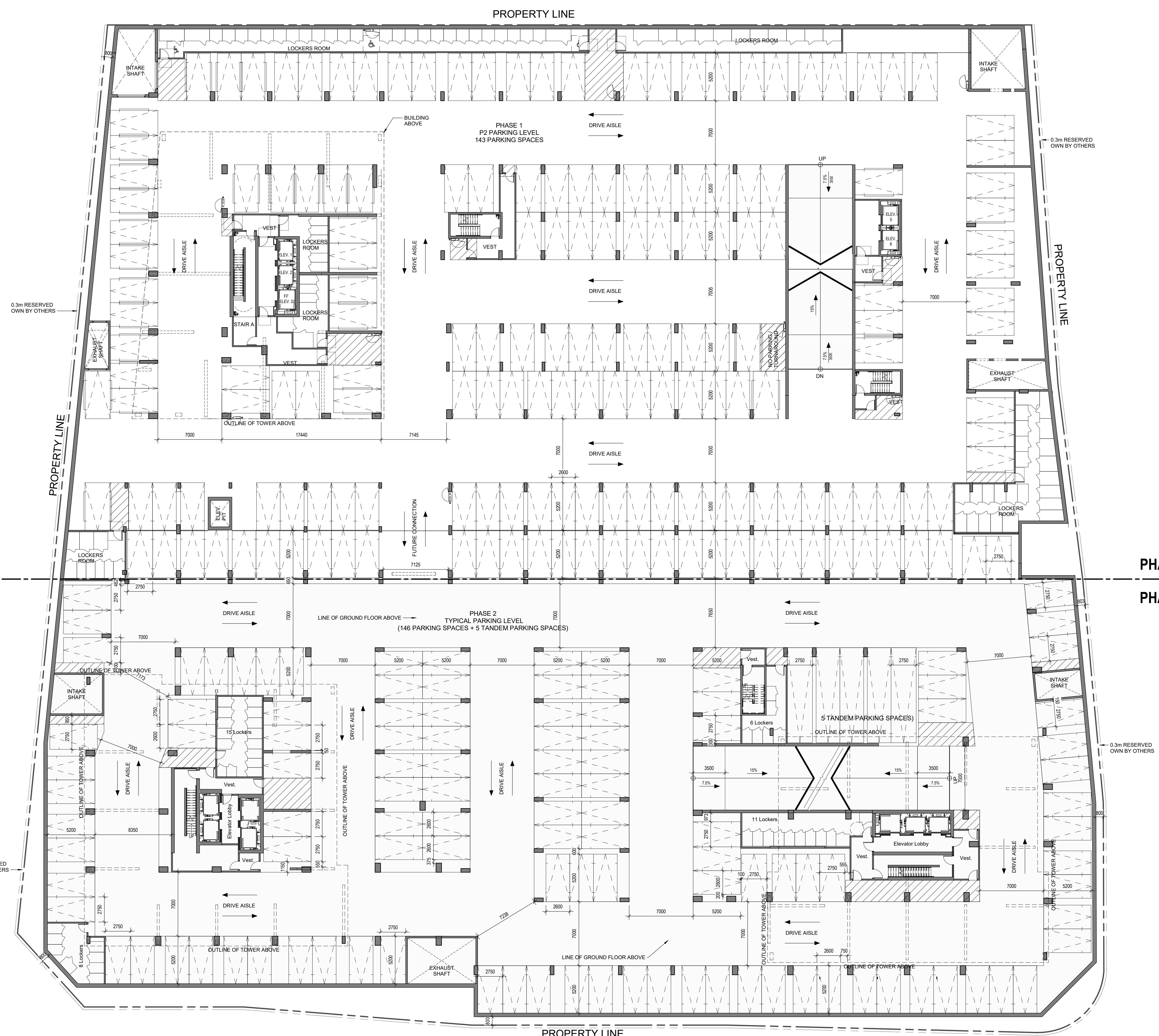

PARKING PLAN P2
SCALE: 1:200