

**581 HURONTARIO STREET - PHASE II - PROPOSED MIXED-USE DEVELOPMENT**

**PARKING PLAN - LEVEL P1**

DRAWN: 11/6/2020 3:03:37 PM CHECKED:

**A302**

**PARKING LEGEND**

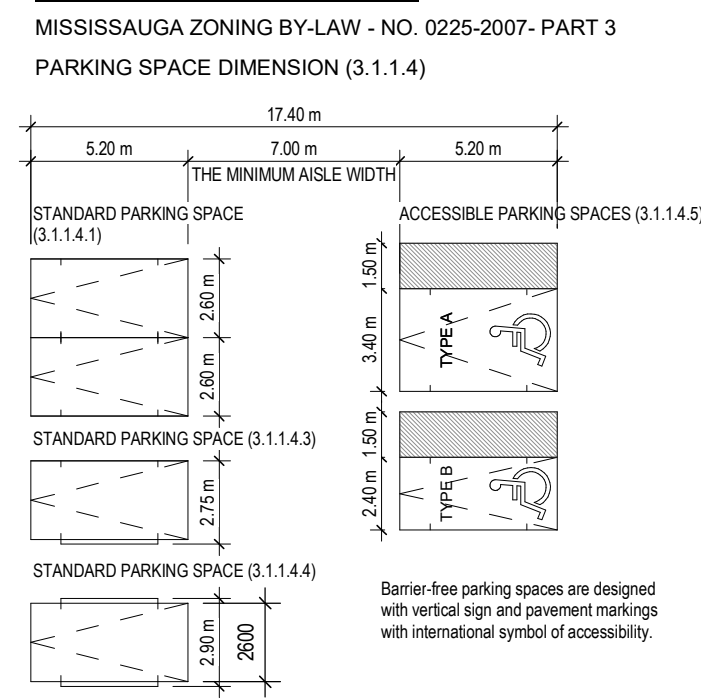

**GENERAL TYPICAL FLOOR NOTES**

- SHADED AREA DENOTES BULKHEADS AND DROP CEILINGS AT ALL RESIDENTIAL UNITS. SEE MECHANICAL DRAWINGS FOR COVERING OF HVAC DUCTS, DROP CEILINGS AND FLOORING AS REQUIRED FOR INSTALLATION AND ENCLOSURE OF MECHANICAL AND ELECTRICAL SERVICES.
- REFER TO INTERIOR DESIGN DRAWINGS FOR INTERIOR FINISHES AND SPECIFICATIONS.
- BALCONY SLABS AND CONCRETE SILL CONDITIONS TO BE BLED OFF AWAY FROM BUILDING FOR DRAINAGE. PROVIDE SCUPPER DRAIN FOR BALCONIES WITH CORERS. ALL TERRACES TO HAVE SCUPPERS, OR AREA DRAINS. SEE PLANS FOR LOCATIONS.
- PROVIDE APPROVED SOUND INSULATION FOR HORIZONTAL AND VERTICAL PIPES THROUGH WALL AND FLOOR PENETRATIONS AS REQUIRED. REFER TO MECHANICAL DRAWINGS & ACOUSTICAL REPORT PREPARED BY HSE ENGINEERING.
- REFER TO WINDOW SCHEDULE FOR LOCATION OF WINDOW OPENING SECTION AND INSECT SCREEN.
- PROVIDE ALL FLOORING SPACE AS REQUIRED FOR ELECTRICAL PANELS. REFER TO ELECTRICAL DRAWINGS FOR LOCATION AND DETAILS.
- COORDINATE WITH MECHANICAL AND ELECTRICAL DRAWINGS FOR ALL PIPE AND SHAFT SLEEVE REQUIREMENTS.
- ALL BATHROOM CEILINGS TO BE CONSTRUCTED AS PER DETAIL C18 / A4.03. PROVIDE ACOUSTICAL BATT IN ALL BATHROOM PIPE SPACES. SEE DETAIL C18 / A4.03.
- AT ALL STAIR PRESSURIZATION SHAFT ENCLOSURES, NO SERVICES SHALL BE ALLOWED TO PENETRATE OR PASS THRU THIS ENCLOSURE.
- ELEVATOR.

- ELEVATOR SHAFT DIMENSIONS PROVIDED BY THE ELEVATOR CONSULTANT. COORDINATE WITH MECHANICAL DRAWINGS. A COPY OF THIS REPORT CAN BE OBTAINED FROM THE OWNER. COORDINATE SHAFT SIZE AND REQUIREMENTS WITH REVIEWED ELEVATOR SHOP DRAWINGS.
  - ELEVATOR FITS SHALL BE CO-ORDINATED WITH ELEVATOR SUPPLIER.
  - ELEVATOR SHAFT WALLS TO BE CONSTRUCTED TO ACHIEVE A MIN. FIRE RESISTANCE RATING OF 90 MIN.
  - AN APPROVED FIRE STOP MATERIAL IS TO BE USED TO SEAL INTERSECTION TOP OF CONCRETE BLOCK AT FLOOR SLABS.
  - ELEVATOR PIT LADDERS TO BE GALVANIZED STEEL AND EXTEND 100mm ABOVE SILL. LADDERS TO BE SUPPLIED & INSTALLED BY GENERAL CONTRACTOR.
- LOCKER ROOM NOTES:**  
ALL LOCKER ASSES WITH TO BE 1100mm (TYP). LOCKERS TO BE CONSTRUCTED WITH ENP WIRE MESH PARTITIONS MINIMUM 2100mm HIGH. PROVIDE WIRE MESH DOOR AND CEILING. ALL WIRE MESH CEILING TO BE 450mm BELOW SPRINKLER DEFLECTOR THROUGHOUT.  
REVIEW LOCKER ROOM LAYOUT PREPARED BY ARCHITECT AND INSTALLER TO PROVIDE INSTALLATION SHOP DRAWINGS FOR REVIEW BY OWNER AND ARCHITECT.
- BICYCLE SPACES NOTES:**  
ALL BICYCLE SPACES TO COMPLY WITH TORONTO BICYCLE BYLAW STANDARDS:  
HORIZONTAL RACKING 800w x 1800dp x 1800p  
HORIZONTAL STACKED RACKING 800w x 1800dp x 2500p  
VERTICAL RACKING 800w x 1200dp x 1800p  
NOTE: MINIMUM 1500mm WALKWAY WHERE BICYCLE PARKING IS REQUIRED
- BICYCLE LOCKER NOTES:**  
REFER TO TYPICAL BICYCLE LOCKER DETAIL ON A2 SERIES DRAWINGS

**GENERAL NOTES LEGEND**

- TOP OF CONCRETE SLAB - LOW POINT
- TOP OF CONCRETE BEAM
- TOP OF CONCRETE WALL
- TOP OF CONCRETE CURB
- TOP OF CONCRETE SLAB
- SPRINKLERED WINDOW ASSEMBLY
- DENOTES CHAIN LINK FENCE
- EXISTING SPOT ELEVATION
- PROPOSED FINISHED SPOT ELEVATION
- PROPOSED FINISHED SPOT ELEVATION RELATIVE TO GROUND FLOOR ELEVATION
- PROPOSED LANDSCAPE ELEVATION
- WALL TYPE & FIRE RATING (SEE AS-SCHEDULES & A7-DETAILS)
- PROPOSED LANDSCAPE ELEVATION
- WALL TYPE & FIRE RATING (SEE AS-SCHEDULES & A7-DETAILS)
- PROPOSED LANDSCAPE ELEVATION

**ABBREVIATIONS**

- |      |                                |     |                                   |
|------|--------------------------------|-----|-----------------------------------|
| AD   | AREA DRAIN                     | FFL | FINISH FLOOR LEVEL                |
| AF   | AREA FINISH FLOOR              | PH  | FIRE HYDRANT                      |
| AO   | AUTOMATIC DOOR OPERATOR        | FHC | FIRE HOSE CABINET                 |
| AP   | APPROXIMATE                    | F   | FLOOR                             |
| APC  | ARCHITECTURAL PRECAST CONCRETE | FRR | FIRE RESISTANCE RATING            |
| APR  | APPROXIMATE                    | GRB | GRASS BARR                        |
| AT   | ACoustic TILE                  | HP  | HIGH POINT                        |
| AW   | ARCHITECTURAL WINDOW           | H   | HOUR                              |
| BF   | BARRIER FREE                   | INT | INTERIOR                          |
| CAF  | CENTRAL ALARM CONTROL FACILITY | JAN | JANITOR                           |
| CB   | CATCH BASIN                    | LAV | LAVATORY                          |
| CC   | CAST-IN-PLACE CONCRETE         | LP  | LOW POINT                         |
| CL   | CONCRETE JOINT                 | LV  | LOW VOLT                          |
| CM   | CONCRETE MASONRY UNIT          | M   | MINIMUM                           |
| CO   | CONCRETE                       | OC  | ON CENTRE                         |
| CO2  | CARBON MONOXIDE DETECTOR       | OP  | OPERABLE PANEL                    |
| COL  | COLLUM                         | PB  | PUSH BUTTON                       |
| CONC | CONCRETE                       | PR  | ROOM                              |
| CR   | CONTROL PANEL                  | R   | RAIN WATER LEADER                 |
| CR   | CARD READER                    | RA  | SCUPPER DRAIN                     |
| DN   | DOWN                           | SA  | SOUND TRANSMISSION CLASSIFICATION |
| EL   | ELECTRICAL                     | SD  | SCUPPER DRAIN                     |
| ELC  | ELECTRICAL CONTROL             | SL  | SOUND TRANSMISSION CLASSIFICATION |
| ELEV | ELEVATOR                       | STC | TYPICAL UNDERCO                   |
| EP   | EDGE OF SLAB                   | TYP | TYPICAL                           |
| ESP  | ELECTRICAL PANEL EXTERIOR      | VE  | VESTIBULE                         |
| FAP  | FIRE ALARM PULL EXTERIOR       | WC  | WATER CLOSET                      |
| FD   | FLOOR DRAIN                    | WD  | WASHER DRYER                      |
| FEC  | FIRE EXTINGUISHER CABINET      | WIC | WALK-IN CLOSET                    |
|      |                                | WR  | WASTE RECEPTACLE                  |

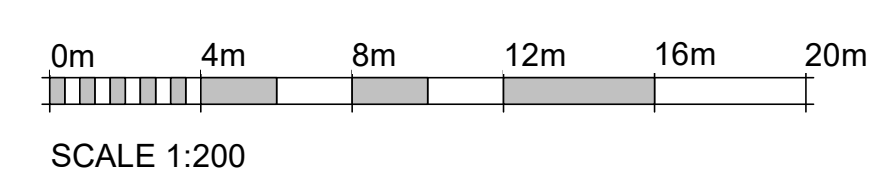
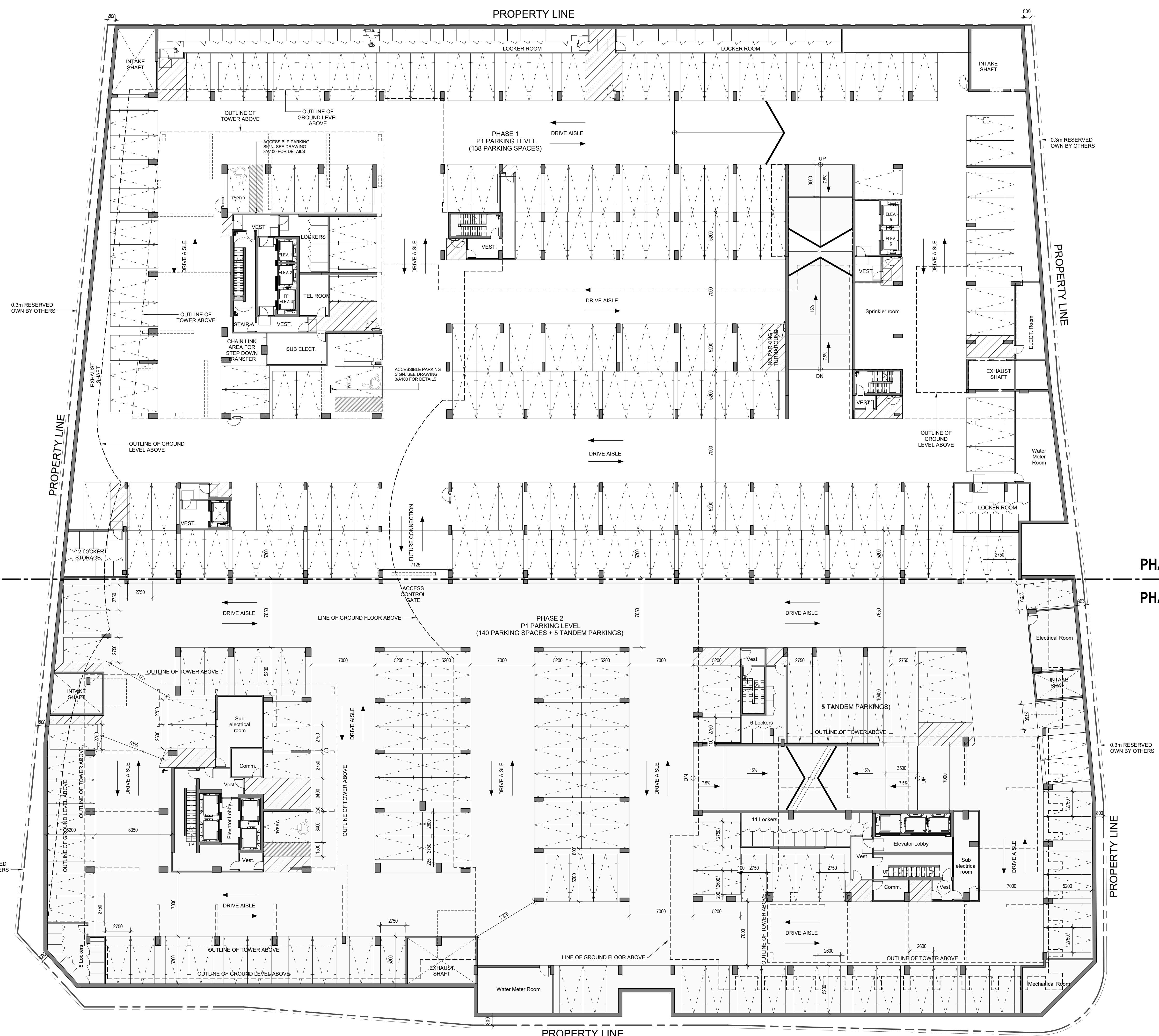

PARKING PLAN P1  
SCALE: 1:200