

Contractor shall check all dimensions on the work and report any discrepancy to the Landscape Architect before proceeding. All drawings and specifications are the property of the Landscape Architect and must be returned at the completion of the work. This drawing is not to be used for construction until signed by the Landscape Architect.

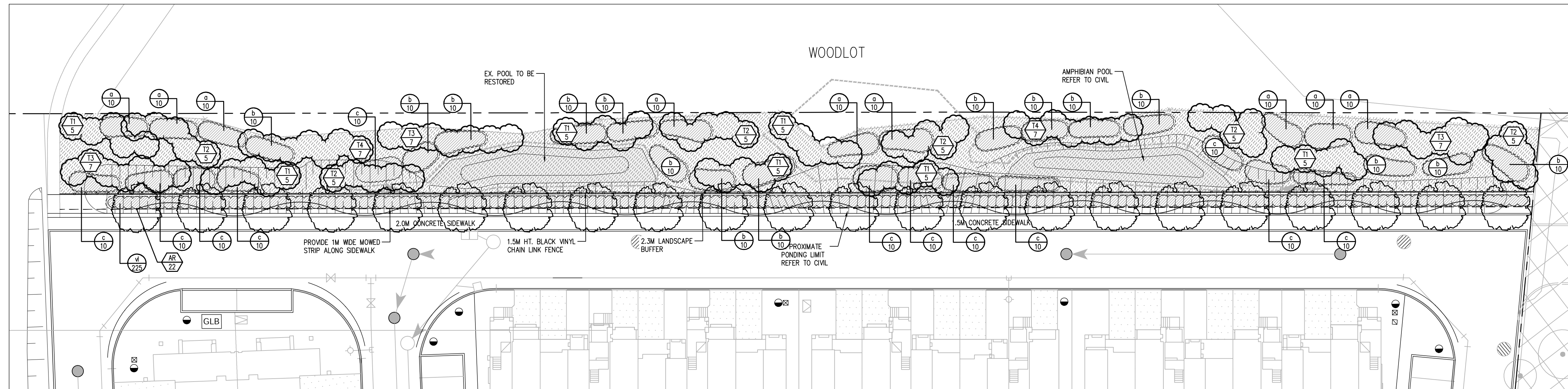

**LEGEND**

- PROPERTY LINE
- SWALE
- 1.5m HT. BLACK VINYL CHAIN LINK FENCE

**PLANTING**

- DECIDUOUS STREET TREE
- DECIDUOUS TREE
- CONIFEROUS TREE
- MULTI-STEM TREE
- SHRUBS
- LIMIT OF BED
- BULB PLANTING

**SURFACING**

- SEED MIX A - LOWLAND RESTORATION MIX

**DETAIL KEY**

- 5 - DETAIL NO.
- D-2 - SHEET NO.

**PLANTING KEY**

- XX - TREE SPECIES QUANTITY
- XX - SHRUB SPECIES QUANTITY

**GENERAL NOTES:**

- THE CONTRACTOR SHALL MAKE CAREFUL EXAMINATION OF EXISTING SITE SURFACE CONDITIONS AND TOPOGRAPHY AND ADVISE THE LANDSCAPE ARCHITECT OR ECOLOGIST OF UNSATISFACTORY SITE SURFACE CONDITIONS AND TOPOGRAPHY PRIOR TO COMMENCEMENT OF CONSTRUCTION. COMMENCEMENT OF CONSTRUCTION WILL MEAN THAT THE CONTRACTOR HAS ACCEPTED THE EXISTING SITE SURFACE CONDITIONS AND TOPOGRAPHY AND NO ALLOWANCE WILL BE MADE LATER FOR ANY EXPENSES INCURRED THROUGH FAILURE TO NOTE UNSATISFACTORY CONDITIONS.
- CONTRACTOR TO REFER TO DRAWINGS AS PREPARED BY NAK DESIGN STRATEGIES TO COORDINATE CONSTRUCTION HOARDING AND ACCESS.
- UNLESS OTHERWISE STATED, ALL WORK SHALL CONFORM TO THE LANDSCAPE ONTARIO SPECIFICATIONS STANDARDS.
- NO CONSTRUCTION ACTIVITY, STOCKPILING OR STAGING ARE TO OCCUR OUTSIDE THE LIMIT OF DISTURBANCE.
- STORAGE OF MATERIALS, EQUIPMENT AND VEHICLES SHALL NOT BE PERMITTED WITHIN MUNICIPAL ROAD ALLOWANCE. CONTRACTOR MUST OBTAIN TOWN PERMITS FOR ROAD OCCUPANCY AND MUST BE IN CONFORMANCE TO BOOK 7 ROADWAY SAFETY STANDARDS.
- CONTRACTOR SHALL BE RESPONSIBLE TO CLEAN ROADS AND WALKWAYS DAILY TO THE SATISFACTION OF THE CONTRACT ADMINISTRATOR.
- SITE SHALL BE MAINTAINED IN A CLEAN AND ORDERLY STATE FOR THE DURATION OF CONSTRUCTION AND ALL WORK SHALL BE PERFORMED IN ACCORDANCE WITH THE OCCUPATIONAL HEALTH AND SAFETY ACT.
- ALL TEMPORARY PROTECTIVE FENCING INCLUDING EROSION SEDIMENT CONTROL FENCING SHALL BE MAINTAINED BY THE CONTRACTOR TO THE SATISFACTION OF THE CONTRACT ADMINISTRATOR FOR THE DURATION OF THE CONSTRUCTION.
- ALL EXISTING VEGETATION TO BE PROTECTED UNDER THIS CONTRACT SHALL BE SECURED BY THE CONTRACTOR FOR THE DURATION OF THE CONTRACT. ANY DAMAGES INCURRED TO BE RECTIFIED AT THE COST TO THE CONTRACTOR.
- ALL EXISTING UTILITIES SHOWN ON THE DRAWINGS ARE FOR REFERENCE ONLY. THE CONTRACTOR SHALL CONTACT UTILITY COMPANIES FOR UTILITY STAKEOUTS AND LOCATES. THE CONTRACTOR SHALL BE RESPONSIBLE FOR THE REPAIR TO ANY DAMAGES CAUSED TO EXISTING UTILITIES DURING CONSTRUCTION.
- CONTRACTOR TO PRESERVE AND PROTECT ALL EXISTING UTILITIES.
- ALL CONSTRUCTION TO BE CARRIED OUT IN ACCORDANCE TO THE MOST CURRENT PROVINCIAL AND MUNICIPAL STANDARDS AND SPECIFICATIONS.
- PRIOR TO TERRACING, THE SUBSOIL MUST BE TILLED (UNDER DRY CONDITIONS) TO A MAXIMUM DEPTH OF 45 CM. TILLING AND SCARIFICATION WILL NOT OCCUR WITHIN THE CREATED PONDS OR WITHIN THE TREE PROTECTION ZONE TO MINIMIZE DISTURBANCE. ALL AREAS DISTURBED DURING CONSTRUCTION TO BE RESTORED WITH 300mm TOPSOIL AND SEED/SOD TO THE SATISFACTION OF THE CONTRACT ADMINISTRATOR. ALL CONSTRUCTION ACCESS AREAS AND MATERIAL STOCK PILE AREAS TO BE SCARIFIED / ROTO-TILLED TO A DEPTH OF 150mm AND STABILIZED FOR SEEDING. COMPACTION RATE TO BE 80% SPD.
- CONTRACTOR TO REPAIR ALL DAMAGES TO HARD SURFACES TO THE SATISFACTION OF THE CONTRACT ADMINISTRATOR, AT NO ADDITIONAL COST TO THE OWNER.
- ALL NURSERY STOCK SHALL MEET STANDARDS OF THE CANADIAN NURSERY TRADES ASSOCIATION, LATEST EDITION. ALL PLANT MATERIAL SHALL BE STAKED FOR INSPECTION AND APPROVAL BY THE LANDSCAPE ARCHITECT OR ECOLOGIST.
- CONTRACTOR SHALL TAKE ALL NECESSARY MEASURES TO CONTROL DUST ON THE PROJECT SITE ON A DAILY BASIS.
- SAVANITA INC. CANNOT GUARANTEE THE ACCURACY OF THE INFORMATION AS PROVIDED ON THE SURVEY. ANY AND ALL LIABILITIES FOR DAMAGE DIRECT OR INDIRECT, HOWEVER CAUSED AND RESULTING IN ANYWAY BY THE USE OF THE SUPPLIED DATA SHOWN ON THE SURVEY IS THE FULL RESPONSIBILITY OF THE USER.
- LANDSCAPING CONTRACTOR TO PROVIDE 72 HOURS NOTICE TO THE ECOLOGIST AND LANDSCAPE ARCHITECT IF SPECIES, SIZE AND/OR QUANTITY IS NOT AVAILABLE AND SUBSTITUTIONS ARE NEEDED. ECOLOGIST TO IDENTIFY SUITABLE SUBSTITUTIONS AND HAVE THESE SUBSTITUTIONS APPROVED BY CVC AND CITY.
- PLANTINGS MAY BE MINIMALLY ADJUSTED TO SUIT LOCATIONS OF SITE UTILITY STRUCTURES OR SERVICES.
- ECOLOGIST TO IDENTIFY SUITABLE SUBSTITUTIONS AND HAVE THESE SUBSTITUTIONS APPROVED BY CVC AND CITY. LANDSCAPING CONTRACTOR TO PROVIDE ECOLOGIST AND LANDSCAPE ARCHITECT WITH 48 HOURS NOTICE BEFORE AN AREA IS TO BE PLANTED. LAYOUT OF PLANT MATERIAL TO BE REVIEWED BY THE ECOLOGIST PRIOR TO INSTALLATION.
- ALL SPECIES SUBSTITUTIONS AND STOCK SIZE ADJUSTMENTS MUST BE APPROVED THROUGH THE ECOLOGIST, LANDSCAPE ARCHITECT, AND CITY BEFORE THE SUBSTITUTION IS PLANTED.
- PROVIDE 1.2m BIODEGRADABLE TRUNK PROTECTORS FOR ALL DECIDUOUS WHIPS.
- WATERING IS REQUIRED TO PROMOTE HEALTHY GROWTH. FOR ALL PLANT MATERIAL, WATER THOROUGHLY IN LATE FALL PRIOR TO FREEZE UP TO SATURATE SOIL AROUND ROOT SYSTEM.
- CONTRACTOR TO PROVIDE A TWO-YEAR WARRANTY REPLACEMENT PERIOD FOR ALL TREES AT 40mm DIAMETER CALIPER AND LARGER.
- FINAL INSPECTION TO OCCUR AFTER THE SECOND YEAR ON HARDSCAPE AND PLANT MATERIAL. DEPENDING ON THE NATURE OF REPLACEMENTS REQUIRED, EXTENDED WARRANTIES MAY APPLY. REPLACEMENTS SHALL BE MADE WITHIN 30 DAYS FROM THE DATE OF INSPECTION UNLESS OTHERWISE DIRECTED BY THE LANDSCAPE ARCHITECT. CONTRACTOR IS RESPONSIBLE TO MAINTAIN WATERING, TRIMMING, AND REPLACEMENT OF DEAD MATERIAL (WITHIN 2 WEEKS) DURING WARRANTY PERIOD.
- AT THE TIME OF FINAL INSPECTION, ALL PLANT MATERIAL SHALL BE IN A HEALTHY, VIGOROUS GROWING CONDITION, PLANTED IN FULL ACCORDANCE WITH DRAWINGS AND CONDITIONS.
- TREE PROTECTION FENCING TO BE INSTALLED PRIOR TO GRADING WITH OVERSIGHT BY ECOLOGIST. CONTRACTOR TO ACTIVELY MAINTAIN THIS FENCING.
- NO HEAVY EQUIPMENT, STOCKPILING OR REFUSE IS PERMITTED INSIDE THE TREE PROTECTION FENCING.

**PROPOSED PLANT LIST - BUFFER BLOCK**

KEY	QTY.	BOTANICAL NAME	COMMON NAME	SIZE/REMARKS
<b>TREES</b>				
AR	22	ACER RUBRUM	RED MAPLE	60mm CAL B&B
TREE MIX T1 (35 TREES)				
40%	14	TILIA AMERICANA	BASSWOOD	100 CM HT. WHIP
40%	14	QUERCUS RUBRA	NORTHERN RED OAK	100 CM HT. WHIP
20%	7	ACER SACCHARINUM	SILVER MAPLE	100 CM HT. WHIP
TREE MIX T2 (30 TREES)				
20%	6	ULMUS AMERICANA	AMERICAN ELM	100 CM HT. WHIP
20%	6	TSUGA CANADENSIS	HEMLOCK	100 CM HT. WHIP
60%	18	CARYA OVATA	SHAGBARK HICKORY	100 CM HT. WHIP
TREE MIX T3 (21 TREES)				
44%	9	ACER RUBRUM	RED MAPLE	100 CM HT. WHIP
22%	6	FICEX GLAUCIA	WHITE SPRUCE	100 CM HT. WHIP
28%	6	QUERCUS RUBRA	NORTHERN RED OAK	100 CM HT. WHIP
TREE MIX T4 (14 TREES)				
35%	5	TSUGA CANADENSIS	HEMLOCK	100 CM HT. WHIP
35%	5	TILIA AMERICANA	BASSWOOD	100 CM HT. WHIP
28%	4	ACER SACCHARINUM	SILVER MAPLE	100 CM HT. WHIP
<b>DECIDUOUS SHRUBS</b>				
VI	225	VBURNUM LENTAGO	NANNYBERRY	60cm ht. 3 gal POTTED
<b>MIX a - UPLAND (90)</b>				
50%	45	PRUNUS VIRGINIANA	CHOCHECHERRY	40cm ht. POTTED
50%	45	RUBUS IDAEUS	RED RASPBERRY	40cm ht. POTTED
<b>MIX b - FLOORPLAN (150)</b>				
50%	75	CORNUS FRACEMOSA	GREY DOGWOOD	60cm ht. POTTED
50%	75	VBURNUM LENTAGO	NANNYBERRY	60cm ht. POTTED
<b>MIX c - LOWLAND (120)</b>				
50%	60	CORNUS SERICEA	RED-OSER DOGWOOD	60cm ht. POTTED
50%	60	SALIX DISCOLOR	PUSSY WILLOW	60cm ht. POTTED

**PROPOSED SEED MIX**

BOTANICAL NAME	COMMON NAME
SEED MIX A - CVC 3-LOWLAND RESTORATION MIX	SEED RATE: 25kg/ha
1%	ANEMONE CANADENSIS
1%	BIENS GERANIA
25%	CAREX VULPINOIDEA
25%	ELIMYS VIRGINICUS VAR. VIRGINICUS
1%	EUTROCHUM MACULATUM VAR. MACULATUM
5%	JUNCUS EFFUSUS SSP. SOLUTUS
5%	JUNCUS TENNIS
25%	POA PALUSTRIS
5%	SCORPUS ATROVIRENS
1%	SYMPHYOTRICHUM NOVAE-ANGLIAE
1%	SYMPHYOTRICHUM PUNICEUM
5%	VERBENA HASTATA
100%	
<b>NURSE CROP</b>	
40%	AVENA SATIVA
15%	ELIMYS CANADENSIS
45%	HORDEUM VULGARE
100%	

No.	Description	Date
7	Issued for Review	Feb.16/21
6	Issued for Review	Nov.03/20
5	Issued for Review	Oct.23/20
4	Issued for Review	Oct.19/20
3	Issued for Review	Oct.01/20
2	Issued for Review	Sept.25/20
1	Issued for Review	Sept.3/20

Revision

City Approval Stamp

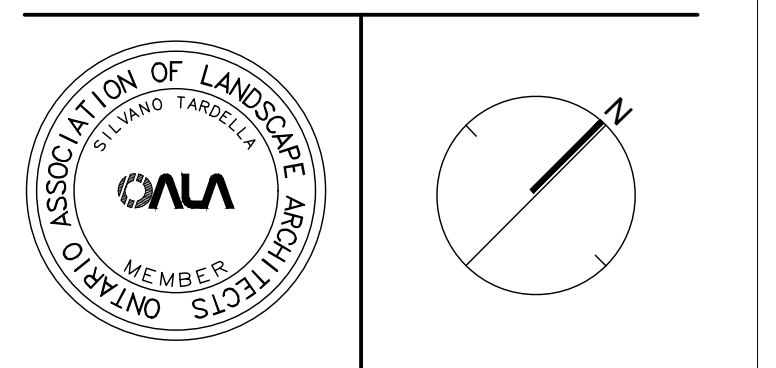

**NAK**  
design strategies

431 BONDCEVALES AVENUE, TORONTO, ON M6B 2N1 CANADA  
T 416.340.8700 F 416.340.7100 NAKDESIGNSTRATEGIES.COM

Project

**Ninth Line South Block**  
5150 Ninth Line

Title  
**BUFFER BLOCK LANDSCAPE PLAN**

Date	September 2020	Sheet	<b>L1</b>
Scale	1:300		
Drawn	sc		
Checked	yl		
Job No.	19-301		