

CROSS SECTION A-A
1:50

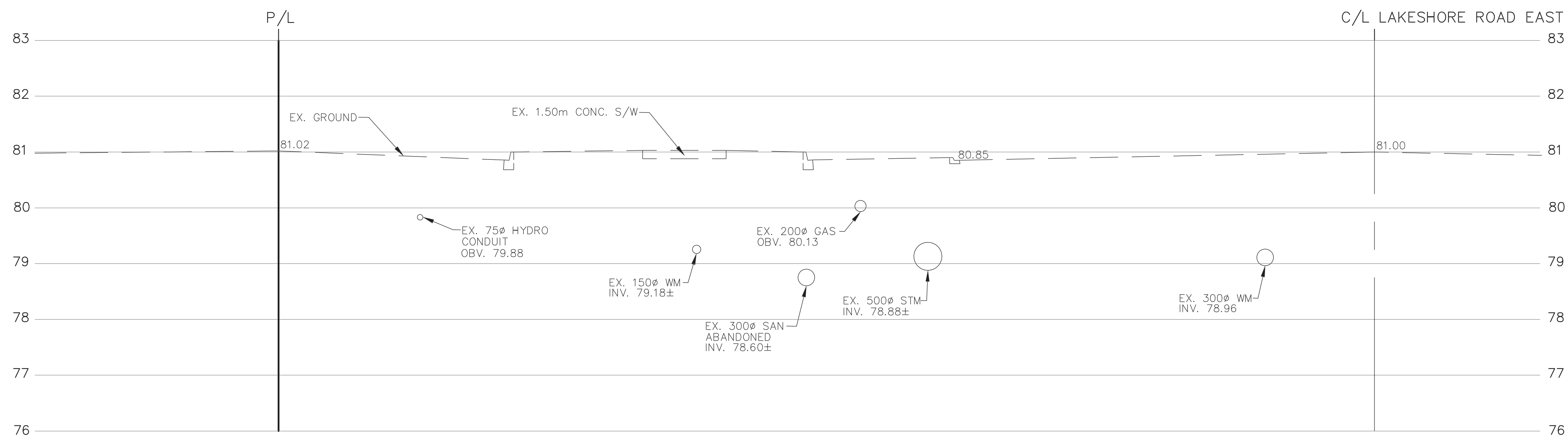

CROSS SECTION B-B
1:50

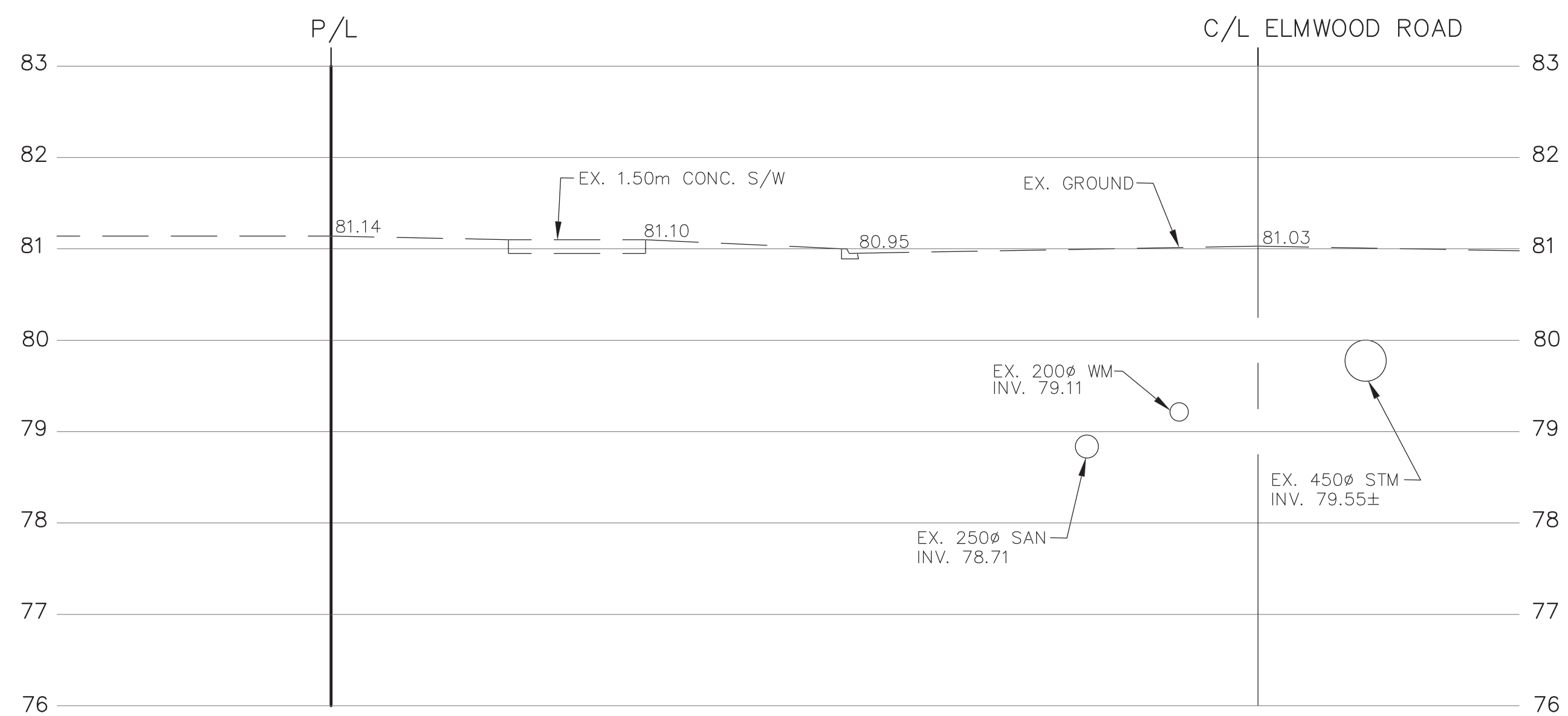

CROSS SECTION C-C
1:50

GENERAL NOTES

1. THE CONTRACTOR IS TO CHECK AND VERIFY ALL DIMENSIONS. IF ANY DISCREPANCIES, THEY MUST BE REPORTED TO THE ENGINEER IMMEDIATELY PRIOR TO CONSTRUCTION.
2. THE CONTRACTOR IS RESPONSIBLE FOR LOCATING AND PROTECTING ALL UTILITIES DURING CONSTRUCTION. GAS, FIBRE, TELEPHONE OR ANY OTHER UTILITIES THAT MAY EXIST ON THE SITE OR WITHIN THE STREETLINES MUST BE LOCATED BY ITS OWN UTILITIES AND VERIFIED PRIOR TO CONSTRUCTION.
3. ALL CONNECTIONS SHALL BE INSTALLED AS PER MUNICIPAL STANDARDS AND SPECIFICATIONS.
4. BUILDER IS TO VERIFY TO THE ENGINEER THAT THE FINAL FOOTING ELEVATION AND TOP OF FOUNDATION WALL ELEVATION ARE IN CONFORMITY WITH THE BUILDING CODE AND THE CERTIFIED GRADING PLAN PRIOR TO PROCEEDING.
5. THE ELEVATION OF THE SIDE SWALE AT THE BUILDING LINE SHALL BE A MINIMUM OF 150mm BELOW THE BUILDING LINE AT THE CENTRE OF THE SWALE.
6. OUTSIDE FINISHED GRADE TO BE A MINIMUM OF 150mm BELOW BRICK VENEER ELEVATION.
7. PRIOR TO ANY SOILING, THE BUILDER IS TO ENSURE TO THE SOILS CONSULTANT AND/OR THE ENGINEER THAT THE LOT HAS BEEN GRADED AND TOPSOILED AND SOILED/COMPLETED WITH A MINIMUM DEPTH OF 100mm OF TOPSOIL AND NO. 1 NURSERY SOIL AND A MINIMUM DEPTH OF 100mm OF CRUSHED STONE TO BE PROVIDED ON THE ENTIRE LENGTH OF EACH DRIVEWAY ON A FIRM SUBGRADE AND THE DRIVEWAY TO BE FINISHED WITH A MINIMUM COMPACTED DEPTH OF 75mm OF ASPHALT BETWEEN THE CURB AND THE GARAGE.
8. NO SOILING ON ANY LOTS IS PERMITTED UNTIL PRELIMINARY INSPECTION IS DONE BY THE ENGINEER AND THE BUILDER.
9. THE DRIVEWAY GRADE WILL BE COMPATIBLE WITH THE EXISTING OR FUTURE SIDEWALK AND CURB DEPRESSION WILL BE PROVIDED FOR EACH ENTRANCE.
10. DRIVEWAY GRADES SHOULD NOT BE LESS THAN 2.0% AND NOT GREATER THAN 8%.
11. LAWN AND GRASSES SHALL HAVE A MINIMUM SLOPE OF 1.0% (PREFERRED 2%) AND A MAXIMUM SLOPE OF 4%.
12. WHERE GRADES EXCEEDS 4% ARE REQUIRED, THE MAXIMUM SLOPE SHALL BE 3:1. GRADE CHANGES IN EXCESS OF 1.0m ARE TO BE ACCOMPLISHED BY USE OF A RETAINING WALL. RETAINING WALLS HIGHER THAN 0.6m SHALL HAVE A FENCE INSTALLED ON THE HIGH SIDE.
13. THE SERVICE CONNECTION TRENCH WITHIN THE TRAVELLED PORTION OF THE ROAD ALLOWANCE SHALL BE BACKFILLED WITH UNDRIPPABLE BACKFILL MATERIAL AS PER C.M. STD. 200.010, 200.011 AND 200.012 UNLESS OTHERWISE SPECIFIED PRIOR APPROVAL FOR OTHER BACKFILL MATERIAL HAS BEEN OBTAINED.
14. ALL WATERMANS AND WATER SERVICE MATERIALS AND CONSTRUCTION METHODS MUST CORRESPOND TO CURRENT MUNICIPAL STANDARDS & SPECIFICATIONS.
15. WATERMANS AND/OR WATER SERVICES ARE TO HAVE A MIN. DEPTH OF 0.7m WITH A MIN. HORIZONTAL SPACING OF 1.2m FROM THEMSELVES AND OTHER UTILITIES.
16. SEDIMENT CONTROL FENCE TO BE INSTALLED AS PER C.M. STD. 200.010.

ALL INTERNAL EXISTING SERVICES AND APPURTENANCES NOT UTILIZED FOR SERVICING OF THIS PROJECT ARE TO BE REMOVED OFF SITE UNLESS OTHERWISE DIRECTED BY THE ENGINEER.

INFORMATION SHOWN HEREON REGARDING THE SIZE AND LOCATION OF EXISTING SERVICES AND/OR UTILITIES IS FURNISHED AS THE BEST AVAILABLE INFORMATION AND SHALL BE INTERPRETED AS THE CONTRACTOR SEES FIT WITH THE UNDERSTANDING THAT THE OWNER DISCLAIMS ALL RESPONSIBILITY FOR ITS SUFFICIENCY AND/OR ACCURACY.

THIS IS TO CERTIFY THAT THE INFORMATION ON THIS PLAN IS COMPLETE, ACCURATE AND BASED ON GTA SITEWORKS (2018) LTD. & WITNESSED BY SKIRA & ASSOCIATES LTD. INCLUDING ENERSOURCE LOCATES.

SIGNED BY ENGINEER



C.M. BENCHMARK No. 757 ELEVATION: 83.725m
DESCRIPTION: ON THE NORTH FACE OF THE EAST CORNER OF THE NORTH WALL OF A CONCRETE BRIDGE ON INGLEWOOD DRIVE, 18m WEST OF HURONTARIO STREET.

SKIRA & ASSOCIATES LTD.
CONSULTING ENGINEERS
3464 Semenyk Court, Suite 100, Mississauga, Ontario L5C 4P8
Tel. (905) 276-5100 Fax. (905) 270-1936 Email - info@skiraconsult.ca

HIGH-RISE RESIDENTIAL BUILDING

LOT 43 REG. PLAN F-12, LOTS 1, 2 & 3, PART OF LOT 4 REG. PLAN C-27

170 LAKESHORE ROAD EAST

LIGHTPOINT

#600-3250 BLOOR ST. W. TORONTO ON M8X 2X9 TEL: (416) 420-0837



EXISTING CROSS-SECTIONS

S.P.

DATE: AUGUST 2021	AREA: Z-07	DWG No:
SCALE: AS NOTED	DRAWN BY: E.W.	C105
CITY FILE:	REGION FILE:	PROJECT No: 221-M82

