

GENERAL NOTES

1. THE CONTRACTOR IS RESPONSIBLE FOR LOCATING AND PROTECTING ALL UTILITIES DURING CONSTRUCTION. THE CONTRACTOR SHALL BE RESPONSIBLE FOR OBTAINING ALL NECESSARY PERMITS AND APPROVALS FROM THE CITY OF MISSISSAUGA AND THE PROVINCE OF ONTARIO.
2. ALL CONNECTIONS SHALL BE INSTALLED AS PER MUNICIPAL STANDARDS AND SPECIFICATIONS.
3. THE CONTRACTOR SHALL BE RESPONSIBLE FOR OBTAINING ALL NECESSARY PERMITS AND APPROVALS FROM THE CITY OF MISSISSAUGA AND THE PROVINCE OF ONTARIO.
4. THE ELEVATION OF THE SIDE GRADE AT THE BUILDING LINE SHALL BE A MINIMUM OF 150mm BELOW THE BUILDING LINE AT THE CORNER OF THE GRADE.
5. THE ELEVATION OF THE SIDE GRADE AT THE BUILDING LINE SHALL BE A MINIMUM OF 150mm BELOW THE BUILDING LINE AT THE CORNER OF THE GRADE.
6. FROM TO ANY BUILDING, THE BUILDING IS TO BE CONSTRUCTED TO THE BUILDING LINE AND THE CONTRACTOR SHALL BE RESPONSIBLE FOR OBTAINING ALL NECESSARY PERMITS AND APPROVALS FROM THE CITY OF MISSISSAUGA AND THE PROVINCE OF ONTARIO.
7. THE CONTRACTOR SHALL BE RESPONSIBLE FOR OBTAINING ALL NECESSARY PERMITS AND APPROVALS FROM THE CITY OF MISSISSAUGA AND THE PROVINCE OF ONTARIO.
8. NO BUILDING ON ANY LOTS IS PERMITTED UNTIL PRELIMINARY INSPECTION IS DONE BY THE ENGINEER AND THE CONTRACTOR.
9. THE DRIVEWAY GRADE SHALL BE COMPATIBLE WITH THE EXISTING OR FUTURE SIDEWALK AND CURB DEPRESSIONS AND SHALL BE PROVIDED FOR EACH ENTRANCE.
10. DRIVEWAY GRADES SHALL NOT BE LESS THAN 2.0% AND NOT GREATER THAN 8.0%.
11. LOTS AND DRIVEWAYS SHALL HAVE A MINIMUM SLOPE OF 0.5% PROPOSED TO AND MAXIMUM SLOPE OF 8.0%.
12. WHERE GRADES IN EXCESS OF 8% ARE REQUIRED, THE MAXIMUM SLOPE SHALL BE 3.1% GRADE CHANGES IN EXCESS OF 10% SHALL BE PROVIDED WITH A MINIMUM OF 10% SLOPE.
13. THE SERVICE CONNECTIONS WITHIN THE TRAVEL PORTION OF THE ROAD SHALL BE INSTALLED WITHIN THE TRAVEL PORTION OF THE ROAD AND SHALL BE INSTALLED WITHIN THE TRAVEL PORTION OF THE ROAD.
14. ALL WATER MAINS AND WATER SERVICE MAINS AND CONSTRUCTION METHODS MUST CORRESPOND TO CURRENT MUNICIPAL STANDARDS AND SPECIFICATIONS.
15. WATER MAINS AND WATER SERVICES ARE TO HAVE A MIN. DEPTH OF 1.0m WITH A MIN. HORIZONTAL SPACING OF 3.0m FROM THE GRADE AND OTHER UTILITIES.
16. SEWAGE CONTROL FENCE TO BE INSTALLED AS PER C.M. STD. 240.015.

ROADS

1. ALL UTILITIES SHALL BE RELOCATED AND EXEMPTED TO BE CONSTRUCTED TO A MIN. 90% STANDARD PROTECTIVE ENCASEMENT. THE SUBURBAN AND PROTECTIVE ENCASEMENT SHALL BE PROVIDED BY THE CONTRACTOR AND SHALL BE PROVIDED BY THE CONTRACTOR AND SHALL BE PROVIDED BY THE CONTRACTOR.
2. THE DEVELOPER/CONTRACTOR IS RESPONSIBLE FOR LOCATING AND PROTECTING ALL EXISTING UTILITIES PRIOR TO ANY CONSTRUCTION. THE CONTRACTOR SHALL BE RESPONSIBLE FOR OBTAINING ALL NECESSARY PERMITS AND APPROVALS FROM THE CITY OF MISSISSAUGA AND THE PROVINCE OF ONTARIO.
3. THE DEVELOPER/CONTRACTOR MUST ENSURE THAT A SUBGRADE CERTIFICATE IS ISSUED BY THE SUBGRADE ENGINEER TO THE CITY OF MISSISSAUGA AND THE PROVINCE OF ONTARIO.
4. THE CONTRACTOR SHALL BE RESPONSIBLE FOR OBTAINING ALL NECESSARY PERMITS AND APPROVALS FROM THE CITY OF MISSISSAUGA AND THE PROVINCE OF ONTARIO.
5. THE TOP 100MM OF THE SUBGRADE IS TO BE COMPACTED TO A MINIMUM OF 95% WITHIN 2% OF THE OPTIMUM MOISTURE CONTENT.
6. ALL CONDITIONS WITHIN PAVED PORTION OF ANY EXISTING ROAD TO BE BACKFILLED WITH UNDESIRABLE MATERIAL AS PER C.M. STD. 230.015 AND 230.016 UNLESS OTHERWISE SPECIFIED PRIOR APPROVAL FOR OTHER BACKFILL MATERIAL HAS BEEN OBTAINED.
7. ALL OTHER BACKFILLS WITHIN EXISTING ROAD SHALL BE BACKFILLED TO ITS SUBGRADE ELEVATION WITH GRANULAR C MATERIAL, AND COMPACTED TO A MINIMUM OF 95% STANDARD PROCTOR DENSITY. SUBGRADE RESTRICTION SHALL BE 150mm TO BE BETTER THAN EXISTING CONDITION IN ACCORDANCE WITH P.S.S. 807.
8. CURBS TO BE AS PER C.M. STD. 230.015 UNLESS OTHERWISE NOTED.
9. SUBURBAN UNDERNEATH ALL CURBS AS SPECIFIED ON PLANS ON EXISTING ROADS.
10. ALL EXISTING ROAD WITHIN EXISTING ROAD ALLOWANCE TO BE REINTEGRATED WITH TOPSOIL AND DOG TO THE SATISFACTION OF CITY OF MISSISSAUGA.
11. ALL EXISTING ROAD WITHIN EXISTING ROAD ALLOWANCE TO BE REINTEGRATED WITH TOPSOIL AND DOG TO THE SATISFACTION OF CITY OF MISSISSAUGA.
12. ALL EXISTING ROAD WITHIN EXISTING ROAD ALLOWANCE TO BE REINTEGRATED WITH TOPSOIL AND DOG TO THE SATISFACTION OF CITY OF MISSISSAUGA.

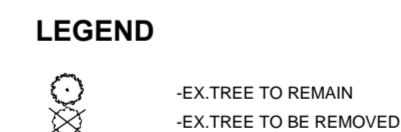

INFORMATION SHOWN HEREON REGARDING THE SIZE AND LOCATION OF EXISTING SERVICES AND/OR UTILITIES IS FURNISHED AS THE BEST AVAILABLE INFORMATION AND SHALL BE INTERPRETED AS THE CONTRACTOR SEES FIT WITH THE UNDERSTANDING THAT THE OWNER DISCLAIMS ALL RESPONSIBILITY FOR ITS SUFFICIENCY AND/OR ACCURACY.

C.M. BENCHMARK No. 752 ELEVATION: 197.356m
 DESCRIPTION: ON THE SOUTH FACE AT THE EAST CORNER OF DECK OF BRIDGE ON AQUITAINE AVENUE, 10m EAST OF GLEN ERIN DRIVE.

SKIRA & ASSOCIATES LTD.
 CONSULTING ENGINEERS
 3464 Semerlyk Court, Suite 100, Mississauga, Ontario L5C 4P8
 Tel: (905) 276-5100 Fax: (905) 270-1936 Email: info@skiraconsult.ca

PROPOSED RESIDENTIAL HIGH RISE AND TOWNHOUSE DEVELOPMENT
 LOT 208 REG. PLAN M-21

6719 GLEN ERIN DRIVE

STARWOOD GROUP INC.
 c/o GSA 700-10 KINGSBIDGE GARDEN CR. MISSISSAUGA, ON L5R 3K6 TEL: (905) 566-8888

No.	DATE	REVISION	INT.
1.	OCT. 07/21	REVISED AS PER CITY COMMENTS	M.E.

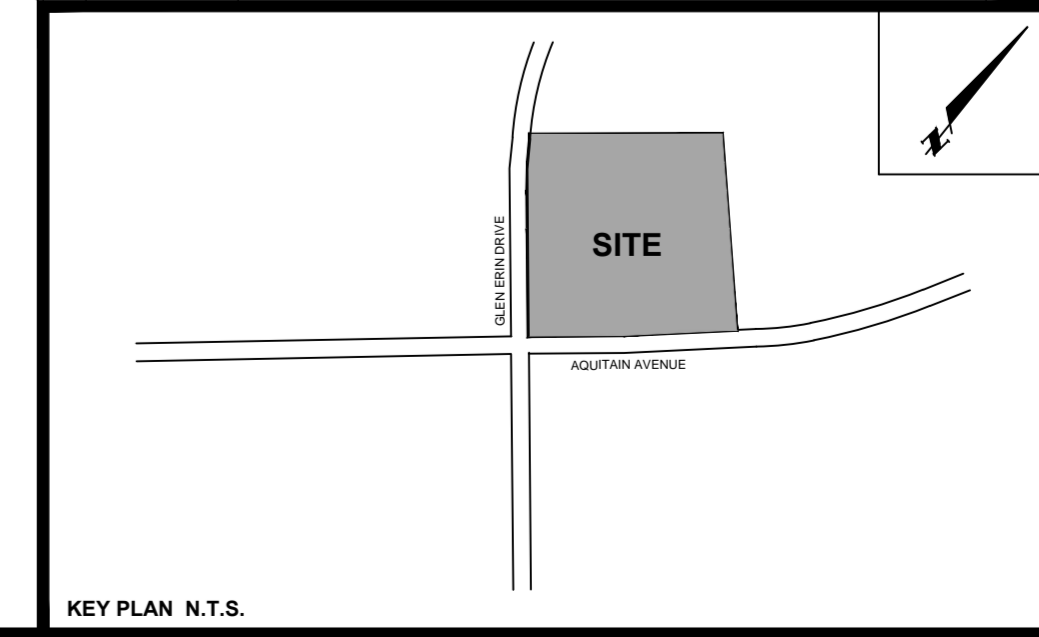

MISSISSAUGA

REMOVAL PLAN

S.P.

DATE: JUNE 2020	AREA: 2-46	DWG. No. C103
SCALE: 1:300	DRAWN BY: E.W.	PROJECT: 220-M22
CITY FILE: OZ 2019	REGION FILE:	

