



5080 Ninth Line, Mississauga ON

Shadow Study Written Analysis
Prepared – September 7, 2021

The latitude and longitude used in the preparation of the shadow study is as follows:

Latitude: 43 degrees 35' 20" N
Longitude: 79 degrees 38' 40" W

North has been determined using a UTM coordinate system using NAD 83 Original to determine North.

The Origin/Source Plan is derived from Horizontal Control Monuments No. 075930012 and No.075930019, and are referred to the 6° UTM Coordinate system, Zone 17, Central Meridian 81°00' West Longitude. (NAD 83 Original).

The following is the summary of the shadow impact criteria that has been met.

3.1 Residential Private Outdoor Amenity Spaces

There is no shadow impact from the proposed development on surrounding residential dwellings on June 21, or September 21.

3.2 Communal Outdoor Amenity Areas

The Sun Access Factor for June 21 is 0.592
The Sun Access Factor for September 21 is 0.706
The Sun Access Factor for December 21 is 0.859



3.3 Public Realm

The opposing boulevard of Ninth Line is free of shadows between the hours of 12:12pm and 2:12pm, and between the hours of 9:12am, 10:12am, and 11:12am.

3.4 Turf and flower gardens in public parks

The proposed development's shadow allows for adequate sunlight during the growing season from March to October by allowing for a minimum of 6 hours of direct sunlight on September 21 on proposed Public Park (except a small portion west of proposed Public Park)

3.5 Building Faces to allow for the possibility of using solar energy

The proposed development does not have a shadow impact for more than two consecutive hourly test times in the No Impact zone on September 21.

Sincerely,

Clifford Korman

20 De Boers Dr. #400 Toronto ON M3J 0H1 TEL 416 665 6060

CLIFFORD KORMAN
| Partner, Architect

BES / B.ARCH / QAA / AAA / MAA / OPPI /
AIA / RAIC / MAIBC / RPP / MCIP / NCARB

CARLOS ANTUNES
| Partner, Architect

B.TECH (ARCH) / M.ARCH / QAA
/ AAA / RAIC

237-8th Ave SE. #401 Calgary AB T2G 5C3 TEL 403 455 6064

BRENT WHITBY
| Partner, Architect

BES / M.ARCH / QAA /
/ AAA / RAIC

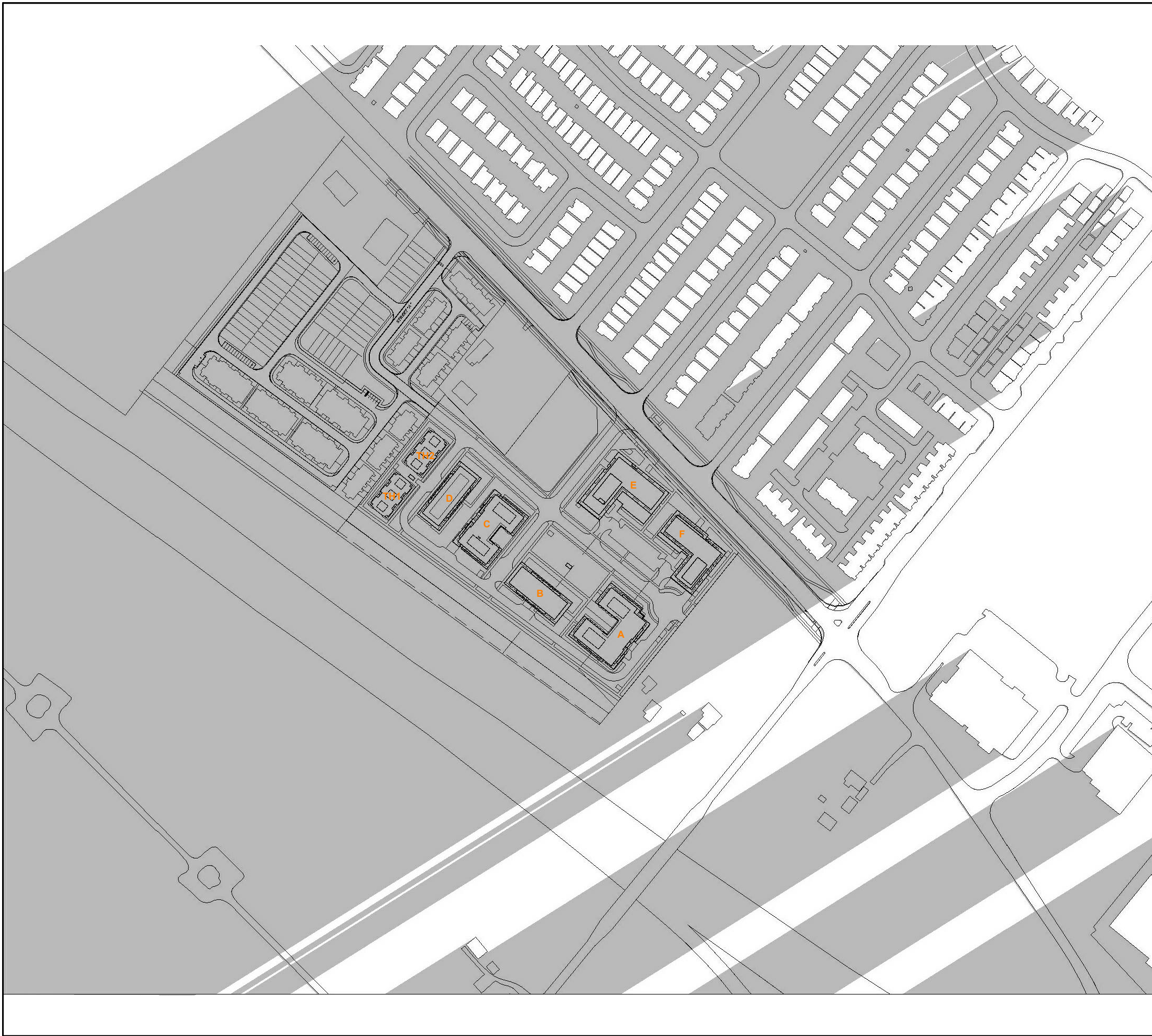

June 21 @ 05:37 1
dA5.1



June 21 @ 07:07 2
dA5.1



June 21 @ 07:20 3
dA5.1

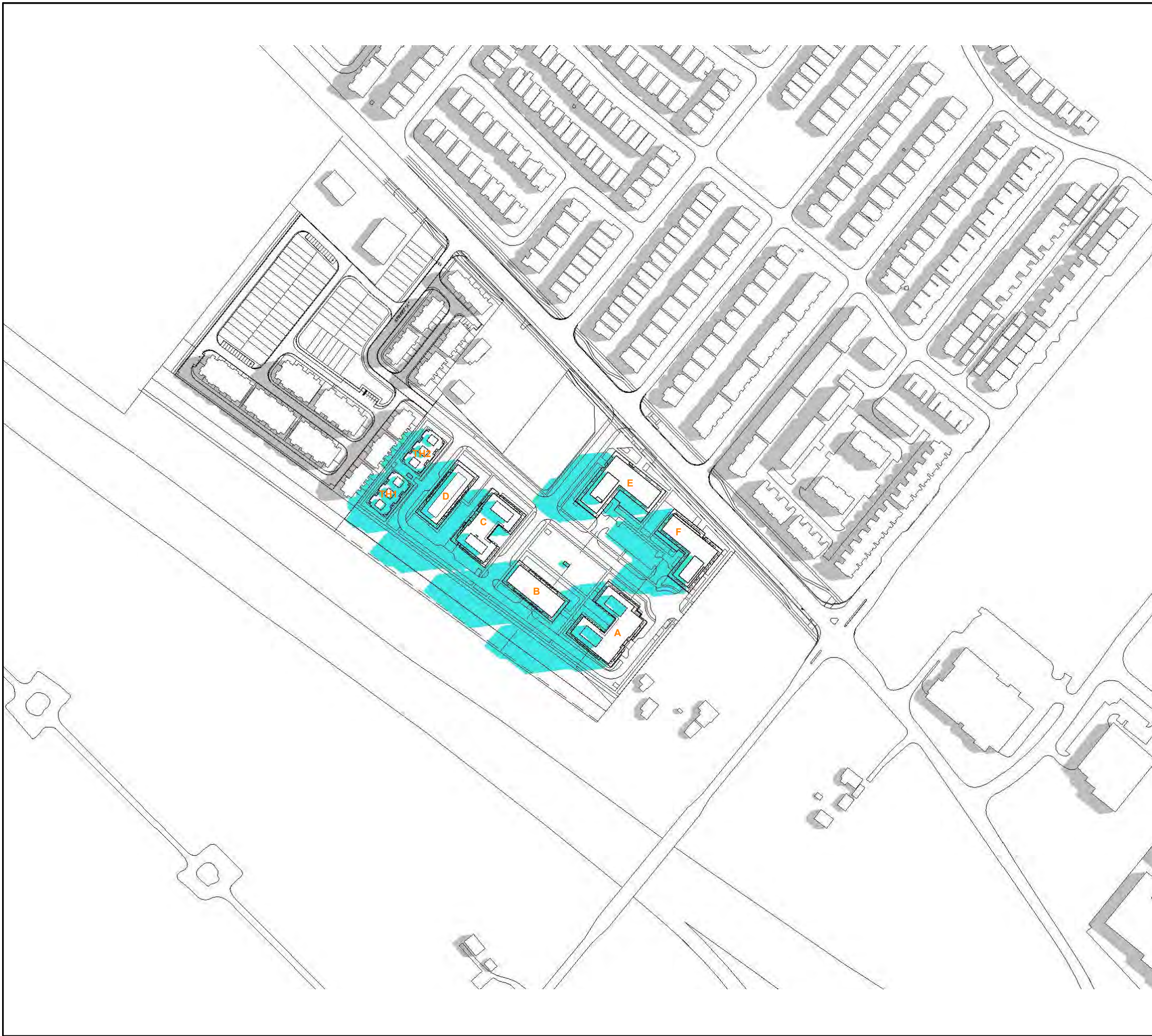

June 21 @ 08:20 4
dA5.1



June 21 @ 09:20 5
dA5.1



June 21 @ 10:20 6
dA5.1

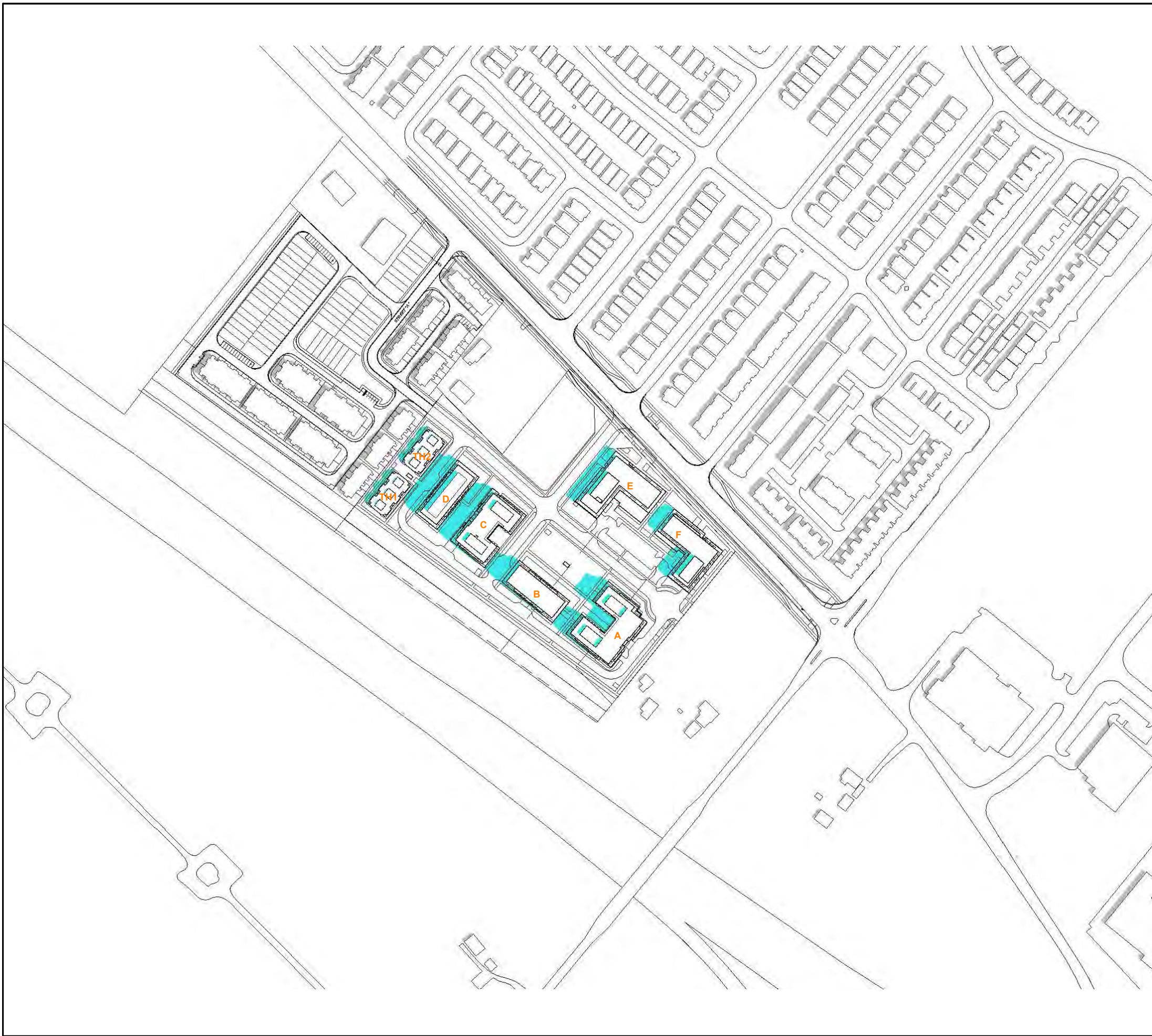

June 21 @ 11:20 7
dA5.1



June 21 @ 12:20 8
dA5.1



June 21 @ 13:20 9
dA5.1

SUN ANGLES:
Sun Angles are based on the latitude and longitude of Mississauga, Ontario, Canada as defined in the software.

Latitude: 43 deg 35' 20"
Longitude: 79 deg 38' 40"

Time Zone: Eastern Standard Time (EST)
Standard Time: UT -5 hours
Daylight Time: UT -4 hours

UT denotes Universal Time (i.e. Greenwich Mean Time)

Software Used:
Autodesk Revit Architecture 2019

Shadow Study on **JUNE 21**

Sun Shadow Timing: JUNE 21
from 1.5 hours after sunrise to 1.5 hours before sunset.

LOCAL TIME EDT:	COMMENTS:
05:37	Rise
07:07	Rise +1.5 hours
07:20	SN -6 hours
08:20	SN -5 hours
09:20	SN -4 hours
10:20	SN -3 hours
11:20	SN -2 hours
12:20	SN -1 hours
13:20	Solar Noon (SN)
14:20	SN +1 hours
15:20	SN +2 hours
16:20	SN +3 hours
17:20	SN +4 hours
18:20	SN +5 hours
19:20	SN +6 hours
19:33	Set -1.5 hours
21:03	Set

Contractor Must Check And Verify All Dimensions On The Job.
Do Not Scale The Drawings.
All Drawings, Specifications And Related Documents Are The Copyright Of The Architect And Must Be Returned Upon Request.
Reproduction Of Drawings, Specifications And Related Documents In Part Or Whole Is Forbidden Without The Architect's Written Permission.
This Drawing Is Not To Be Used For Construction Until Signed By The Architect.
Date:



KIRKOR ARCHITECTS + PLANNERS

20 De Boers Dr. # 400 Toronto ON M3J 0H1
TEL 416 665 6060 kirkorarchitects.com

No.: Revision: Date:

01 Issued For Reaming Sep 20, 2021
No.: Issued For: Date:

Drawing Title:
June Sun Shadow Study

Project:

5080 NINTH LINE
YOUR HOME DEVELOPMENT

Scale:
Drawn by:
Checked by:
Project No.:
17-179
Date:
09/20/21
Drawing No.:

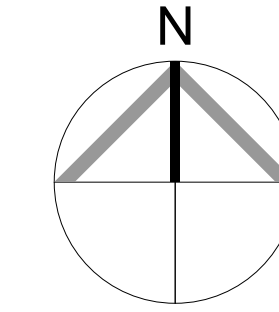

dA5.1



June 21 @ 14:20 1
dA5.2



June 21 @ 15:20 2
dA5.2



June 21 @ 16:20 3
dA5.2



June 21 @ 17:20 4
dA5.2

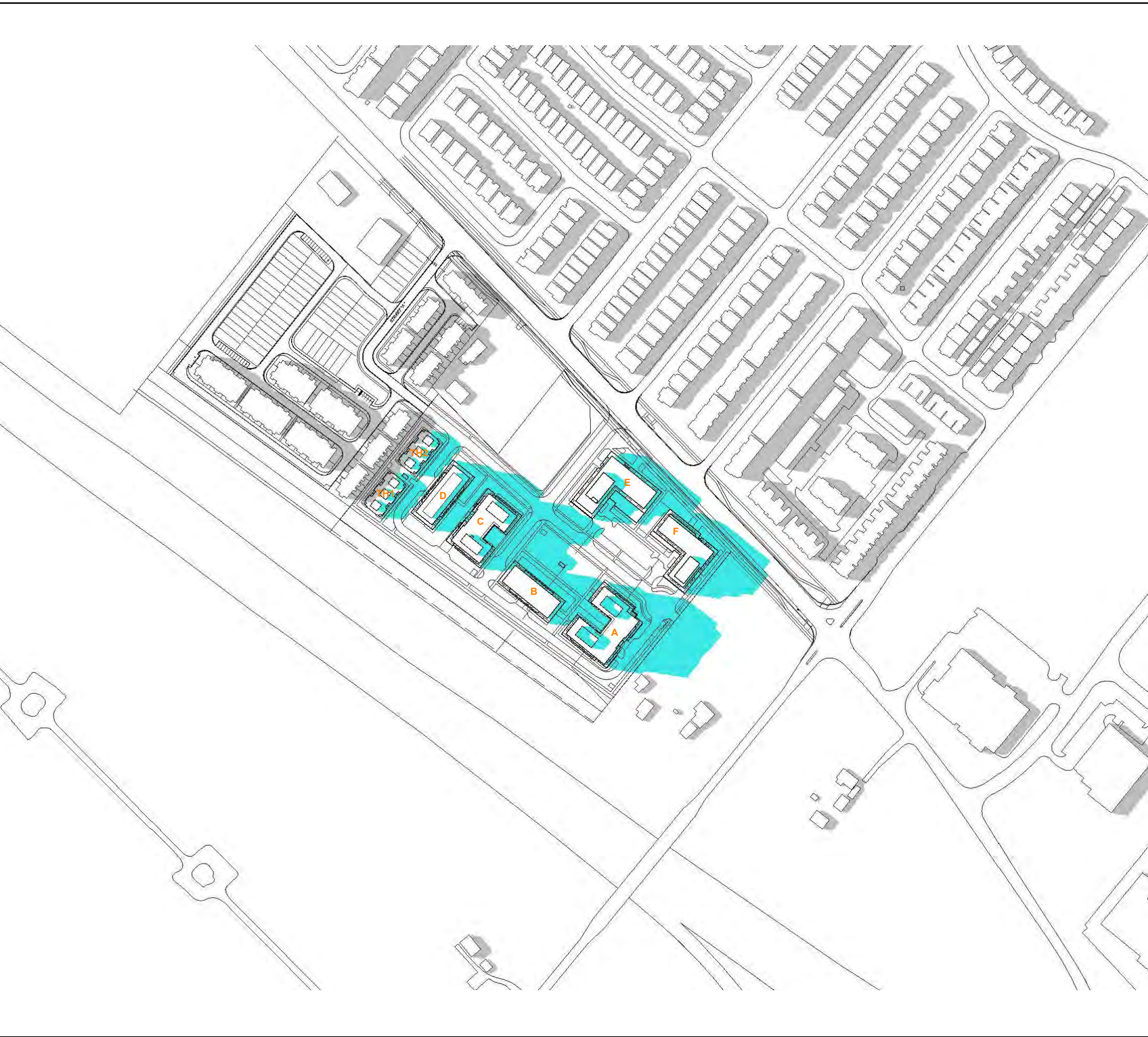

June 21 @ 18:20 5
dA5.2



June 21 @ 19:20 6
dA5.2



June 21 @ 19:33 7
dA5.2

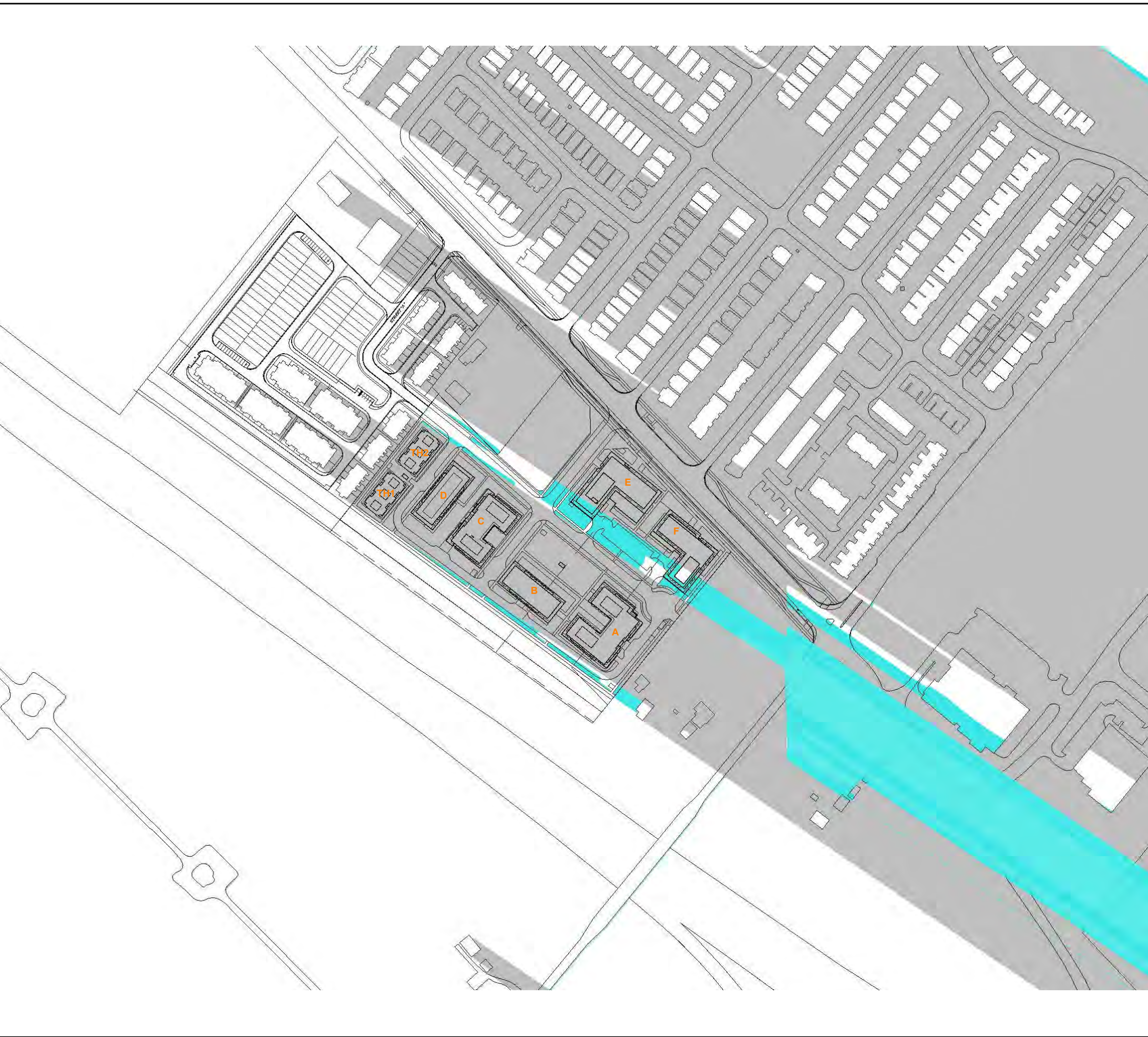

June 21 @ 21:03 8
dA5.2

SUN ANGLES:
Sun Angles are based on the latitude and longitude of Mississauga, Ontario, Canada as defined in the software.

Latitude: 43 deg 35' 20"
Longitude: 79 deg 38' 40"

Time Zone: Eastern Standard Time (EST)
Standard Time: UT -5 hours
Daylight Time: UT -4 hours

UT denotes Universal Time (i.e. Greenwich Mean Time)

Software Used:
Autodesk Revit Architecture 2019

Shadow Study on **JUNE 21**

Sun Shadow Timing: JUNE 21
from 1.5 hours after sunrise to 1.5 hours before sunset.

LOCAL TIME EDT:	COMMENTS:
05:37	Rise
07:07	Rise +1.5 hours
07:20	SN -6 hours
08:20	SN -5 hours
09:20	SN -4 hours
10:20	SN -3 hours
11:20	SN -2 hours
12:20	SN -1 hours
13:20	Solar Noon (SN)
14:20	SN +1 hours
15:20	SN +2 hours
16:20	SN +3 hours
17:20	SN +4 hours
18:20	SN +5 hours
19:20	SN +6 hours
19:33	Set -1.5 hours
21:03	Set

Contractor Must Check And Verify All Dimensions On The Job.
Do Not Scale The Drawings.
All Drawings, Specifications And Related Documents Are The Copyright Of The Architect And Must Be Returned Upon Request.
Reproduction Of Drawings, Specifications And Related Documents In Part Or Whole Is Forbidden Without The Architect's Written Permission.
This Drawing Is Not To Be Used For Construction Until Signed By The Architect.
Date:



KIRKOR ARCHITECTS + PLANNERS

20 De Boers Dr. # 400 Toronto ON M3J 0H1
TEL 416 665 6060 kirkorarchitects.com

No.: Revision: Date:

01 Issued For Reaming Sep 20, 2021
No.: Issued For: Date:

Drawing Title:
June Sun Shadow Study

Project:

5080 NINTH LINE
YOUR HOME DEVELOPMENT

Scale:

Drawn by:

Checked by:

Project No.: **17-179**

Date: **09/20/21**

Drawing No.: **Standards for Shadow Study**

9
dA5.2

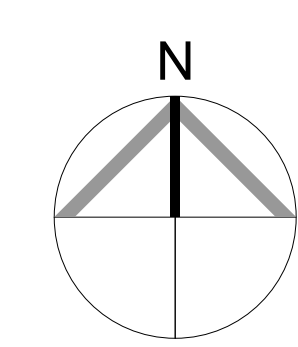

dA5.2



March/September 21 @ 07:05 1
dA5.3



March/September 21 @ 08:35 2
dA5.3



March/September 21 @ 09:12 3
dA5.3

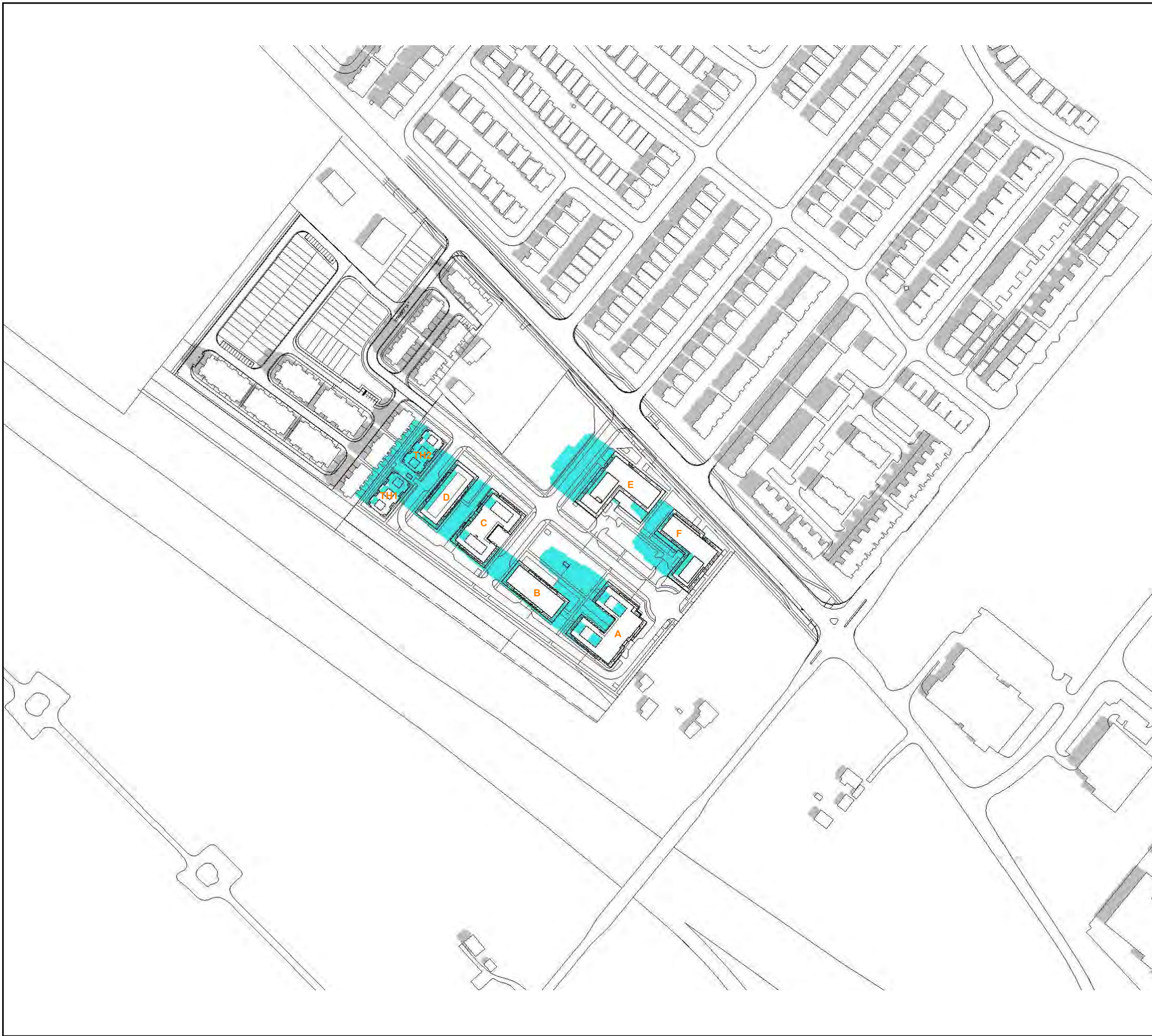

March/September 21 @ 10:12 4
dA5.3

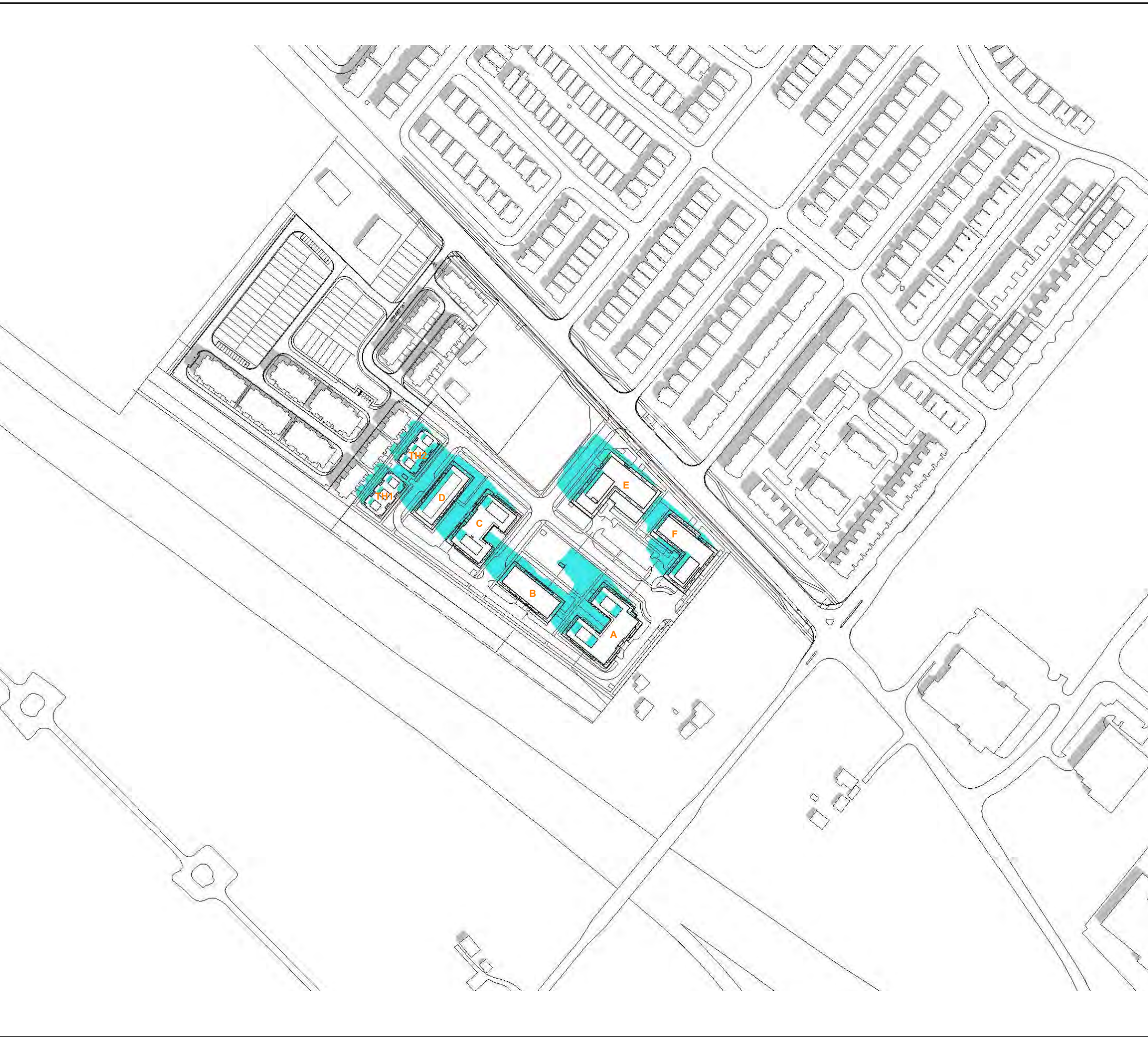

March/September 21 @ 11:12 5
dA5.3



March/September 21 @ 12:12 6
dA5.3

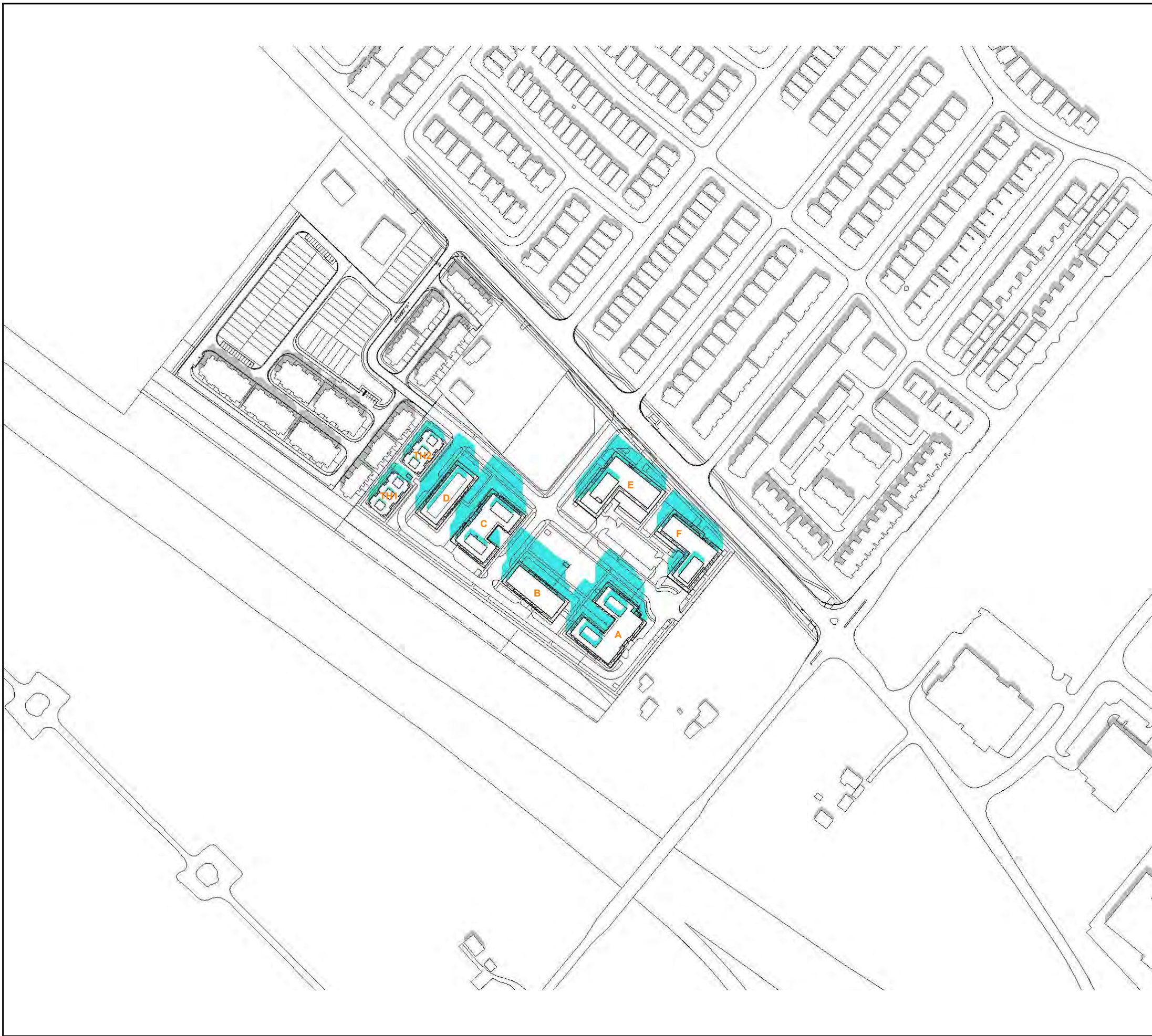

March/September 21 @ 13:12 7
dA5.3



March/September 21 @ 14:12 8
dA5.3



March/September 21 @ 15:12 9
dA5.3

SUN ANGLES:
Sun Angles are based on the latitude and longitude of Mississauga, Ontario, Canada as defined in the software.

Latitude: 43 deg 35' 20"
Longitude: 79 deg 38' 40"

Time Zone:Eastern Standard Time (EST)
Standard Time: UT -5 hours
Daylight Time: UT -4 hours

UT denotes Universal Time (i.e. Greenwich Mean Time)

Software Used:
Autodesk Revit Architecture 2019

Shadow Study on **SEPTEMBER 21**

Sun Shadow Timing: SEPTEMBER 21
from 1.5 hours after sunrise to 1.5 hours before sunset.

LOCAL TIME EDT:	COMMENTS:
07:05	Rise
08:35	Rise +1.5 hours
09:12	SN -4 hours
10:12	SN -3 hours
11:12	SN -2 hours
12:12	SN -1 hours
13:12	Solar Noon (SN)
14:12	SN +1 hours
15:12	SN +2 hours
16:12	SN +3 hours
17:12	SN +4 hours
17:48	Set -1.5 hours
19:18	Set

Contractor Must Check And Verify All Dimensions On The Job.
Do Not Scale The Drawings.
All Drawings, Specifications And Related Documents Are The Copyright Of The Architect And Must Be Returned Upon Request.
Reproduction Of Drawings, Specifications And Related Documents In Part Or Whole Is Forbidden Without The Architects Written Permission.
This Drawing Is Not To Be Used For Construction Until Signed By The Architect.
Date:

KIRKOR ARCHITECTS + PLANNERS

20 De Boers Dr. # 400 Toronto ON M3J 0H1
TEL 416 665 6060 kirkorarchitects.com

No.:	Revision:	Date:
------	-----------	-------

01	Issued For Reaming	Sep 20, 2021
No.:	Issued For:	Date:

Drawing Title:

March/September Sun Shadow Study

Project:

5080 NINTH LINE
YOUR HOME DEVELOPMENT

Scale:

Drawn by:

Checked by:

Project No.: 17-179

Date: 09/20/21

Drawing No.: 10

dA5.3

Plot Date: 2021-09-20 10:41:43 AM File Path: C:\Revit\2019\17179P11-Model-5080 Ninth Line Mississauga_Master Model_mydiponjan\VC\6.rvt



March/September 21 @ 16:12

1

dA5.4

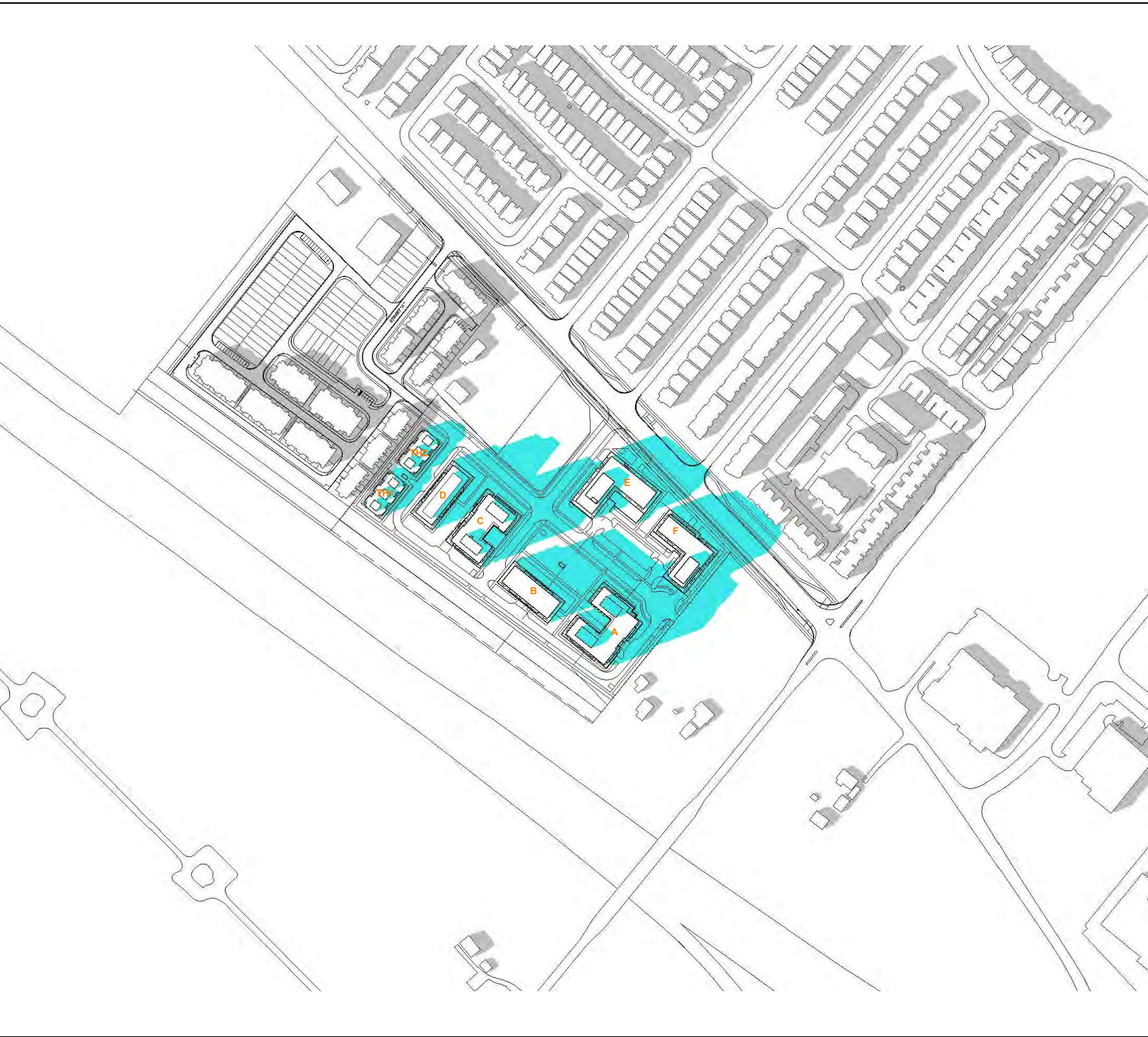

March/September 21 @ 17:12

2

dA5.4



March/September 21 @ 17:48

3

dA5.4

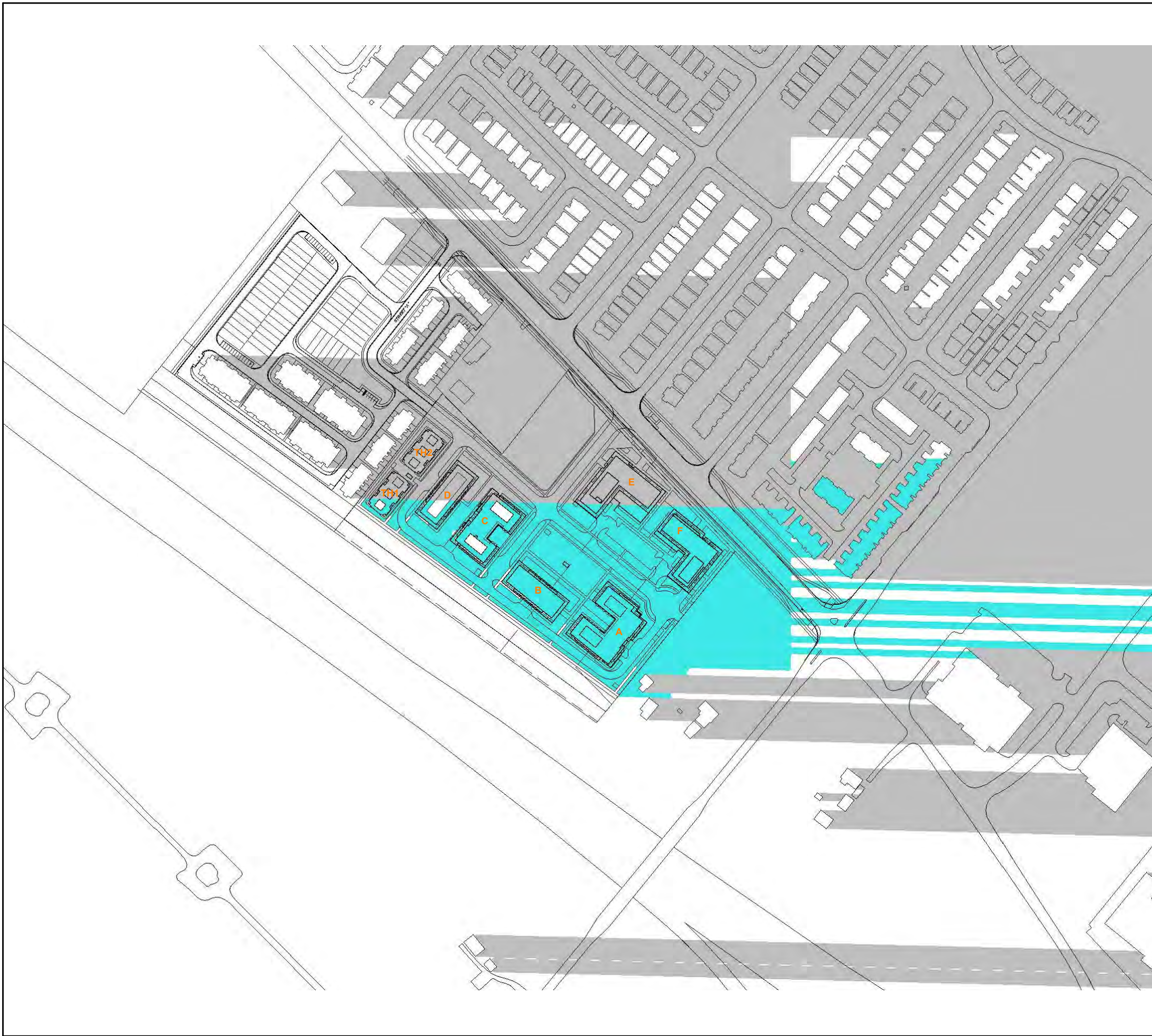

March/September 21 @ 19:18

4

dA5.4

SUN ANGLES:
Sun Angles are based on the latitude and longitude of Mississauga, Ontario, Canada as defined in the software.

Latitude: 43 deg 35' 20"
Longitude: 79 deg 38' 40"

Time Zone:Eastern Standard Time (EST)
Standard Time: UT -5 hours
Daylight Time: UT -4 hours

UT denotes Universal Time (i.e. Greenwich Mean Time)

Software Used:
Autodesk Revit Architecture 2019

Shadow Study on **SEPTEMBER 21**

Sun Shadow Timing: SEPTEMBER 21
from 1.5 hours after sunrise to 1.5 hours before sunset.

LOCAL TIME EDT:	COMMENTS:
07:05	Rise
08:35	Rise +1.5 hours
09:12	SN -4 hours
10:12	SN -3 hours
11:12	SN -2 hours
12:12	SN -1 hours
13:12	Solar Noon (SN)
14:12	SN +1 hours
15:12	SN +2 hours
16:12	SN +3 hours
17:12	SN +4 hours
17:48	Set -1.5 hours
19:18	Set

Contractor Must Check And Verify All Dimensions On The Job.
Do Not Scale The Drawings.
All Drawings, Specifications And Related Documents Are The Copyright Of The Architect And Must Be Returned Upon Request.
Reproduction Of Drawings, Specifications And Related Documents In Part Or Whole Is Forbidden Without The Architect's Written Permission.
This Drawing Is Not To Be Used For Construction Until Signed By The Architect.
Date:



KIRKOR ARCHITECTS + PLANNERS

20 De Boers Dr. # 400 Toronto ON M3J 0H1
TEL 416 665 6060 kirkorarchitects.com

No.:	Revision:	Date:
------	-----------	-------

01	Issued For Re-zoning	Sep 20, 2021
No.:	Issued For:	Date:

Drawing Title:

March/September Sun Shadow Study

Project:

5080 NINTH LINE
YOUR HOME DEVELOPMENT

Scale:

Drawn by:

Checked by:

Project No.: **17-179**

Date: **09/20/21**

Drawing No.:

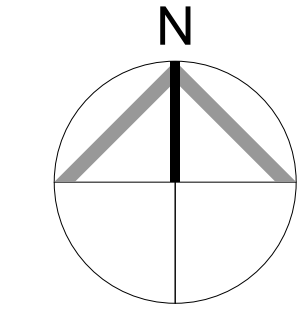

dA5.4

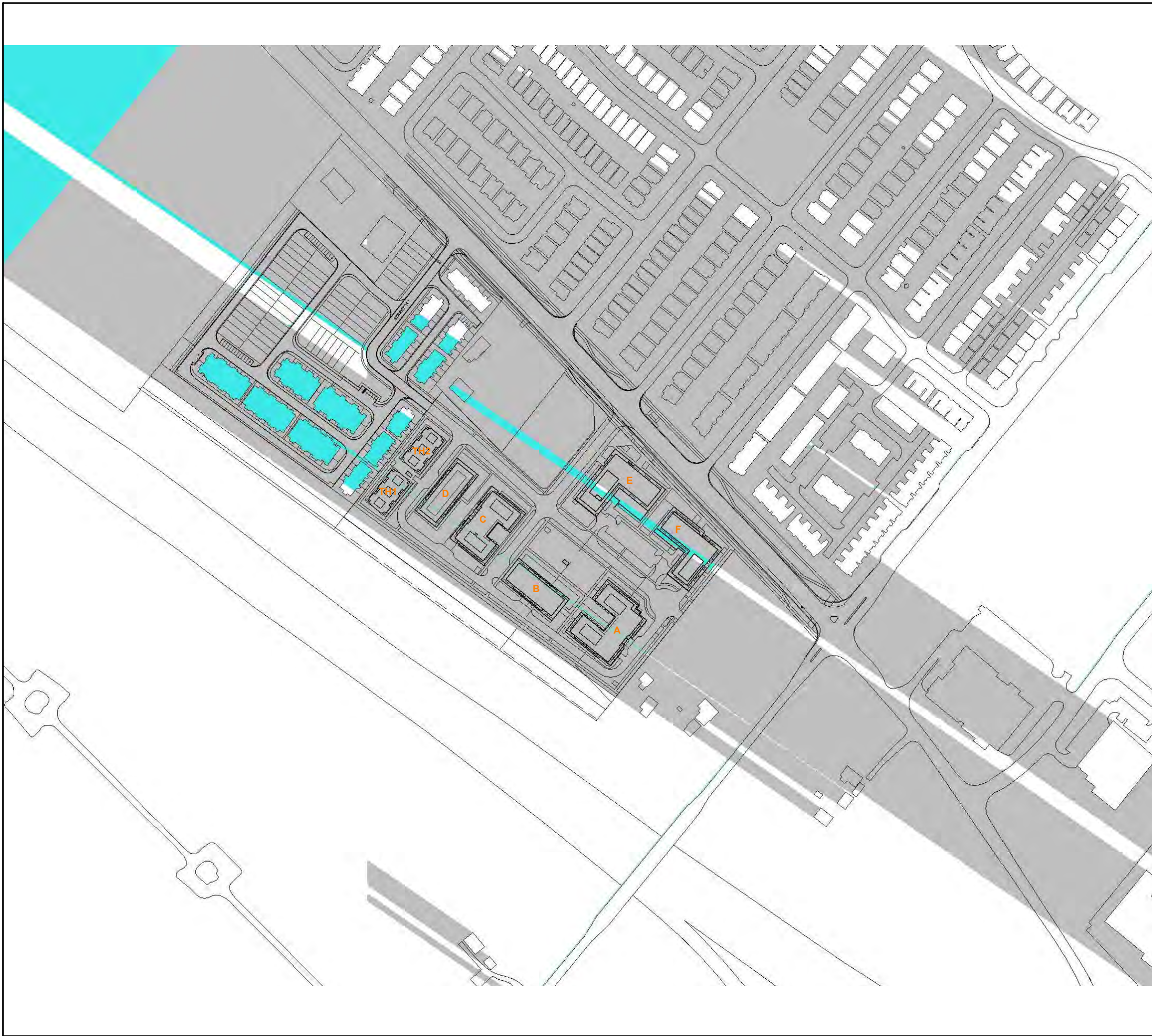

December 21 @ 07:49 1
dA5.5

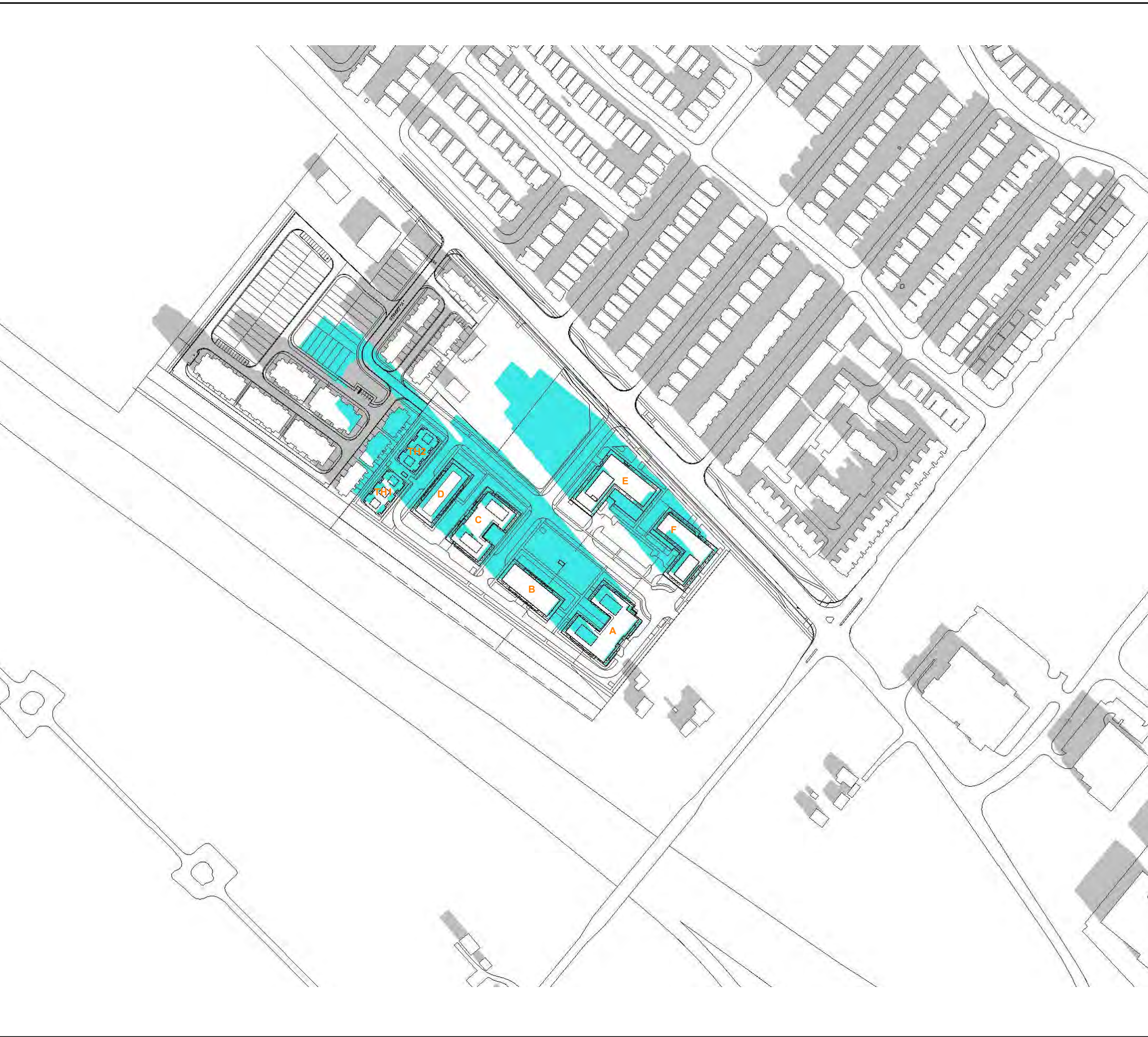

December 21 @ 09:19 2
dA5.5

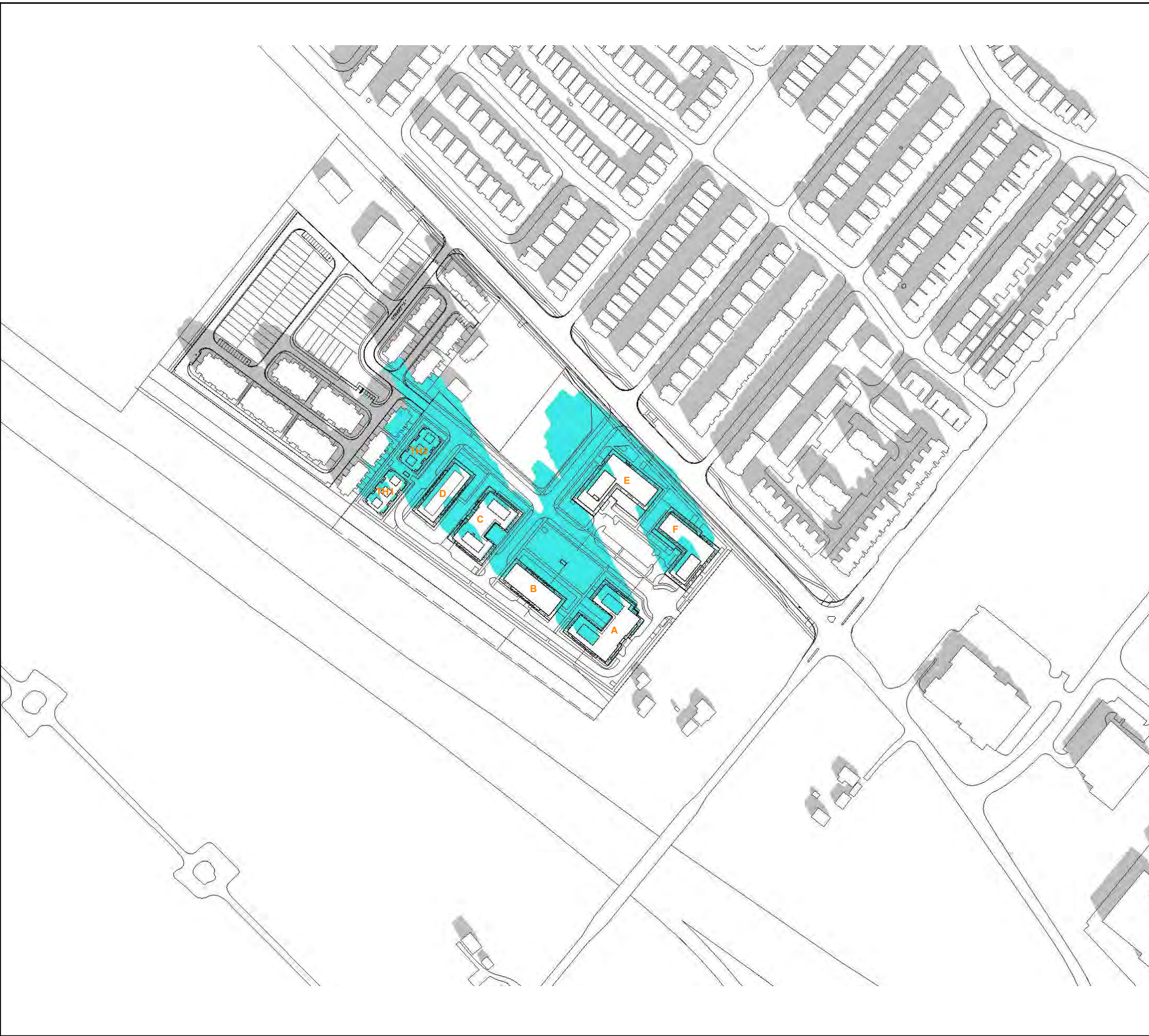

December 21 @ 10:17 3
dA5.5

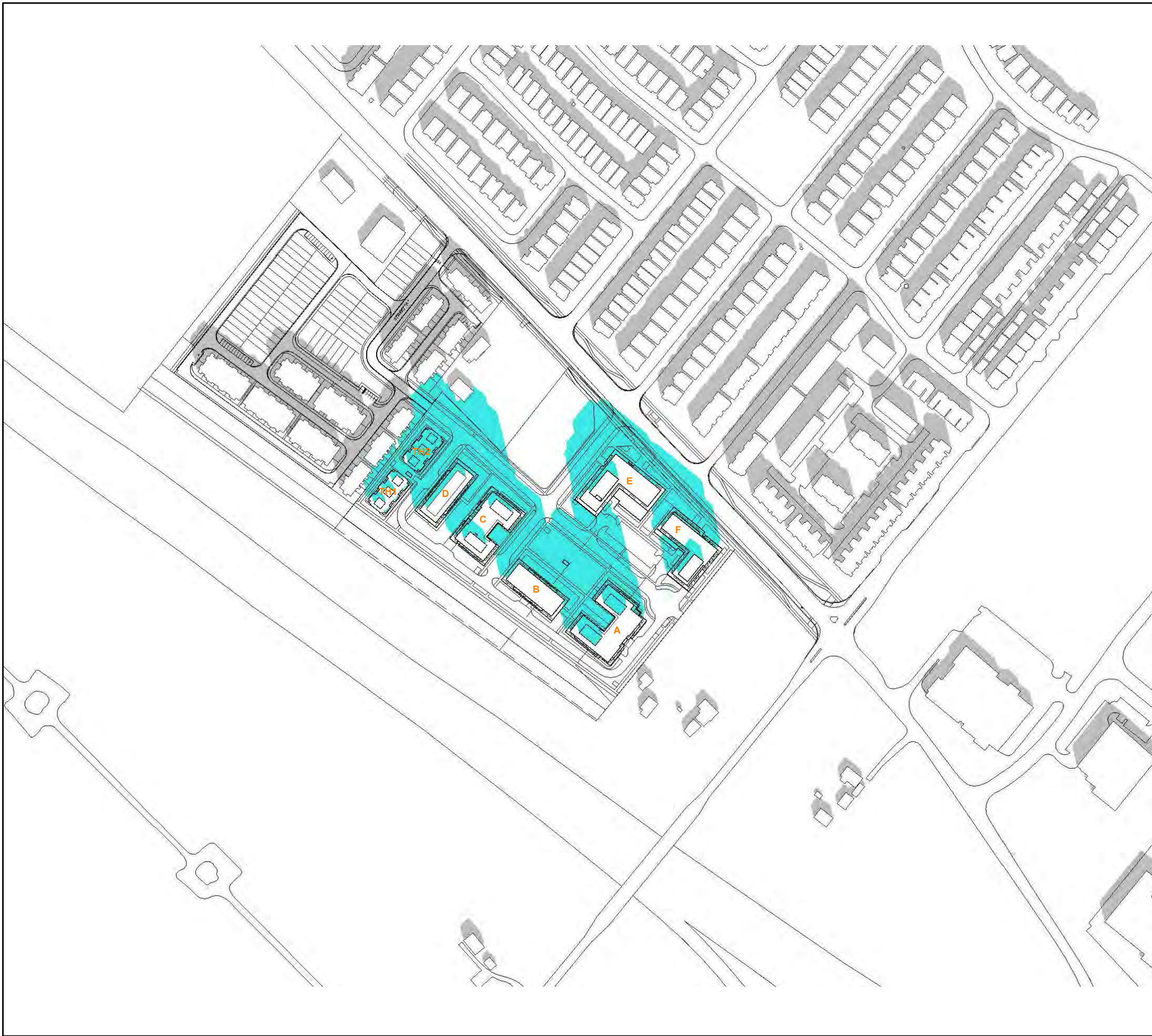

December 21 @ 11:17 4
dA5.5



December 21 @ 12:17 5
dA5.5



December 21 @ 13:17 6
dA5.5

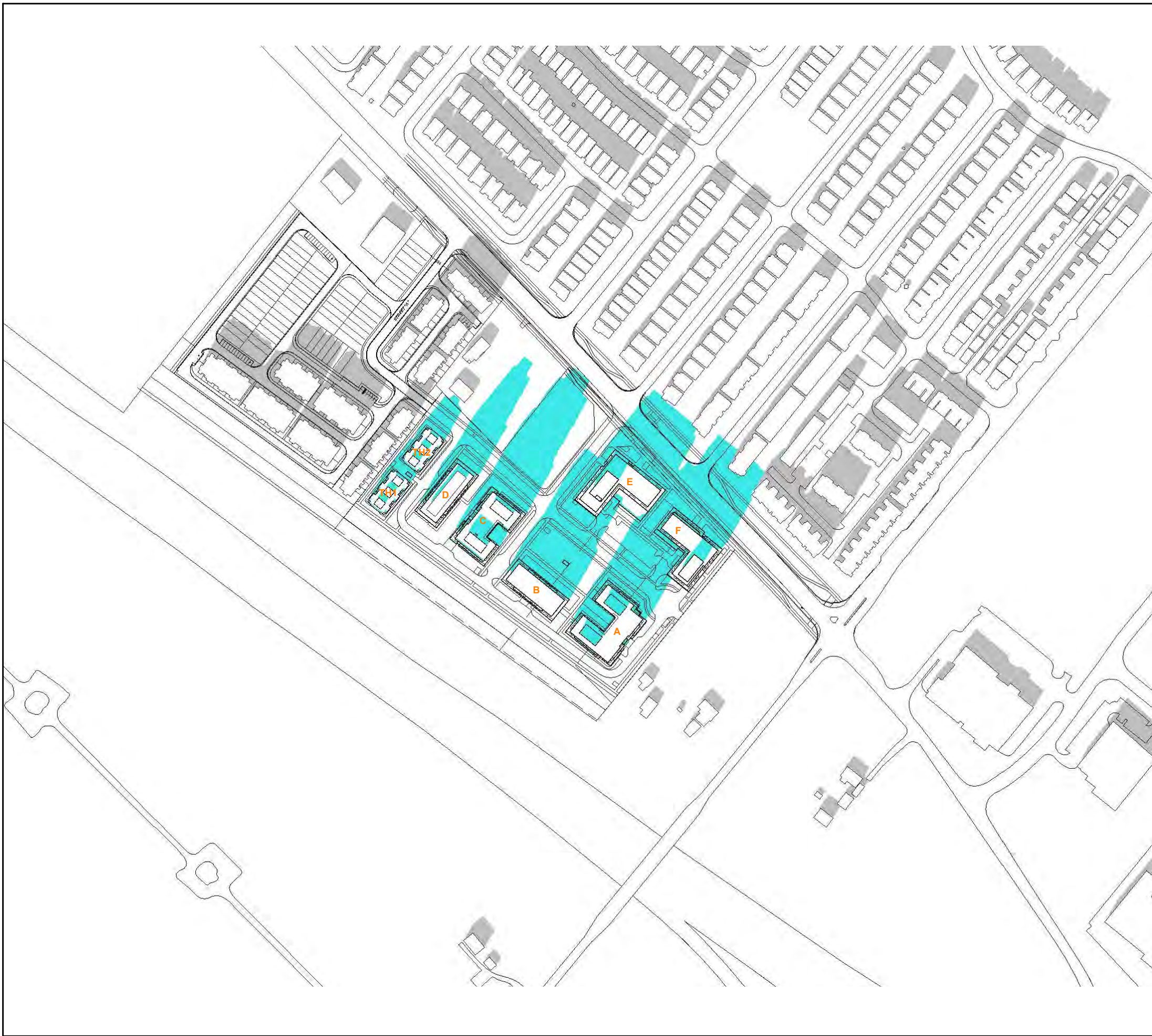

December 21 @ 14:17 7
dA5.5

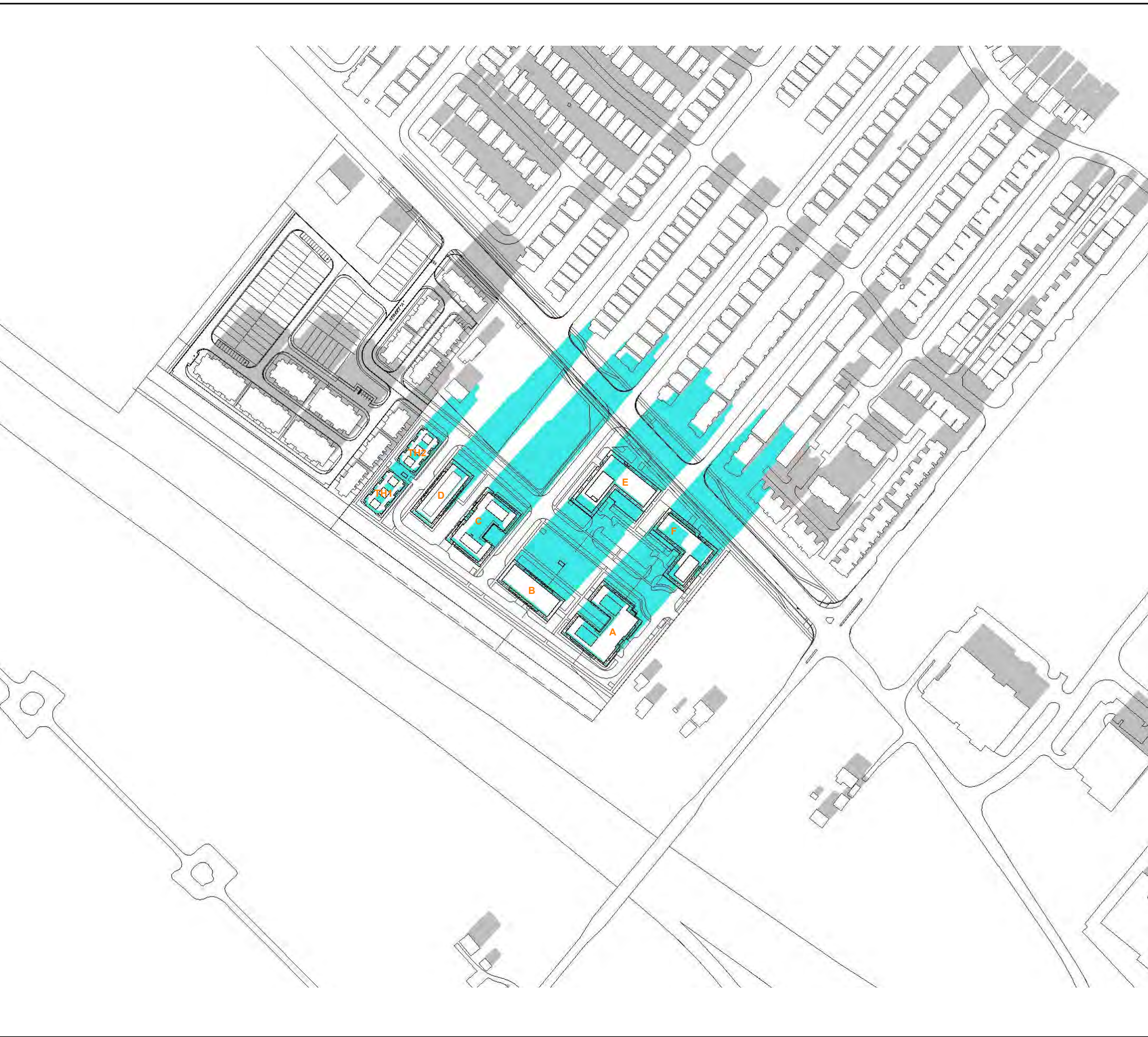

December 21 @ 15:15 8
dA5.5



December 21 @ 16:45 9
dA5.5

SUN ANGLES:
Sun Angles are based on the latitude and longitude of Mississauga, Ontario, Canada as defined in the software.

Latitude: 43 deg 35' 20"
Longitude: 79 deg 38' 40"

Time Zone: Eastern Standard Time (EST)
Standard Time: UT -5 hours
Daylight Time: UT -4 hours

UT denotes Universal Time (i.e. Greenwich Mean Time)

Software Used:
Autodesk Revit Architecture 2019

Shadow Study on **DECEMBER 21**

Sun Shadow Timing: DECEMBER 21
from 1.5 hours after sunrise to 1.5 hours before sunset.

LOCAL TIME EDT:	COMMENTS:
07:49	Rise
09:19	Rise +1.5 hours
10:17	SN -2 hours
11:17	SN -1 hours
12:17	Solar Noon (SN)
13:17	SN +1 hours
14:17	SN +2 hours
15:15	Set -1.5 hours
16:45	Set

Contractor Must Check And Verify All Dimensions On The Job.
Do Not Scale The Drawings.
All Drawings, Specifications And Related Documents Are The Copyright Of The Architect And Must Be Retained Upon Request.
Reproduction Of Drawings, Specifications And Related Documents In Part Or Whole Is Forbidden Without The Architect's Written Permission.
This Drawing Is Not To Be Used For Construction Until Signed By The Architect.
Date:

KIRKOR ARCHITECTS + PLANNERS

20 De Boers Dr. # 400 Toronto ON M3J 0H1
TEL 416 665 6060 kirkorarchitects.com

No.:	Revision:	Date:
------	-----------	-------

01	Issued For Re-zoning	Sep 20, 2021
No.:	Issued For:	Date:

Drawing Title:
December Sun Shadow Study

Project:

5080 NINTH LINE
YOUR HOME DEVELOPMENT

Scale:

Drawn by:

Checked by:

Project No.: **17-179**

Date: **09/20/21**

Drawing No.:

dA5.5