

ON GRADE

- PRUNE TO REMOVE DAMAGED BRANCHES FOLLOWING PROPER HORTICULTURAL PRACTICES. DO NOT PRUNE LEADER.
- NOTES:
- TREE TO HAVE STRAIGHT TRUNK & SINGLE LEADER, UNLESS SPECIFIED AS MULTI-STEMMED
  - DO NOT CUT LEADER
  - SET TREE PLUMB
  - FLOOD SAUCER TWICE DURING FIRST 24 HOURS AFTER PLANTING
  - TREE PIT TO BE 3 TIMES WIDTH OF ROOT BALL OR 1' DIA. MINIMUM
  - SYNTHETIC BURLAP IS UNACCEPTABLE
  - LOOSE OR CRACKED ROOTBALLS ARE UNACCEPTABLE
  - REMOVE TOP 2/3 OF WIRE BASKETS
  - SCARIFY ROOT BALL EDGES 1/2" DEEP IN FOUR LOCATIONS
  - REMOVE 1/3 BURLAP PRIOR TO BACKFILL
  - SCARIFY PIT SURFACE TO 4-6" MIN. DEPTH PRIOR TO PLANTING.
  - SECURE TWO LONG T-BARS, MIN 2.4M LONG DRILLED TO RECEIVE GALVANIZED WIRE THREADED THROUGH RUBBER HOSE TO SUPPORT TREE. PAINT T-BARS FLAT BLACK.
  - SECURE TREE WRAP UP TO FIRST BRANCH
  - PLANT SLIGHTLY HIGHER THAN THE TREE'S ORIGINAL GRADE.
  - 75mm MIN. MULCH
  - PLANTING SOIL MIX. COMPACT TO ELIMINATE AIR POCKETS AND PREVENT SETTLEMENT.

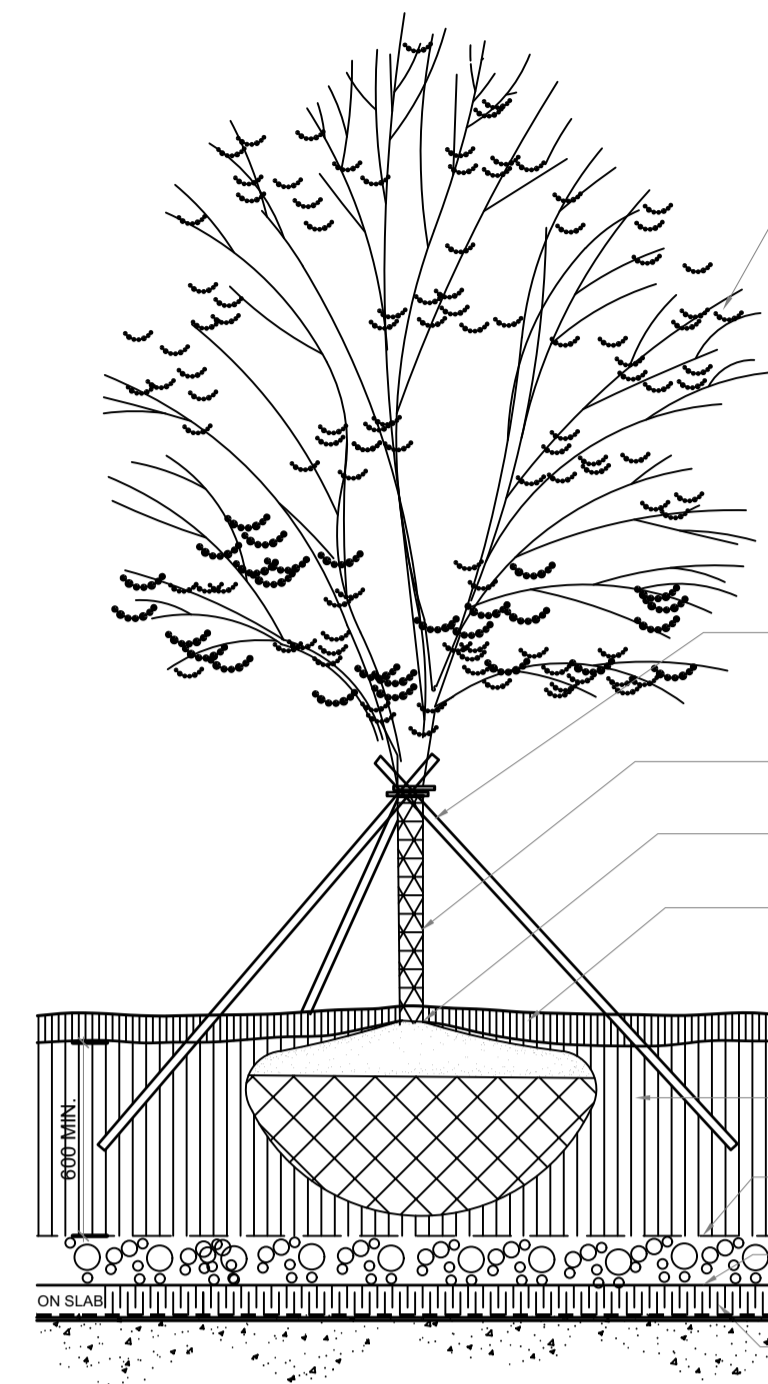

ON SLAB

- PRUNE TO REMOVE DAMAGED BRANCHES FOLLOWING PROPER HORTICULTURAL PRACTICES. DO NOT PRUNE LEADER.
- 3-50x50x2400 LG. WOOD STAKES SPACED EQUALLY (TRIPOD METHOD) SECURED WITH 1.5mm DIA. GALVANIZED WIRE THREADED THROUGH RUBBER HOSE TO SUPPORT TREE.
- SECURE TREE WRAP UP TO FIRST BRANCH
- PLANT SLIGHTLY HIGHER THAN THE TREE'S ORIGINAL GRADE.
- 75mm MIN. MULCH
- PLANTING SOIL MIX. COMPACT TO ELIMINATE AIR POCKETS AND PREVENT SETTLEMENT.
- FILTER FABRIC OVER 100mm-19 DIA. CLEAR STONE DRAINAGE COURSE
- ROOT BARRIER
- PROTECTION BOARD W.P. MEMBRANE AND STRUCTURAL SLAB (SEE ARCHITECTURAL DWGS.)

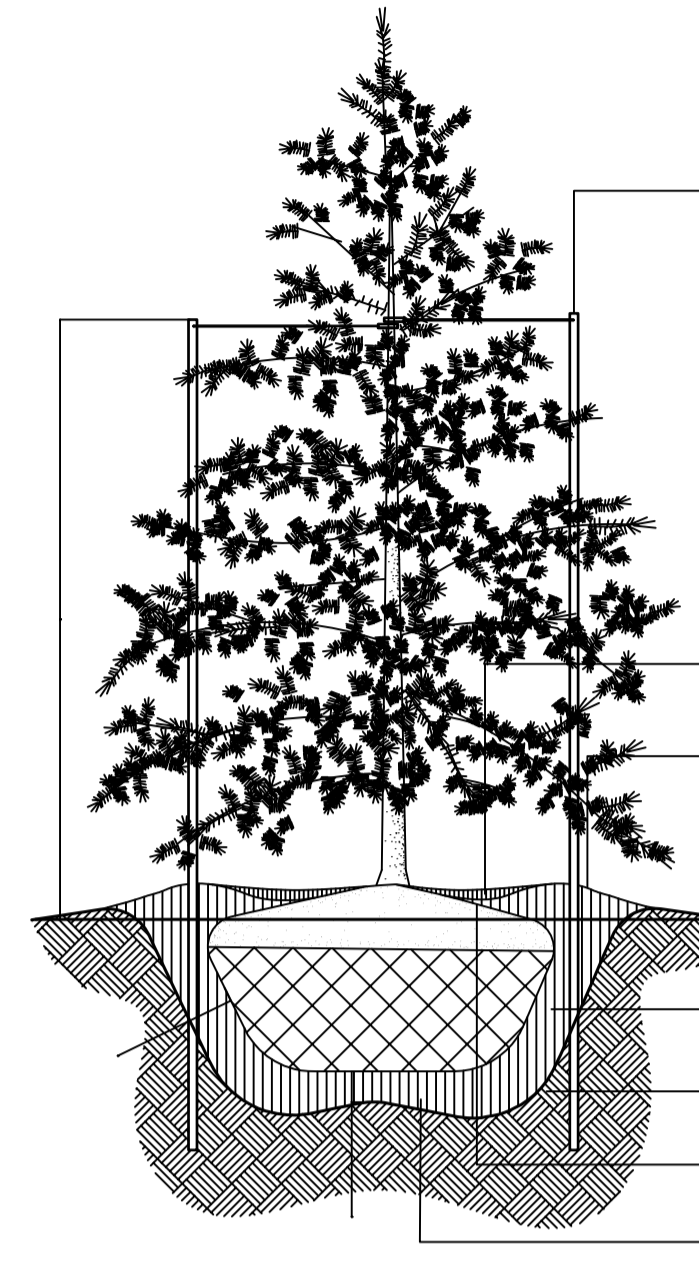

ON GRADE

- TWO T-BARS, 38x38x2440 LONG, DRILLED TO RECEIVE 1.5 DIA. GALVANIZED WIRE THREADED THROUGH 12.7 DIA. BLACK RUBBER HOSE. PAINT "T-BARS" FLAT BLACK.
- 75mm MIN. SHREDDED PINE BARK MULCH (BY GRO-BARK LTD. OR ALL TREAT FARMS LTD OR APPROVED ALTERNATE)
- PROVIDE 102 SAUCER
- PLANT TREES 100 HIGHER THAN ORIGINAL GRADE.
- EXISTING GRADE
- PLANTING SOIL MIX. LIGHTLY COMPACT AND WATER WELL TO ELIMINATE AIR POCKETS AND PREVENT SETTLEMENT.
- SCARIFY SUBGRADE AROUND PLANTING PIT.
- REMOVE TOP RING OF WIRE BASKET OR 1/3 OF BURLAP FROM ROOT BALL.
- WELL COMPACTED SOIL MIX UNDER ROOT BALL.

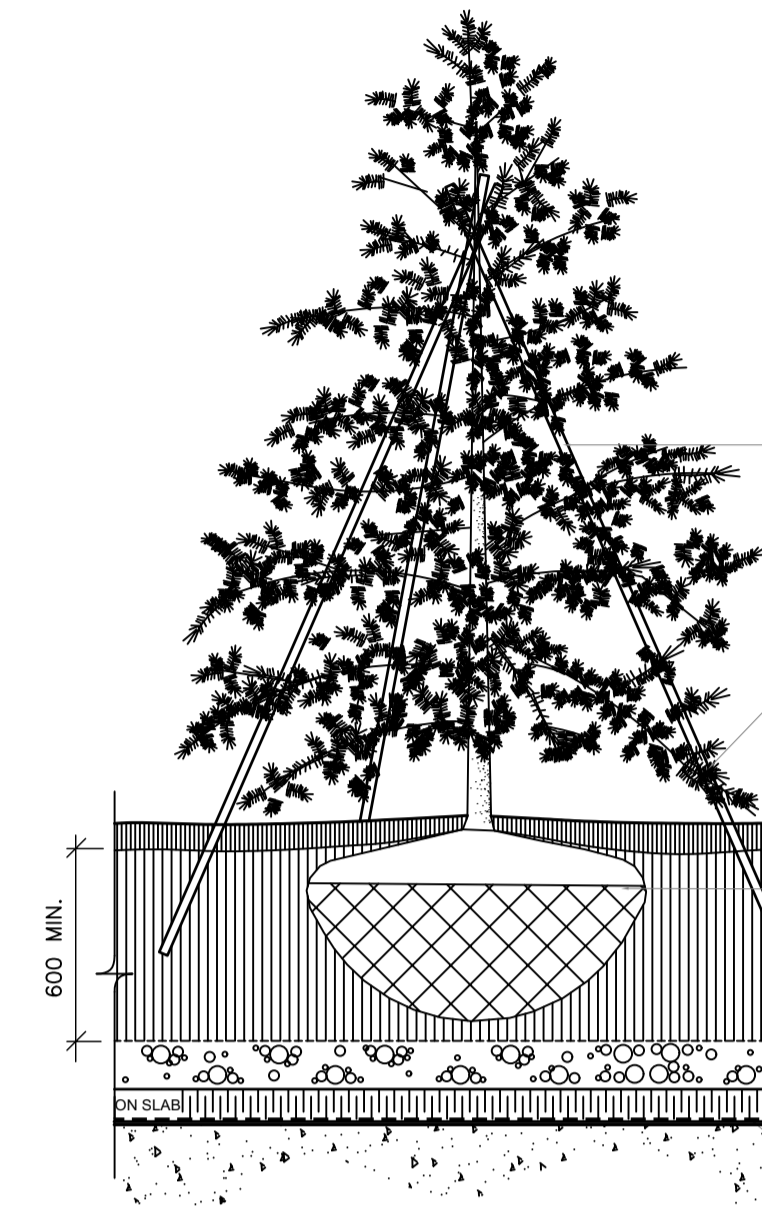

ON SLAB

- USE TRIPOD STAKING METHOD FOR TREES PLANTED ON SLAB. INSTALL WITH CAUTION, ENSURING THAT STAKES DO NOT PUNCTURE WATERPROOFING MEMBRANE.
- 3-50 X 50 X 2400 LG. WOOD STAKES, SPACED EQUALLY (TRIPOD METHOD), SECURED WITH 1.5mm DIA. GALVANIZED SECURED WITH 1.5mm DIA. GALVANIZED WIRE THREADED THROUGH RUBBER HOSE TO SUPPORT TREE.
- 75mm MIN. MULCH
- REMOVE TOP RING OF WIRE BASKET OR TOP 1/3 OF BURLAP
- PLANTING SOIL MIX. COMPACT TO ELIMINATE AIR POCKETS AND PREVENT SETTLEMENT.
- FILTER FABRIC OVER 100mm-19 DIA. CLEAR STONE DRAINAGE COURSE
- ROOT BARRIER
- PROTECTION BOARD W.P. MEMBRANE AND STRUCTURAL SLAB (SEE ARCHITECTURAL DWGS.)

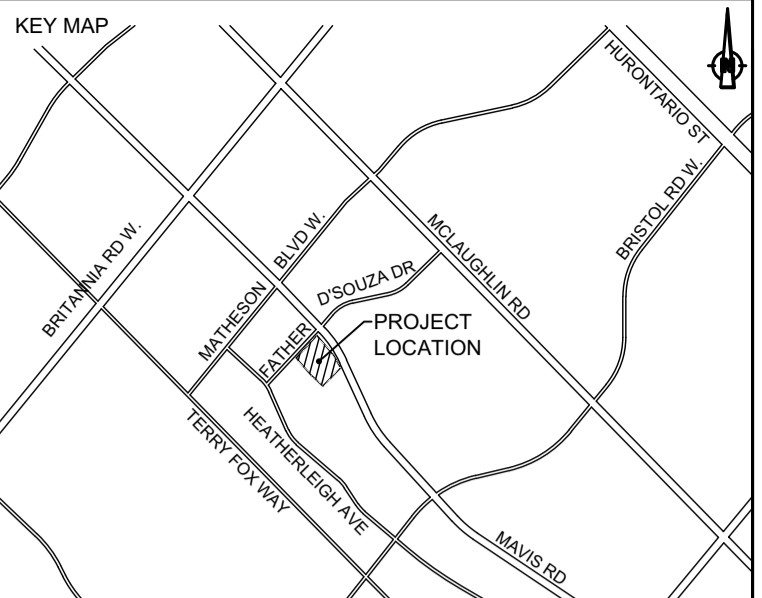

**BENCHMARK**

LOCATION: CITY OF MISSISSAUGA  
 BENCHMARK: No.1070 WITH ELEVATION 176.461m  
 DESCRIPTION: BENCHMARK SET HORIZONTALLY AT THE BASE OF A 750mmØ CONCRETE TRAFFIC POLE AT THE SOUTH-EAST CORNER OF BRISTOL ROAD AND GUILDWOOD WAY.

BENCHMARK: No.1056 WITH ELEVATION 177.332m  
 DESCRIPTION: TABLET SET HORIZONTALLY AT THE BASE OF A 750mmØ CONCRETE TRAFFIC POLE AT THE CORNER OF BRISTOL ROAD WEST AND CEREMONIAL DRIVE

COMPLETED BY:  
 LAND SURVEY GROUP - ONTARIO LAND SURVEYORS  
 777 THE QUEENSWAY, UNIT 1  
 TORONTO, ONTARIO, M8Z 1N4  
 (416) 252-2511  
 COMPLETED ON: NOVEMBER 11TH, 2020

NOT FOR CONSTRUCTION  
 REZONING ONLY

NO	DATE	REVISION/ISSUED
2	2021/12/09	RE-ISSUED FOR REZONING
1	2021/08/09	ISSUED FOR REZONING

**WSP** Landscape Architecture  
 100 Commerce Valley Drive West  
 Thornhill, ONT, Canada L3T 0A1  
 t 905-885-1100  
 f 905-882-0055  
 www.wsp.com

CLIENT  
 YEE HONG CENTRE FOR GERIATRIC CARE  
 C/O YEE HONG SENIOR LIVING

PROJECT TITLE  
 YEE HONG MISSISSAUGA  
 ("YHMSS")

SITE ADDRESS  
 5510 MAVIS ROAD  
 MISSISSAUGA, ON  
 L5V 2X5

MUNICIPALITY  
 CITY OF MISSISSAUGA  
 ON

DRAWING TITLE  
 LANDSCAPE DETAILS

STAMP

DESIGNED AK	DRAWN AK	CHECKED ML
SCALE AS SHOWN	DATE FEBRUARY 2021	
PROJECT NUMBER 211-01372-00	DWG. NUMBER LD1	

**1 DECIDUOUS TREE / ORNAMENTAL TREE PLANTING**

SCALE NTS

**2 CONIFEROUS TREE PLANTING**

SCALE NTS

- NOTES:
- SHRUBS SPECIFIED BARE ROOTS (B.R.) TO BE PLANTED SO THAT ROOTS ARE PLACED NATURALLY WITH SOIL MIX BACKFILLED CAREFULLY TO PREVENT ROOT DAMAGE.
  - PROVIDE 100 HIGH EARTH SAUCER AROUND SHRUB BED WITH 100 WIDE SMOOTH BED EDGE TO RETAIN MULCH.

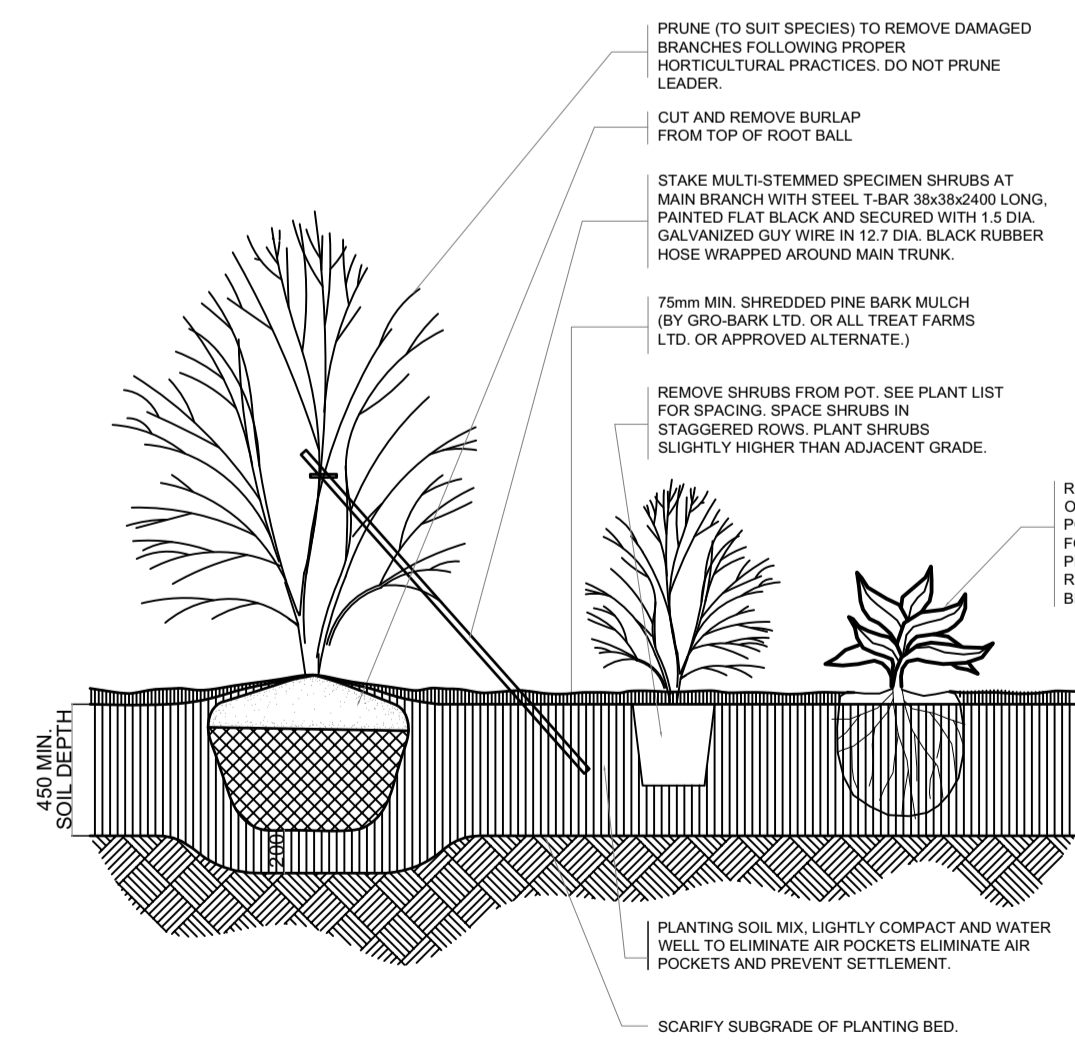

ON GRADE

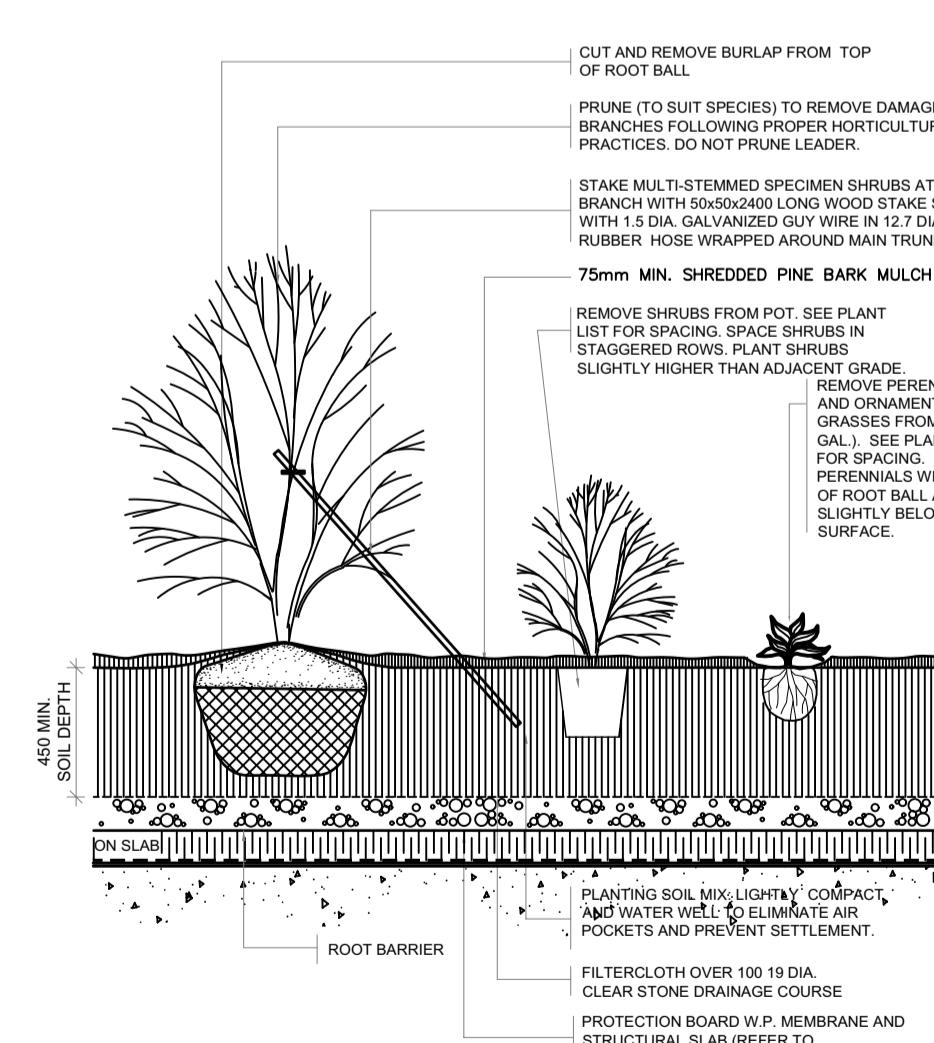

ON SLAB

- PRUNE (TO SUIT SPECIES) TO REMOVE DAMAGED BRANCHES FOLLOWING PROPER HORTICULTURAL PRACTICES. DO NOT PRUNE LEADER.
- CUT AND REMOVE BURLAP FROM TOP OF ROOT BALL
- STAKE MULTI-STEMMED SPECIMEN SHRUBS AT MAIN BRANCH WITH STEEL T-BARS 2000mm LONG, PAINTED FLAT BLACK AND SECURED WITH 1.5 DIA. GALVANIZED GUY WIRE IN 12.7 DIA. BLACK RUBBER HOSE WRAPPED AROUND MAIN TRUNK.
- 75mm MIN. SHREDDED PINE BARK MULCH (BY GRO-BARK LTD. OR ALL TREAT FARMS LTD. OR APPROVED ALTERNATE)
- REMOVE SHRUBS FROM POT. SEE PLANT LIST FOR SPACING. SPACE SHRUBS IN STAGGERED ROWS. PLANT SHRUBS SLIGHTLY HIGHER THAN ADJACENT GRADE.
- REMOVE PERENNIALS AND ORNAMENTAL GRASSES FROM POT (GAL.). SEE PLANT LIST FOR SPACING. PLANT PERENNIALS WITH TOP OF ROOT BALL AT OR SLIGHTLY BELOW SOIL SURFACE.
- PLANTING SOIL MIX. LIGHTLY COMPACT AND WATER WELL TO ELIMINATE AIR POCKETS AND PREVENT SETTLEMENT.
- SCARIFY SUBGRADE OF PLANTING BED.
- CUT AND REMOVE BURLAP FROM TOP OF ROOT BALL
- PRUNE (TO SUIT SPECIES) TO REMOVE DAMAGED BRANCHES FOLLOWING PROPER HORTICULTURAL PRACTICES. DO NOT PRUNE LEADER.
- STAKE MULTI-STEMMED SPECIMEN SHRUBS AT MAIN BRANCH WITH 2000mm LONG WOOD STAKE SECURED WITH 1.5 DIA. GALVANIZED GUY WIRE IN 12.7 DIA. BLACK RUBBER HOSE WRAPPED AROUND MAIN TRUNK.
- 75mm MIN. SHREDDED PINE BARK MULCH
- REMOVE SHRUBS FROM POT. SEE PLANT LIST FOR SPACING. SPACE SHRUBS IN STAGGERED ROWS. PLANT SHRUBS SLIGHTLY HIGHER THAN ADJACENT GRADE.
- REMOVE PERENNIALS AND ORNAMENTAL GRASSES FROM POT (GAL.). SEE PLANT LIST FOR SPACING. PLANT PERENNIALS WITH TOP OF ROOT BALL AT OR SLIGHTLY BELOW SOIL SURFACE.
- PLANTING SOIL MIX. LIGHTLY COMPACT AND WATER WELL TO ELIMINATE AIR POCKETS AND PREVENT SETTLEMENT.
- ROOT BARRIER
- PLANTING SOIL MIX. LIGHTLY COMPACT AND WATER WELL TO ELIMINATE AIR POCKETS AND PREVENT SETTLEMENT.
- PROTECTION BOARD W.P. MEMBRANE AND STRUCTURAL SLAB (REFER TO ARCHITECTURAL DWGS.)

**3 SHRUB / PERENNIAL / ORNAMENTAL GRASS PLANTING**

SCALE NTS

YYMMDD6/26/2021 8:55 AM  
 C:\Users\junfeng.LIU\SP\_03851\Thornhill LAID - Documents\2020\211-01372-00 - Yee Hong Mavis Retirement Home30 - Drawings\01 LANDSCAPE DETAILS.dwg