

PLAN OF TOPOGRAPHY OF
PART OF LOTS 3 AND 4,
RANGE 1,
SOUTH OF DUNDAS STREET
RACEY TRACT
(ORIGINALLY IN TOWNSHIP OF TORONTO)
CITY OF MISSISSAUGA
REGIONAL MUNICIPALITY OF PEELE

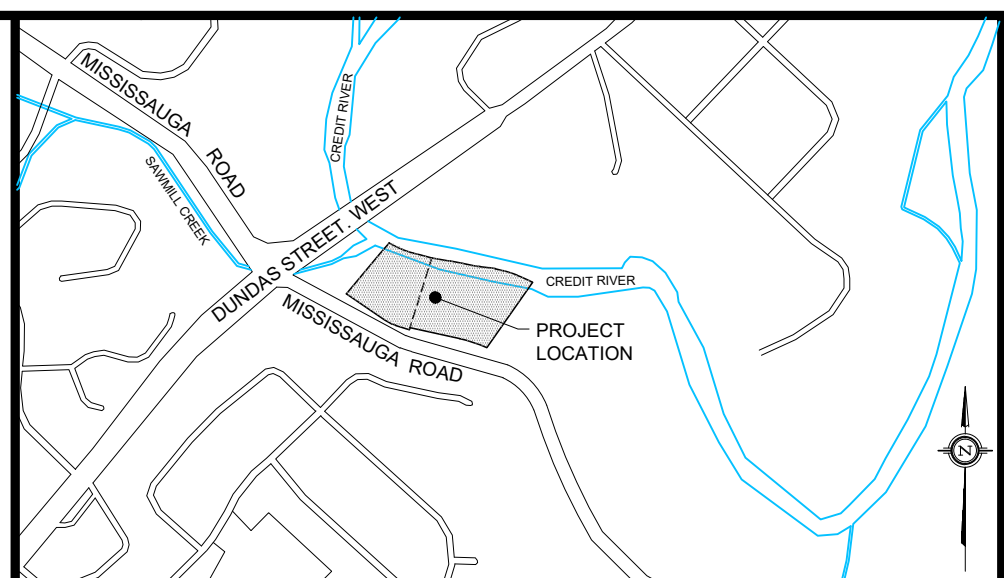

LEGEND

EXISTING	PROPOSED	DESCRIPTION
MH1	MH1	STORM MANHOLE
MH1A	MH1A	SANITARY MANHOLE
FD	FD	FLOOR DRAIN TO INTERNAL OGS
CB	CB	SINGLE CATCHBASIN
DCB	DCB	DOUBLE CATCHBASIN
HYD&V	HYD&V	FIRE HYDRANT
VB	VB	VALVE & BOX
---	---	SLOPE LINE (3:1 MAX)
---	---	CURRENT PROPERTY LIMIT
---	---	FUTURE PROPERTY LIMIT
---	---	SWALE
---	---	RIGHT OF WAY
---	---	LOT LINE
---	---	FENCE LINE
---	---	CURB/SIDEWALK
---	---	CONCRETE RETAINING WALL
---	---	PARKING GARAGE / CONCRETE WALL
---	---	STORM SEWER
---	---	SANITARY SEWER
---	---	WATERMAIN
---	---	FOREST DRIPLINE
---	---	ASPHALT SURFACE

- NOTES**
- ALL DIMENSIONS ARE IN METRES UNLESS OTHERWISE NOTED.
 - ALL DIMENSIONS SHALL BE CHECKED AND VERIFIED IN THE FIELD BY THE CONTRACTOR PRIOR TO ANY CONSTRUCTION, AND ANY DISCREPANCIES SHALL BE REPORTED IMMEDIATELY TO THE ENGINEER.
 - ALL WORK SHALL BE IN ACCORDANCE WITH CURRENT CITY OF MISSISSAUGA STANDARD SPECIFICATIONS AND DRAWINGS UNLESS OTHERWISE NOTED HEREIN.
 - ORDER OF PRECEDENCE OF STANDARDS DRAWINGS IS FIRSTLY CITY OF MISSISSAUGA, AND SECONDLY ONTARIO PROVINCIAL STANDARD DRAWINGS (OPSD).
 - THE CONTRACTOR TO BE RESPONSIBLE FOR LOCATION OF ALL EXISTING U/G AND OVERHEAD UTILITIES. CONTRACTOR IS REQUIRED TO OBTAIN ALL LOCATIONS & NOTIFY THE VARIOUS UTILITY COMPANIES 72 HOURS PRIOR TO THE COMMENCEMENT OF ANY WORK. THE CITY OF MISSISSAUGA AND CONSULTANT ASSUMES NO RESPONSIBILITY FOR THE ACCURACY OF THE LOCATIONS OF EXISTING UTILITIES AS INDICATED ON THIS DRAWING.

BENCHMARK
BENCHMARK: CITY OF MISSISSAUGA No. 58
ELEVATION = 108.293m
LOCATION: CITY OF MISSISSAUGA
DATED: DEC 10, 2019
COMPLETED BY:
TARASICK McMILLAN KUBICKI LTD.
ONTARIO LAND SURVEYORS
4181 SLADVIEW CRESCENT, UNIT 42, MISSISSAUGA, ONTARIO L5L 2R2
(905) 569-8849

NO.	REVISION	DATE	BY	APPROVED
01	ISSUED FOR FIRST SUBMISSION	2021/04/26	K.M.	

SCALE: 1:500

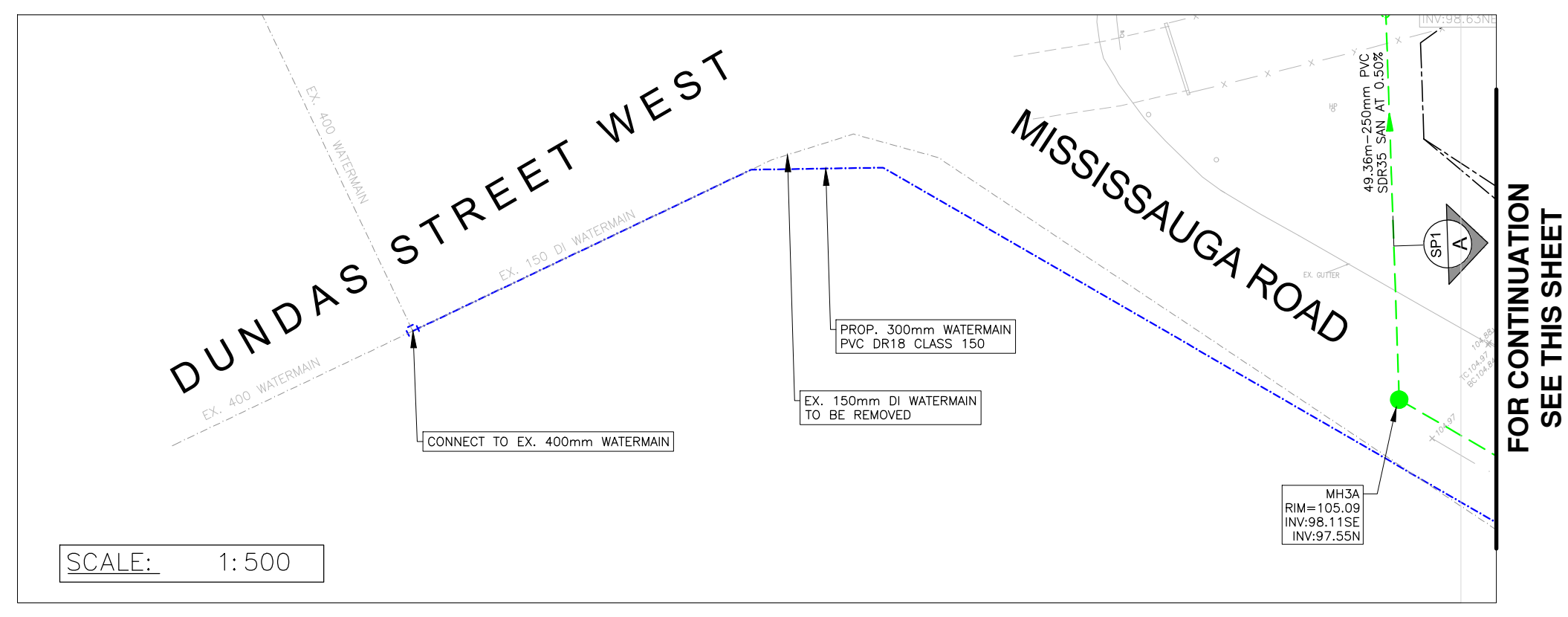

SCALE: 1:500

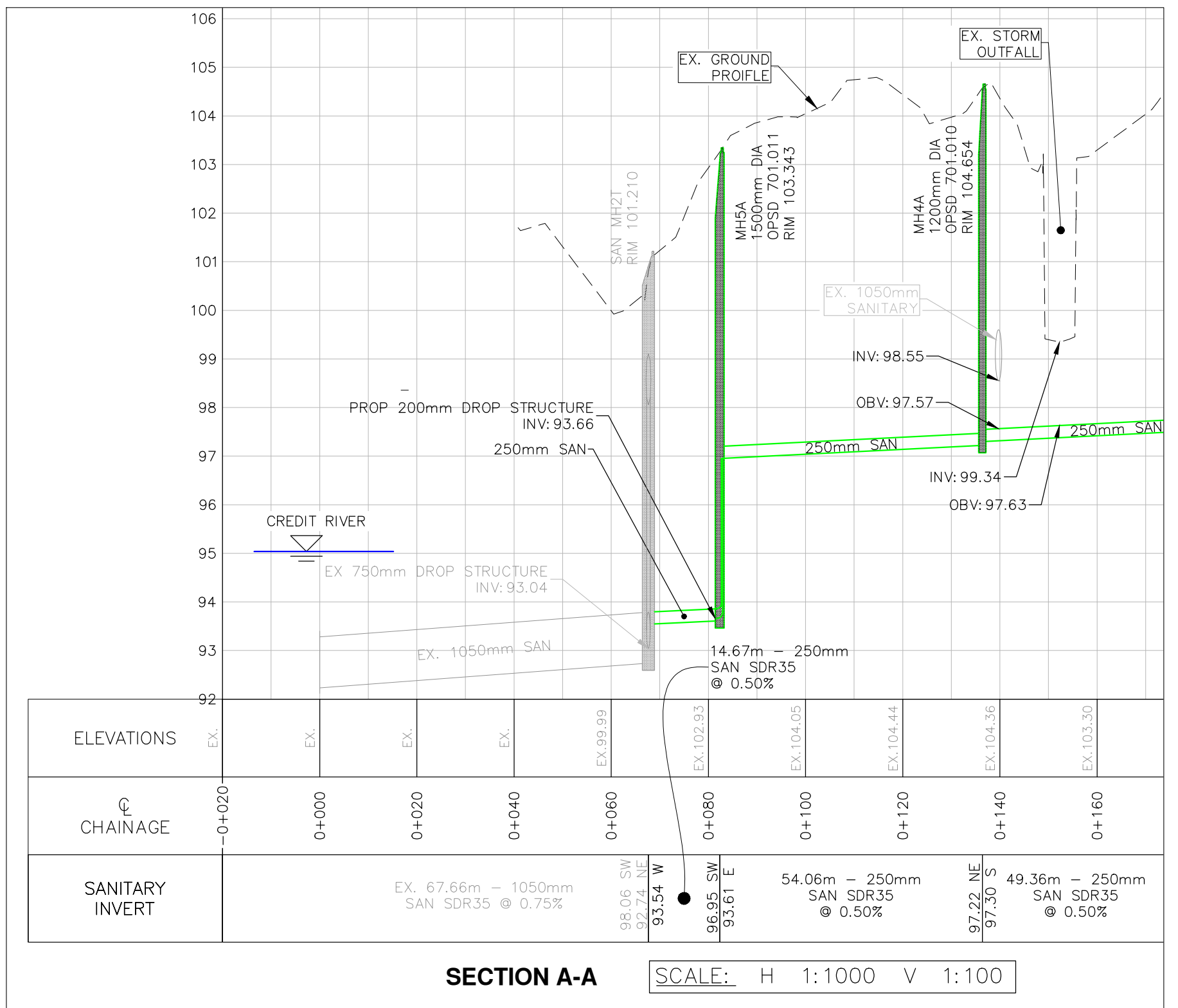

SUBMISSION DRAWING
NOT TO BE USED FOR CONSTRUCTION

Greck
5770 Highway 7
Woodbridge, Ontario
L4L 1T8

K. MAHMOOD
100160233
PROVINCE OF ONTARIO

CLIENT NAME:
590816 ONTARIO INC.
2616 CYNARA ROAD
MISSISSAUGA, ON L5B 2R7

PROJECT NAME:
2935 & 2955 MISSISSAUGA ROAD
MISSISSAUGA, ON

SERVICING PLAN

DESIGNED BY: E.P./K.M.	SCALES:	PROJECT No. 20-697
CHECKED BY: E.G.	HORIZONTAL: AS NOTED	DRAWING No. SP1
DRAWN BY: K.M.	VERTICAL: AS NOTED	SHEET No. 02
DATE: APR 26, 2021	SHEET SIZE: 24"x36"	