

DEPARTMENTS

- 05 MED/SURG
- 25 PUBLIC AREAS, RETAIL & AMENITY
- 32 CORPORATE SERVICES
- 34 MATERIALS MANAGEMENT
- CIRCULATION PAT/STAFF
- CIRCULATION PUBLIC
- ELEVATOR PAT/STAFF
- ELEVATOR PUBLIC
- ELEVATOR SERVICE - AGV
- ELEVATOR SERVICE/STAFF
- PLANT - COMMS
- PLANT - ELEC
- PLANT - MECH SHAFT
- STAIRS
- UNASSIGNED

1 DEPARTMENTAL ZONE STUDY - LEVEL 19
A-210 1:500

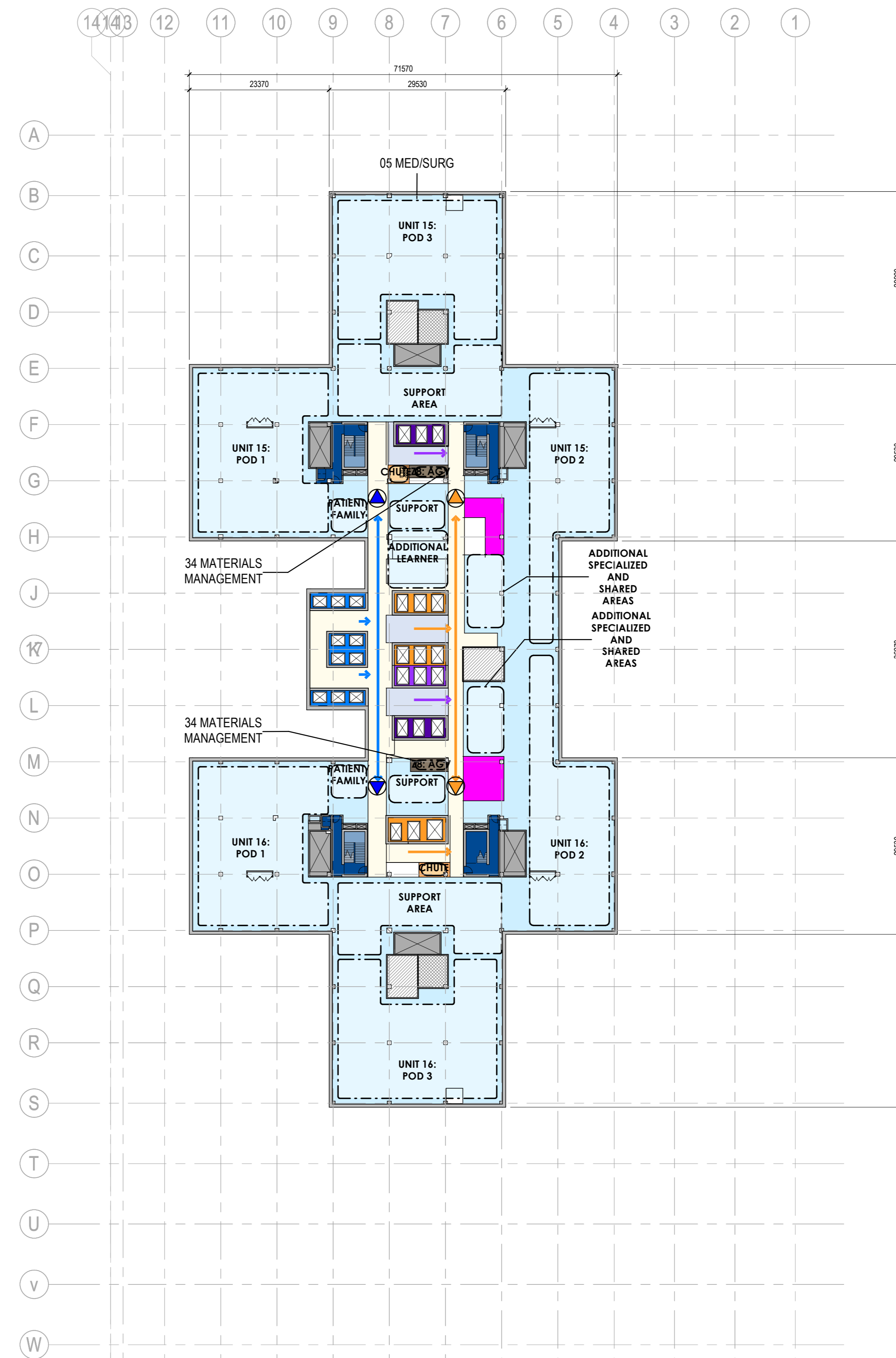

DEPARTMENTS

- 05 MED/SURG
- 32 CORPORATE SERVICES
- 34 MATERIALS MANAGEMENT
- CIRCULATION PAT/STAFF
- CIRCULATION PUBLIC
- ELEVATOR PAT/STAFF
- ELEVATOR PUBLIC
- ELEVATOR SERVICE - AGV
- ELEVATOR SERVICE/STAFF
- PLANT - COMMS
- PLANT - ELEC
- PLANT - MECH SHAFT
- STAIRS
- UNASSIGNED

2 DEPARTMENTAL ZONE STUDY - LEVEL 20
A-210 1:500

DEPARTMENTAL ZONE LEGEND

ACCESSIBLE TERRACE TYPE	
*INDICATES BALCONIES	
PROGRAMMED ROOF TERRACE (APPROX. 85% PAVING / 20% PLANTING)	
PROPOSED HARD LANDSCAPING	
PAVING AT GRADE ABOVE OCCUPIED BELOW-GRADE BUILDING AREA	
ROOF TYPE	
TYPE 1 - NON ACCESSIBLE VEGETATIVE ROOF (APPROX. 80% PLANTING / 20% GRAVEL SERVICE PATHS)	
TYPE 2 - NON ACCESSIBLE DECORATIVE GRAVEL ROOF	
TYPE 3 - TYPICAL FLAT ROOF	
TYPE 4 - HIGH SRI FLAT ROOF	
OTHER SYMBOLS	
ENTRANCE - PUBLIC	
ENTRANCE - PATIENT/STAFF	
ENTRANCE - SERVICE	
EMERGENCY EXIT	
TERRACE/ROOFTOP ACCESS	
FLOW LINE - PUBLIC	
FLOW LINE - PATIENT/STAFF	
FLOW LINE - SERVICE	
FLOW LINE - TRAUMA	
90 MIN FIRE SEPERATION (REFER TO L0)	

Issue/Revision	By	App'd	DATE
5			2021.12.04
4			2021.08.06
3			2021.05.11
2			2021.03.04
1			2020.12.18

CONFIDENTIAL PROJECT
NOT FOR CONSTRUCTION

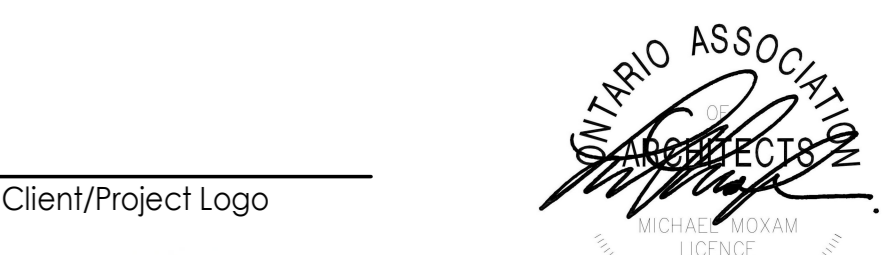

Client/Project
TRILLIUM HEALTH PARTNERS
NEW MISSISSAUGA HOSPITAL TOWER
PAM 21-323 W7
100 QUEENSWAY WEST & 2250 HURONTARIO ST
MISSISSAUGA ON

Title
LEVEL 19 AND 20 DEPARTMENTAL ZONE PLANS

Project No. 1400200191
Revision 5
Scale As Indicated
Drawing No. A-210

