

### DEPARTMENTS

- CIRCULATION PAT/STAFF
- ELEVATOR PAT/STAFF
- ELEVATOR PAT/STAFF - OVERRUN
- ELEVATOR PUBLIC - OVERRUN
- ELEVATOR SERVICE - AGV
- PLANT - ELEC
- PLANT - MECH SHAFT
- STAIRS
- UNASSIGNED

**1 DEPARTMENTAL ZONE STUDY - LEVEL 23 M&E PLANT**  
A-212 1:500

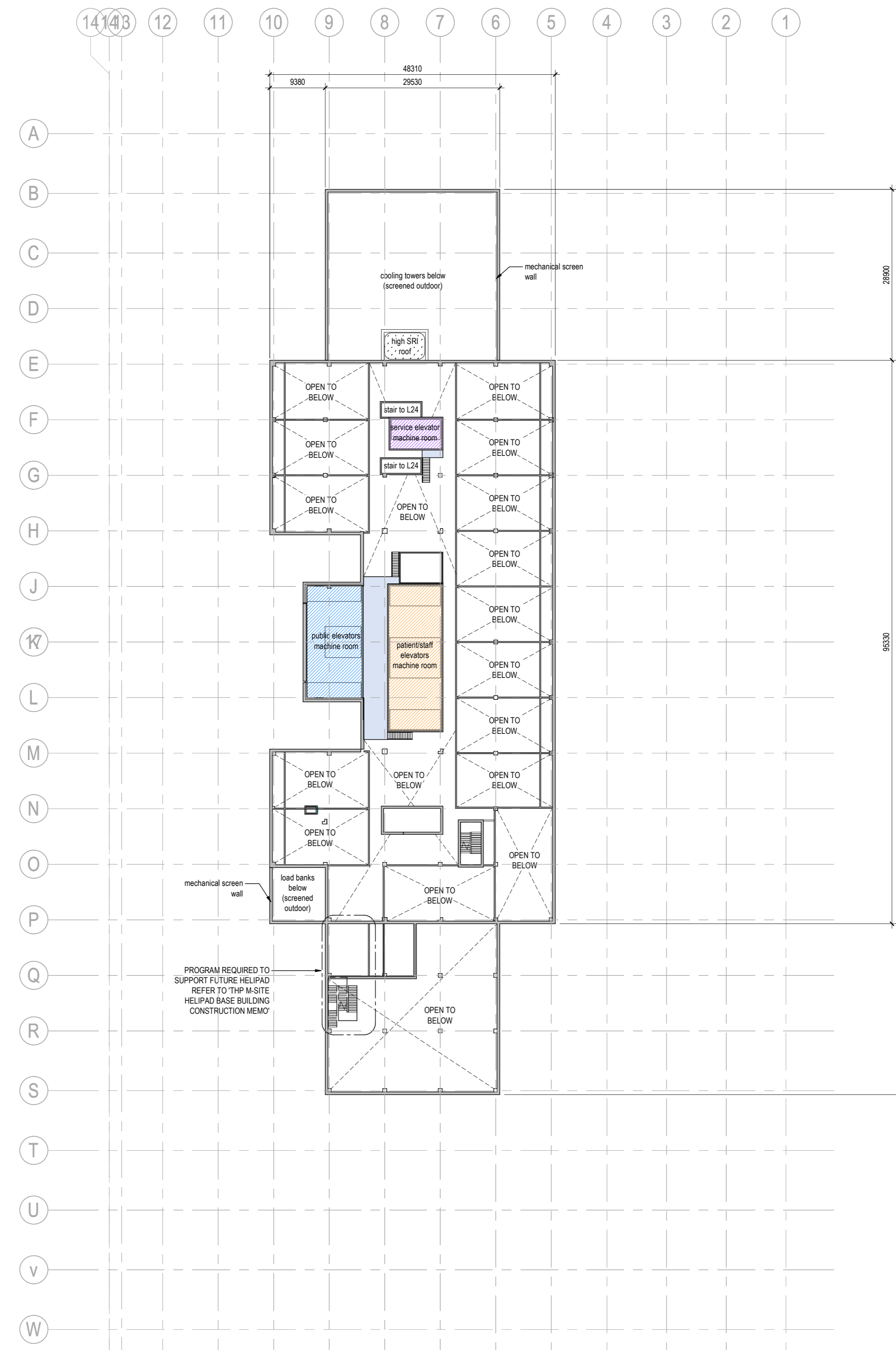

### DEPARTMENTS

- CIRCULATION PAT/STAFF
- ELEVATOR PAT/STAFF - OVERRUN
- ELEVATOR PUBLIC - OVERRUN
- ELEVATOR SERVICE - OVERRUN

**2 DEPARTMENTAL ZONE STUDY - LEVEL 23.1 M&E PLANT MEZZANINE**  
A-212 1:500

#### DEPARTMENTAL ZONE LEGEND

- ACCESSIBLE TERRACE TYPE**  
\*INDICATES BALCONIES
- PROGRAMMED ROOF TERRACE (APPROX. 80% PAVING / 20% PLANTING)
  - PROPOSED HARD LANDSCAPING
  - PAVING AT GRADE ABOVE OCCUPIED BELOW-GRADE BUILDING AREA
- ROOF TYPE**
- TYPE 1 - NON ACCESSIBLE VEGETATIVE ROOF (APPROX. 80% PLANTING / 20% GRAVEL SERVICE PATHS)
  - TYPE 2 - NON ACCESSIBLE DECORATIVE GRAVEL ROOF
  - TYPE 3 - TYPICAL FLAT ROOF
  - TYPE 4 - HIGH SRI FLAT ROOF
- OTHER SYMBOLS**
- ENTRANCE - PUBLIC
  - ENTRANCE - PATIENT/STAFF
  - ENTRANCE - SERVICE
  - EMERGENCY EXIT
  - TERRACE/ROOFTOP ACCESS
  - FLOW LINE - PUBLIC
  - FLOW LINE - PATIENT/STAFF
  - FLOW LINE - SERVICE
  - FLOW LINE - TRAUMA
  - 90 MIN FIRE SEPERATION (REFER TO I0)

Issue/Revision	By	App'd	DATE
5			2021.12.06
4			2021.08.06
3			2021.05.31
2			2021.03.04
1			2020.12.18

CONFIDENTIAL PROJECT  
**NOT FOR CONSTRUCTION**

Client/Project Logo



Client/Project  
TRILLIUM HEALTH PARTNERS  
NEW MISSISSAUGA HOSPITAL TOWER  
PAM 21-323 W7

100 QUEENSWAY WEST & 2250 HURONTARIO ST  
MISSISSAUGA ON

Title  
LEVEL 23 AND 23.1 DEPARTMENTAL  
ZONE PLANS

Project No. 1400200191 Scale As Indicated  
Revision Drawing No. A-212

