

QUEENSWAY WEST

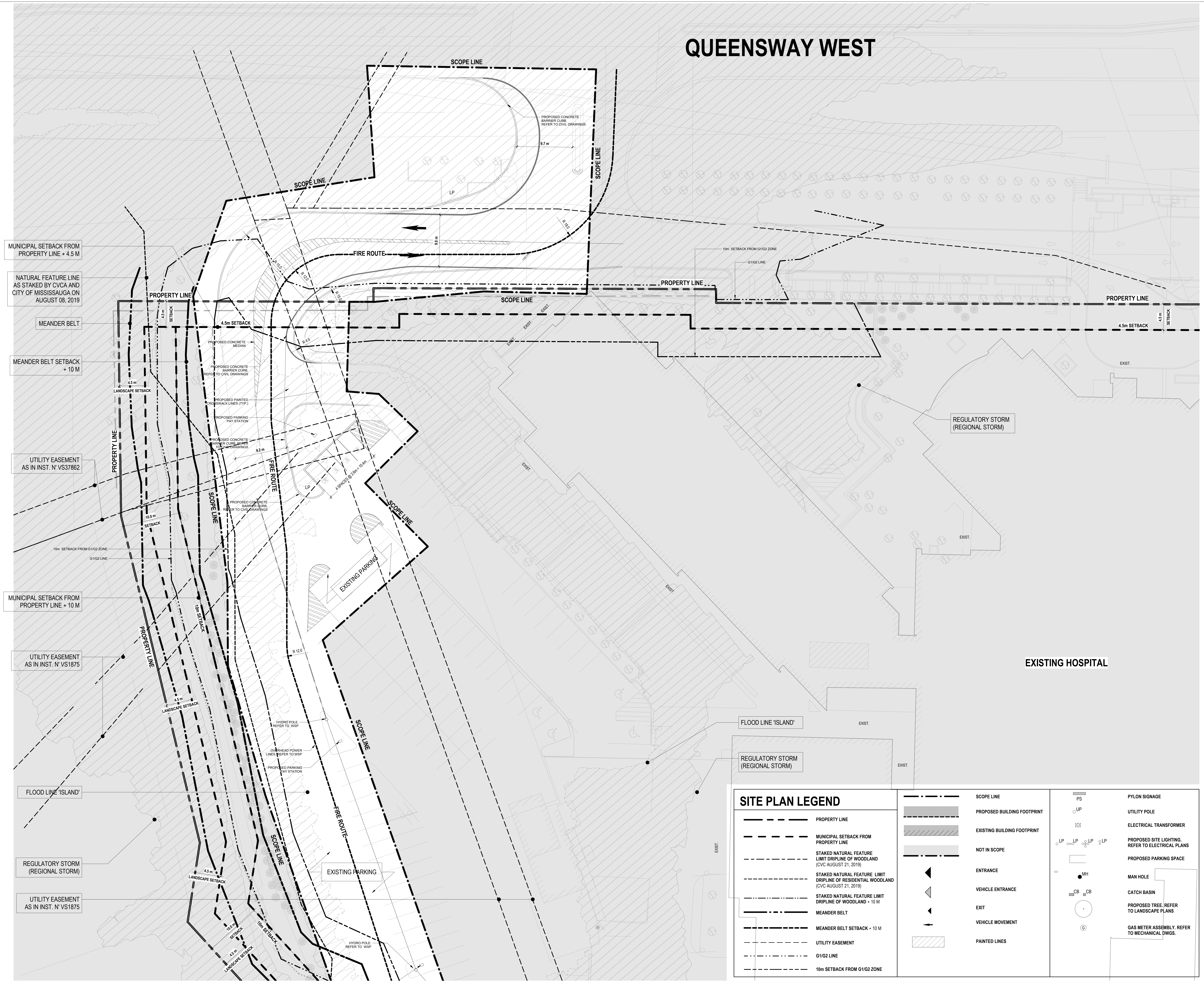

ISSUED FOR

1	2021-05-20	SCHEMATIC DESIGN
2	2021-06-25	QA 50%
3	2021-07-23	100% DESIGN DEVELOPMENT QA
4	2021-08-06	BID BP01
5	2021-08-06	BUILDING PERMIT
6	2021-08-06	SITE PLAN APPROVAL



- MUNICIPAL SETBACK FROM PROPERTY LINE + 4.5 M
- NATURAL FEATURE LINE AS STAKED BY CVCA AND CITY OF MISSISSAUGA ON AUGUST 08, 2019
- MEANDER BELT
- MEANDER BELT SETBACK + 10 M
- UTILITY EASEMENT AS IN INST. N° VS37862
- MUNICIPAL SETBACK FROM PROPERTY LINE + 10 M
- UTILITY EASEMENT AS IN INST. N° VS1875
- FLOOD LINE 'ISLAND'
- REGULATORY STORM (REGIONAL STORM)
- UTILITY EASEMENT AS IN INST. N° VS1875

METRIC
THIS DRAWING IS COPYRIGHTED AND MUST NOT BE USED, REPRODUCED, OR REVISED WITHOUT WRITTEN PERMISSION. ALL DIMENSIONS ARE IN MILLIMETERS UNLESS OTHERWISE NOTED. VERIFY DIMENSIONS. DO NOT SCALE THIS DRAWING.

REPORT INCONSISTENCIES AND OMISSIONS TO THE CONSULTANT FOR CLARIFICATION BEFORE COMMENCING WITH THE WORK. DEVIATIONS FROM THE CONTRACT DOCUMENTS WITHOUT WRITTEN APPROVAL FROM THE CONSULTANT ARE SUBJECT TO CORRECTION AT THE CONTRACTOR'S EXPENSE.

CLIENT
TRILLIUM HEALTH PARTNERS
150 DERRWAY DR. ETOBICOKE
TORONTO, ON M9C 1A5
TEL: (416) 299-8511 WEBSITE: trilliumhealthpartners.ca

CONSTRUCTION MANAGER
KENADAN CONTRACTING LTD.
780 DERRFORD DRIVE
MISSISSAUGA, ON L5N 0G5
TEL: (905) 910-2680 WEBSITE: www.kenadan.com/

ARCHITECT & PRIME CONSULTANT
DIALOG
35 JOHN STREET, SUITE 500
TORONTO, ON M5V 1G8
TEL: (416) 966-0220 WEBSITE: dialogdesign.ca

STRUCTURAL ENGINEER
DIALOG

MECHANICAL ENGINEER
DIALOG

ELECTRICAL ENGINEER
DIALOG

LANDSCAPE ARCHITECT
DIALOG

CIVIL ENGINEER
MTE CONSULTANTS INC.
1018 SUTTON DRIVE, UNIT A
BURLINGTON, ON L7R 1B8
TEL: (905) 639-2322 WEBSITE: mte85.com

SECURITY
THE ATARM GROUP INC.
288-180 WOODWARD DRIVE
OTTAWA, ON K2C 2R7
TEL: (613) 617-5999 WEBSITE: theatarmgroup.com

SIGNAGE AND WAYFINDING
ENTRO
33 HARBOUR SQUARE, SUITE 202
TORONTO, ON M5J 2G2
TEL: (416) 368-6868 WEBSITE: entro.com

VIBRATION, NOISE, ACOUSTICS
SWALLOW ACOUSTICS CONSULTANTS LTD.
23366 REVELS AVENUE
MISSISSAUGA, ON L5G 4S5
TEL: (905) 271-1668 WEBSITE: throntonnoiseitb.com

BUILDING CODE
LRI ENGINEERING INC.
171 UNIVERSITY AVE. 3RD FLOOR, BOX 1
TORONTO, ON M5H 1B3
TEL: (416) 515-9331 WEBSITE: lri.ca

VERTICAL TRANSPORTATION
SOBEMAN ENGINEERING INC.
55 ST. CLAIR AVENUE WEST, SUITE 205
TORONTO, ON M5V 1Y7
TEL: (416) 323-1133 WEBSITE: sobemanengineering.com

HARDWARE
SPYDER SC
35 HILDA RD.
WOODBRIDGE, ON L4H 3M5
TEL: (847) 271-6489 WEBSITE: spydersc.com

KEYPLAN

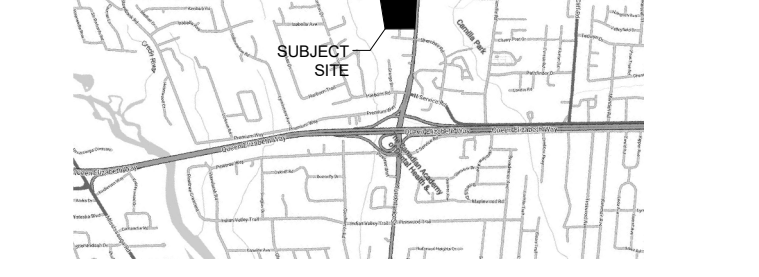

SEAL

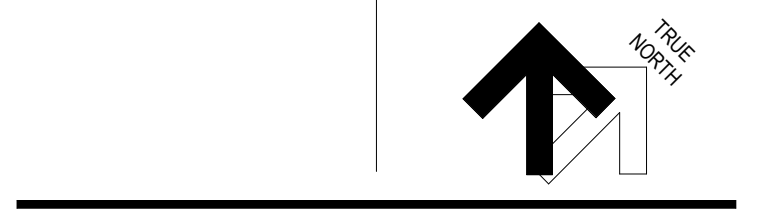

THP M-SITE HOSPITAL PARKING STRUCTURE

MISSISSAUGA HOSPITAL
100 QUEENSWAY WEST
MISSISSAUGA, ONTARIO
L5B 1B8

SITE PLAN NEW CONSTRUCTION - PART 4

DRAWN: Author CHECKED: Checker
PLOT DATE: 8/13/2021 12:17:57 PM

A124

SITE PLAN LEGEND

	PROPERTY LINE		PROPOSED BUILDING FOOTPRINT		PYLON SIGNAGE
	MUNICIPAL SETBACK FROM PROPERTY LINE		EXISTING BUILDING FOOTPRINT		UTILITY POLE
	STAKED NATURAL FEATURE LIMIT DRIPLINE OF WOODLAND (CVC AUGUST 21, 2019)		NOT IN SCOPE		ELECTRICAL TRANSFORMER
	STAKED NATURAL FEATURE LIMIT DRIPLINE OF RESIDENTIAL WOODLAND (CVC AUGUST 21, 2019)		ENTRANCE		PROPOSED SITE LIGHTING, REFER TO ELECTRICAL PLANS
	STAKED NATURAL FEATURE LIMIT DRIPLINE OF WOODLAND + 10 M		VEHICLE ENTRANCE		PROPOSED PARKING SPACE
	MEANDER BELT		EXIT		MAN HOLE
	MEANDER BELT SETBACK + 10 M		VEHICLE MOVEMENT		CATCH BASIN
	UTILITY EASEMENT		PAINTED LINES		PROPOSED TREE, REFER TO LANDSCAPE PLANS
	G1/G2 LINE				GAS METER ASSEMBLY, REFER TO MECHANICAL DWGS.
	10m SETBACK FROM G1/G2 ZONE				

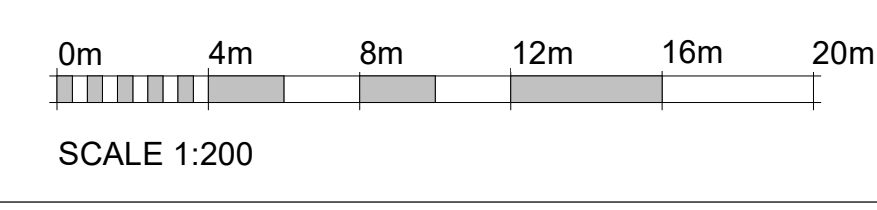

SITE PLAN NEW CONSTRUCTION - PART 4
SCALE: 1:200