

W

Appendix W: LIGHTING EVALUATION REPORT



Engineering
for **people**

Street Lighting

Photometric Report

Lakeshore Road West & Clarkson Road Reconstruction

City of Mississauga

Yan Jiang, M.Eng, P.Eng
PEO : 100541121



500-5935 Airport Road,
Mississauga, ON L4V 1W5
T. 905-695-1005
F. 905-695-0525
www.cima.ca

Lakeshore Rd and Clarkson Rd Reconstruction

Ref. Number : B001266

Prepared by : Yan Jiang

File : [B001266 Lighting Calc_e01.AGI](#)

Client :



Date : 9/23/2022

AGI32® Version 19.13.0

Page 1 of 8

PHOTOMETRIC REQUIREMENTS

Lakeshore Road West

Street Identification : Arterial
Sector : Urban
Pedestrian Conflict Identification : Medium
Existing Lighting Level : N/A Lux

Avg. Maintained Luminance - Lavg : 0.9 cd/m²
Uniformity - Lavg/Lmin : 3
Uniformity - Lmax/Lmin : 5
Veiling Luminance Ratio - Lvmax/Lavg : 30 %

Avg. Maintained Illuminance - Eavg : 13 Lux
Uniformity - Eavg/Emin : 3

Lakeshore Road West & Clarkson Road N & S Intersection

Street Identification : Arterial/Arterial
Sector : Urban
Pedestrian Conflict Identification : Medium
Existing Lighting Level : N/A Lux

Avg. Maintained Illuminance - Eavg : 26 Lux
Uniformity - Eavg/Emin : 3

Sidewalk / Bikeway

Sector : Urban
Pedestrian Conflict Identification : Medium

Avg. Maintained Horizontal Illuminance - Ehavg : 5 Lux
Uniformity - Ehavg/Ehmin : 4
Avg. Maintained Vertical Illuminance - Evavg : 2 Lux

DESIGN - PLAN VIEW

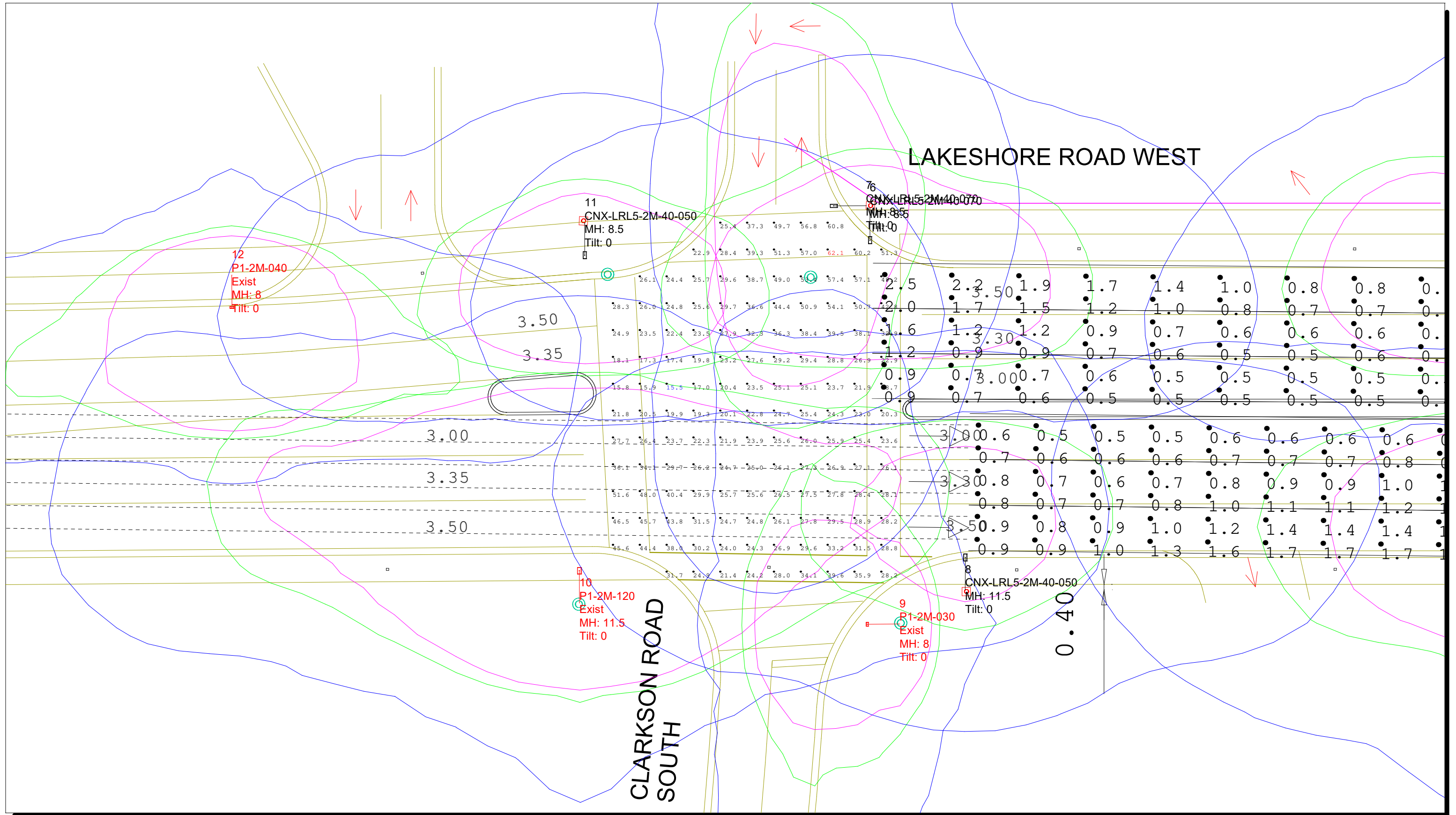

DESIGN - ISOMETRIC VIEW

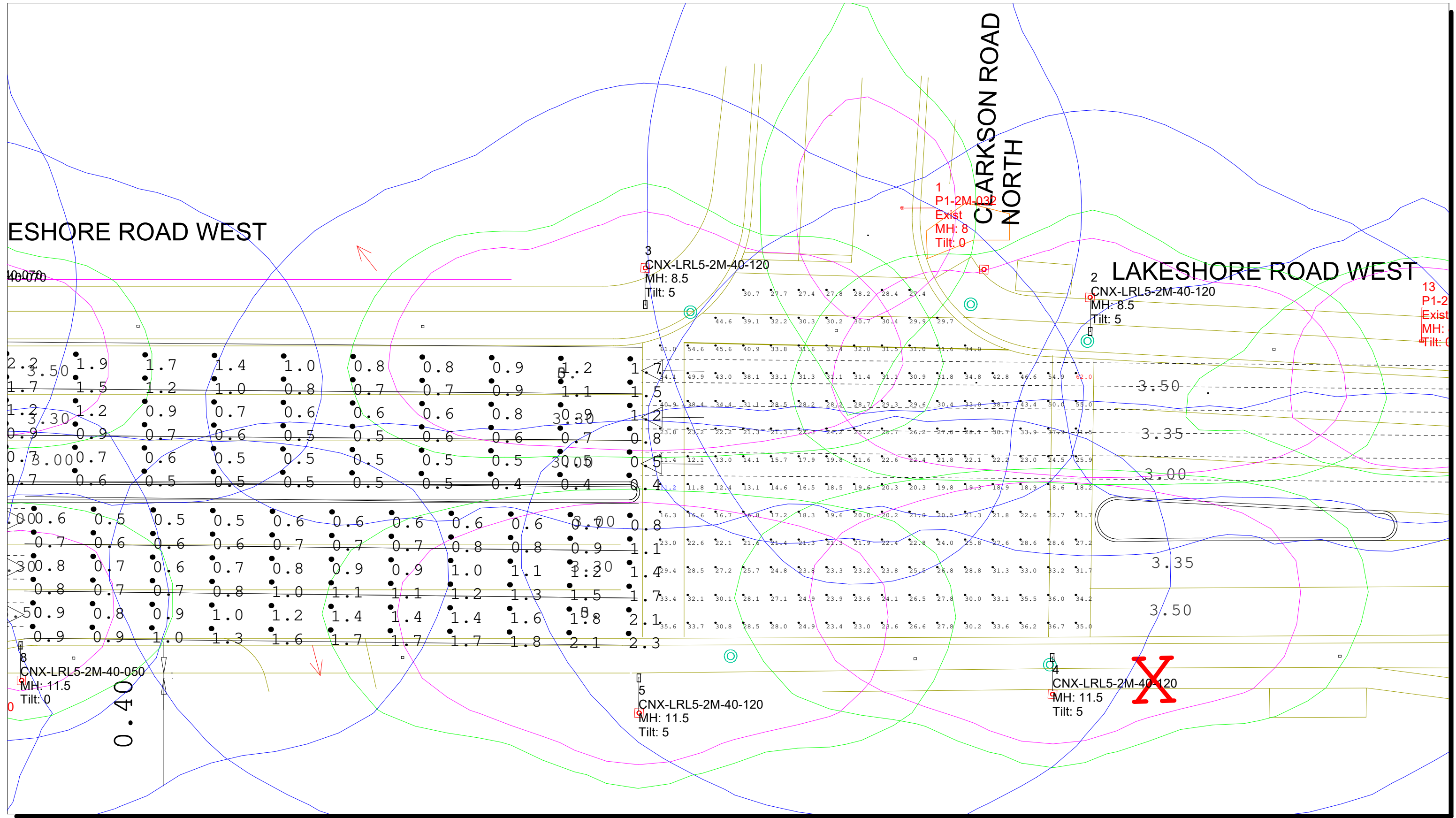

600-5008 Air South Road Blvd.
 Mississauga, ON L4V 1W5
 T. (905) 695-7062
 F. (905) 666-2453
 www.cima.ca

Lakeshore Rd and Clarkson Rd Reconstruction
 Ref. Number : B001266
 Prepared by : CIMA
 File : B001266 Lighting Calc_e01.AGI

Client :

 MISSISSAUGA

Date : 9/23/2022
 AGI32® Version 19.13.0
 Page 4 of 8

DISCLAIMER :
 The calculations are carried out according to IES and TAC standards and practices. There may be significant difference between the measured values and the calculated values. This difference is due to tolerances in the calculation methods, test procedures, component performance, measurement techniques and to the site conditions, such as voltage and temperature variations. Data used to perform the calculations, room dimensions, reflectances, furniture and architectural elements affect the lighting calculations significantly. If the actual environmental conditions do not match the data, there will be significant differences between the actual values and the calculated values.

DESIGN - ISOMETRIC VIEW

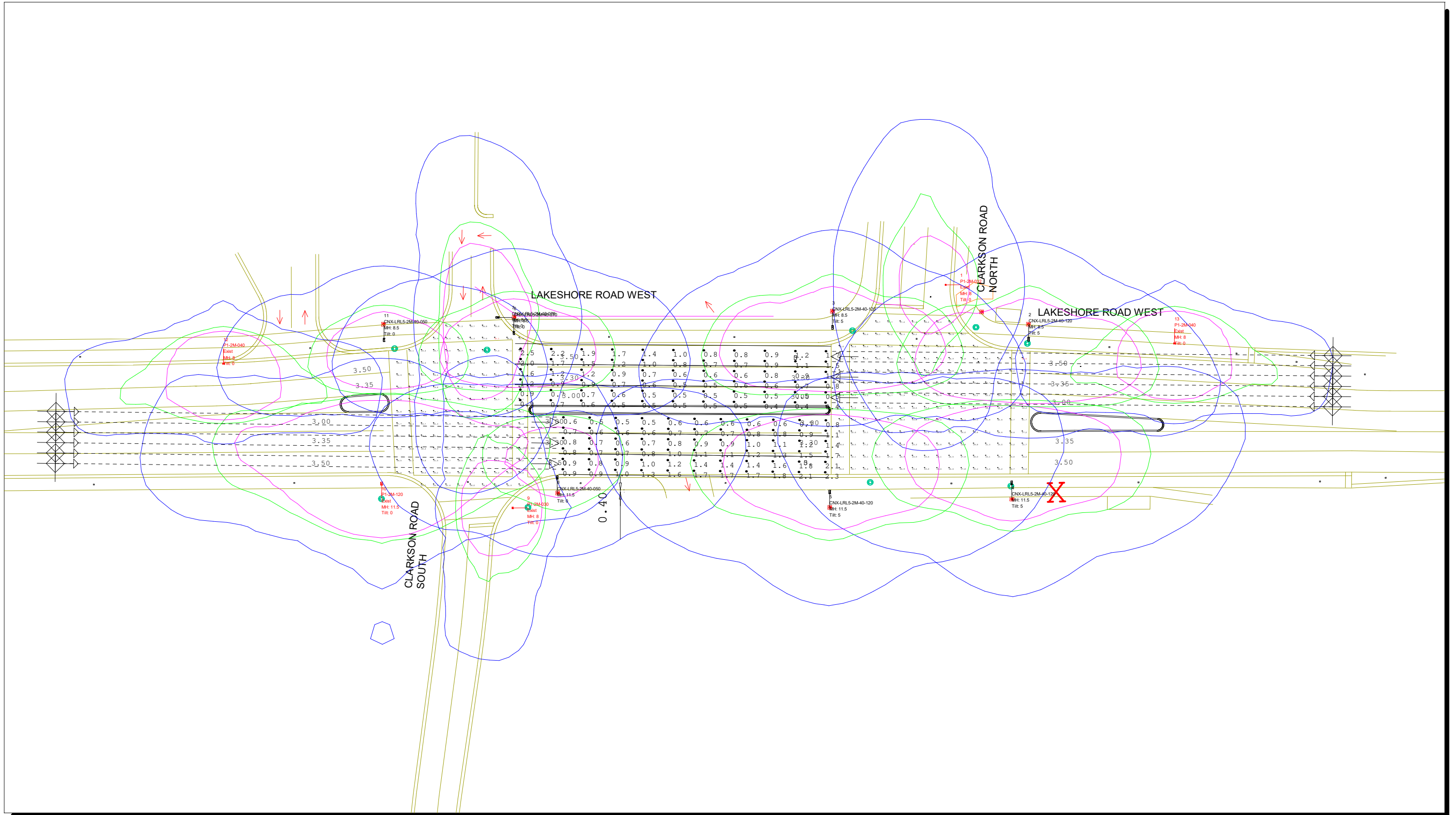

LUMINAIRE DEFINITIONS

| Luminaire Schedule | | | | | | | | | | | | |
|--------------------|--------------------|------------------------|-------------|-------------|-------|-----------|-------------|--------------|------------|------------|-------|--|
| Symbol | Label | Filename | Lamp Lumens | Lum. Lumens | LLF | IES Class | Long. Class | Cutoff Class | BUG Rating | Lum. Watts | Tag | |
| —■ | P1-2M-032 | P1-2M-032.IES | N.A. | 7652 | 0.850 | Type II | Medium | N.A. | B2-U0-G2 | 72.32 | Exist | |
| —■ | P1-2M-120 | P1-2M-120.IES | 25035.69 | 25036 | 0.850 | Type II | Short | Full Cutoff | B3-U0-G3 | 262.57 | Exist | |
| —■ | P1-2M-040 | P1-2M-040.IES | N.A. | 8109 | 0.850 | Type II | Medium | N.A. | B2-U0-G1 | 91.24 | Exist | |
| —■ | P1-2M-030 | P1-2M-030.ies | 6460.5 | 6461 | 0.850 | Type II | Short | Full Cutoff | B2-U0-G1 | 67.88 | Exist | |
| —■ | CNX-LRL5-2M-40-120 | CNX-LRL5-2M-40-120.IES | 18467 | 18468 | 0.850 | Type II | Short | Full Cutoff | B3-U0-G3 | 119.022 | | |
| —■ | CNX-LRL5-2M-40-070 | CNX-LRL5-2M-40-070.IES | 10939 | 10938 | 0.850 | Type II | Short | Semi-Cutoff | B2-U0-G2 | 72.0498 | | |
| —■ | CNX-LRL5-2M-40-050 | CNX-LRL5-2M-40-050.IES | 7600 | 7599 | 0.850 | Type II | Short | Semi-Cutoff | B2-U0-G2 | 50 | | |

| Luminaire Schedule | | | | | | | |
|--------------------|--------------------|---------------------------------|-------------|-----|-----|-------|--|
| Symbol | Label | Description | Arrangement | Arm | Qty | Tag | |
| —■ | P1-2M-032 | CNX-LRL4-2M-42-032-M-XXX-700 | SINGLE | 2.4 | 1 | Exist | |
| —■ | P1-2M-120 | CNX-LRL3-P1-2M-42-120-L-700 | SINGLE | 2.4 | 1 | Exist | |
| —■ | P1-2M-040 | CNX-LRL3-P1-2M-42-040-S-XXX-700 | SINGLE | 2.4 | 2 | Exist | |
| —■ | P1-2M-030 | LRL3-P1-2M-42-030-S-XXX-700 | SINGLE | 2.4 | 1 | Exist | |
| —■ | CNX-LRL5-2M-40-120 | | SINGLE | 2.4 | 4 | | |
| —■ | CNX-LRL5-2M-40-070 | | SINGLE | 2.4 | 2 | | |
| —■ | CNX-LRL5-2M-40-050 | | SINGLE | 2.4 | 2 | | |

RESULTS

| Calculation Summary | | | | | | | | | | |
|------------------------------|-------------------|---------|-------|------|------|---------|---------|------------|---------|--------|
| Label | CalcType | Units | Avg | Max | Min | Avg/Min | Max/Min | Meter Type | LVRatio | RTable |
| Lakeshore & Clarkson N Inter | Illuminance | Lux | 28.02 | 62.0 | 11.2 | 2.50 | 5.54 | Horizontal | N.A. | N.A. |
| Lakeshore & Clarkson S Inter | Illuminance | Lux | 31.09 | 62.1 | 15.5 | 2.01 | 4.01 | Horizontal | N.A. | N.A. |
| Lakeshore EB_Illum | Illuminance | Lux | 14.09 | 35.8 | 7.3 | 1.93 | 4.90 | Horizontal | N.A. | N.A. |
| Lakeshore EB_Luminance | Luminance | Cd/Sq.m | 1.03 | 2.3 | 0.5 | 2.06 | 4.60 | Horizontal | N.A. | R3 |
| Lakeshore EB_Veil_Lum | Veiling Luminance | Cd/Sq.m | N.A. | N.A. | N.A. | N.A. | N.A. | Horizontal | 0.39 | R3 |
| Lakeshore WB_Illum | Illuminance | Lux | 15.60 | 57.1 | 4.7 | 3.32 | 12.15 | Horizontal | N.A. | N.A. |
| Lakeshore WB_Luminance | Luminance | Cd/Sq.m | 0.91 | 2.5 | 0.4 | 2.28 | 6.25 | Horizontal | N.A. | R3 |
| Lakeshore WB_Veil_Lum | Veiling Luminance | Cd/Sq.m | N.A. | N.A. | N.A. | N.A. | N.A. | Horizontal | 0.44 | R3 |



600-5008 Air Road Blvd.
Mississauga, ON L4V 1W5
T. 905-695-7062
F. 905-688-2453
www.cima.ca

Lakeshore Rd and Clarkson Rd Reconstruction

Ref. Number : B001266 No CIMA

Prepared by : CIMA's Name

File : B001266 Lighting Calc_e01.AGI

Client :



Date : 9/23/2022

AGI32® Version 19.13.0

Page 7 of 8

DISCLAIMER :
The calculations are carried out according to IES and TAC standards and practices. There may be significant difference between the measured values and the calculated values. This difference is due to tolerances in the calculation methods, test procedures, component performance, measurement techniques and to the site conditions, such as voltage and temperature variations. Data used to perform the calculations, room dimensions, reflectances, furniture and architectural elements affect the lighting calculations significantly. If the actual environmental conditions do not match the data, there will be significant differences between the actual values and the calculated values.

LUMINAIRE LOCATION

| Luminaire Location Summary | | | | | | | | | | |
|----------------------------|--------------------|---------|---------|------|---------|------|------|------|----------|---------|
| LumNo | Label | X | Y | Z | Orient | Tilt | Roll | Spin | Switched | Dimming |
| 1 | P1-2M-032 | 43.857 | 16.753 | 8 | 180.336 | 0 | 0 | 0 | On | 1.00 |
| 2 | CNX-LRL5-2M-40-120 | 55.085 | 10.235 | 8.5 | 268.829 | 5 | 0 | 0 | On | 1.00 |
| 3 | CNX-LRL5-2M-40-120 | 22.913 | 12.162 | 8.5 | 270.403 | 5 | 0 | 0 | On | 1.00 |
| 4 | CNX-LRL5-2M-40-120 | 52.321 | -18.062 | 11.5 | 90.543 | 5 | 0 | 0 | On | 1.00 |
| 5 | CNX-LRL5-2M-40-120 | 22.456 | -19.554 | 11.5 | 89.664 | 5 | 0 | 0 | On | 1.00 |
| 6 | CNX-LRL5-2M-40-070 | -29.258 | 11.244 | 8.5 | 270.35 | 0 | 0 | 0 | On | 1.00 |
| 7 | CNX-LRL5-2M-40-070 | -29.547 | 11.411 | 8.5 | 180.213 | 0 | 0 | 0 | On | 1.00 |
| 8 | CNX-LRL5-2M-40-050 | -22.153 | -17.202 | 11.5 | 89.654 | 0 | 0 | 0 | On | 1.00 |
| 9 | P1-2M-030 | -27.045 | -19.755 | 8 | 180.449 | 0 | 0 | 0 | On | 1.00 |
| 10 | P1-2M-120 | -50.9 | -18.187 | 11.5 | 90.276 | 0 | 0 | 0 | On | 1.00 |
| 11 | CNX-LRL5-2M-40-050 | -50.518 | 10.122 | 8.5 | 270.226 | 0 | 0 | 0 | On | 1.00 |
| 12 | P1-2M-040 | -76.818 | 6.24 | 8 | 270.303 | 0 | 0 | 0 | On | 1.00 |
| 13 | P1-2M-040 | 78.957 | 9.548 | 8 | 269.54 | 0 | 0 | 0 | On | 1.00 |