

407 CORRIDOR LIMIT

FUT. TRANSITWAY (B.O.)

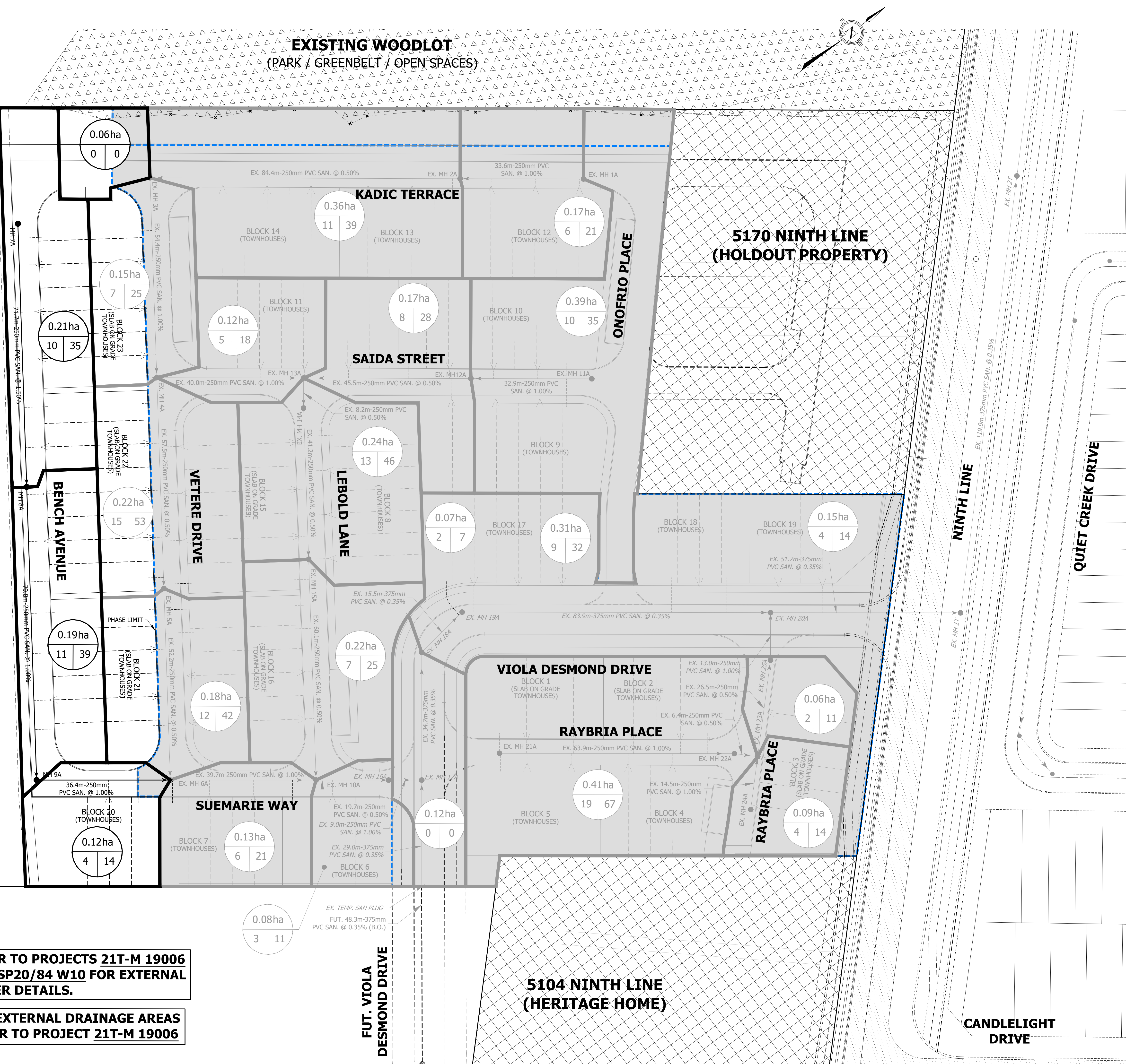

REFER TO PROJECTS 21T-M 19006 AND SP20/84 W10 FOR EXTERNAL SEWER DETAILS.

FOR EXTERNAL DRAINAGE AREAS REFER TO PROJECT 21T-M 19006

0.08ha
3 11

FUT. VIOLA DESMOND DRIVE

5104 NINTH LINE (HERITAGE HOME)

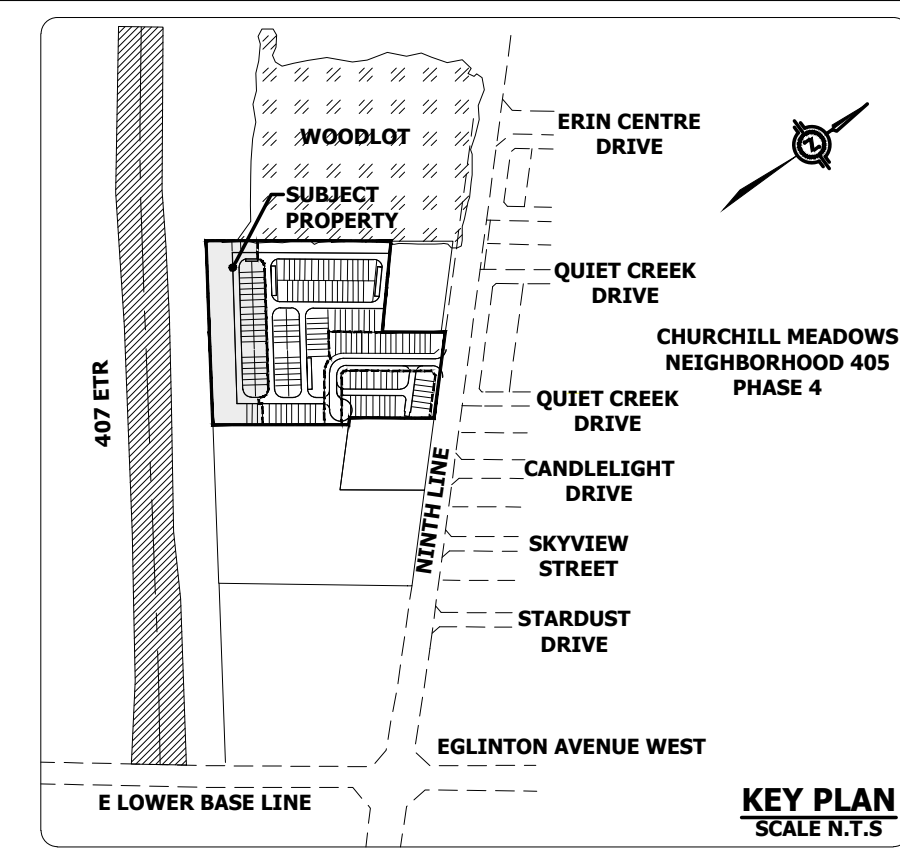

- LEGEND**
- SANITARY SEWER AND MANHOLE
 - EXISTING SANITARY SEWER AND MANHOLE
 - FUTURE SANITARY SEWER AND MANHOLE
 - 0.10 Ha. DRAINAGE AREA (Ha.)
 - 70 7 POPULATION (3.5 PPU)
 - NUMBER OF UNITS
 - ▬ DRAINAGE AREA BOUNDARY
 - ▬ EXTERNAL DRAINAGE AREA BOUNDARY
 - ▬ EXTERNAL WORKS

BENCHMARK:
ELEVATIONS ARE REFERRED TO THE CITY OF MISSISSAUGA CONTROL MONUMENT No. 075033001, A BRASS CAP IN CONCRETE CYLINDER, LOCATED 9m ON EAST SIDE OF THE CENTRELINE OF NINTH LINE, 14m NORTH OF THE CENTRELINE OF ROADSIDE WAY, HAVING A PUBLISHED ELEVATION OF 193.80 METRES.

No.	REVISION	DATE	BY
5			
4			
3	ISSUED FOR THIRD SUBMISSION	AUG 2022	S.R.
2	ISSUED FOR SECOND SUBMISSION	JUNE 2022	S.R.
1	ISSUED FOR FIRST SUBMISSION	MAR. 2022	S.R.



URBANTECH® Consulting
A Division of Leighton-Zec Ltd.
3760 14th Avenue, Suite 301,
Markham, ON, L3R 3T7
TEL. 905.946.9461 • urbantech.com

5150 NINTH LINE SOUTH
MEDIUM DENSITY BLOCK
MATTAMY (5150 NINTH LINE) LIMITED
7880 KEELE STREET
VAUGHAN, ON, L4K 4G7
(905)-907-8888

Region of Peel
Working for you



SANITARY DRAINAGE PLAN

PROJECT #:	19-608	DRAWING:	
SITE PLAN FILE No.:			
SUBDIVISION FILE No.:			
CITY FILE No.:			
REGION CONNECTION FILE No.:			
DESIGNED:	Z.K.	CHECKED:	S.R.
DRAWN:	Z.K.	DATE:	JULY 2020
SCALE:	1:500		