

PLOT DATE: October 31, 2022 1:41:19 PM

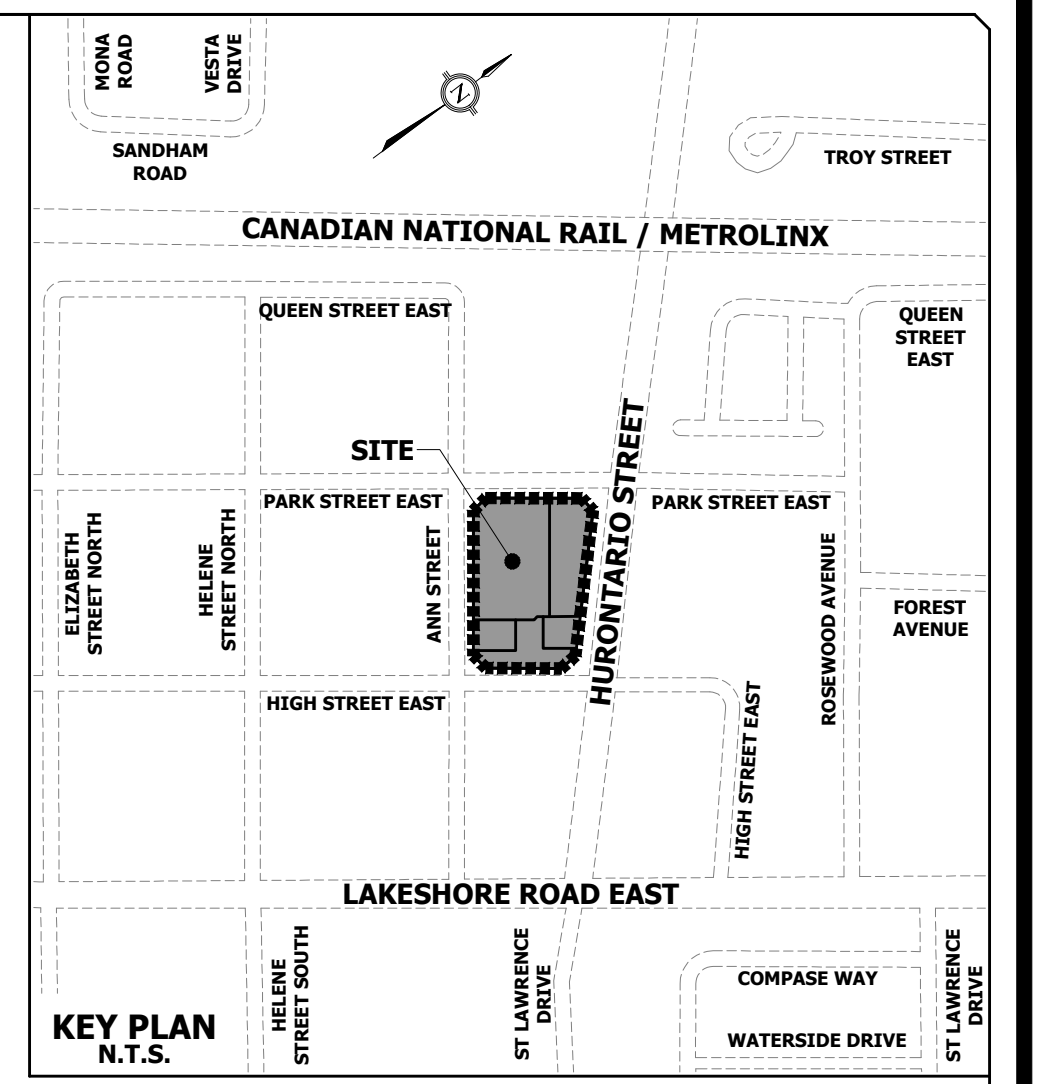
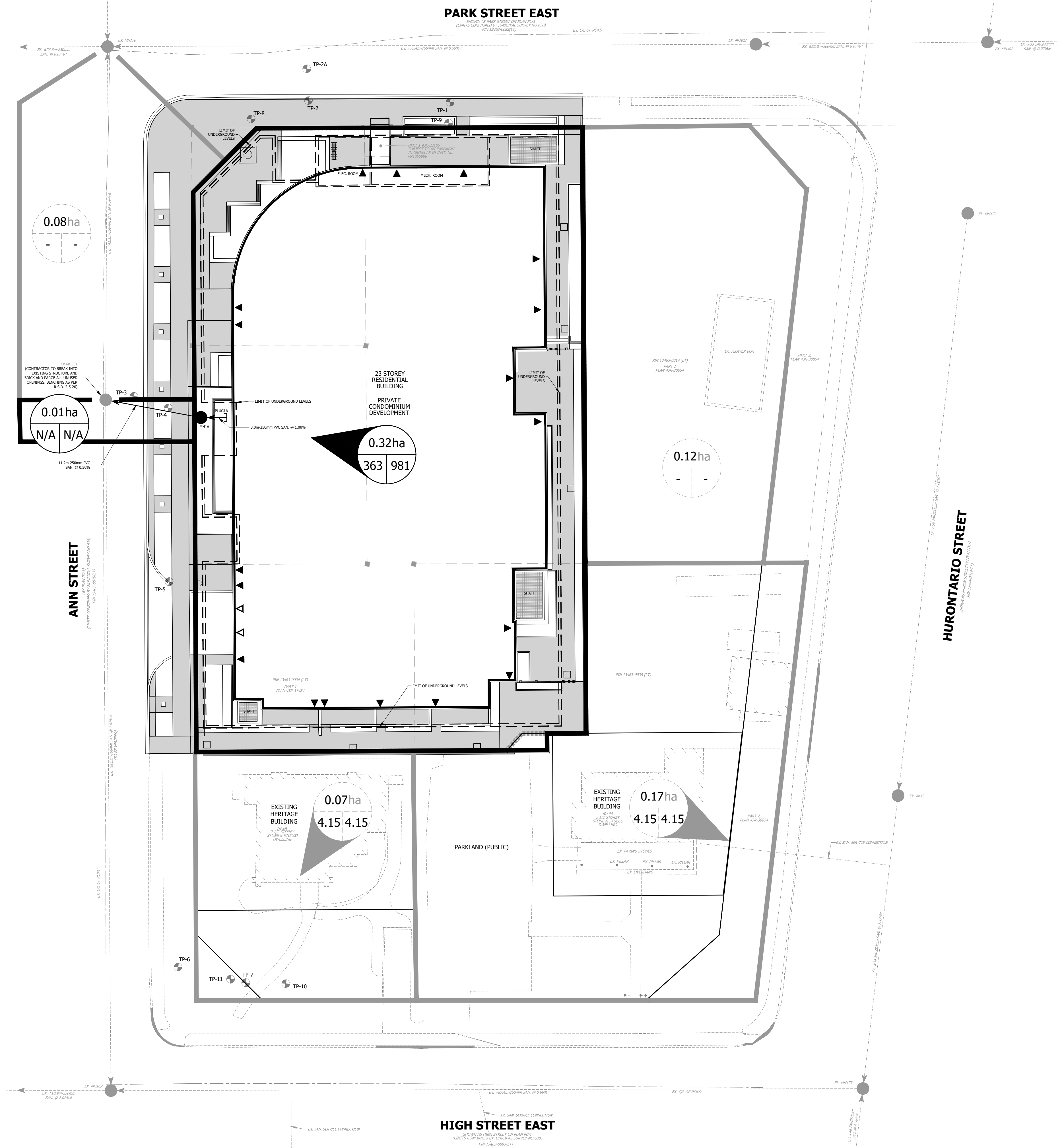

LEGEND

- SANITARY SEWER AND MANHOLE
- EXISTING SANITARY SEWER AND MANHOLE
- 0.32ha 200 720 DRAINAGE AREA (ha) POPULATION
- 0.03ha 1 1 EXISTING DRAINAGE AREA (ha.) POPULATION
- 0.03ha 1 1 EXISTING DRAINAGE AREA (ha.) POPULATION PER UNIT
- DRAINAGE AREA BOUNDARY
- EXISTING DRAINAGE AREA BOUNDARY
- LIMIT OF PROPERTY
- LIMIT OF UNDERGROUND LEVELS

ELEVATION NOTE
 ELEVATIONS SHOWN ON THIS PLAN ARE RELATED TO GEODETIC DATUM AND ARE DERIVED FROM THE CITY OF MISSISSAUGA BENCHMARKS:
 No. 72: ELEVATION=78.12m
 No. 73: ELEVATION=81.58m

BENCHMARK NOTE
 LB#1 SANITARY MANHOLE 0.696m FROM THE CENTER LINE OF THE ROAD AT THE INTERSECTION OF ANN STREET AND HIGH STREET. ELEVATION=80.36m
 LB#2 SANITARY MANHOLE 1.345m FROM THE CENTER LINE OF THE ROAD AT THE INTERSECTION OF PARK STREET AND HURONTARIO STREET. ELEVATION=82.51m

TOPOGRAPHIC SURVEY PREPARED BY J.D. BARNES LIMITED, JANUARY 26, 2020.

ISSUED FOR OPA & RECORDING SUBMISSION DATE DEC. 21, 2021	ISSUED FOR OPA & RECORDING SUBMISSION DATE OCT. 26, 2022	THIRD DATE	FINAL DATE
--	--	------------	------------



URBANTECH® Consulting
 A Division of Leighton-Zec West Ltd.
 2030 Bristol Circle, Suite 105
 Oakville, ON L6H 0H2
 TEL. 905.829.8818 • urbantech.com

10 WEST GO GP INC.
 17 & 19 ANN STREET, 84 & 90 HIGH STREET
 OZ OPA 22-3

Region of Peel
 working with you

MISSISSAUGA

SANITARY DRAINAGE PLAN

REGION FILE No. XXX	CITY FILE No. XXX
SCALE: 1:250	AREA Z-08-CS/D
DRAWN BY: A.G.	CHECKED BY: R.M./R.B.T.M
DATE: NOVEMBER 2021	SHEET OF C-
PROJECT No. 19-241	PLAN No. 301

FILE: F:\PROJECTS\19-241 (ANN & HIGH STREET)\03 DRAWINGS\300 - DRAINAGE\301 SANITARY DRAINAGE PLAN.DWG