

NOTES

- COPYRIGHT OF THIS DRAWING AND DESIGN IS RESERVED BY THE DESIGNER. THE DRAWING AND ALL ASSIGNED DOCUMENTS ARE AN INSTRUMENT OF SERVICE BY THE DESIGNER. THE DRAWING AND THE INFORMATION CONTAINED THEREIN MAY NOT BE REPRODUCED IN WHOLE OR IN PART WITHOUT THE PRIOR WRITTEN PERMISSION OF THE DESIGNER.
- DRAWINGS ARE NOT TO BE SCALED FOR CONSTRUCTION.
- IT IS THE CONTRACTOR'S RESPONSIBILITY TO NOTIFY THE CONSULTANT IF ANY DISCREPANCIES IN THE DRAWING AND CONTRACT DOCUMENTS ARE DISCOVERED.
- CONTRACTOR TO VERIFY ALL EXISTING UTILITY LOCATIONS AND DEPTHS PRIOR TO CONSTRUCTION AND NOTIFY LANDSCAPE ARCHITECT IF CONFLICTS ARE PRESENT. IF UTILITY RELOCATIONS ARE REQUIRED DUE TO CONFLICT OR DAMAGE, COORDINATE WITH APPROPRIATE UTILITY COMPANIES.
- WATERING PROGRAM TO BE ADMINISTERED FOR NEWLY PLANTED TREES FOR THE FIRST TWO YEARS AFTER PLANTING BY OWNER/CONTRACTOR.
- SOIL IS TO BE RETAINED ON SITE OR ADJUSTED OR REPLACED WITH SOIL OF EQUAL OR BETTER QUALITY OF COMMERCE/CONTRACTOR.
- MAINTAIN SOIL VOLUME ACHIEVABLE HAS BEEN ALLOCATED TO ALL LARGE CHOPPY TREES TO MEET TREE SOIL VOLUME DEMAND FOR EACH TREE MAINTAINED.
- 75% OF SOIL ROOF HARDSCAPE, INCLUDING STONE/JUNT PAVING, TO HAVE MINIMUM SOLAR REFLECTIVITY OF 50 OR AN EQUAL SOLAR REFLECTANCE OF AT LEAST 0.35.
- FILE: 1842 IN COLLABORATION WITH HPMB ARCHITECTS' DRAWINGS AND ALL PROJECT CIVIL ENGINEERING DRAWINGS.

- LEGEND**
- EXISTING TREE TO BE REMOVED (PERMIT REQUIRED)
 - EXISTING TREE (UNDERSIZED - NO PERMIT REQUIRED)
 - EXISTING DECIDUOUS TREE
 - EXISTING CONIFEROUS TREE
 - TREE PROTECTION ZONE FENCING
 - PROPERTY LINE
 - UNDERGROUND GARAGE OUTLINE

ISSUE

- 5
- 4
- 3
- 2023-10-07 ISSUED FOR ZBA
- 2022-09-19 ISSUED FOR COORDINATION

ASSOCIATION OF LANDSCAPE ARCHITECTS
MEMBER
ONARIO

Janet Rosenberg & Studio
Landscape Architecture and Urban Design
4150 85th Street #4150 85th Street
4150 85th Street #4150 85th Street
348 Hurontario Avenue, Toronto Ontario M5C 2B3 Canada

UNITED PROPERTY RESOURCE CORPORATION

UPRC WESTMINSTER UNITED CHURCH
4094 Tomken Rd, Mississauga, ON L4W 1J5

TREE PRESERVATION PLAN

SCALE: 1:250
DRAWN: RM
CHECKED: WS
PROJECT NUMBER: 21-039
DRAWING DATE: 2022-04-12

L001

NOTES: Tree locations not surveyed, locations are field measured by the arborist. Work location estimated from clients provided site plan.

Contains information licensed under the Open Government Licence - Toronto.

- All field data have been recorded by Adam Mohamed ISA Certified Arborist® ON-2333A. All tree locations are based on the survey supplied by the client and field observation by the arborist.
- This plan shall be used in conjunction with the Tree Protection Action Key (TPAK). Specific information regarding tree species, condition, and protection protocols are listed therein.
- Refer to the Arborist Report prepared for this project for specific instruction regarding tree protection requirements.

PLAN KEY

- TREE RECOMMENDED FOR REMOVAL
- RETAINED TREE
- EXISTING CONIFEROUS TREE
- CONIFEROUS TREE FOR REMOVAL
- RETAINED CONIFEROUS TREE
- REPLACEMENT TREE
- RETAINED HEDGEROW
- HEDGEROW FOR REMOVAL
- TREE PROTECTION FENCE
- TREE PROTECTION ZONE

N

No.	DATE	BY	REVISIONS
1	6/24/2022	JS	Initial Tree Inventory
2	8/22/2022	JS	Final Site Plan
3	10/14/2022	JS	Updates

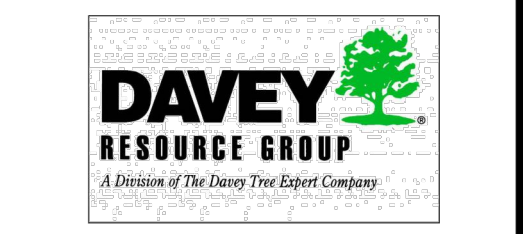

TITLE: Pre-Construction Assessment
4094 Tomken Rd, Mississauga,
ON, L4W 4H5

CLIENT: Carly Forrester

DRAWING NO.: 001	SCALE: 1:600
JOB NO.:	SHEET: 1 of 3

Tree Map Number	Species	Botanical	DBH (cm) @ 1.4 m	Tree Ownership	Minimum Tree Protection Distance (m)	Health	Structure	Overall Condition	Tree Height (m)	Crown Width (m)	Live Crown Ratio (%)	Deadwood (%)	Construction Inside Min TPZ (Y/N)	Construction Impact (None, Low, Medium, High)	Action	Permit Required? (Y/N)	Observations and Recommendations
101	Sugar Maple	<i>Acer saccharum</i>	30	Boundary	1.8	G	G	G	12.2	9.1	100	0	N	L	Preserve	N	Tag#101, TPF
102	Austrian Pine	<i>Pinus nigra</i>	30	Boundary	1.8	G	G	G	12.2	9.1	100	0	N	L	Preserve	N	Tag#102 TPF
103	Austrian Pine	<i>Pinus nigra</i>	52	Private	3.6	G	G	G	12.2	6.1	100	0	N	L	Preserve	N	Tag#103 TPF
104	Austrian Pine	<i>Pinus nigra</i>	22	Private	1.8	G	G	G	12.2	9.1	100	0	N	L	Preserve	N	Tag#104 TPF
105	Austrian Pine	<i>Pinus nigra</i>	22	Private	1.8	G	G	G	12.2	9.1	100	0	Y	L	Injure	Y	hand-dig or hydro-vac to excavate parking lot edge, arborist root pruning
106	Austrian Pine	<i>Pinus nigra</i>	20	Private	1.5	G	G	G	12.2	6.1	100	0	N	L	Preserve	N	Tag#106 TPF
107	Colorado Blue Spruce	<i>Picea pungens</i>	31	Private	2.4	G	G	G	15.2	9.1	100	0	Y	H	Remove	Y	Tag#107
108	HoneyLocust	<i>Gleditsia triacanthos</i>	16	Private	1.5	G	G	G	6.1	9.1	100	0	Y	H	Remove	Y	Tag#108
109	HoneyLocust	<i>Gleditsia triacanthos</i>	16	Private	1.5	G	G	G	6.1	9.1	100	0	Y	H	Remove	Y	Tag#109
110	HoneyLocust	<i>Gleditsia triacanthos</i>	14	Private	1.5	G	G	G	6.1	9.1	100	0	Y	H	Remove	Y	Tag#110
111	HoneyLocust	<i>Gleditsia triacanthos</i>	15	Private	1.5	G	G	G	6.1	9.1	100	0	Y	H	Remove	Y	Tag#111
112	HoneyLocust	<i>Gleditsia triacanthos</i>	13	Private	1.5	G	F	F	6.1	9.1	70	30	Y	H	Remove	Y	Tag#112, one dead branch
113	HoneyLocust	<i>Gleditsia triacanthos</i>	26	Private	1.8	G	F	F	9.1	9.1	100	0	Y	H	Remove	Y	Tag#113, abnormal root flare growth
114	Colorado Blue Spruce	<i>Picea pungens</i>	20	Neighbour	1.5	G	F	F	15.2	9.1	70	30	N	L	Preserve	N	Estimated DBH, needles missing
115	Common buckthorn	<i>Rhamnus carthartica</i>	10	Neighbour	1.5	G	G	G	3	9.1	100	0	N	L	Preserve	N	Estimated DBH
116	Common buckthorn	<i>Rhamnus carthartica</i>	10	Neighbour	1.5	G	G	G	3	9.1	100	0	N	L	Preserve	N	Estimated DBH
117	Manitoba maple	<i>Acer negundo</i>	10	Neighbour	1.5	G	G	G	3	9.1	100	0	N	L	Preserve	N	Estimated DBH
118	Eastern White cedar	<i>Thuja occidentalis</i>	10	Neighbour	1.5	G	G	G	6.1	9.1	100	0	N	L	Preserve	N	Estimated DBH, 2 stem hedgerow (5-10 cm DBH)
119	Cherry	<i>Prunus species</i>	11	Neighbour	1.5	G	G	G	9.1	9.1	100	0	N	L	Preserve	N	Estimated DBH
120	Colorado Blue Spruce	<i>Picea pungens</i>	11	Neighbour	1.5	G	G	G	9.1	9.1	100	0	N	L	Preserve	N	Estimated DBH
121	HoneyLocust	<i>Gleditsia triacanthos</i>	12	Neighbour	1.5	G	G	G	6.1	9.1	100	0	N	L	Preserve	N	Estimated DBH
122	HoneyLocust	<i>Gleditsia triacanthos</i>	30	Neighbour	1.8	G	G	G	12.2	9.1	100	0	N	L	Preserve	N	Estimated DBH
123	Cherry	<i>Prunus species</i>	20	Neighbour	1.5	G	G	G	12.2	9.1	100	0	N	L	Preserve	N	Estimated DBH
124	Colorado Blue Spruce	<i>Picea pungens</i>	22	Neighbour	1.8	G	G	G	15.2	9.1	100	0	N	L	Preserve	N	Estimated DBH
125	Colorado Blue Spruce	<i>Picea pungens</i>	22	Neighbour	1.8	G	G	G	15.2	9.1	100	0	N	L	Preserve	N	Estimated DBH
126	Colorado Blue Spruce	<i>Picea pungens</i>	25	Neighbour	1.8	G	G	G	15.2	9.1	100	0	N	L	Preserve	N	Estimated DBH
127	HoneyLocust	<i>Gleditsia triacanthos</i>	12	Private	1.5	P	P	P	6.1	9.1	60	40	Y	H	Remove	Y	Tag#127, dieback in top of crown
128	Willow	<i>Salix species</i>	32	Private	2.4	G	G	G	9.1	9.1	100	0	Y	H	Remove	Y	Tag#128
129	Willow	<i>Salix species</i>	29	Private	1.8	G	F	F	9.1	9.1	100	0	Y	H	Remove	Y	Tag#129, multistem (18, 23), missing leaves, trunk wound
130	HoneyLocust	<i>Gleditsia triacanthos</i>	32	Private	2.4	G	G	G	12.2	9.1	100	0	Y	H	Remove	Y	Tag#130
131	HoneyLocust	<i>Gleditsia triacanthos</i>	36	Private	2.4	G	G	G	12.2	9.1	100	0	Y	H	Remove	Y	Tag#131
132	HoneyLocust	<i>Gleditsia triacanthos</i>	36	Private	2.4	G	G	G	12.2	9.1	100	0	Y	H	Remove	Y	Tag#132
133	HoneyLocust	<i>Gleditsia triacanthos</i>	25	Private	1.8	G	G	G	12.2	9.1	100	0	Y	H	Remove	Y	Tag#133
134	HoneyLocust	<i>Gleditsia triacanthos</i>	30	Private	1.8	G	G	G	12.2	9.1	100	0	Y	H	Remove	Y	Tag#134
135	HoneyLocust	<i>Gleditsia triacanthos</i>	26	Private	1.8	G	G	G	12.2	9.1	100	0	Y	H	Remove	Y	Tag#135
136	HoneyLocust	<i>Gleditsia triacanthos</i>	39	Private	2.4	G	G	G	12.2	9.1	100	0	Y	H	Remove	Y	Tag#136
137	English oak	<i>Quercus robur</i>	41	Private	3.0	G	G	G	18.3	9.1	100	0	Y	M	Injure	Y	Hand digging for new pathways, arborist root pruning
138	Pear	<i>Pyrus sp</i>	17	Private	1.5	F	F	F	15.2	9.1	70	30	Y	H	Remove	Y	Tag#138, Multistem (17, 8), one stem dead
139	Pear	<i>Pyrus sp</i>	11	Private	1.5	F	F	F	15.2	9.1	70	30	Y	H	Remove	Y	Tag#139, Multistem (11, 8, 10)
140	English oak	<i>Quercus robur</i>	43	Private	3.0	G	G	G	18.3	9.1	100	0	Y	M	Injure	Y	Hand digging for new pathways, arborist root pruning
141	Norway maple	<i>Acer platanoides</i>	23	Boundary	1.8	G	G	G	12.2	9.1	100	0	Y	H	Remove	Y	Tag#141
142	Colorado Blue Spruce	<i>Picea pungens</i>	22	Private	1.8	F	F	F	15.2	9.1	70	30	Y	H	Remove	Y	Tag#142, missing leaves TPF
143	Colorado Blue Spruce	<i>Picea pungens</i>	25	Private	1.8	G	G	G	15.2	9.1	100	0	Y	H	Remove	Y	Tag#143 TPF
144	Norway maple	<i>Acer platanoides</i>	23	Private	1.8	F	F	F	12.2	9.1	70	30	Y	H	Remove	Y	Tag#144, missing leaves, trunk damage
145	Sugar Maple	<i>Acer saccharum</i>	25	Private	1.8	G	G	G	12.2	9.1	100	0	Y	H	Remove	Y	Tag#145
146	Sugar Maple	<i>Acer saccharum</i>	21	Private	1.8	G	G	G	12.2	9.1	100	0	Y	H	Remove	Y	Tag#146
147	Sugar Maple	<i>Acer saccharum</i>	17	Private	1.5	G	G	G	12.2	9.1	100	0	Y	H	Remove	Y	Tag#147
148	Sugar Maple	<i>Acer saccharum</i>	28	Private	1.8	G	G	G	12.2	9.1	100	0	Y	H	Remove	Y	Tag#148
149	Lilac species	<i>Syringa species</i>	21	Private	1.8	G	G	G	12.2	9.1	100	0	Y	H	Remove	Y	Tag#149, Multistem (13, 9, 9, 10)
150	Lilac species	<i>Syringa species</i>	13	Private	1.5	G	G	G	12.2	9.1	100	0	Y	H	Remove	Y	Tag#150
151	Lilac species	<i>Syringa species</i>	16	Private	1.5	G	G	G	12.2	9.1	100	0	Y	H	Remove	Y	Tag#151, Multistem (14, 8)
152	Pear	<i>Pyrus species</i>	20	Private	1.5	G	G	G	9.1	9.1	100	0	Y	H	Remove	Y	Estimated DBH
153	White pine	<i>Pinus strobus</i>	22	Private	1.8	G	G	G	12.2	9.1	70	30	Y	H	Remove	Y	Tag#153, missing needles;
154	Freeman maple	<i>Acer x Freemani</i>	10	Private	1.5	G	G	G	9.1	9.1	100	0	Y	H	Remove	Y	Tag#154
155	Cherry	<i>Prunus species</i>	20	Private	1.5	G	G	G	9.1	9.1	100	0	N	L	Preserve	N	Estimated DBH
156	Crabapple	<i>Malus sylvestris</i>	13	Private	1.5	G	G	G	9.1	9.1	100	0	N	L	Preserve	N	Estimated DBH, Multistem (10, 3, 8)
157	Crabapple	<i>Malus sylvestris</i>	16	Private	1.5	G	G	G	9.1	9.1	100	0	N	L	Preserve	N	Estimated DBH, Multistem (10, 8, 10)
158	Pear	<i>Pyrus species</i>	17	Private	1.5	G	G	G	9.1	9.1	100	0	N	L	Preserve	N	Tag#158, Multistem (14, 10)
159	Crabapple	<i>Malus sylvestris</i>	26	Private	1.8	G	G	G	9.1	9.1	100	0	Y	H	Remove	Y	Tag#159
160	Juniper	<i>Juniperus species</i>	11	Private	1.5	G	G	G	9.1	9.1	100	0	Y	H	Remove	Y	Estimated DBH
161	Colorado Blue Spruce	<i>Picea pungens</i>	32	Private	2.4	G	G	G	15.2	9.1	100	0	Y	L	Injure	Y	Hand digging for new pathways, arborist root pruning
162	White spruce	<i>Picea glauca</i>	18	Private	1.5	F	F	F	15.2	9.1	70	30	Y	M	Injure	Y	Hand digging for new pathways, arborist root pruning
163	Colorado Blue Spruce	<i>Picea pungens</i>	27	Private	1.8	F	F	F	15.2	9.1	70	30	Y	L	Injure	Y	Hand digging for new pathways, arborist root pruning
164	HoneyLocust	<i>Gleditsia triacanthos</i>	25	Neighbour	1.8	G	G	G	12.2	9.1	100	0	N	L	Preserve	N	Estimated DBH
165	HoneyLocust	<i>Gleditsia triacanthos</i>	25	Neighbour	1.8	G	F	F	12.2	9.1	70	30	N	L	Preserve	N	Estimated DBH, missing leaves
166	HoneyLocust	<i>Gleditsia triacanthos</i>	25	Neighbour	1.8	G	G	G	12.2	9.1	100	0	N	L	Preserve	N	Estimated DBH
167	HoneyLocust	<i>Gleditsia triacanthos</i>	25	Neighbour	1.8	G	F	F	12.2	9.1	70	30	N	L	Preserve	N	Estimated DBH, missing leaves
168	HoneyLocust	<i>Gleditsia triacanthos</i>	25	Neighbour	1.8	G	G	G	12.2	9.1	100	0	N	L	Preserve	N	Estimated DBH
169	White mulberry	<i>Morus alba</i>	15	Neighbour	1.5	G	G	G	6.1	9.1	100	0	N	L	Preserve	N	Estimated DBH
170	HoneyLocust	<i>Gleditsia triacanthos</i>	25	Neighbour	1.8	G	G	G	12.2	9.1	100	0	N	L	Preserve	N	Estimated DBH
171	Colorado Blue Spruce	<i>Picea pungens</i>	10	Neighbour	1.5	G	G	G	9.1	9.1	100	0	N	L	Preserve	N	Estimated DBH
172	HoneyLocust	<i>Gleditsia triacanthos</i>	25	Neighbour	1.8	G	G	G	12.2	9.1	100	0	N	L	Preserve	N	Estimated DBH
173	HoneyLocust	<i>Gleditsia triacanthos</i>	30	Neighbour	1.8	P	P	P	12.2	9.1	50	50	N	L	Preserve	N	Estimated DBH, half of tree without leaves
174	Austrian Pine	<i>Pinus nigra</i>	22	Private	1.8	G	G	G	9.1	9.1	100	0	Y	L	Injure	Y	Multistem (14, 17); hand-dig or hydro-vac to excavate parking lot edge, arborist root pruning
175	Austrian Pine	<i>Pinus nigra</i>	23	Private	1.8	G	G	G	12.2	9.1	100	0	N	L	Preserve	N	Tag#175 TPF
176	Littleleaf Linden	<i>Tilia cordata</i>	44	Private	3.0	G	G	G	12.2	9.1	100	0	N	L	Preserve	N	Tag#176 TPF
177	Lilac species	<i>Syringa species</i>	10	Private	1.5	G	G	G	6.1	9.1	100	0	Y	H	Remove	Y	Tag#177
178	Littleleaf Linden	<i>Tilia cordata</i>	34	Private	2.4	G	G	G	12.2	9.1	100	0	Y	H	Remove	Y	Tag#178
179	Littleleaf Linden	<i>Tilia cordata</i>	28	Private	1.8	G	F	F	12.2	9.1	70	30	Y	H	Remove	Y	Tag#179, missing leaves
180	Littleleaf Linden	<i>Tilia cordata</i>	32	Private	2.4	G	G	G	12.2	9.1	100	0	Y	H	Remove	Y	Tag#180

NOTES: Tree locations not surveyed, locations are field measured by the arborist. Work location estimated from clients provided site plan.

Contains information licensed under the Open Government Licence – Toronto.

- All field data have been recorded by Adam Mohamed ISA Certified Arborist® ON-2333A. All tree locations are based on the survey supplied by the client and field observation by the arborist.
- This plan shall be used in conjunction with the Tree Protection Action Key (TPAK). Specific information regarding tree species, condition, and protection protocols are listed therein.
- Refer to the Arborist Report prepared for this project for specific instruction regarding tree protection requirements.

PLAN KEY

- TREE RECOMMENDED FOR REMOVAL
- RETAINED TREE
- CONIFEROUS TREE FOR REMOVAL
- RETAINED CONIFEROUS TREE
- REPLACEMENT TREE
- RETAINED HEDGEROW
- HEDGEROW FOR REMOVAL
- TREE PROTECTION FENCE
- TREE PROTECTION ZONE

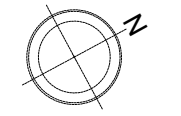

No.	DATE	BY	REVISIONS
1	6/24/2022	JS	Initial Tree Inventory
2	8/22/2022	JS	Final Site Plan
3	10/14/2022	JS	Updates



TITLE: Pre-Construction Assessment
4094 Tomken Rd, Mississauga,
ON, L4W 4H5

CLIENT: Carly Forrester

DRAWING NO.: 001 SCALE: 1:600

JOB NO.: SHEET: 2 of 3

02830-6

Hoarding Framed Protective Construction Hoarding Solid Board- Plastic Snow Fence

NOTE:
TO BE USED AS A GUIDELINE ONLY.
NOT TO SCALE. REMOVE CITY TITLE BLOCK
AND REDRAW TO REPRESENT SITE SPECIFIC
CONDITIONS. ALL SITE SPECIFIC CONDITIONS
ARE TO BE CONFIRMED BY THE PROJECT
CONSULTANT.

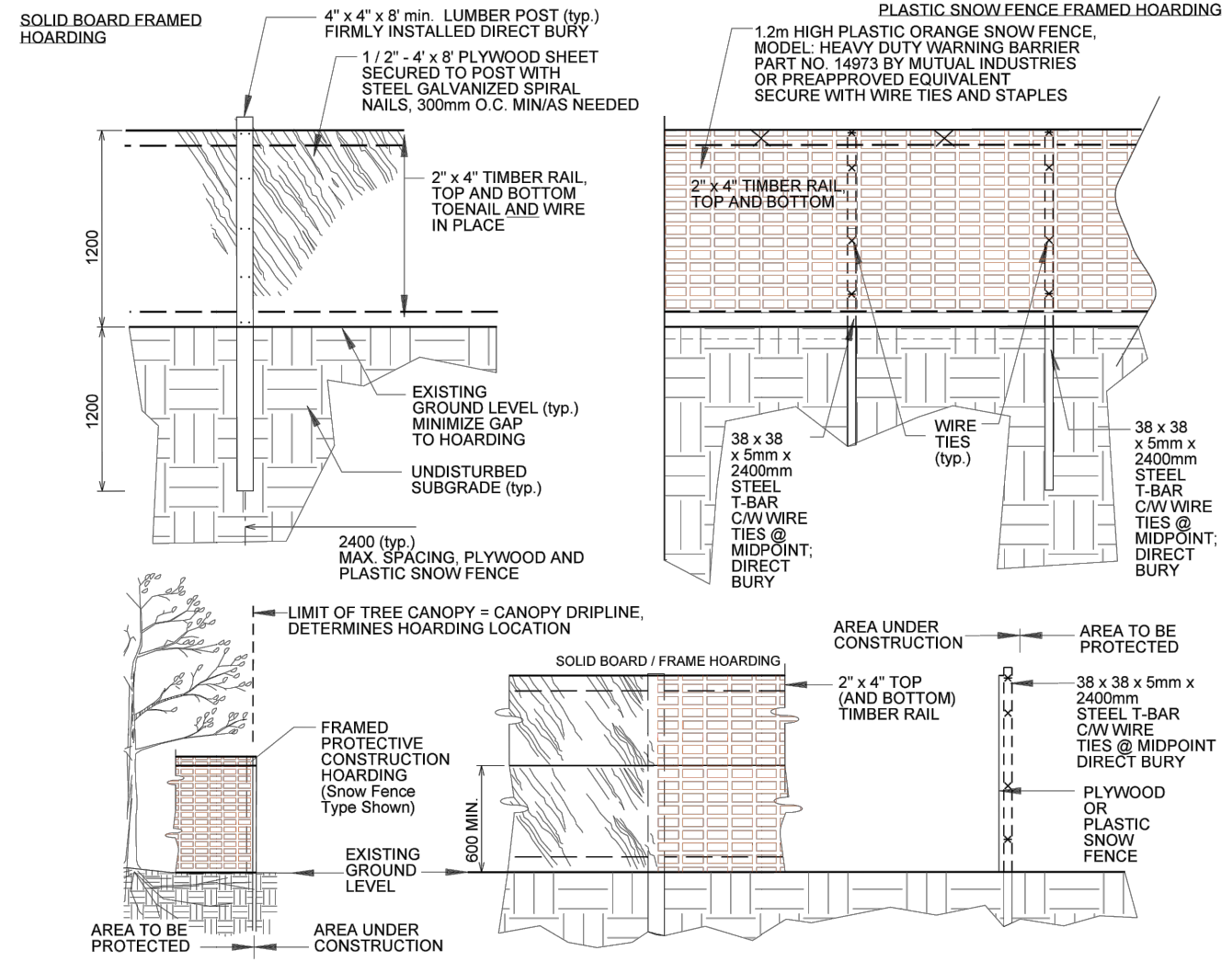

- NOTES:**
1. HOARDING LOCATION AS PER DRAWINGS. HOARDING INSTALLATIONS ARE TO INCLUDE WOVEN GEOTEXTILE FABRIC FOR SEDIMENT CONTROL.
 2. NO MOBILIZATION OR CONSTRUCTION WORK TO OCCUR UNTIL HOARDING HAS BEEN INSPECTED AND APPROVED BY COMMUNITY SERVICES PROJECT MANAGER (CSPM). CONTRACTOR TO ARRANGE FOR A HOARDING INSPECTION WITH (CSPM), 48 HOUR NOTICE REQUIRED.
 3. HOARDING TO BE SUPPLIED, INSTALLED AND MAINTAINED BY THE CONTRACTOR THROUGH ALL PHASES OF WORK ON SITE.
 4. THE CONTRACTOR IS TO REMOVE AND DISPOSE THE HOARDING OFF SITE WHEN DIRECTED BY THE (CSPM).
 5. ALL WOOD PRODUCTS TO BE NEW AND LUMBER KILN DRIED SPF.
 6. ALL FASTENERS TO BE NEW GALVANIZED STEEL AND SECURELY INSTALLED. WIRE TIES MIN 3.5mm DIA. GALVANIZED STEEL.
 7. DO NOT ALLOW WATER TO COLLECT AND/OR POND ON EITHER SIDE OF THE HOARDING.
 8. WHEN INSTALLING DIRECT BURY TIMBER POSTS AND T-BARS, TAKE CARE TO AVOID VISIBLE AND ASCERTAINABLE TREE ROOTS.
 9. PLACE HOARDING AT LIMIT OF TREE CANOPY DRIP LINE OR BEYOND (E.G. FURTHER AWAY FROM TRUNK) OF TREE.
 10. HOARDED OFF AREA TO REMAIN UNDISTURBED. NO STOCKPILING, STAGING OR MOVEMENT OF VEHICLES TO OCCUR WITHIN PROTECTED AREA.
 11. FOR PROTECTION OF TREE'S AND ROOT SYSTEM, CONTRACTOR MAY BE REQUIRED TO PROVIDE WATERING, MULCHING, FERTILIZING, PRUNING OR OTHER ACTIVITIES TO ENSURE THE HEALTH OF THE TREE(S).
 12. ALL MEASUREMENTS IN MILLIMETRES UNLESS NOTED OTHERWISE (E.G. DIMENSIONAL LUMBER).
 13. CONTRACTOR RESPONSIBLE FOR LOCATES

N.T.S.

Detail: 02830-6

ORIGINAL DATE: Mar 08/18
REVISION DATE: Mar 08/18



NOTES: Tree locations not surveyed, locations are field measured by the arborist. Work location estimated from clients provided site plan.
Contains information licensed under the Open Government Licence – Toronto.

- All field data have been recorded by Adam Mohamed ISA Certified Arborist® ON-2333A. All tree locations are based on the survey supplied by the client and field observation by the arborist.
- This plan shall be used in conjunction with the Tree Protection Action Key (TPAK). Specific information regarding tree species, condition, and protection protocols are listed therein.
- Refer to the Arborist Report prepared for this project for specific instruction regarding tree protection requirements.

PLAN KEY

- TREE RECOMMENDED FOR REMOVAL
- RETAINED TREE
- CONIFEROUS TREE FOR REMOVAL
- RETAINED CONIFEROUS TREE
- REPLACEMENT TREE
- RETAINED HEDGEROW
- HEDGEROW FOR REMOVAL
- TREE PROTECTION FENCE
- TREE PROTECTION ZONE

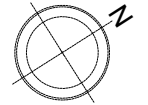

No.	DATE	BY	REVISIONS
1	6/24/2022	JS	Initial Tree Inventory
2	8/22/2022	JS	Final Site Plan
3	10/14/2022	JS	Updates



TITLE: Pre-Construction Assessment
4094 Tomken Rd, Mississauga,
ON, L4W 4H5

CLIENT: Carly Forrester

DRAWING NO.: 001	SCALE: 1:600
JOB NO.:	SHEET: 3 of 3