

1
TI-1
TREE INVENTORY, REMOVALS, AND PROTECTION PLAN
SCALE: 1:500

TREE INVENTORY NOTES

Tree #	Owner	Common Name	Botanical Name	DBH (CM)	Min. TPZ Radius (m)	Cond.	Canopy Diameter (m)	Structure	Comments	Recommendation
1	N	White pine	Pinus strobus	23	1.8	F	7	G		Retain
2	N	White pine	Pinus strobus	28	1.8	G	9	G		Retain
3	N	White pine	Pinus strobus	27	1.8	G	8	F/G	Slightly imbalanced crown	Retain
4	N	Balsam fir	Abies balsamea	10	1.5	F	2	F		Retain
5	N	Balsam fir	Abies balsamea	14	1.5	F	2	F		Retain
6	N	Colorado Spruce	Picea pungens	16	1.5	F	5	F/G		Retain
7	N	Hop-hornbeam	Ostrya virginiana	17	1.5	F/G	9	F		Retain
8	N	Hop-hornbeam	Ostrya virginiana	14	1.5	F/G	10	F		Retain
9	N	Hop-hornbeam	Ostrya virginiana	13	1.5	F	8	F	Mild lean	Retain
10	M	Red Oak	Quercus rubra	5	1.2	F	1.5	F/G		Transplant
11	M	Red Oak	Quercus rubra	6	1.2	F	1.2	F/G		Transplant
12	M	Red Oak	Quercus rubra	5	1.2	F	1	G		Transplant
13	M	Maidenhair Tree	Ginkgo biloba	5	1.2	F/G	1	G		Transplant
14	M	Maidenhair Tree	Ginkgo biloba	5	1.2	F/G	1	G		Transplant
15	M	Maidenhair Tree	Ginkgo biloba	6	1.2	F/G	1	F/G		Transplant
16	M	Maidenhair Tree	Ginkgo biloba	5	1.2	F/G	1	G		Transplant
17	M	Maidenhair Tree	Ginkgo biloba	5	1.2	F/G	1	G		Transplant

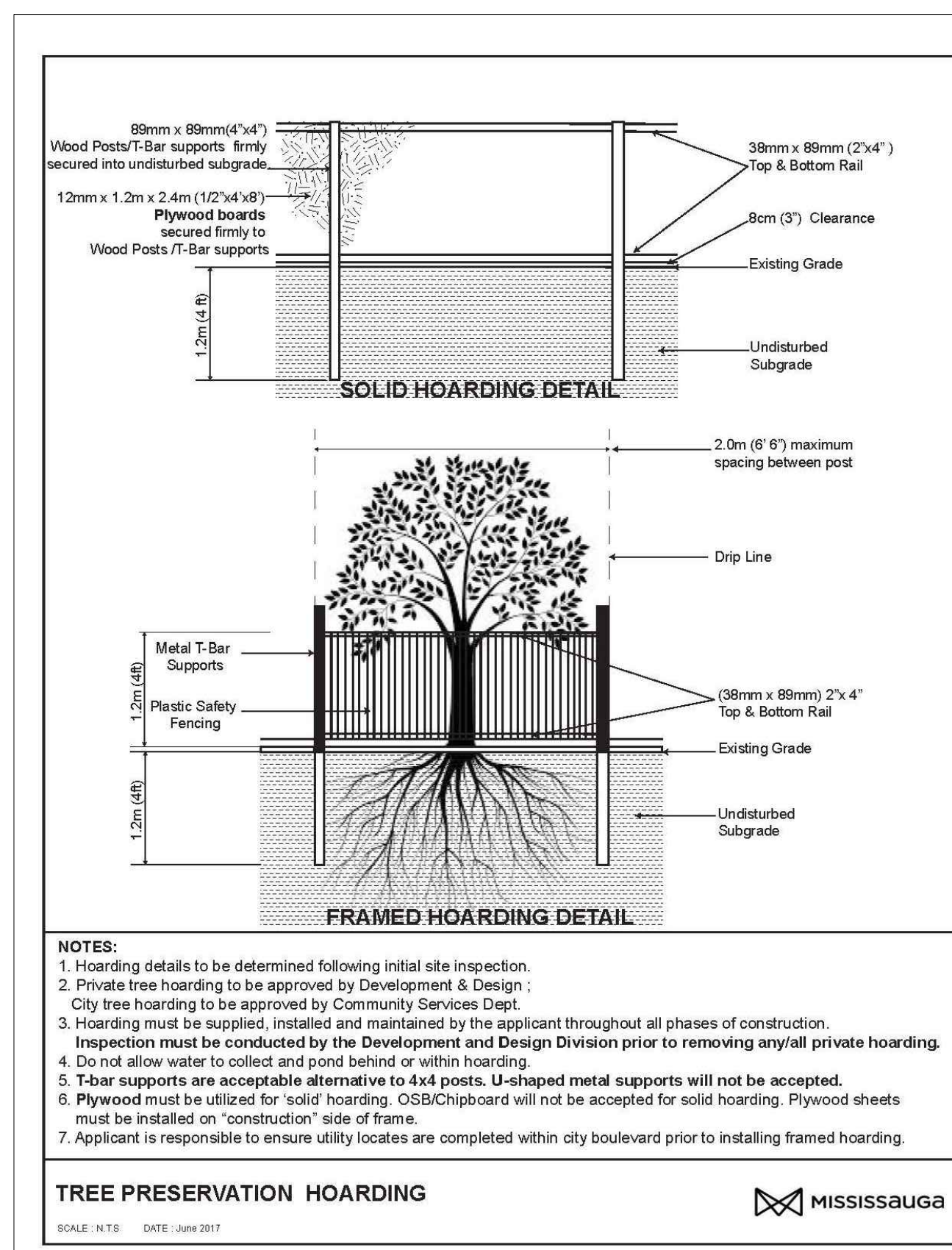

2
TI-1
TREE PRESERVATION HOARDING
CITY OF MISSISSAUGA STANDARD

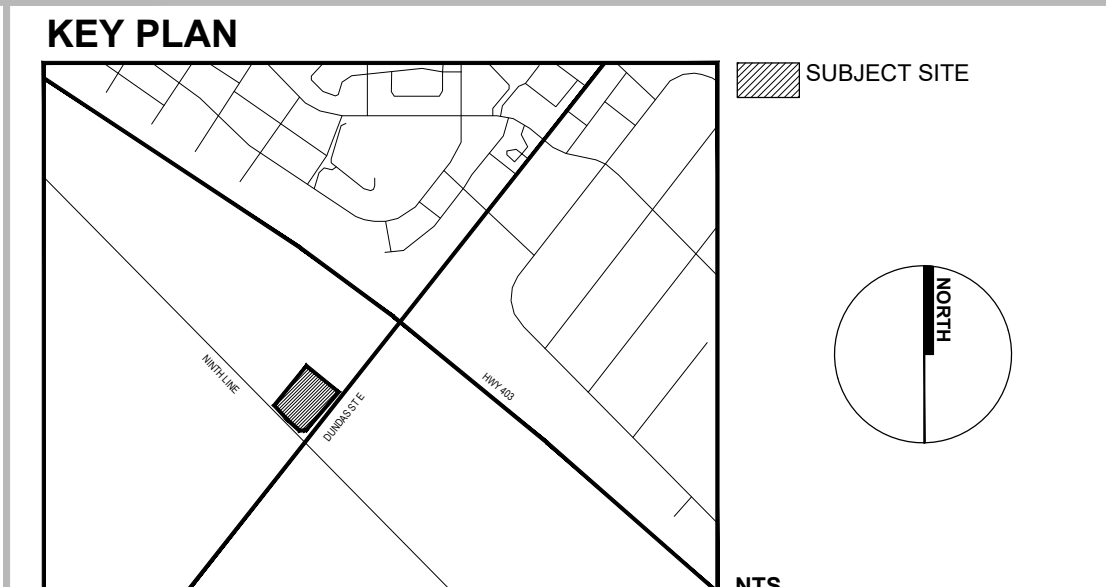

- LEGEND**
- EXISTING DECIDUOUS TREE TO REMAIN
 - EXISTING CONIFEROUS TREE TO REMAIN
 - EXISTING DECIDUOUS TREE TO BE TRANSPLANTED
 - TRANSPLANT LOCATION
 - FRAMED HOARDING (Municipal Lands)
 - PROPERTY LINE
 - TREE IDENTIFICATION KEY (TREE TRANSPLANT LOCATION)
 - TREE IDENTIFICATION KEY (TREES TO BE RETAINED/TRANSPLANTED)

- GENERAL NOTES**
- Do not scale the drawings. All dimensions are in millimetres unless noted otherwise.
 - This drawing is to be read in conjunction with the project site plan, landscape plan, and engineering plan.
 - The tree inventory includes assessment of trees >10cm DBH. The trees have been assessed based on species, size and condition.
 - The contractor shall check and verify all existing and proposed grading and conditions on the project and immediately report any discrepancies to the consultant before proceeding with any removals.
 - The contractor is to be aware of all existing and proposed services and utilities. The contractor is responsible for having all underground services and utility lines staked by each agency having jurisdiction prior to commencing work.
 - This drawing is to be used for development approval only.
 - Do not leave any holes open overnight.
 - Keep area outside construction zone clean and useable by others at all times. Contractor shall thoroughly clean areas surrounding the construction zone at the end of each work day.
 - Contractor to make good any and all damages outside of the development area that may occur as a result of tree removals at no extra cost.
 - This drawing is Copyright MHBC Planning, 2020.

REVISION NO.	DATE	ISSUED / REVISION	BY
4.	AUGUST 3, 2023	ISSUED FOR SPA	MB
3.	DECEMBER 3, 2021	ISSUED FOR OPA	CC
2.	DECEMBER 1, 2020	ISSUED FOR SPA	TT
1.	OCTOBER 6, 2020	ISSUED FOR REVIEW	HH

MHBC PLANNING URBAN DESIGN & LANDSCAPE ARCHITECTURE
230-7030 WESTON ROAD WOODBRIDGE, ON, L4L 6G7 | P: 905.761.5388 F: 905.761.5389 | WWW.MHBCPLAN.COM

STAMP

ASSOCIATION OF LANDSCAPE ARCHITECTS
ONARIO
MEMBER

ISSUED FOR SPA ONLY
NOT FOR CONSTRUCTION

All drawings and specifications are instruments of service and will remain the property of MHBC Planning and must be returned at the completion of the work. This drawing shall not be used for construction purposes unless the drawings are marked 'Issued for Construction' and the professional seal is signed and dated by the landscape architect.

PROJECT
3855 Dundas Street East
MISSISSAUGA, ONTARIO

DATE
OCTOBER 2020

DRAWN BY
H.H.

PLAN SCALE
AS NOTED

FILE NO.
16257N

CHECKED BY
N.M.

OTHER

FILE NAME
TREE INVENTORY, PROTECTION, AND REMOVALS

DWG NO.
TI-1