

EXISTING  
RESIDENTIAL

EXISTING  
RESIDENTIAL

FUTURE  
RESIDENTIAL

EXISTING  
RESIDENTIAL

38mm sanitary forcemain  
installed by directional  
boring located on a  
3.0m wide easement.

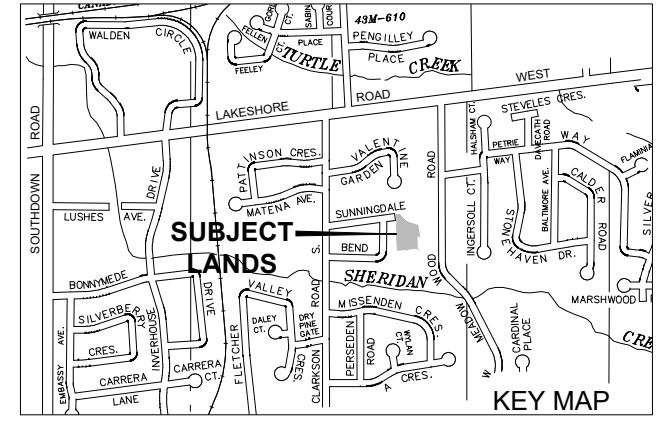

**DRAFT POTL PLAN**  
1667 SUNNINGDALE BEND  
PART OF LOTS 8, 9, & 10  
REGISTERED PLAN D-13  
CITY OF MISSISSAUGA  
REGION OF PEEL

**DEVELOPMENT STATISTICS**

SITE AREA:	0.51ha (1.26ac)
TOTAL UNITS:	5 UNITS
PART 1:	559m <sup>2</sup> (6,017ft <sup>2</sup> )
PART 2:	565m <sup>2</sup> (6,082ft <sup>2</sup> )
PART 3:	656m <sup>2</sup> (7,061ft <sup>2</sup> )
PART 4:	716m <sup>2</sup> (7,707ft <sup>2</sup> )
PART 5:	607m <sup>2</sup> (6,534ft <sup>2</sup> )
PART 6:	671m <sup>2</sup> (7,223ft <sup>2</sup> )
PART 7:	690m <sup>2</sup> (7,427ft <sup>2</sup> )
PART 8:	663m <sup>2</sup> (7,136ft <sup>2</sup> )



SCALE 1:500  
JANUARY 18, 2024

