

**LEGAL INFORMATION TAKEN FROM:**

TOPOGRAPHY OF PART OF LOT 4 CONVEYANCE WEST OF HURONTARIO STREET (GEOGRAPHIC TOWNSHIP OF TORONTO) CITY OF MISSISSAUGA REGIONAL MUNICIPALITY OF PEEL  
 SURVEY PREPARED BY: KRUMAR SURVEYORS LTD. 1137 CENTRE STREET THORNHILL, ON L4J 3M5 DATED MAY 2, 2022  
 THE ARCHITECT IS NOT RESPONSIBLE FOR ERRORS OR OMISSIONS IN THIS RESPECT.

**NOTE:**

Refer to the Site Grading Plan prepared by Urban Ecosystems, Drawing (Title and/or Number), for the purposes of obtaining site grading information.

DATE	ISSUED FOR
2023/01/27	ISSUED FOR REZONING

**LEGEND**

- PRIMARY BUILDING ENTRANCE
- SECONDARY BUILDING ENTRANCE
- CENTERLINE
- Room name**
- ROOM NAME, NUMBER, AREA
- PROPOSED ELEVATION (M)
- WALL TAG
- WINDOW TAG
- DOOR TAG
- ELEVATION TAG
- ACCESSIBLE PARKING
- FIRE HYDRANT
- CATCH BASIN
- LIGHT BOLLARD
- LIGHT POST
- WALL LIGHT
- BIKE RACK
- INTAKE/EXHAUST VENT
- EASEMENT
- EXTENT OF UNDERGROUND
- SEVERANCE LINE
- PROPERTY LINE
- TOP OF BANK
- LONG TERM STABLE SLOPE

NO.	DATE	DESCRIPTION
1	2023/01/27	ISSUED FOR REZONING

**REVISIONS**  
 Contractor must check and verify all dimensions and be responsible for same; reporting any discrepancies to the Architect before commencing work.  
 All drawings, prints and specifications are the property of the Architect and must be returned to him on completion of work. Latest drawings only to be used for construction.  
 Prints are not to be scaled.

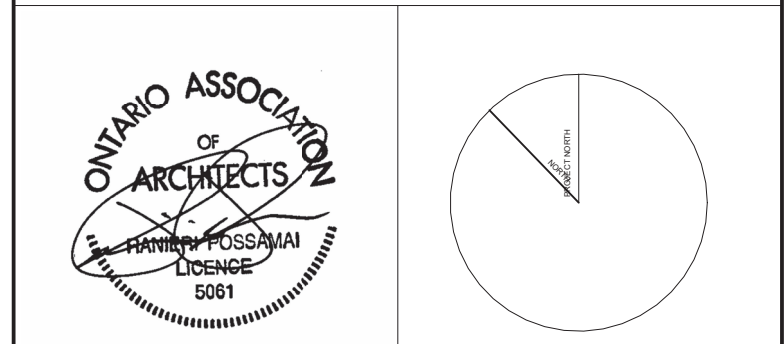

**GLOBAL**  
 6 Leavitt Road, Toronto, Ontario M6A 1K2  
 Tel: 416 256 4440 Fax: 416 256 4449

**FOREST GREEN HOMES**

**CLIENT** Forest Green Homes  
 150 RUTLEDGE RD. MISSISSAUGA (STREETSVILLE) ONT.

**PROJECT NAME** Vic 2  
 150 RUTLEDGE RD. MISSISSAUGA (STREETSVILLE) ONT.

**DRAWN BY** CM, DO  
**CHECKED BY** RP, PP  
**DATE** 06/29/21  
**SCALE** As indicated  
**DWG. TITLE**

**SITE P1 PLAN**

<b>PROJECT NO.</b>	<b>A103</b>
<b>22-03</b>	

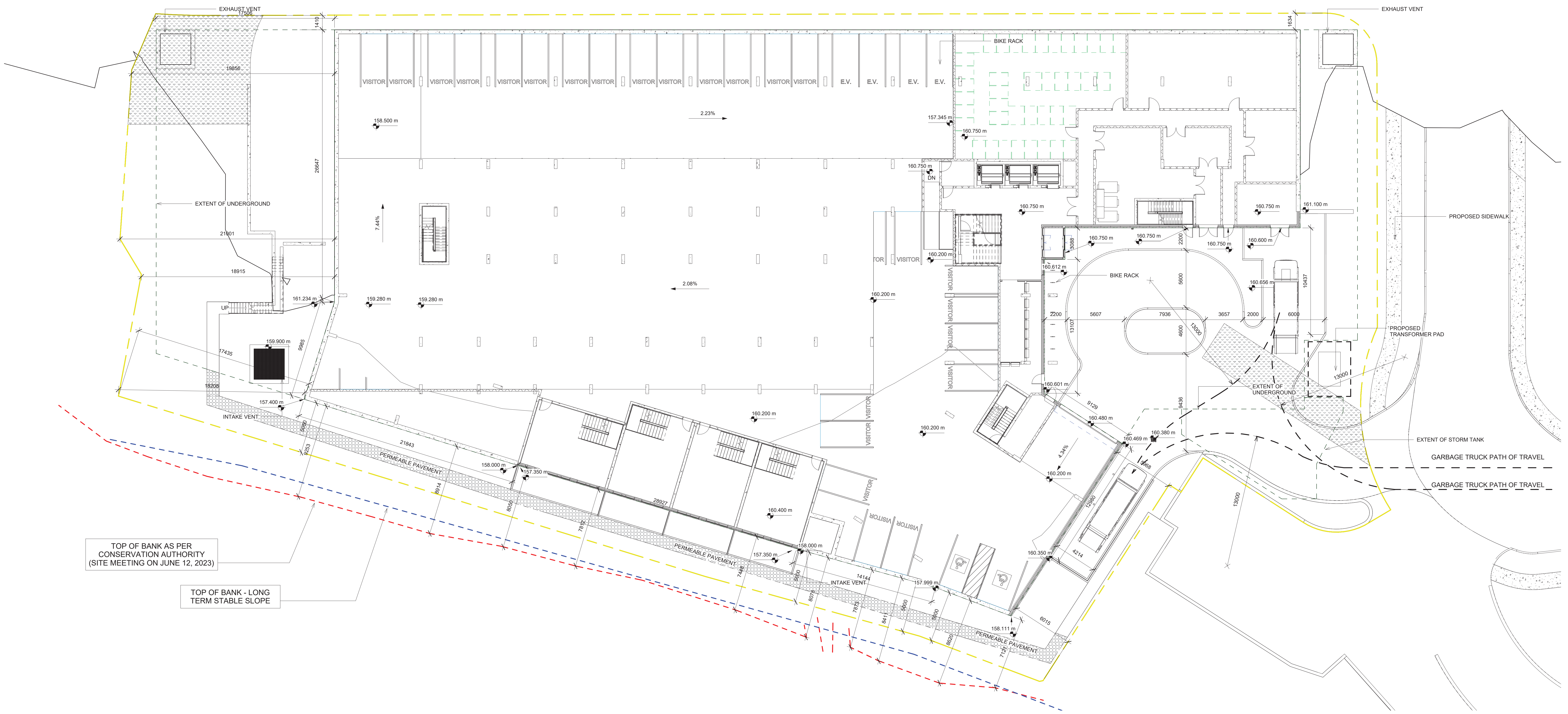

TOP OF BANK AS PER CONSERVATION AUTHORITY (SITE MEETING ON JUNE 12, 2023)

TOP OF BANK - LONG TERM STABLE SLOPE