

EROSION CONTROLS

4. ALL SILT FENCING AND EROSION CONTROL MEASURES TO BE INSTALLED PRIOR TO COMMENCEMENT OF ANY WORK AND REMAIN IN PLACE UNTIL THE SITE HAS STABILIZED (I.E. PAVED, VEGETATION OR OTHER COVER) AND ANY ACCUMULATED SEDIMENT IS REMOVED.
5. SEDIMENT CONTROL PROTECTION SHALL BE PLACED AS DETAILED AND TO BE PROVIDED AROUND ALL SANITARY AND STORM MAINTENANCE HOLES AND CATCHBASINS, SHALL REMAIN IN PLACE UNTIL SITE IS STABILIZED.
6. SEDIMENT CONTROL MEASURES MUST BE INSPECTED IMMEDIATELY AFTER EVERY RAIN EVENT OR AS DIRECTED BY SITE ENGINEER.
7. SEDIMENT MUST BE REMOVED FROM SILT FENCE WHEN ACCUMULATION REACHES $\frac{1}{3}$ OF THE HEIGHT OF THE FENCE.
8. SILT REMOVAL MUST BE UNDERTAKEN WITH CARE TO MINIMIZE OFF-SITE SEDIMENTATION.
9. CONTRACTOR TO SUPPLY, PLACE AND MAINTAIN TERRAFIX SILT SACK SEDIMENT TRAPS IN CATCH BASINS, OR APPROVED EQUAL.
10. EROSION CONTROL MEASURES ARE TO BE MONITORED WEEKLY TO ENSURE FENCING IS INSTALLED AND MAINTENANCE IS PERFORMED TO CITY REQUIREMENTS AND ANY DAMAGE TO THE MEASURES IS REPAIRED IMMEDIATELY.
11. THE CONTRACTOR IS RESPONSIBLE TO ENSURE THAT ANY ADJACENT MUNICIPAL ROADWAYS AND SIDEWALKS ARE CLEANED OF ALL MUD, DIRT AND DEBRIS AT ALL TIMES AND MUST BE CLEANED AT A MINIMUM OF TWO TIMES PER WEEK, AS REQUIRED OR AT THE DIRECTION OF THE CITY.
12. SEDIMENT AND EROSION CONTROL PLAN IS A DYNAMIC DOCUMENT, WHICH MAY BE SUBJECT TO CHANGE OR MODIFICATIONS AS A RESULT OF SITE DEVELOPMENTS OR CHANGES ON SITE.
13. ADDITIONAL SEDIMENT CONTROL MEASURES MAY BE REQUIRED AS DETERMINED BY THE CITY. THE CONTRACTOR IS TO PROVIDE ALL ADDITIONAL EROSION CONTROL MEASURES.
14. AN AFTER HOURS CONTACT NUMBER IS TO BE VISIBLY POSTED ON-SITE FOR EMERGENCIES.
15. IF SITE CONSTRUCTION ACTIVITIES ARE INTERRUPTED AND/OR INACTIVITY EXCEEDS 30 DAYS, ALL STRIPPED AND/OR BARE SOIL AREAS ARE TO BE STABILIZED BY SODDING/SEEDING/MULCHING OR OTHER APPROVED METHODS TO THE APPROVAL OF THE SITE ENGINEER.
16. ALL EROSION AND SEDIMENTATION CONTROL DEVICES ARE TO BE INSTALLED AND MAINTAINED IN ACCORDANCE WITH THE REQUIREMENTS OF THE CITY OF MISSISSAUGA.
17. EXCESS WATER FROM THE SITE SHALL NOT BE PUMPED INTO THE CITY AND/OR REGIONAL SYSTEMS UNLESS NECESSARY PERMITS AND/OR APPROVALS ARE IN PLACE.

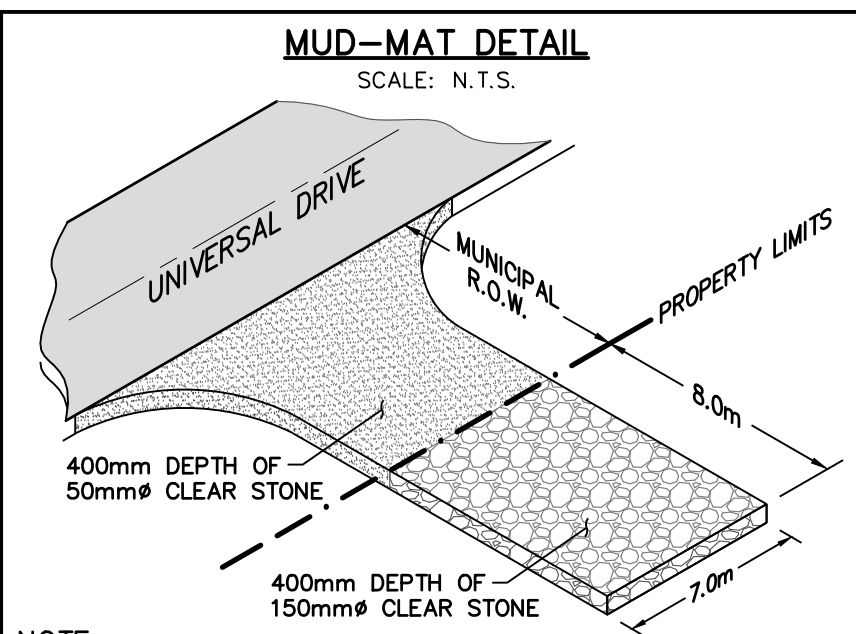

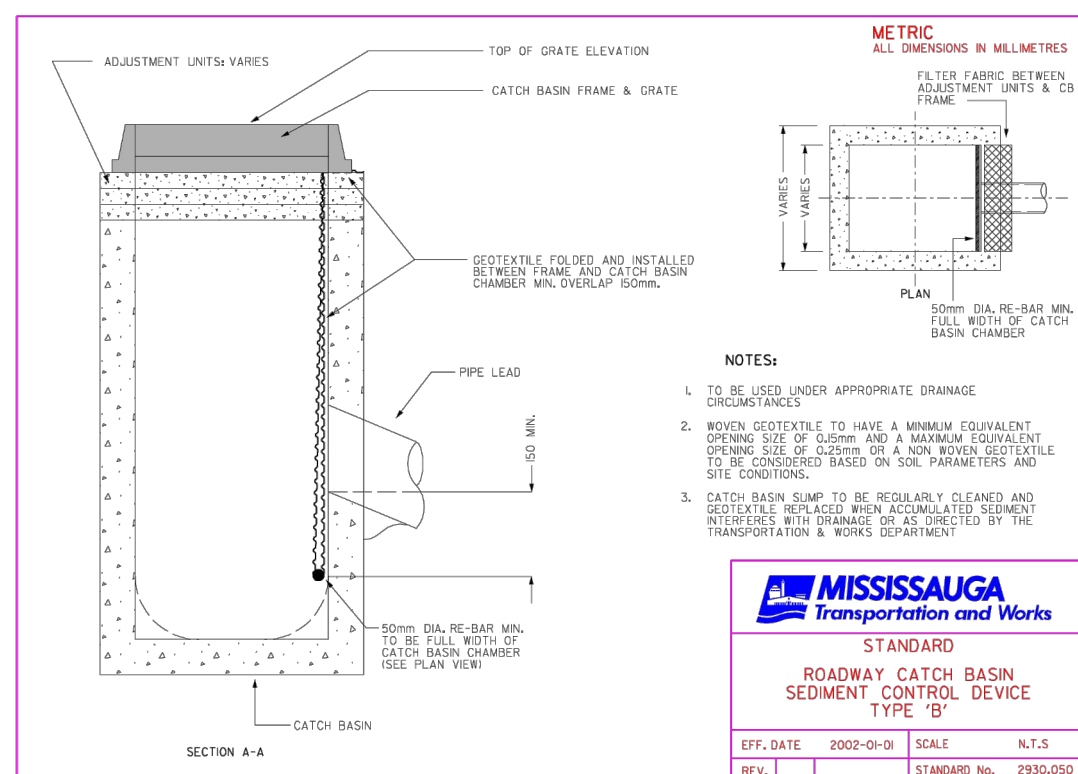





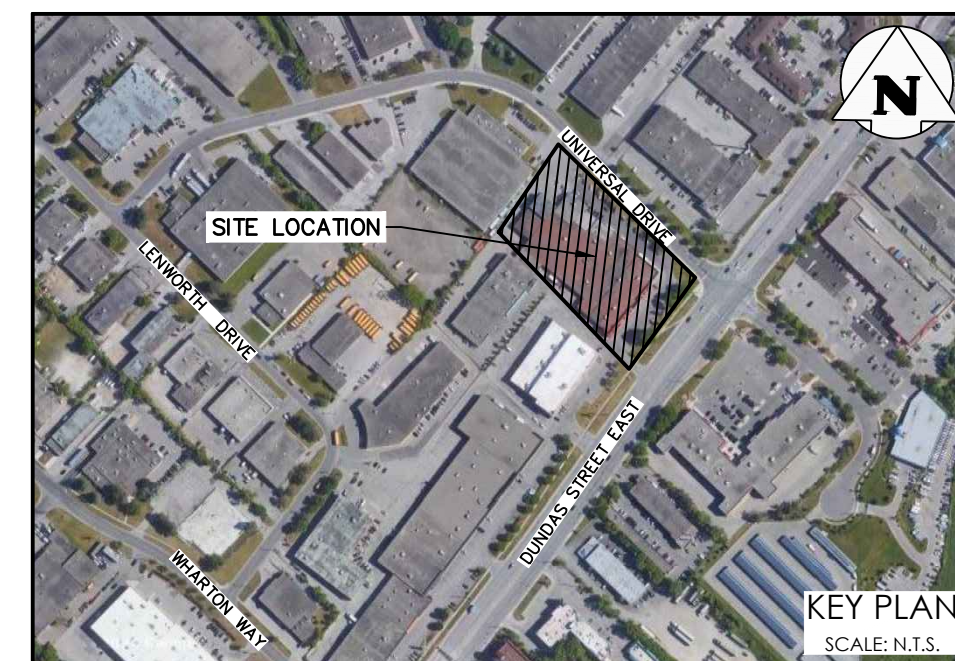
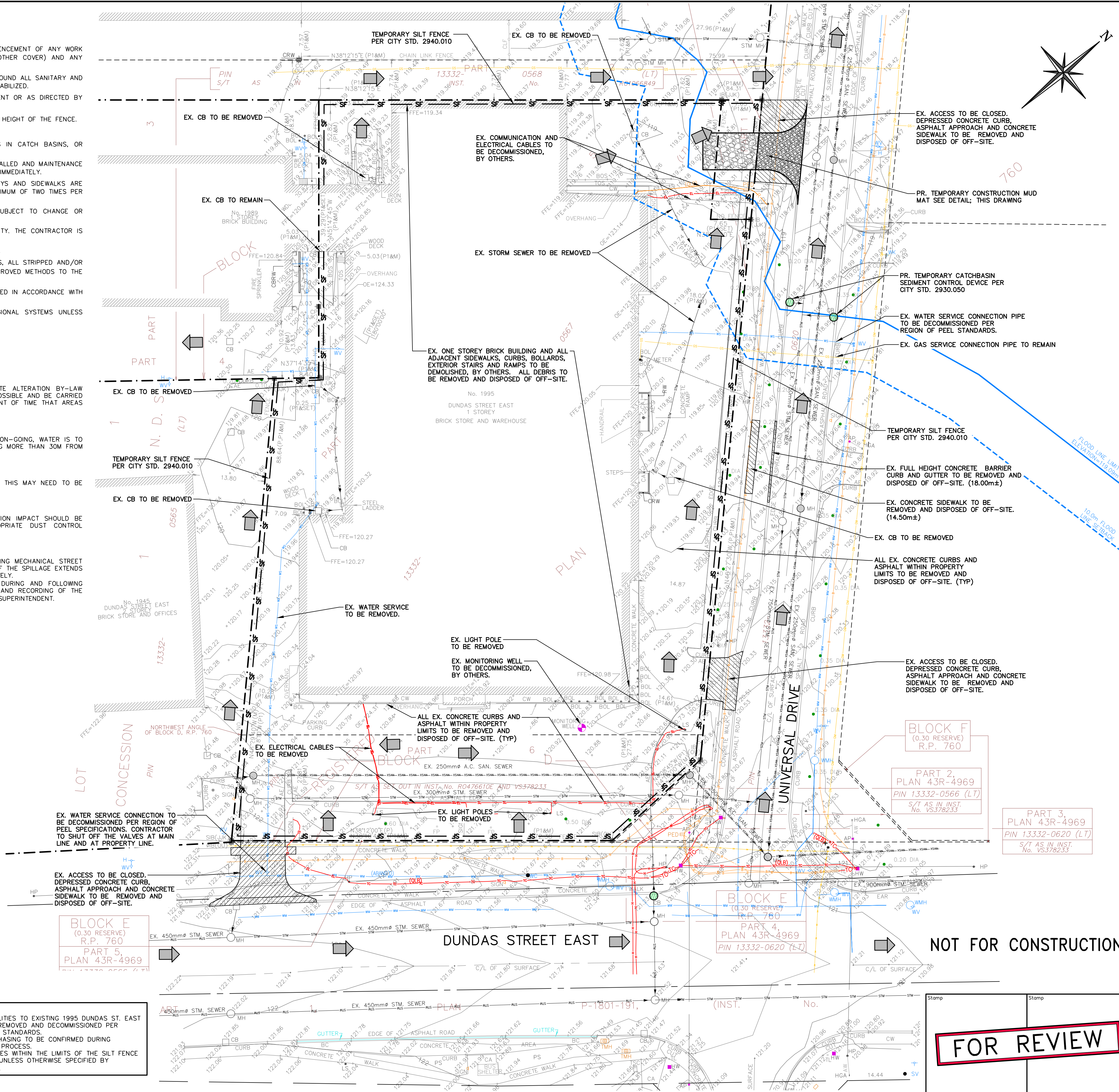
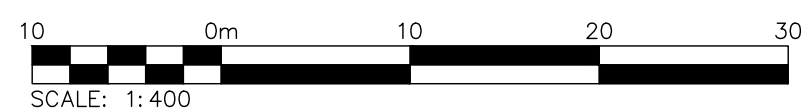

DUST CONTROL WILL BE SUPPLIED BY THE GENERAL CONTRACTOR, BY WAY OF THE FOLLOWING:

- PRE-GRADING PLANNING**
- 1.1. TOPSOIL STRIPPING AND EARTHWORKS WILL COMMENCE UPON RECEIPT OF THE SITE ALTERATION BY-LAW PERMIT FROM THE CITY OF VAUGHAN. THE SERVICING WILL COMMENCE AS SOON AS POSSIBLE AND BE CARRIED OUT IN CONJUNCTION WITH THE EARTHWORKS. THIS WILL REDUCE THE OVERALL AMOUNT OF TIME THAT AREAS ARE LEFT SUSCEPTIBLE TO WIND THAT CREATES BLOWING DUST.
- 2. WATERING (POST-GRADING)**
- 2.1. WITHIN AREAS WHERE EARTHWORKS OR UNDERGROUND MUNICIPAL SERVICING IS ON-GOING, WATER IS TO BE UTILIZED AT SUFFICIENT QUANTITY TO PREVENT VISIBLE EMISSIONS FROM EXTENDING MORE THAN 30M FROM THE POINT OF ORIGIN.
- 3. REDUCE VEHICLE SPEED**
- 3.1. THE ON-SITE SPEED LIMIT FOR CONSTRUCTION VEHICLES WILL BE 25KM/H MAXIMUM. THIS MAY NEED TO BE USED IN CONJUNCTION WITH WATERING TO PREVENT VISIBLE DUST EMISSIONS.
- 4. RESTRICT ACTIVITIES DURING HIGH WIND PERIODS**
- 4.1. THE HIGH VISIBILITY OF CERTAIN WORKS AND THE CLOSE PROXIMITY AND POPULATION IMPACT SHOULD BE TAKEN INTO CONSIDERATION WHEN SCHEDULING DUST-PRODUCING WORK. APPROPRIATE DUST CONTROL MEASURES SHALL BE IN PLACE IN SUCH SITUATIONS.
- 5. ROAD CLEANING**
- 5.1. SPILLAGE, EROSION OR MATERIALS "TRACKED OUT" ON A ROAD TO BE CLEANED USING MECHANICAL STREET SWEEPERS OR FLUSHER TRUCK AT LEAST BY THE END OF THE WORK DAY. HOWEVER, IF THE SPILLAGE EXTENDS MORE THAN 15M ALONG A PAVED PUBLIC ROADWAY IT MUST BE CLEANED UP IMMEDIATELY.
- 5.2. IMPORTING AND EXPORTING OF MATERIALS ON AND OFFSITE WILL BE SHUT DOWN DURING AND FOLLOWING INCLEMENT WEATHER UNTIL THE ROAD SURFACES HAVE BEEN CLEANED. MONITORING AND RECORDING OF THE SITE CONDITIONS WILL BE UNDERTAKEN BY FIELD STAFF AND THE CONTRACTOR'S SITE SUPERINTENDENT.



NOTE:
GEOTEXTILE (TERRAFIX 270R OR APPROVED EQUAL) TO BE PLACED AS
SEPARATION BARRIER BETWEEN EXISTING GROUND AND CLEAR STONE.



	PROPERTY LINE
	EXISTING CONTOUR (0.5m)
	EXISTING CONTOUR (1.0m)
	EXISTING DITCH
	EXISTING HYDRO POLE
	EXISTING FENCE
	EXISTING GRADE
	EXISTING OVERLAND FLOW DIRECTION
	MUD-MAT; SEE DETAIL
	SILT FENCE; SEE DETAIL
	TEMPORARY CATCHBASIN SILTATION CONTROL DEVICE.

0	ISSUED FOR SUBMISSION	2024/DEC/C
No.	ISSUE / REVISION	YYYY/MMM/

BEARING NOTE:
BEARINGS ARE UTM GRID, DERIVED FROM OBSERVED REFERENCE POINTS A AND B, REAL TIME NETWORK (RTN) OBSERVATIONS, UTM ZONE 17, NAD 83 (CSRS) (2010.0).

BENCHMARK:
ELEVATIONS SHOWN ON THIS PLAN ARE RELATED TO GEODETIC DATUM AND ARE DERIVED FROM ONTARIO BENCHMARK No. 00119653206, HAVING A PUBLISHED ELEVATION OF 121.950 METRES. (CGVD28: 78).

SURVEY NOTES:
SURVEY COMPLETED BY J.D. BARNES LIMITED, NOVEMBER 28, 2023.
REFERENCE No. 2023-21-012-00

SITE PLAN NOTES:
DESIGN ELEMENTS ARE BASED ON CONCEPTUAL SITE PLAN BY RAW.
DATED: DECEMBER 04, 2024
JOB No. 22073, SHEET NUMBER: A100

DRAWING NOTES:

THIS DRAWING IS THE EXCLUSIVE PROPERTY OF C.F. CROZIER & ASSOCIATES INC. AND THE REPRODUCTION OF ANY PART OF IT WITHOUT PRIOR WRITTEN CONSENT OF THIS OFFICE IS PROHIBITED.

THE CONTRACTOR SHALL VERIFY ALL DIMENSIONS, LEVELS, AND DATUMS ON SITE AND REPORT ANY DISCREPANCIES OR OMISSIONS TO THIS OFFICE PRIOR TO CONSTRUCTION.

THIS DRAWING IS TO BE READ AND UNDERSTOOD IN CONJUNCTION WITH ALL OTHER PLANS AND DOCUMENTS APPLICABLE TO THIS PROJECT. DO NOT SCALE THIS DRAWING.

ALL EXISTING UNDERGROUND UTILITIES TO BE VERIFIED IN THE FIELD BY THE CONTRACTOR PRIOR TO CONSTRUCTION.

Project	1995 DUNDAS STREET EAST CITY OF MISSISSAUGA
---------	--

REMOVALS, EROSION AND
SEDIMENT CONTROL PLAN

Drawn	M.I.M	Design	M.I.M	Project No.	2707-7161
Check	N.C.	Check	N.C.	Scale	1: 400
				Dwg.	C 10

FOR REVIEW