

FILENAME: C:\Users\Julian2\Documents\CD\CD\Edenshaw\Envision - LDP\Project Files\25-0893\23 Elizabeth Street North.dwg
PLOTDATE: May 27, 2025, 10:45am, Julian2\peel

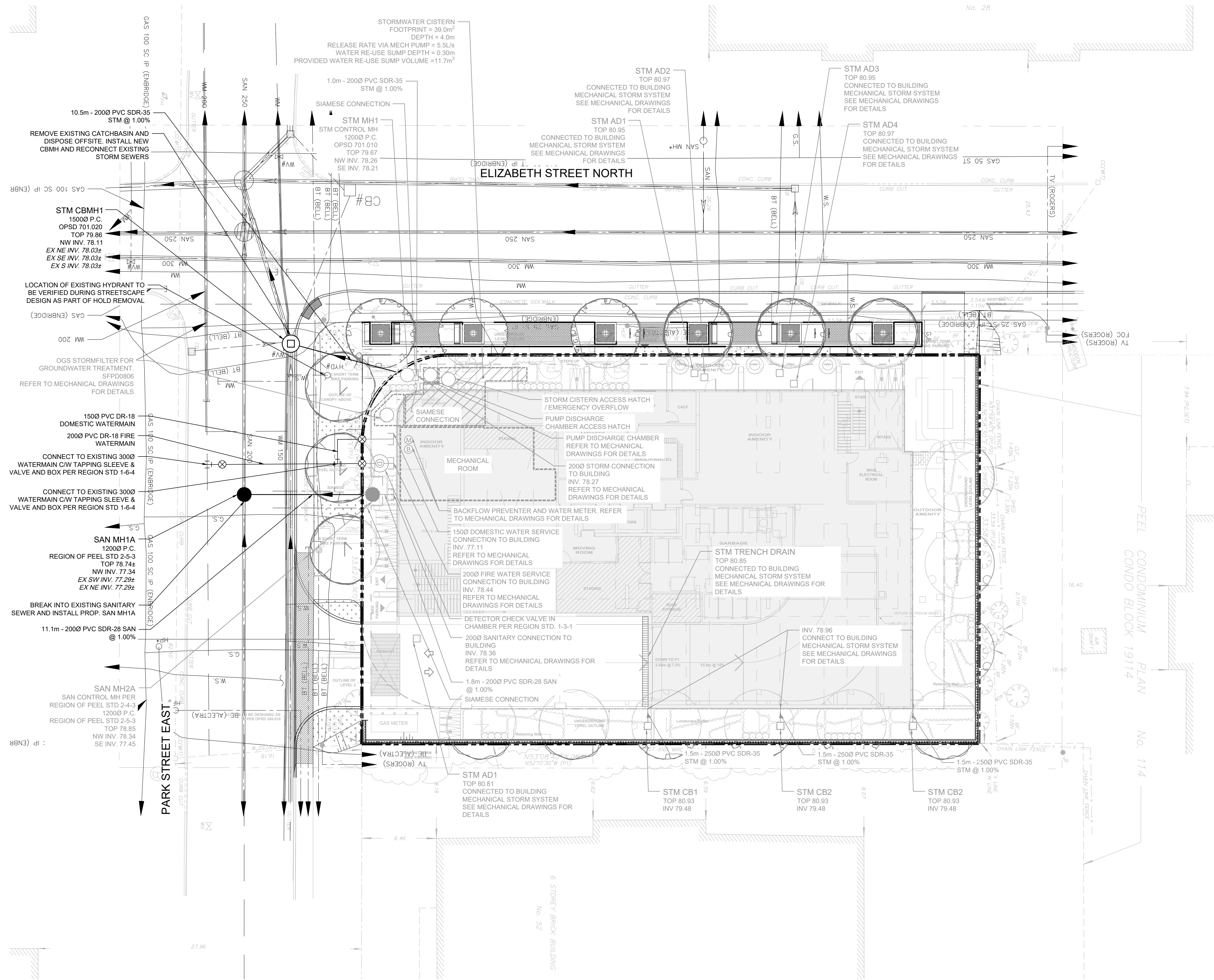

PROPOSED SERVICES OTHER THAN WATER, SANITARY AND STORM HAVE NOT BEEN DESIGNED AND HAVE NOT BEEN INCLUDED ON THIS PLAN

TREE PLANTING TRENCH LOCATION PER LANDSCAPE PLANS PREPARED BY LAND ART DESIGN

PROPOSED UTILITY DESIGN IS PRELIMINARY AND SUBJECT TO CHANGE DURING THE DETAILED DESIGN PHASE OF THE PROJECT

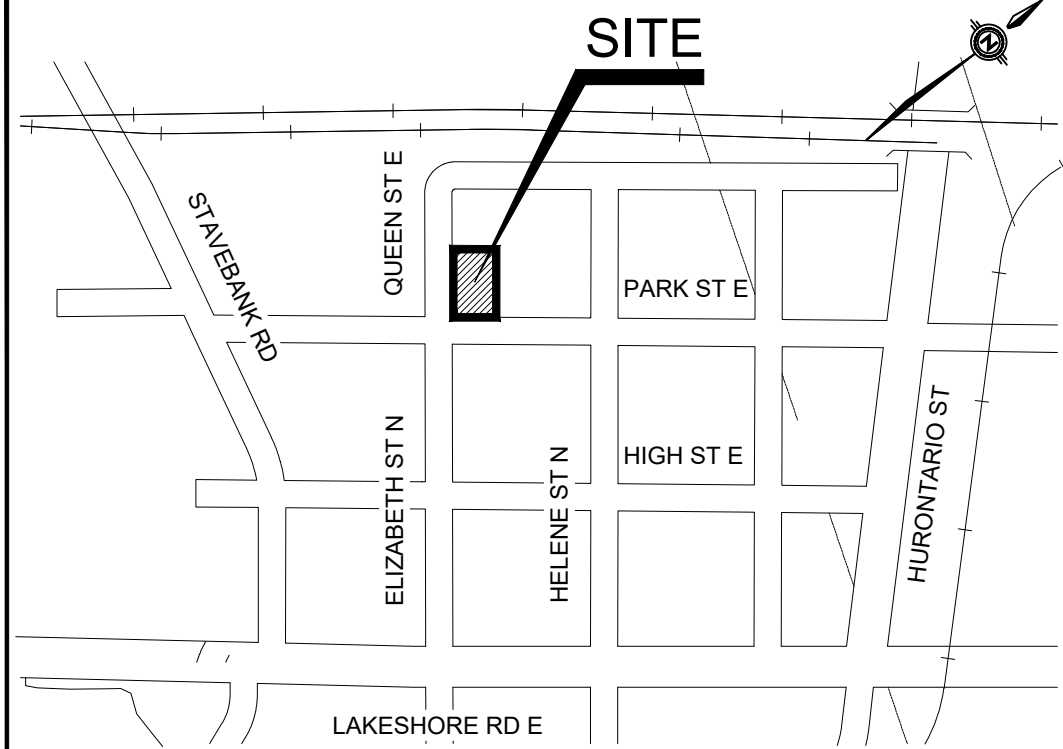
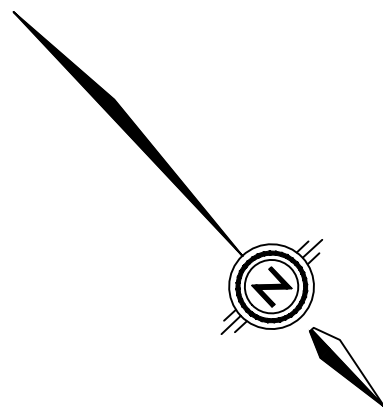

KEY PLAN		NTS
LEGEND		
	EX. VALVE & CHAMBER	
	EX. HYDRANT	
	EX. SANITARY MANHOLE	
	EX. STORM MANHOLE	
	EX. CATCHBASIN	
	SANITARY MANHOLE	
	STORM MANHOLE	
	CATCHBASIN	
	DOUBLE CATCHBASIN	
	VALVE AND BOX	
	HYDRANT AND VALVE	
	LIMIT OF PROPERTY	

BENCHMARK NOTES:
ELEVATION ARE REFERRED TO MISSISSAUGA DATUM, AND WERE DERIVED FROM THE CITY OF MISSISSAUGA BENCHMARK NO. 3470, HAVING A PUBLISHED ELEVATION OF 78.304 METRES, (TO OBTAIN GEODETIC ELEVATIONS (1978 G.S.C RE-ADJUSTMENT), SUBTRACT 0.121 METRES FROM THE VALUES SHOWN HEREIN)
ALL DIMENSIONS AND ELEVATIONS ARE IN METRES UNLESS OTHERWISE NOTED.
PIPE SIZES ARE IN MILLIMETRES

REVISIONS			
No.	REVISIONS	DATE	APPR. BY
2	REISSUED FOR O.P.A / Z.B.A SUBMISSION	MAY 23/25	D.A.
1	ISSUED FOR O.P.A / Z.B.A / S.P.A SUBMISSION	FEB 19/25	D.A.

CLIENT
EDENSHAW ELIZABETH DEVELOPMENTS LIMITED

PROJECT TITLE
23 ELIZABETH STREET NORTH & 42 - 46 PARK STREET EAST MISSISSAUGA, ONTARIO

STAMP

APPROVED AS TO FORM IN RELIANCE UPON THE PROFESSIONAL SKILL AND ABILITY OF ENVISION CONSULTANTS LTD. AS TO DESIGN AND SPECIFICATION

DIRECTOR OF DEVELOPMENT / TRANSPORTATION ENGINEERING

CONSULTANT

6415 Northwest Dr. Mississauga, ON Canada L4V 1X1
Office (905) 677-0202
E-mail: admin@envisionconsultants.ca

MUNICIPALITY

SHEET TITLE			UTILITY PLAN
DESIGNED BY: D.A.	DATE: FEB 2025	CHECKED BY: A.W.	
DRAWN BY: M.R.	PROJECT No.		
SCALES: 1: 200	25-0893	DRAWING No. C-108	