

KEY PLAN

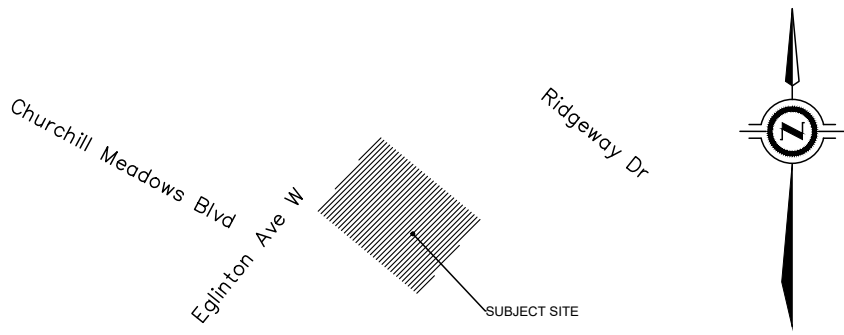

DISTANCES SHOWN ON THIS PLAN ARE IN METRES AND CAN BE CONVERTED TO FEET BY DIVIDING BY 0.3048. THE POSITION OF POLE LINES, CONDUITS, WATERMAINS, SEWERS AND OTHER UNDERGROUND AND OVERGROUND UTILITIES AND STRUCTURES IS NOT NECESSARILY SHOWN ON THE CONTRACT DRAWING, AND WHERE SHOWN, THE ACCURACY OF THE POSITION OF SUCH UTILITIES AND STRUCTURES IS NOT GUARANTEED BEFORE STARTING WORK, THE CONTRACTOR SHALL INFORM HIMSELF OF THE EXACT LOCATION OF ALL SUCH UTILITIES AND STRUCTURES, AND SHALL ASSUME ALL LIABILITY FOR DAMAGE TO THEM.

LEGEND

- PROPERTY LINE
- PROP.  $\phi$  OF SWALE
- PROPOSED ELEVATION
- EXISTING ELEVATION
- $\times 232.55TC$  TOP OF CURB
- $\times 232.55BC$  BOTTOM OF CURB
- $\times 232.55SWL$  CENTER OF SWALE
- BUILDING ENTRANCE
- 3:1 SLOPE
- CONSTRUCTION AREA
- OVERLAND FLOW ROUTE
- PROPOSED PERMEABLE PAVERS
- EXISTING TREE PROTECTION HOARDING

3	ISSUED FOR SUBMISSION	MAR 04 2025	W.L.	G.R.
2	ISSUED FOR SUBMISSION	SEP 04 2024	W.L.	G.R.
1	ISSUED FOR SUBMISSION	FEB 06 2024	W.L.	G.R.
NO.	Revision	Date	By	App'd

**BENCHMARK**  
BEARINGS ARE UTM GRID, DERIVED FROM OBSERVED REFERENCE POINTS (ORP'S) A & B BY REAL NETWORK (RTN) OBSERVATIONS, UTM ZONE 17, NAD 83 (CSRS, 2010)

POINT ID	NORTHING	EASTING
A	4818684.69	590032.23
B	4818472.87	590207.97

CONSULTANT	ACCEPTED CITY OF MISSISSAUGA
SIGNATURE	DATE



3650 EGLINTON AVENUE WEST

SITE GRADING PLAN

Surveyed by: W.L.	Checked by: G.R.	Project No. NT-22-129
Drawn by: W.L.	Approved by: G.R.	Drawing No. SG-01
Designed by: W.L.	Date: JAN. 23, 2023	Sheet No.
Scale: 1:200		1 OF 6

Pavement Design  
Provided by Soil Engineers Ltd., October 2023

Course	Thickness (mm)	OPSS Specifications
Asphalt Surface	40	HL-3
Asphalt Binder	65	HL-8
Granular Base	200	Granular 'A'
Granular Sub-Base	250	Granular 'B'