

1. Public and private services, appurtenances, materials and construction methods must comply with the most current Region of Peel standards and specifications, the Local Municipality's requirements for the Ontario Building Code and Ontario Provincial Standards. All works shall adhere to all applicable legislation, including Regional by-laws.
2. Watermain and / or water service materials 100 mm (4") and larger must be **PVC DR18** constructed as per **AWWA C900-16**. Size 50 mm (2") and smaller must be **Type K Soft Copper** constructed as per **ASTM B88-49** or **Polyethylene** constructed as per **AWWA C901** and **CSA B.137.10 (Choose only one material)**.
3. Watermains and / or water services are to have a minimum cover of 1.7 m (5'6") with a minimum horizontal spacing of 1.2 m (4") from themselves and all other utilities.
4. Provisions for flushing water line prior to testing, etc. must be provided with at least a50 mm (2") outlet on 100 mm (4") and larger lines. Copper lines are to have flushing points at the end, the same size as the line. They must also be hose or piped to allow the water to drain onto a parking lot or down a drain. On fire lines, flushing outlet to be 100 mm (4") diameter minimum on a hydrant.
5. All curb stops to be 3.0 m (10') off the face of the building unless otherwise noted.
6. Hydrant and valve set to Region standard 1 - 6 - 1 Dimension A and B, 0.7 m (2') and 0.9 m (3') and to have pump nozzle.
7. Watermains to be installed to grades as shown on approved site plan. Copy of grade sheet must be supplied to inspector prior to commencement of work, where requested by inspector.
8. Watermains must have a minimum vertical clearance of 0.3 m (12") over / 0.5 m (20") under sewers and all other utilities when crossing.
9. All proposed water piping must be isolated from existing lines in order to allow independent pressure testing and chlorinating from existing systems.
10. All live tapping and operation of Region water valves shall be arranged through the Regional Inspector assigned or by contacting the Operations and Maintenance Division.
11. Location of all existing utilities in the field to be established by the contractor.
12. The contractor(s) shall be solely responsible for locating, exposing, supporting and protecting of all underground and overhead utilities and structures existing at the time of construction in the area of their work. Whether shown on the plans or not and for all repairs and consequences resulting from damage to same.
13. The contractor(s) shall be solely responsible to give 72 hours written notice to the utilities prior to crossing such utilities, for the purpose of inspection by the concerned utility. This inspection will be for the duration of the construction, with the contractor responsible for all costs arising from such inspection.
14. All proposed water piping must be isolated through a temporary connection that shall include an appropriate cross-connection control device, consistent with the degree of hazard, for backflow prevention of the active distribution system, conforming to Region of Peel standards 1-7-7 or 1-7-8.
15. All water meters must be installed in heated and accessible space.
16. Proposals to connect to an existing service lateral requires approval from the Region of Peel inspector at construction stage.

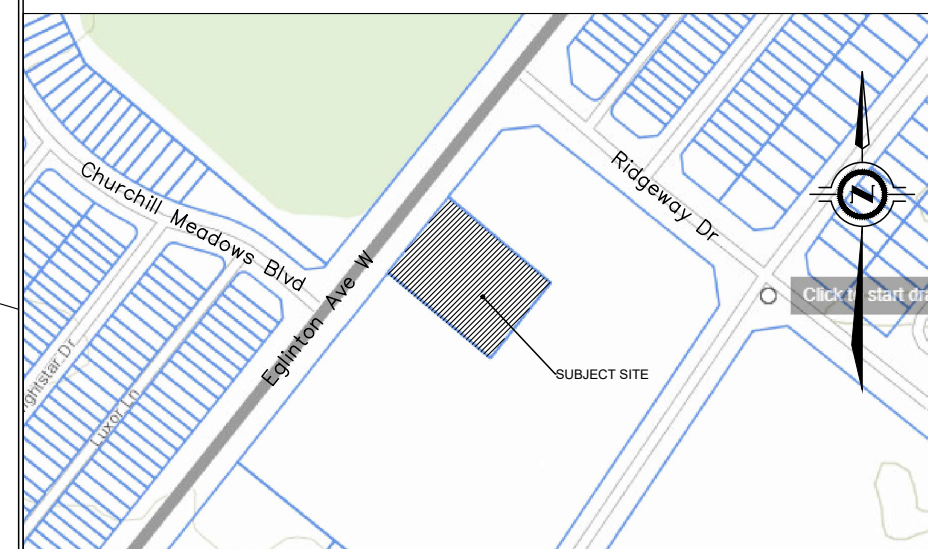
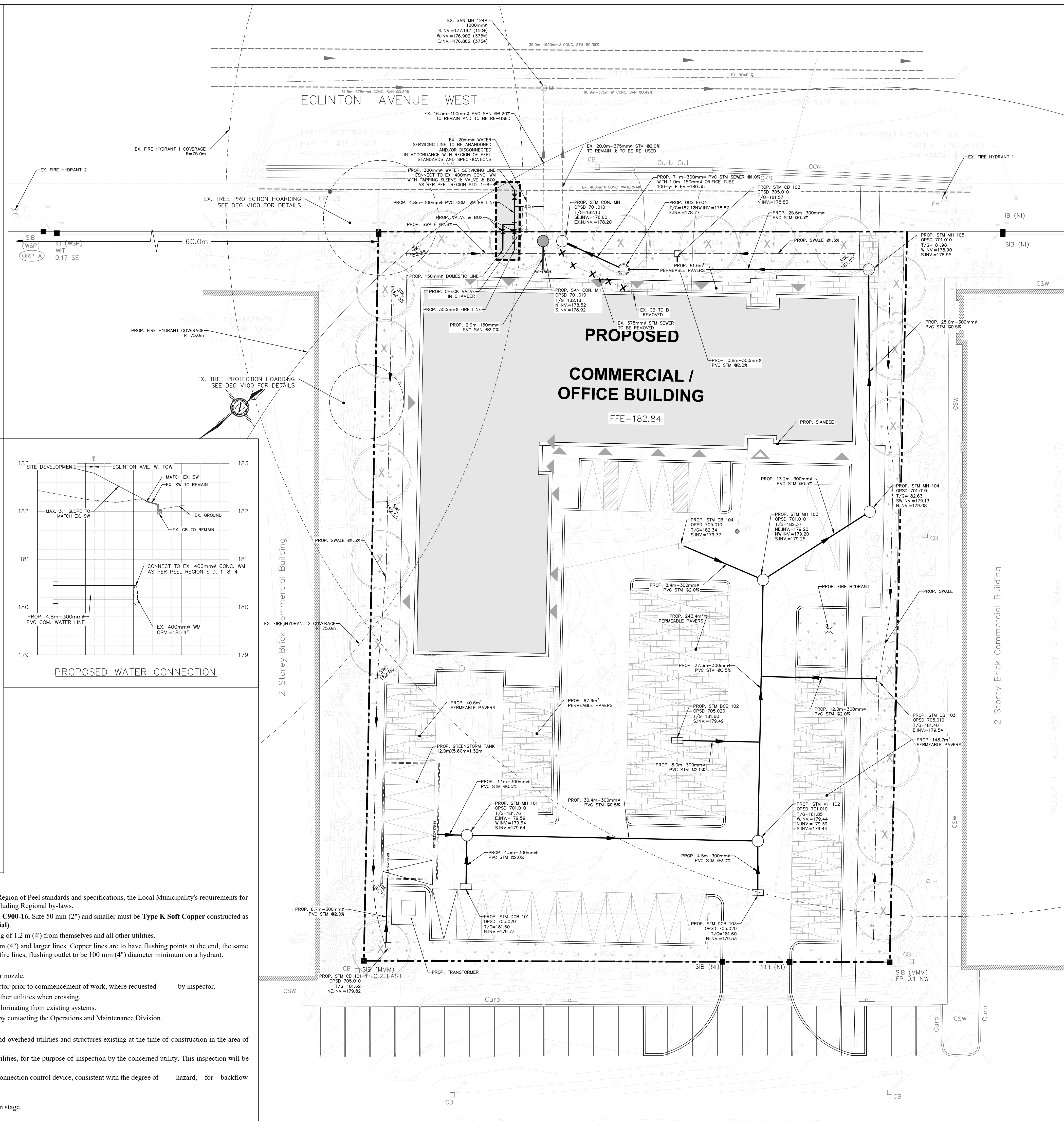

	PROPOSED WATERMAIN
	EXISTING WATERMAIN
	PROPOSED SANITARY SEWER
	EXISTING SANITARY SEWER
	PROPOSED STORM SEWER
	EXISTING STORM SEWER
	PROPOSED ROOF DRAIN PIPE
	EXISTING HYDRANT AND VALVE
	EXISTING VALVE CHAMBER
	EXISTING STORM MH
	EXISTING SANITARY MH
	PROPOSED STORM MH
	PROPOSED SANITARY MH
	PROPOSED STORM CATCHBASIN MH
	EXISTING CATCHBASIN SINGLE
	PROPOSED CATCHBASIN
	VALVE & BOX
	TAPPING SLEEVE & VALVE & BOX
	PROPERTY LINE
	PROPOSED PERMEABLE PAVERS
	CONSTRUCTION AREA
	TO BE REMOVED
	EXISTING TREE PROTECTION HOARDING

4	ISSUED FOR SUBMISSION	MAR 04 2025	W.L.	G.R.
3	ADDRESS REGION'S COMMENTS	NOV 18 2024	W.L.	G.R.
2	ISSUED FOR SUBMISSION	SEP 04 2024	W.L.	G.R.
1	ISSUED FOR SUBMISSION	FEB 06 2024	W.L.	G.R.
NO.	Revision	Date	By	Appr'd

BEARINGS ARE UTM GRID, DERIVED FROM OBSERVED REFERENCE POINTS (ORP'S) A & B BY REAL NETWORK (RTN) OBSERVATIONS, UTM ZONE 17, NAD 83 (CSRS, 2010)

POINT ID	NORTHING	EASTING
A	4818684.69	590032.23
B	4818472.87	590207.97

CONSULTANT	ACCEPTED CITY OF MISSISSAUGA
	<hr/> SIGNATURE DATE



Surveyed by: <u>COMPTON MATHIAS, LINT</u>	Checked by: <u>G.R.</u>	Project No. NT-22-129
Drawn by: <u>W.L.</u>	Approved by: <u>G.R.</u>	Drawing No. SS-01
Designed by: <u>W.L.</u>	Date: <u>JAN. 23, 2023</u>	
Scale: 1:200		Sheet No.
		3 OF 6