

All sod shall conform to the standards of the Nursery Sod Growers Association of Ontario. All sodded areas shall be prepared with a minimum of 100mm of topsoil and sodded with #1 bluegrass - fescue nursery sod.

All planting beds are to be continuous, and excavated to a minimum depth of 450mm unless noted otherwise. Planting beds are to be filled with a soil mixture composed of six (6) parts sand loam, two (2) parts well rotted manure, and one (1) part peat moss, in addition to the fertilizers specified above.

All beds are to be covered with a 75mm depth of clean, shredded pine bark mulch by Gro-Bark or approved equal unless noted otherwise. Guying and staking of trees shall conform to the planting details. Wrap all deciduous trees as per the specifications of the Ontario Landscape Contractors Association.

The contractor will be responsible for the protection of all plant material from damages resulting from winter conditions as well as rodents during the warranty period. Apply "Skoot" rodent deterrent formula (or approved equal) to all coniferous trees and all shrubs in late October as per manufacturer's directions.

1	LANDSCAPE SPECIFICATIONS
.D1	N.T.S

1. Do not scale the drawings. All dimensions are in millimeters unless noted otherwise.
2. This drawing is to be read in conjunction with the overall master plan and engineering drawings prepared by the project engineer and site plans prepared by the project architect.
3. The contractor shall check and verify all existing and proposed grading and conditions on the project and immediately report any discrepancies to the consultant before proceeding with any work.
4. The contractor is to be aware of all existing and proposed services and utilities. The contractor is responsible for having all underground services and utility lines staked by each agency having jurisdiction prior to commencing work.
5. This drawing is to be used for development approval only. For layout of all work refer to construction drawings.
6. Plant quantities indicated on the plan supercede the quantities from the plant list (report any discrepancies to the landscape architect).
7. Do not leave any holes open overnight.
8. Keep area outside construction zone clean and useable by others at all times. Contractor shall thoroughly clean areas surrounding the construction zone at the end of each work day.
9. Contractor to make good any and all damages outside of the development area that may occur as a result of construction at no extra cost.
10. This drawing is Copyright MHBC 2025

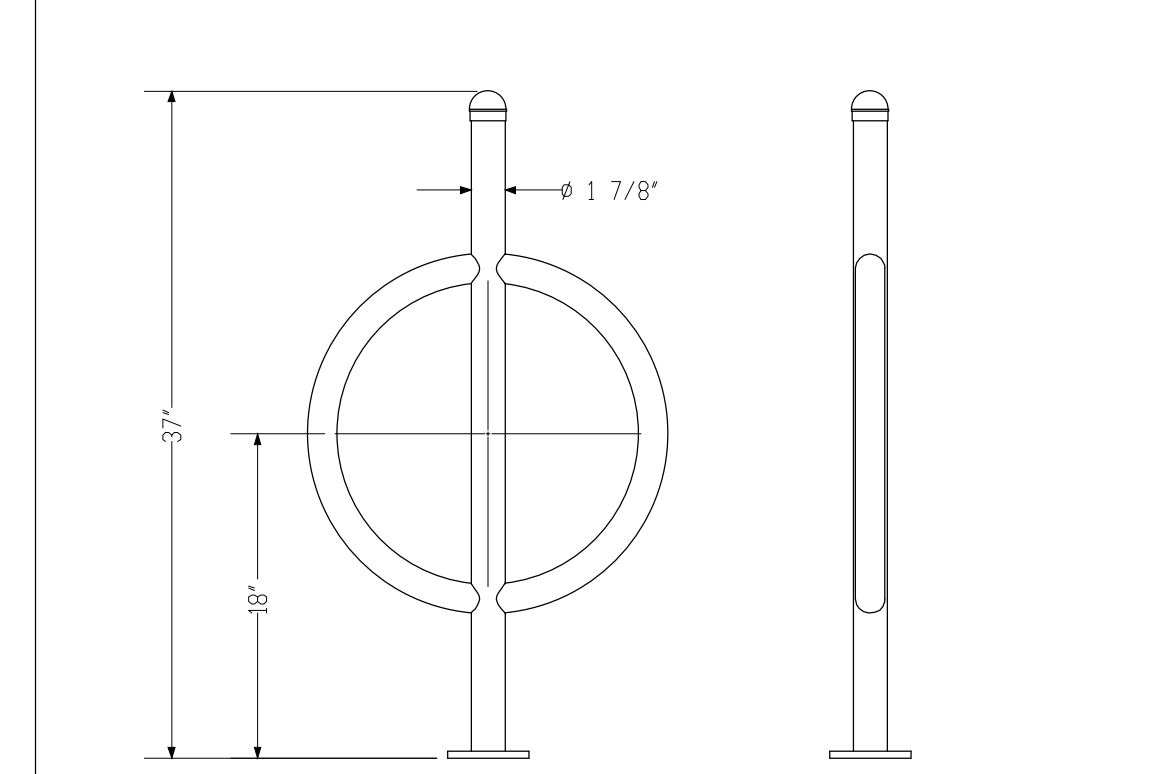
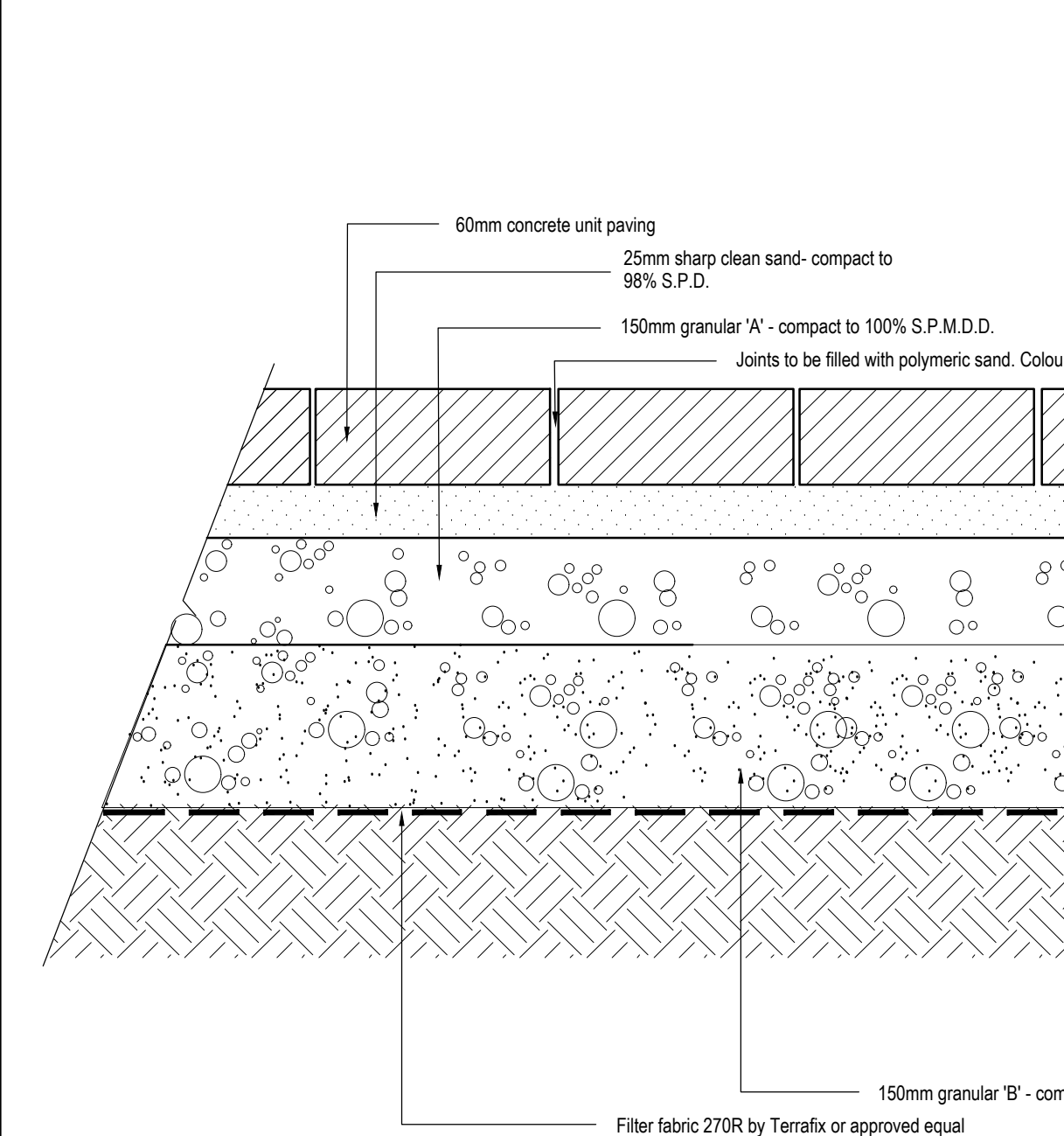

7	MAGLIN 100 BIKE RACK
LD1	N.T.S

STAMP DATE AUGUST 2005

PROJECT

128 LAKESHORE AVE E

LANDSCAPE DETAILS