

This drawing is an instrument of service, it is provided by and is the property of Turner Fleischer. The contractor must verify and accept responsibility for all dimensions and conditions on site and must notify Turner Fleischer of any variations from the supplied information. This drawing is not to be used for any other project without the written consent of Turner Fleischer. The contractor must comply with all applicable codes and requirements of all applicable laws and regulations. The contractor must ensure full responsibility and bear costs for any corrections or damages resulting from his work.

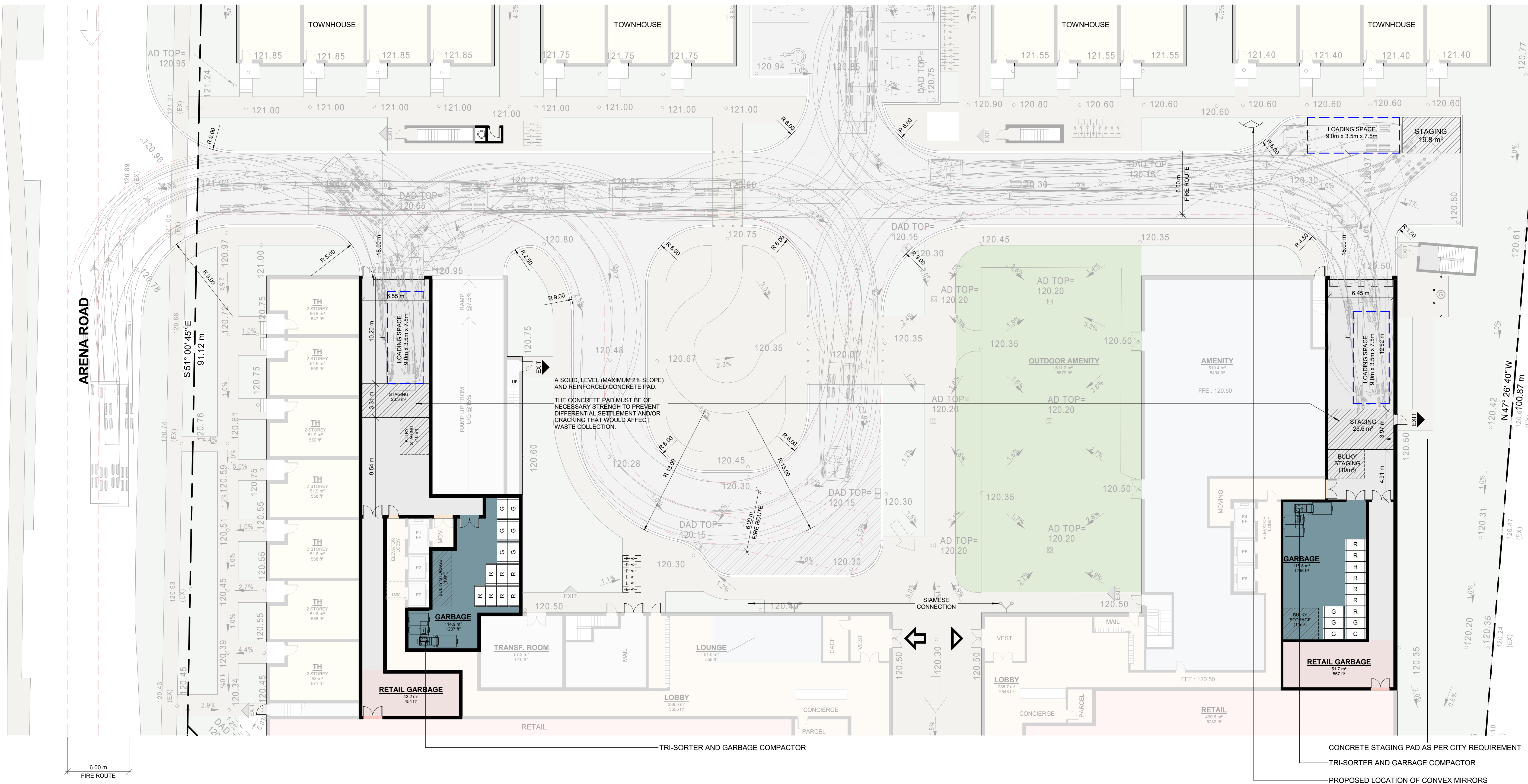

RESIDENTIAL SOLID WASTE MANAGEMENT NOTES:

SOLID WASTE MANAGEMENT REQUIREMENTS AS PER THE PEEL WASTE COLLECTION DESIGN STANDARDS MANUAL:

- * PEEL WASTE MANAGEMENT REQUIRES INTERNAL STORAGE AREAS TO BE LARGE ENOUGH TO CONTAIN ALL THE REQUIRED NUMBER OF FRONT-END GARBAGE BINS, IN ADDITION TO A SPACE (A MINIMUM OF 10 m²) FOR THE STORAGE OF BULKY ITEMS.
- * EACH 3 CUBIC YARD BIN CONTAINING COMPACTED WASTE CAN ACCOMMODATE 54 UNITS. FOR RECYCLABLE MATERIALS, EACH 3 CUBIC YARD BIN CONTAINING NON-COMPACTED WASTE CAN ACCOMMODATE 45 UNITS
- THE TURNING RADIUS FROM THE CENTRE LINE HAS TO BE A MINIMUM OF 13 METRES ON ALL TURNS FOR THE WASTE COLLECTION VEHICLE WITH THE MAXIMUM GRADE CHANGE PERMITTED ALONG THE ACCESS ROUTE BEING 8%. THE COLLECTION AREA IS TO BE DESIGNED SUCH THAT IT WILL CONSIST OF A LEVEL (+/-2%) CONCRETE SURFACE.
- TRAINED ON-SITE PERSONNEL MUST MANEUVER COLLECTION BINS IN FRONT OF COLLECTION VEHICLE DURING COLLECTION DAY.
- TRAINED ON-SITE PERSONNEL MUST ASSIST THE COLLECTION VEHICLE IN REVERSING OUT OF THE LOADING SPACE ON COLLECTION DAY.
- THE FOLLOWING MINIMUM CLEARANCES ARE TO BE PROVIDED FOR THE WASTE COLLECTION VEHICLE:
 - IN THE COLLECTION AREA AN OVERHEAD CLEARANCE OF 7.5 METRES FROM OBSTRUCTIONS SUCH AS BALCONIES, WIRES AND TREES MUST BE PROVIDED.
 - OUTSIDE OF THE COLLECTION AREA AN OVERHEAD CLEARANCE OF 4.4 METRES FROM OBSTRUCTIONS SUCH AS BALCONIES, WIRES AND TREES MUST BE PROVIDED.

RESIDENTIAL WASTE MANAGEMENT CALCULATIONS:

**RESIDENTIAL MIXED-USE BUILDING
WASTE STORAGE ROOM SIZE AND NUMBER OF BINS REQUIRED:**

NUMBER OF UNITS = 593

593/54 = 11
11 SOLID WASTE BINS (3 CU YD) REQUIRED FOR 593 UNITS

10 m² FOR BULKY ITEMS

593/45
14 RECYCLABLE MATERIALS BIN (3 CU YD) REQUIRED FOR 593 UNITS

SOLID WASTE MANAGEMENT AREA PROVIDED :
230.7 m²

STAGING AREA PROVIDED :
68.7 m²

**TOWNHOMES
WASTE STORAGE ROOM SIZE AND NUMBER OF BINS REQUIRED:**

NUMBER OF UNITS = 28

1 SOLID WASTE BINS (3 CU YD) REQUIRED FOR 28 UNITS

1 RECYCLABLE MATERIALS BIN REQUIRED FOR 28 UNITS

4	05-27-2026	OPA & ZBA RESUBMISSION #2	MLE
3	23-07-2025	OPA & ZBA RESUBMISSION	MLE
2	08-09-2024	OPA & ZBA SUBMISSION	MLE
1	08-17-2022	OPA, ZBA & SPA RESUBMISSION	MLE
#	DATE	DESCRIPTION	BY

PROJECT
PROPOSED MIXED-USE DEVELOPMENT
1225 Dundas Street E, Mississauga, ON
(OZ/OPA 22-20 W3)

RESIDENTIAL SOLID WASTE MANAGEMENT

PROJECT NO.	22.117P01
PROJECT DATE	2022-08-07
DRAWN BY	MLE
CHECKED BY	NMC
SCALE	1 : 200

