

EGLINTON AVE W.

MISSISSAUGA ROAD

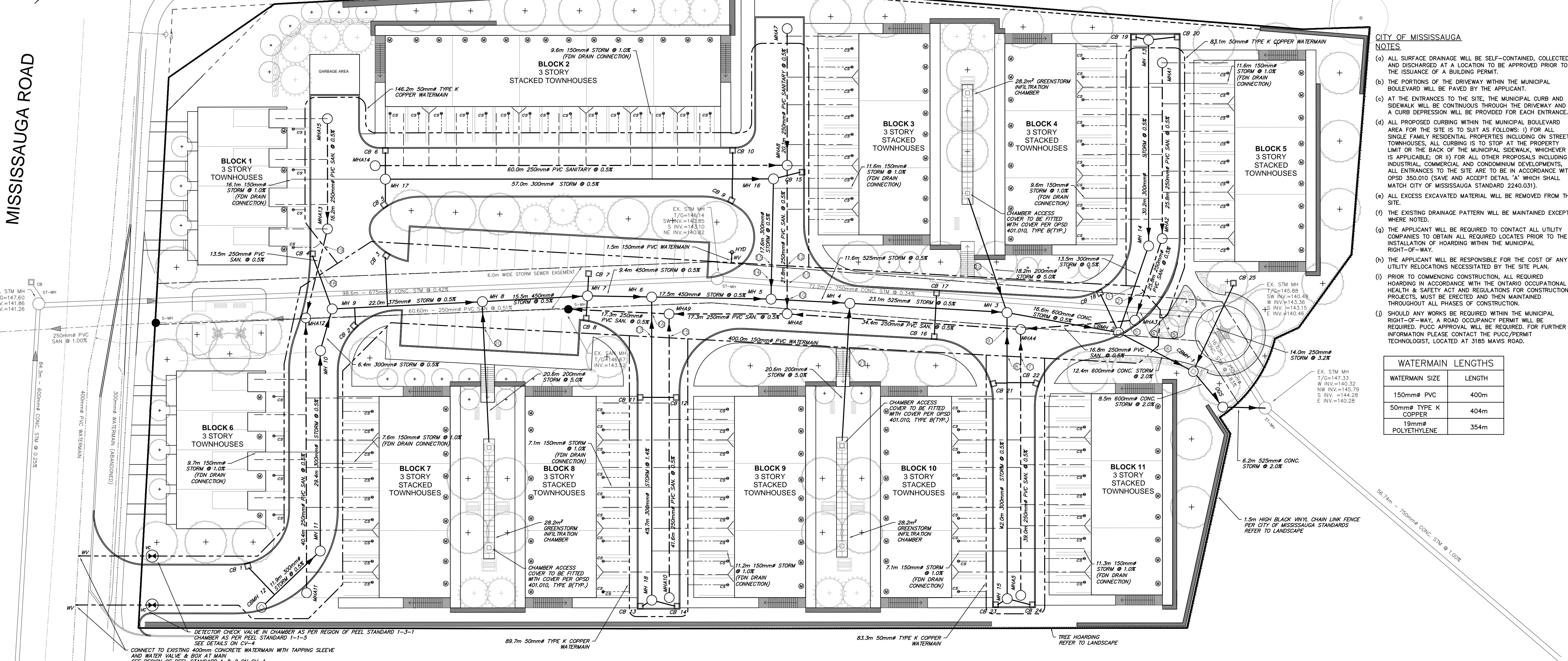
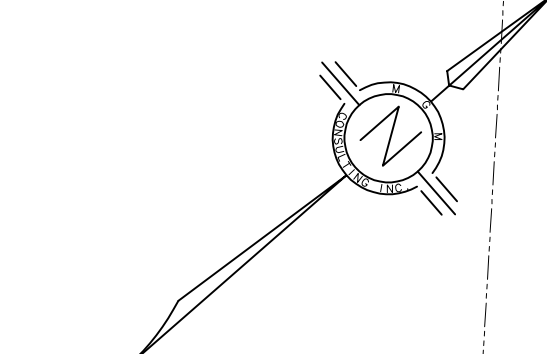

- CITY OF MISSISSAUGA NOTES**
- ALL SURFACE DRAINAGE WILL BE SELF-CONTAINED, COLLECTED AND DISCHARGED AT A LOCATION TO BE APPROVED PRIOR TO THE ISSUANCE OF A BUILDING PERMIT.
 - THE PORTIONS OF THE DRIVEWAY WITHIN THE MUNICIPAL BOULEVARD WILL BE PAVED BY THE APPLICANT.
 - AT THE ENTRANCES TO THE SITE, THE MUNICIPAL CURB AND SIDEWALK WILL BE CONTINUOUS THROUGH THE DRIVEWAY AND A CURB DEPRESSION WILL BE PROVIDED FOR EACH ENTRANCE.
 - ALL PROPOSED CURBING WITHIN THE MUNICIPAL BOULEVARD AREA FOR THE SITE IS TO SUIT AS FOLLOWS: 1) FOR ALL SINGLE FAMILY RESIDENTIAL PROPERTIES INCLUDING ON STREET TOWNHOUSES, ALL CURBING IS TO STOP AT THE PROPERTY LIMIT OR THE BACK OF THE MUNICIPAL SIDEWALK, WHICHEVER IS APPLICABLE; OR 1) FOR ALL OTHER PROPOSALS INCLUDING INDUSTRIAL, COMMERCIAL AND CONDOMINIUM DEVELOPMENTS, ALL ENTRANCES TO THE SITE ARE TO BE IN ACCORDANCE WITH OPSD 350.010 (SAVE AND ACCEPT DETAIL 'A' WHICH SHALL MATCH CITY OF MISSISSAUGA STANDARD 2240.031).
 - ALL EXCESS EXCAVATED MATERIAL WILL BE REMOVED FROM THE SITE.
 - THE EXISTING DRAINAGE PATTERN WILL BE MAINTAINED EXCEPT WHERE NOTED.
 - THE APPLICANT WILL BE REQUIRED TO CONTACT ALL UTILITY COMPANIES TO OBTAIN ALL REQUIRED LOCATES PRIOR TO THE INSTALLATION OF HOARDING WITHIN THE MUNICIPAL RIGHT-OF-WAY.
 - THE APPLICANT WILL BE RESPONSIBLE FOR THE COST OF ANY UTILITY RELOCATIONS NECESSITATED BY THE SITE PLAN.
 - PRIOR TO COMMENCING CONSTRUCTION, ALL REQUIRED HOARDING IN ACCORDANCE WITH THE ONTARIO OCCUPATIONAL HEALTH & SAFETY ACT AND REGULATIONS FOR CONSTRUCTION PROJECTS, MUST BE ERECTED AND THEN MAINTAINED THROUGHOUT ALL PHASES OF CONSTRUCTION.
 - SHOULD ANY WORKS BE REQUIRED WITHIN THE MUNICIPAL RIGHT-OF-WAY, A ROAD OCCUPANCY PERMIT WILL BE REQUIRED. PUCC APPROVAL WILL BE REQUIRED. FOR FURTHER INFORMATION PLEASE CONTACT THE PUCC/PERMIT TECHNOLOGIST, LOCATED AT 3185 MAVIS ROAD.

WATERMAIN LENGTHS	
WATERMAIN SIZE	LENGTH
150mm# PVC	400m
50mm# TYPE K COPPER	404m
19mm# POLYETHYLENE	354m

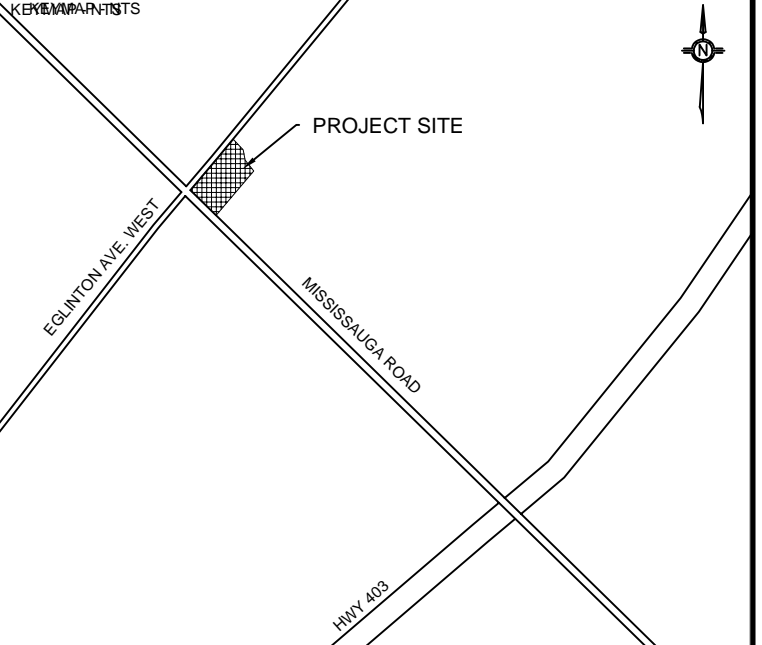

- LEGEND**
- EXISTING HYDRO POLE
 - EXISTING LIGHT STANDARD
 - EXISTING FIRE HYDRANT
 - EXISTING WATER VALVE
 - EXISTING CATCHBASIN
 - EXISTING MANHOLE
 - EXISTING SANITARY SEWER
 - EXISTING WATERMAIN
 - EXISTING STORM SEWER
 - EXISTING OVERHEAD HYDRO
 - PROPOSED CB MANHOLE
 - PROPOSED STORM MANHOLE
 - PROPOSED CATCH BASIN
 - PROPOSED SANITARY MANHOLE
 - PROPOSED TREATMENT UNIT
 - PROPOSED 19mm TYPE K SOFT COPPER WATER SERVICE
 - PROPOSED WATER METER
 - PROPOSED 125mm PVC SANITARY SEWER
 - PROPOSED STORM SEWER
 - PROPOSED SANITARY SEWER
 - PROPOSED WATERMAIN

No.	DATE	DRAWING ISSUE DESCRIPTION
1	2025 06 23	FIRST SUBMISSION
2	2025 10 08	ISSUED FOR REVIEW
3	2025 10 16	SECOND SUBMISSION

STORM STRUCTURE TABLE					
STRUCTURE	STRUCTURE SIZE	STRUCTURE OPSD	FRAME/GRATE OPSD	RIM	INVERT
EX. MH	1800mm	701.012	401.010	147.04	N 140.33 SW 140.28 E 140.28
OGS	1200mm	701.010	400.010	147.00	NE 140.45 W 140.50
CBMH 1	1200mm	701.010	400.010	147.11	E 140.67 NW 144.54 SW 140.72 SW 141.85
CBMH 2	1200mm	701.010	400.010	146.84	NE 142.07 NW 143.27 W 143.27 SW 143.27
MH 3	1200mm	701.010	401.010	147.08	NE 143.34 SE 144.54 NW 144.54 SW 143.42
MH 4	1200mm	701.010	401.010	147.08	NE 143.56 SE 144.76 SW 143.58
MH 5	1200mm	701.010	401.010	147.18	NE 143.64 NW 144.50 SW 143.72
MH 6	1200mm	701.010	401.010	147.00	NE 143.81 SE 144.61 SW 143.84
MH 7	1200mm	701.010	401.010	147.00	NE 143.89 NW 145.09 SE 145.09 SW 143.97
MH 8	1200mm	701.010	401.010	147.00	NE 144.05 SE 145.25 SW 144.08
MH 9	1200mm	701.010	401.010	146.96	NE 144.19 NW 145.19 SE 144.24
MH 10	1200mm	701.010	401.010	146.96	NW 144.27 SW 145.25 SE 144.32
MH 11	1200mm	701.010	401.010	146.92	NW 144.47 SW 144.52
CBMH 12	1200mm	701.010	400.010	146.79	N 144.58

STORM STRUCTURE TABLE					
STRUCTURE	STRUCTURE SIZE	STRUCTURE OPSD	FRAME/GRATE OPSD	RIM	INVERT
MH 13	1200mm	701.010	401.010	146.98	NE 143.55 SW 144.75 SE 144.75
MH 14	1200mm	701.010	401.010	147.05	NW 143.40 SE 143.35
MH 15	1200mm	701.010	401.010	147.03	NW 144.75 S 145.30 E 145.30
MH 16	1200mm	701.010	401.010	146.92	SE 144.44 SW 144.49 NE 144.75 SE 144.49 NW 145.30
MH 17	1200mm	701.010	401.010	146.92	NE 144.84 S 145.45 NE 145.45
MH 18	1200mm	701.010	401.010	147.02	NW 144.84 S 145.45 NE 145.45
CB 1	600x600mm	705.010	400.010	146.79	145.34
CB 2	600x600mm	705.010	400.010	146.82	145.37
CB 3	600x600mm	705.010	400.010	146.79	145.34
CB 4	600x600mm	705.010	400.010	146.79	145.34
CB 5	600x600mm	705.010	400.010	146.88	145.43
CB 6	600x600mm	705.010	400.010	146.88	145.43
CB 7	600x600mm	705.010	400.010	146.80	145.33
CB 8	600x600mm	705.010	400.010	146.80	145.33
CB 9	600x600mm	705.010	400.010	146.86	145.39
CB 10	600x600mm	705.010	400.010	146.86	145.39
CB 11	600x600mm	705.010	400.010	146.96	145.49
CB 12	600x600mm	705.010	400.010	146.96	145.49
CB 13	600x600mm	705.010	400.010	146.96	145.49
CB 14	600x600mm	705.010	400.010	146.96	145.49
CB 15	600x600mm	705.010	400.010	146.87	145.40
CB 16	600x600mm	705.010	400.010	146.90	145.43
CB 17	600x600mm	705.010	400.010	146.80	145.43
CB 18	600x600mm	705.010	400.010	146.84	145.37
CB 19	600x600mm	705.010	400.010	146.93	145.46
CB 20	600x600mm	705.010	400.010	146.93	145.46
CB 21	600x600mm	705.010	400.010	146.89	145.42
CB 22	600x600mm	705.010	400.010	146.89	145.42
CB 23	600x600mm	705.010	400.010	146.97	145.50
CB 24	600x600mm	705.010	400.010	146.97	145.50
CB 25	600x600mm	705.010	400.010	147.21	145.74

NOTE:
ALL CATCH BASINS AND CATCH BASIN MANHOLES LOCATED IN ASPHALT AREAS TO BE FITTED WITH CATCH BASIN SHIELDS

SEWER CROSSING TABLE			
CROSSING #	INV. UPPER	OBV. LOWER	CLEARANCE
1	145.15-WM	143.61-STM	1.54m
2	145.10-WM	144.47-WM	0.63m
3	145.25-WM	141.36-STM	3.89m
4	144.26-SAN	141.37-STM	2.89m
5	143.31-STM	141.37-STM	1.94m
6	145.20-WM	142.72-STM	2.48m
7	145.15-WM	144.02-SAN	1.13m
8	145.15-WM	144.57-STM	0.58m
9	144.55-STM	143.95-SAN	0.60m
10	144.25-SAN	144.08-STM	0.17m
11	144.26-SAN	141.54-STM	2.72m
12	145.28-WM	144.53-SAN	0.75m
13	145.28-WM	144.82-STM	0.46m
14	144.51-STM	141.54-STM	2.97m
15	145.10-WM	144.52-SAN	0.58m
16	144.64-SAN	144.19-STM	0.45m
17	144.64-SAN	141.14-WM	0.50m
18	145.00-WM	143.65-SAN	1.35m
19	145.09-WM	143.68-SAN	1.41m
20	145.45-WM	144.95-WM	0.50m
21	145.09-STM	144.59-WM	0.50m
22	145.31-WM	145.01-STM	0.30m

SANITARY STRUCTURE TABLE					
STRUCTURE	STRUCTURE SIZE	STRUCTURE OPSD	FRAME/GRATE OPSD	RIM	INVERT
MHA1	1200mm	701.010	401.010	147.02	SE 144.50
MHA2	1200mm	701.010	401.010	147.04	NW 144.37 SE 144.32
MHA3	1200mm	701.010	401.010	146.87	NW 144.25 SW 144.20
MHA4	1200mm	701.010	401.010	147.05	NE 144.10 SE 143.80 SW 143.74
MHA5	1200mm	701.010	401.010	147.05	NW 144.00
MHA6	1200mm	701.010	401.010	147.17	NE 143.76 SW 143.74
MHA7	1200mm	701.010	401.010	147.28	SE 144.47
MHA8	1200mm	701.010	401.010	147.17	NW 144.37 SE 144.40 SW 144.35
MHA9	1200mm	701.010	401.010	146.92	NE 143.65 SE 143.68 NW 143.63
MHA10	1200mm	701.010	401.010	146.95	NW 144.50
MHA11	1200mm	701.010	401.010	146.93	NW 143.57
MHA12	1200mm	701.010	401.010	146.90	SE 143.37 NE 143.32 SW 143.32 NW 143.37
MHA13	1200mm	701.010	401.010	146.91	SE 143.44 NW 143.49
MHA14	1200mm	701.010	401.010	146.90	NE 144.66
MHA15	1200mm	701.010	401.010	147.05	SE 143.57

REGIONAL MUNICIPALITY OF PEEL CONSTRUCTION STANDARDS

- ALL MATERIALS AND CONSTRUCTION METHODS MUST CORRESPOND TO THE CURRENT PEEL PUBLIC WORKS STANDARDS AND SPECIFICATIONS.
- WATERMAIN AND / OR WATER SERVICE MATERIALS 100 MM (4") AND LARGER MUST BE DR 18 P.V.C. PIPE MANUFACTURED TO A.W.W.A. SPEC. C900-16 SPEC COMPLETE WITH TRACER WIRE. SIZE 50 MM (2") AND SMALLER MUST BE TYPE K SOFT COPPER PIPE PER A.S.T.M. B88-49 SPECIFICATION.
- WATERMAINS AND / OR WATER SERVICES ARE TO HAVE A MINIMUM COVER OF 1.7 M (5'6") WITH A MINIMUM HORIZONTAL SPACING OF 1.2 M (4") FROM THEMSELVES AND ALL OTHER UTILITIES.
- PROVISIONS FOR FLUSHING WATER LINE PRIOR TO TESTING, ETC. MUST BE PROVIDED WITH AT LEAST A 50 MM (2") OUTLET ON 100 MM (4") AND LARGER LINES. COPPER LINES ARE TO HAVE FLUSHING POINTS AT THE END, THE SAME SIZE AS THE LINE, THEY MUST ALSO BE HOSED OR PIPED TO ALLOW THE WATER TO DRAIN INTO A PARKING LOT OR DOWN A DRAIN. ON FIRE LINES, FLUSHING OUTLET TO BE 100 MM (4") DIAMETER MINIMUM ON A HYDRANT.
- ALL CURB STOPS TO BE 3.0 M (10') OFF THE FACE OF THE BUILDING UNLESS OTHERWISE NOTED.
- HYDRANT AND VALVE SET TO REGION STANDARD 1 - 6 - 1 DIMENSION A AND B, 0.7 M (2') AND 0.9 M (3') AND TO HAVE PUMPER NOZZLE.
- WATERMAINS TO BE INSTALLED TO GRADES AS SHOWN ON APPROVED SITE PLAN. COPY OF GRADE SHEET MUST BE SUPPLIED TO INSPECTOR PRIOR TO COMMENCEMENT OF WORK, WHERE REQUESTED BY INSPECTOR.
- WATERMAINS MUST HAVE A MINIMUM VERTICAL CLEARANCE OF 0.3 M (12") OVER / 0.5 M (20") UNDER SEWERS AND ALL OTHER UTILITIES WHEN CROSSING.
- ALL PROPOSED WATER PIPING MUST BE IN ACCORDANCE WITH EXISTING LINES IN ORDER TO ALLOW INDEPENDENT PRESSURE TESTING AND CHLORINATING FROM EXISTING SYSTEMS.
- ALL LIVE TAPPING AND OPERATION OF REGION WATER VALVES SHALL BE ARRANGED THROUGH THE REGIONAL INSPECTOR ASSIGNED OR BY CONTACTING THE OPERATIONS AND MAINTENANCE DIVISION.
- LOCATION OF ALL EXISTING UTILITIES IN THE FIELD TO BE ESTABLISHED BY THE CONTRACTOR. THE CONTRACTOR(S) SHALL BE SOLELY RESPONSIBLE FOR LOCATES, EXPOSING, SUPPORTING AND PROTECTING OF ALL UNDERGROUND AND OVERHEAD UTILITIES AND STRUCTURES EXISTING AT THE TIME OF CONSTRUCTION IN THE AREA OF THEIR WORK WHETHER SHOWN ON THE PLANS OR NOT AND FOR ALL REPAIRS AND CONSEQUENCES RESULTING FROM DAMAGE TO SAME.
- THE CONTRACTOR(S) SHALL BE SOLELY RESPONSIBLE TO GIVE 72 HOURS WRITTEN NOTICE TO THE UTILITIES PRIOR TO CROSSING SUCH UTILITIES, FOR THE PURPOSE OF INSPECTION BY THE CONCERNED UTILITY. THIS INSPECTION WILL BE FOR THE DURATION OF THE CONSTRUCTION, WITH THE CONTRACTOR RESPONSIBLE FOR ALL COSTS ARISING FROM SUCH INSPECTION.
- ALL PROPOSED WATER PIPING MUST BE ISOLATED THROUGH A TEMPORARY CONNECTION THAT SHALL INCLUDE AN APPROPRIATE CROSS-CONNECTION CONTROL DEVICE, CONSISTENT WITH THE DEGREE OF HAZARD, FOR BACKFLOW PREVENTION OF THE ACTIVE DISTRIBUTION SYSTEM, CONFORMING TO REGION OF PEEL STANDARDS 1-7-7 OR 1-7-8.

- NOTE:**
- CONTRACTOR TO CONTACT MCM CONSULTING INC. IMMEDIATELY SHOULD THERE BE ANY CONFLICTS BETWEEN EXISTING CONDITIONS AND PROPOSED GRADING AND/OR SERVING DESIGN, OR CONFLICTS IN CONSTRUCTING THE WORK AS PER THE INTENT OF THE APPROVED DESIGN PRIOR TO CONSTRUCTION.
- NOTE:**
- ALL WORK TO CONFORM TO THE LATEST MUNICIPAL STANDARDS AND SPECIFICATIONS AS WELL AS THE LATEST ADOPTED ONTARIO PROVINCIAL STANDARD DRAWINGS AND SPECIFICATIONS.
 - ALL DISTURBED AREAS TO BE RESTORED TO ORIGINAL CONDITION OR BETTER TO SATISFACTION OF THE MUNICIPALITY AND MGM CONSULTING INC.
 - CONTRACTOR TO LOCATE AND PROTECT ALL EXISTING SERVICES AND UTILITIES PRIOR TO AND DURING CONSTRUCTION.
 - CONTRACTOR TO LOCATE AND CONFIRM ALL EXISTING UTILITIES AND SERVICE INFORMATION PRIOR TO CONSTRUCTION.
 - CONTRACTOR TO ENSURE ADEQUATE CLEARANCE FROM ALL EXISTING SERVICES AND UTILITIES.
 - CONTRACTOR TO CONFIRM ALL EXISTING INVERTS PRIOR TO INTERNAL SERVING.
 - CONTRACTOR TO CONFIRM THE PAVEMENT STRUCTURE THICKNESS" BASED ON THE GEOTECHNICAL REPORT.

CONSTRUCTION NOTES:

- ALL SITE GRADING SHALL BE CARRIED OUT IN ACCORDANCE WITH OPSD 206.
- ALL MATERIALS ENCOUNTERED DURING EXCAVATION THAT ARE NOT SUITABLE FOR USE AS EARTH FILL ARE TO BE REMOVED AND DISPOSED OFF SITE, IN ACCORDANCE WITH CURRENT REGULATIONS.
- ALL GRANULAR MATERIALS SHALL CONFORM TO OPSD 1010 AND BE COMPACTED TO 100% STANDARD PROCTOR DENSITY.
- ALL ASPHALT MATERIALS SHALL BE IN ACCORDANCE WITH OPSD 1003, 1101, 1150 AND BE PLACED IN ACCORDANCE WITH OPSD 310.
- ALL CONCRETE FOR SIDEWALKS SHALL BE IN ACCORDANCE WITH OPSD 351 AND ALL CONCRETE FOR CURBING SHALL BE IN ACCORDANCE WITH OPSD 353. CONCRETE BARRIER CURB SHALL BE CONSTRUCTED AS PER OPSD 600.110. CONCRETE CURB AND GUTTER SHALL BE CONSTRUCTED AS PER OPSD 600.040.
- CONCRETE CURBS ON THE INSIDE OF THE SITE TO BE CONSTRUCTED AS PER OPSD 600.110.
- FOR EROSION AND SEDIMENT CONTROLS, REFER TO MGM DRAWING CV-1.
- ALL DISTURBED GRASSED AREAS ARE TO BE RESTORED WITH 150mm DEPTH OF TOPSOIL AND SOO.
- THE CONTRACT CONSISTS OF ALL WORK WITHIN THE PROPERTY LINE AND ANY WORK SPECIFICALLY NOTED OUTSIDE OF THE PROPERTY LINE.
- ALL AREAS AFFECTED BY THE PROPOSED WORKS TO BE RESTORED TO ORIGINAL CONDITION OR BETTER.

LEGAL AND TOPOGRAPHICAL SURVEY PROVIDED BY:
SCHAEFFER DZALDOV BENNETT LTD.
JOB NO. 15-155-01, DATED JULY 21, 2015.

SITE BENCHMARK:
ELEVATIONS SHOWN HEREON ARE REFERRED TO CITY OF MISSISSAUGA BENCHMARK NO. 970, HAVING A PUBLISHED ELEVATION OF 148.702 METRES.

CONSULTANT:
KINGRIDGE DEVELOPMENTS
CONSULTING ENGINEER
OCT. 16/2025
PROVINCE OF ONTARIO

MGM CONSULTING INC.
Consulting Engineering & Project Management
555 Industrial Drive
Suite 201
Mississauga, Ontario
L4T 1G1
Tel: (905) 887-8878
Fax: (905) 875-1238
Email: mcm@mcmgroup.com
www.mcmgroup.com

CLIENT:
THORNY BRAE TOWNHOUSE DEVELOPMENT
1775 THORNY BRAE PLACE MISSISSAUGA ONTARIO

DRAWING:
SERVICING PLAN

DRAWN BY: BN	CHECKED BY: MLS	JOB CAPTAIN: JB
SCALE: 1:300	PROJECT NO.: 2025-004	SHEET NO.: CV-3
CURRENT ISSUE: 3	CURRENT REV: 2	