

ELEVATIONS ARE REFERRED TO THE CITY OF MISSISSAUGA BENCHMARK NO. 650179, ON ONR BRIDGE OVER HURON/ONTARIO STREET, TABLET IN TOP OF SIDEWALK ON NORTH-EAST SIDE OF RAILWAY, 1N FORM THE NORTH-EAST END, 0.6m, NORTH-WEST OF EDGE OF CURB, HAVING A PUBLISHED ELEVATION OF 85.641 METRES.

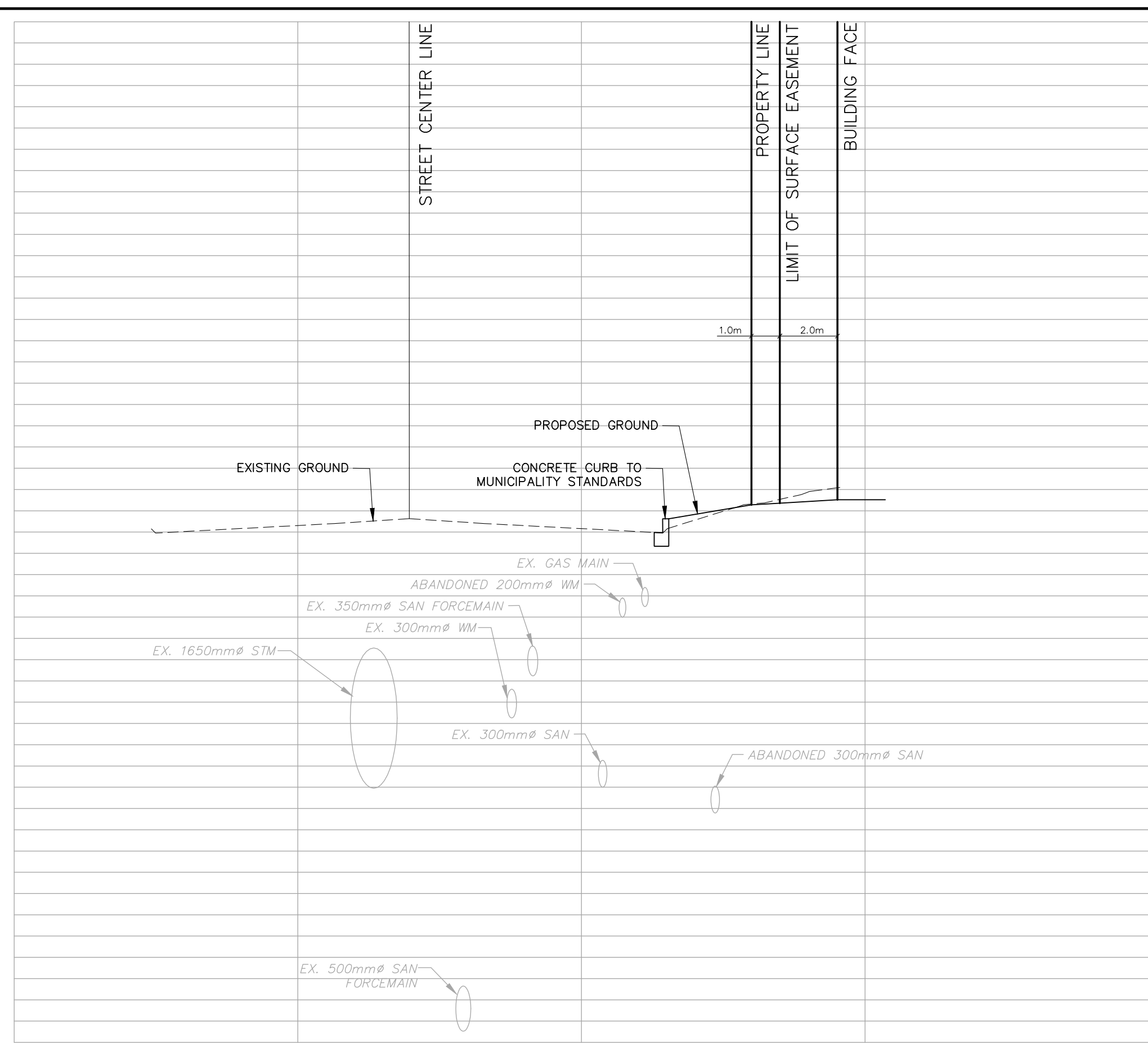

SECTION A-A

SCALE: HORZ.=1:150
VERT.=1:50

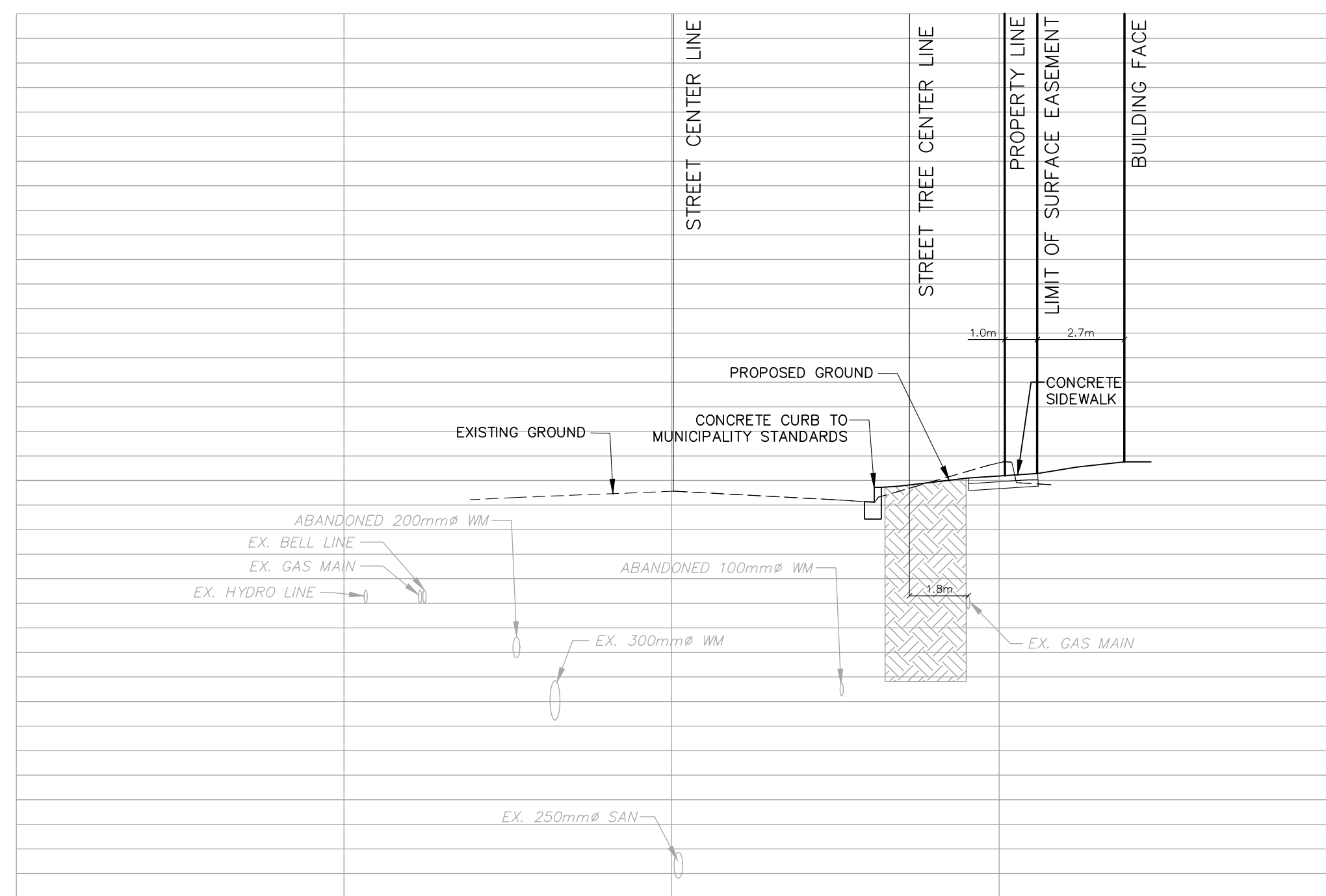

SECTION B-B

SCALE: HORZ.=1:150
VERT.=1:50

CLIENT BLACKTUSK GROUP 800-365 Bay Street, Toronto, ON M5H 2V1	KEY PLAN 	ISSUES	SEAL 	PROJECT 128 Lakeshore Road East Mississauga, ON	ENGINEERING + MANAGEMENT P. 402, 100, 2000 800 CHATEL WOODS COURT, SUITE 204 MISSISSAUGA, ON L4X 1G8 HUSSON.CA		
		<table border="1"><thead><tr><th>No.</th><th>DESCRIPTION</th><th>DATE</th></tr></thead><tbody><tr><td>01</td><td>ZBA SUBMISSION 1</td><td>2021/12/17</td></tr></tbody></table>				No.	DESCRIPTION
No.	DESCRIPTION	DATE					
01	ZBA SUBMISSION 1	2021/12/17					
		PROJECT NO: 211246	SHEET NUMBER C-102				
		DRAWN BY: WZ	CHECKED BY: DWS	ISSUE			
		SCALE: 1:150	APPROVED BY: DWS				