

**PETROFF**  
 PETROFF PARTNERSHIP ARCHITECTS  
 10 AVIVA WAY  
 SUITE 400  
 MARKHAM, ONTARIO  
 L6G 0G1  
 T 905.470.7000  
 F 905.470.2500  
 www.petroff.com

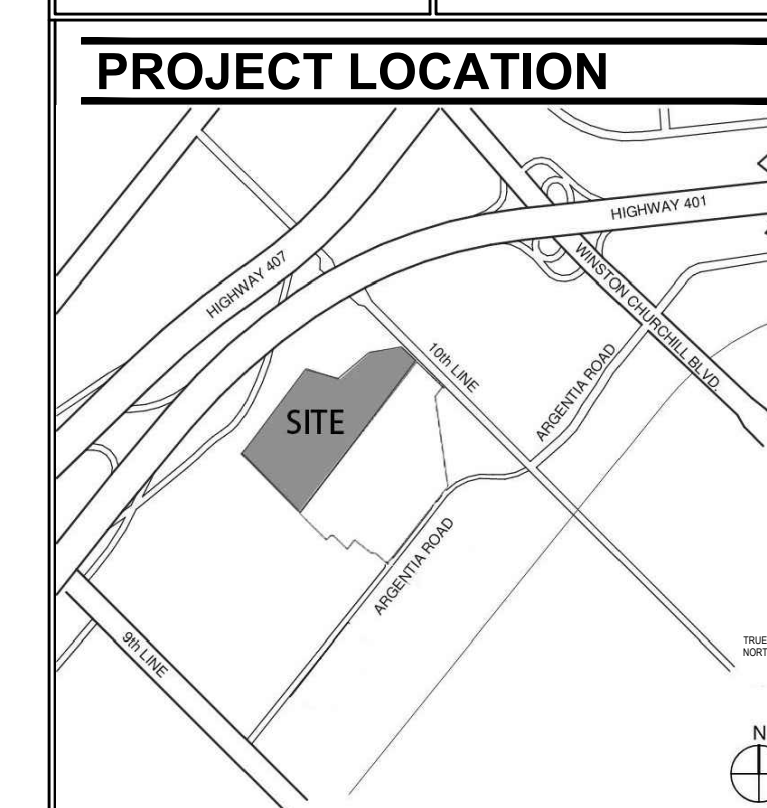

**LEGAL DESCRIPTION**

FOR LEGAL SURVEY INFORMATION REFER TO:  
 PART OF LOT 14  
 CONCESSION 10, NEW SURVEY  
 GEOGRAPHIC TOWNSHIP OF TRAFALGAR  
 CITY OF MISSISSAUGA  
 REGIONAL MUNICIPALITY OF PEELE  
 PREPARED BY GENESIS LAND SURVEYING INC.,  
 10 FOUR SEASONS PLACE, 10TH FLOOR,  
 TORONTO, ON M9B 6H7 DATED OCTOBER 16, 2024.

SITE SPECIFIC ZONING TO BE VERIFIED UPON  
 CONSULTATION WITH CITY OF MISSISSAUGA. LAYOUT  
 IS SUBJECT TO IMPLEMENTATION OF ENVIRONMENTAL,  
 STORM WATER MANAGEMENT, ETC. REQUIREMENTS  
 UPON CONSULTATION WITH AUTHORITIES HAVING  
 JURISDICTION

**ADDITIONAL SITE WORKS**

NOTE:  
 FOR LANDSCAPE AND SITE FURNITURE INFORMATION,  
 REFER TO DRAWINGS BY MHBC LANDSCAPE.

FOR GRADING AND SERVICING INFORMATION, REFER  
 TO DRAWINGS BY MTE CONSULTANTS.

FOR SITE PHOTOMETRIC AND ELECTRICAL  
 INFORMATION, REFER TO DRAWINGS  
 BY HAMMERSCHLAG & JOFFE.

FOR TRAFFIC SIGNAGE AND DESIGN REFER TO  
 DRAWINGS BY TYLIN.

NOTE:  
 FIRE ACCESS ROUTE TO BE DESIGNED TO SUPPORT  
 A LOAD OF NOT LESS THAN 11,363 KG PER AXLE AND  
 HAVE A CHANGE IN GRADIENT OF NOT MORE THAN 1  
 IN 12.5 OVER A MINIMUM DISTANCE OF 15M. ROUTE  
 TO BE DESIGNATED AS PER BYLAW 1036-81

**KEY PLAN**

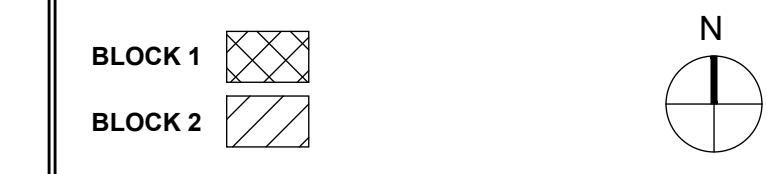
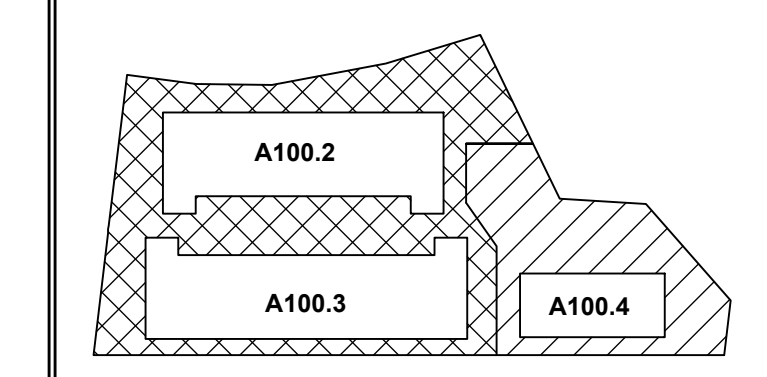

REV #	DATE	REVISION TITLE
1	AUG 15, 2025	ISSUED FOR SPA
2	MAR 4, 2026	ISSUED FOR SPA

PROJECT NO: 25026.00  
 DRAWN BY: TY  
 CHECKED BY: RCB

00 TENTH LINE WEST,  
 MISSISSAUGA, ON  
 TOR000394  
 INDUSTRIAL DEVELOPMENT



Prologis Inc. (Canada)  
 185 The West Mall, Suite 700, Toronto  
 647-258-2600  
 Tony.Nguyen: tnguyen4@prologis.com  
 https://www.prologis.com

SHEET TITLE:  
**OVERALL FLOOR PLAN  
 LEVEL 2 DATA CENTRE**

SEAL:

SHEET NO. **A.220**

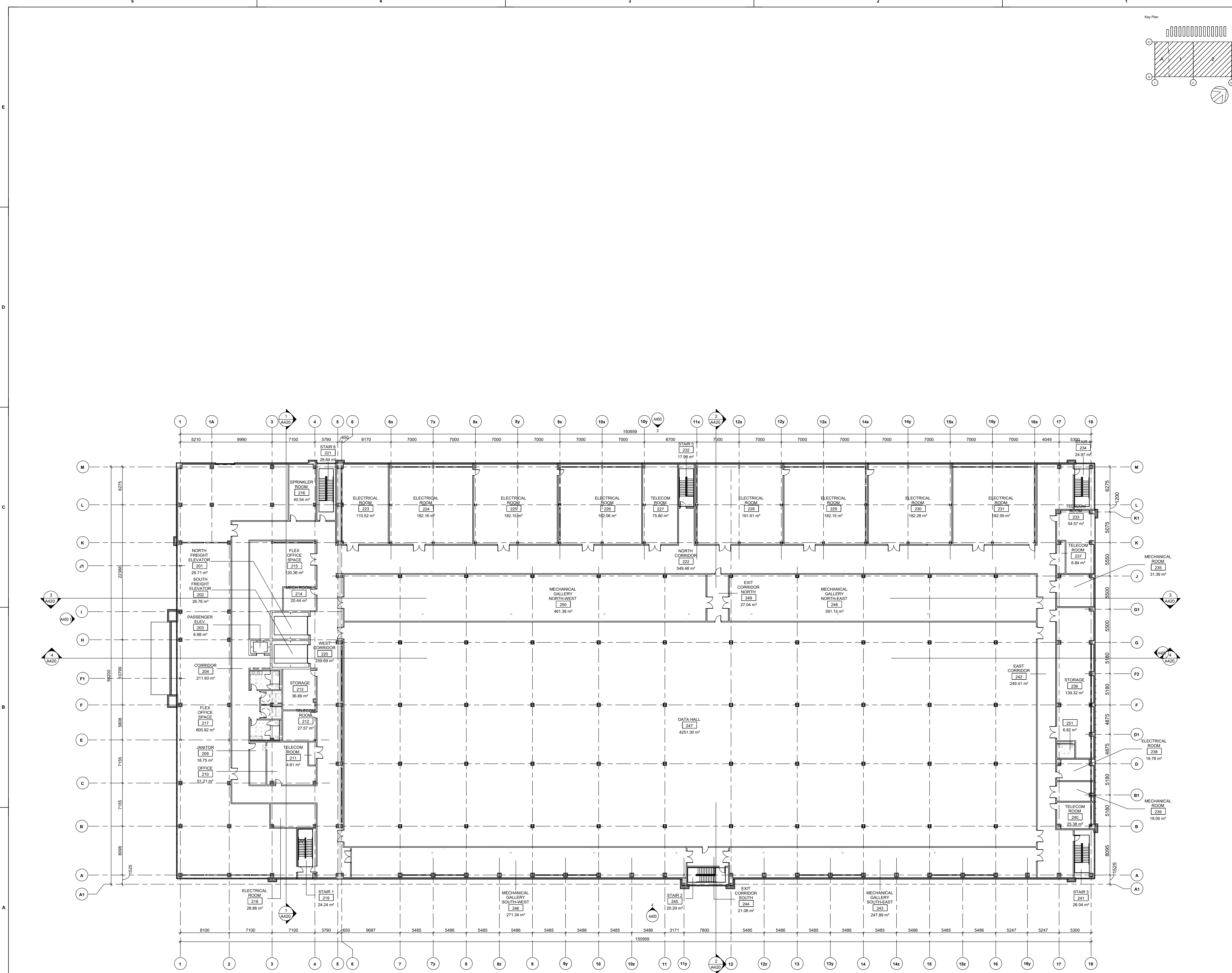

**1 OVERALL PLAN - LEVEL 02**  
 A220 1:200