

NOTES TO CONTRACTOR:

- INSPECTION:**
CONTRACTOR IS RESPONSIBLE FOR CONTACTING ENGINEER & CITY INSPECTION STAFF 48 HRS PRIOR TO COMMENCING WORK TO ARRANGE FOR INSPECTION & OFF-SITE WORKS. ENGINEER TO DETERMINE SCOPE OF INSPECTION AND TESTING REQUIRED FOR CERTIFICATION OF UNDERGROUND SERVICE INSTALLATION AS MANDATED BY ONTARIO BUILDING CODE PART 3 SECTION 2.2. GENERAL REVIEW FAILURE TO NOTIFY ENGINEER WILL RESULT IN EXTENSIVE POST CONSTRUCTION INSPECTION AT CONTRACTOR'S EXPENSE.
- CONFIRMATION OF EXISTING INVERTS:**
72 HOURS PRIOR TO THE START OF CONSTRUCTION, THE CONTRACTOR IS TO LOCATE, COPE AND VERIFY INVERTS OF EXISTING SEWERS AT CONNECTION POINTS AND REPORT FINDINGS TO MTE. SHOULD THE CONTRACTOR PROCEED WITHOUT COMPLETING THESE LOCATES EXTRA COSTS RESULTING FROM DELAYS AND STANDBY TIME WILL NOT BE CONSIDERED.

NOTE:
REFER TO SITEPLAN/LANDSCAPE PLAN FOR ALL SURFACE TYPES AND DETAILS

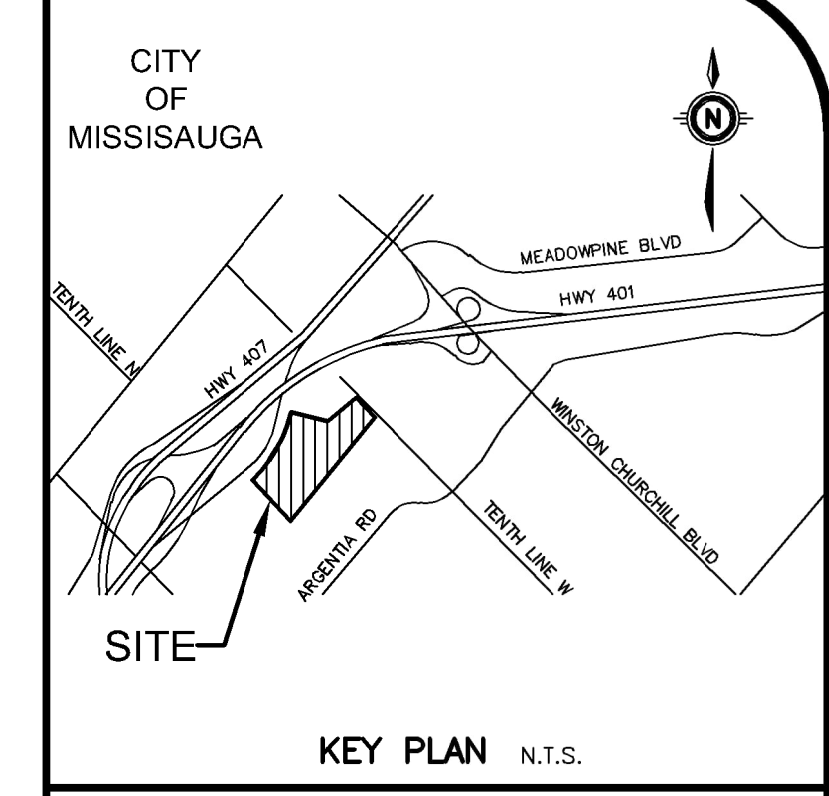

GEODETIC BENCHMARK ELEV. = 208.076m
ELEVATIONS ARE REFERRED TO THE CITY OF MISSISSAUGA BENCHMARK No. 1045, LOCATED AT THE BASE OF A 750mm CONCRETE TRAFFIC POLE AT THE SOUTH-WEST CORNER OF ARGENTA ROAD AND PLAZA ENTRANCE (EASTWARD), HAVING A PUBLISHED ELEVATION OF 208.076 METRES.

SITE BENCHMARK ELEV. = m
SEE GEODETIC BENCHMARK

NOTE TO CONTRACTOR:
DO NOT SCALE DRAWINGS.
CONTRACTORS MUST CHECK AND VERIFY ALL DIMENSIONS AND REPORT ANY DISCREPANCIES TO THE ENGINEER BEFORE PROCEEDING WITH THE WORK.
ALL DRAWINGS REMAIN THE PROPERTY OF THE ENGINEER AND SHALL NOT BE REPRODUCED OR REUSED WITHOUT THE ENGINEER'S WRITTEN PERMISSION.

THE OWNER/ARCHITECT/CONTRACTOR IS ADVISED THAT M.T.E. CONSULTANTS INC. CANNOT CERTIFY ANY COMPONENT OF THE SITE WORKS NOT INSPECTED DURING CONSTRUCTION. IT IS THE RESPONSIBILITY OF THE GENERAL CONTRACTOR TO NOTIFY M.T.E. CONSULTANTS INC. PRIOR TO COMMENCEMENT OF CONSTRUCTION TO ARRANGE FOR INSPECTION.

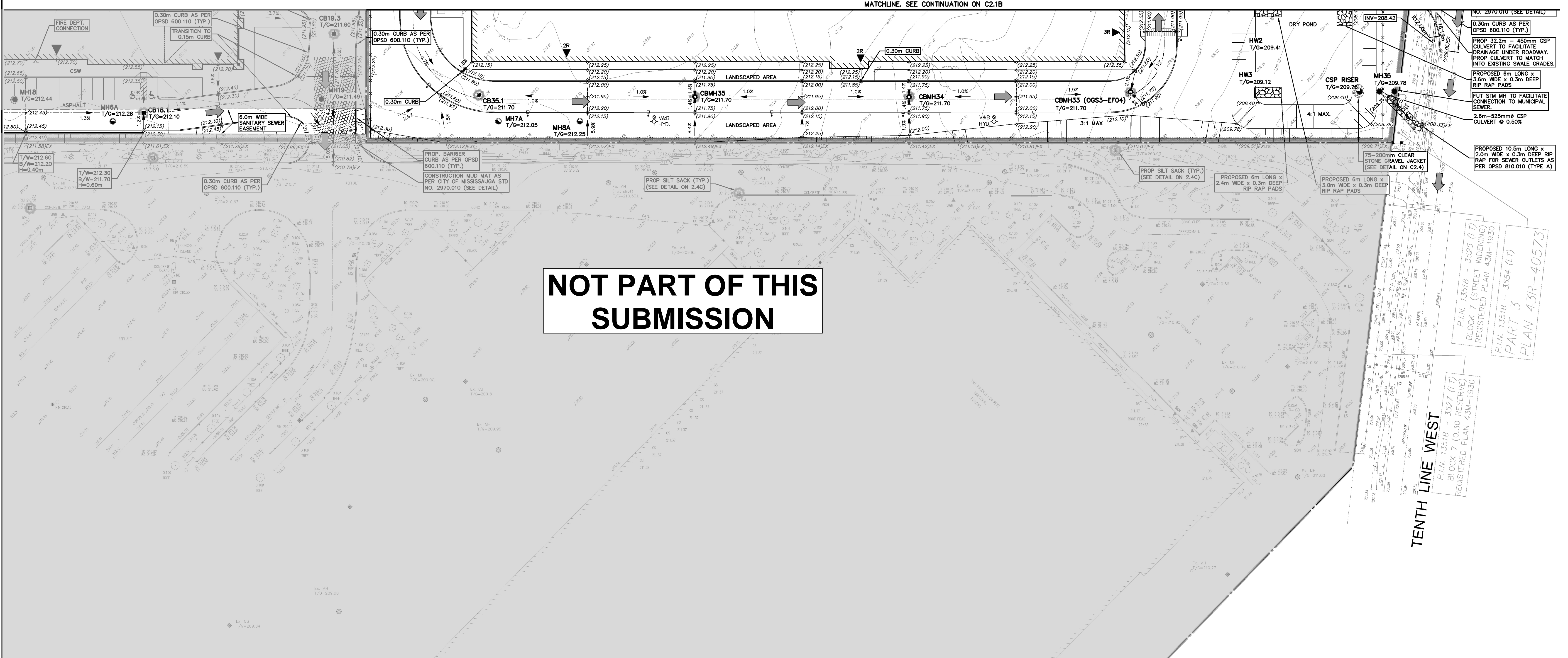

NOT PART OF THIS SUBMISSION

GRADING CERTIFICATION NOTE:
I HAVE REVIEWED THE PLANS FOR THE CONSTRUCTION OF THE PROPOSED INDUSTRIAL DEVELOPMENT LOCATED AT 7564 TENTH LINE WEST IN MISSISSAUGA, ONTARIO AND HAVE PREPARED THIS PLAN TO INDICATE THE COMPATIBILITY OF THE PROPOSAL TO EXISTING ADJACENT PROPERTIES AND MUNICIPAL SERVICES. IT IS MY BELIEF THAT ADHERENCE TO THE PROPOSED GRADES AS SHOWN WILL PRODUCE ADEQUATE SURFACE DRAINAGE AND PROPER FACILITY OF THE MUNICIPAL SERVICES WITHOUT ANY DETRIMENTAL EFFECT TO THE EXISTING DRAINAGE PATTERNS OR ADJACENT PROPERTIES.

- CITY OF MISSISSAUGA STANDARD GRADING NOTES**
 - ALL SURFACE DRAINAGE WILL BE SELF-CONTAINED, COLLECTED & DISCHARGED AT A LOCATION TO BE APPROVED PRIOR TO THE ISSUANCE OF A BUILDING PERMIT.
 - THE PORTIONS OF THE DRIVEWAY WITHIN THE MUNICIPAL BOULEVARD WILL BE PAVED BY THE APPLICANT.
 - AT THE ENTRANCES TO THE SITE, THE MUNICIPAL CURB AND SIDEWALK WILL BE CONTINUOUS THROUGH THE DRIVEWAY AND A CURB DEPRESSION WILL BE PROVIDED FOR EACH ENTRANCE.
 - ALL PROPOSED CURBING WITHIN THE MUNICIPAL BOULEVARD AREA FOR THE SITE IS TO BE AS FOLLOWS:
 - FOR ALL SINGLE FAMILY RESIDENTIAL PROPERTIES INCLUDING ON STREET TOWNHOUSES, ALL CURBING IS TO STOP AT PROPERTY LIMIT OR THE BACK OF THE MUNICIPAL SIDEWALK, WHICHEVER IS APPLICABLE.
 - FOR ALL OTHER PROPOSALS INCLUDING INDUSTRIAL, COMMERCIAL AND CONDOMINIUM DEVELOPMENTS, ALL ENTRANCES TO THE SITE ARE TO BE IN ACCORDANCE WITH OPSD 350.010 (SAVE AND ACCEPT DETAIL 2) WHICH SHALL MATCH CITY OF MISSISSAUGA STANDARD 244(0.13). CITY OF MISSISSAUGA STANDARD SHOULD BE FIRST AS THE ACCESS REQUIREMENT.
 - ALL EXCESS EXCAVATED MATERIAL WILL BE REMOVED FROM THE SITE.
 - THE EXISTING DRAINAGE PATTERN WILL BE MAINTAINED EXCEPT WHERE NOTED.
 - THE APPLICANT WILL BE REQUIRED TO CONTACT ALL UTILITY COMPANIES TO OBTAIN ALL REQUIRED LOCATES PRIOR TO THE INSTALLATION OF HOARDING WITHIN THE MUNICIPAL RIGHT-OF-WAY.
 - THE APPLICANT WILL BE RESPONSIBLE FOR THE COST OF ANY UTILITY RELOCATIONS NECESSITATED BY THE SITE PLAN.
 - PRIOR TO COMMENCING CONSTRUCTION, ALL REQUIRED HOARDING IN ACCORDANCE WITH ONTARIO OCCUPATIONAL HEALTH AND SAFETY ACT AND REGULATIONS FOR CONSTRUCTION PROJECTS, MUST BE ERECTED AND THEN MAINTAINED THROUGHOUT ALL PHASES OF CONSTRUCTION.
 - SHOULD ANY WORKS BE REQUIRED WITHIN THE MUNICIPAL RIGHT-OF-WAY, A ROAD OCCUPANCY PERMIT WILL BE REQUIRED. PUCC APPROVAL WILL BE REQUIRED FOR FURTHER INFORMATION, PLEASE CONTACT THE PUCC PERMIT TECHNOLOGIST, AT 905-615-4950 OR BY EMAIL AT INCDISTRIBUTION@MISSISSAUGA.CA OR VISIT THE WEBSITE LINK BELOW: [HTTPS://WWW.MISSISSAUGA.CA/SERVICES-AND-PROGRAMS/TRANSPORTATION-AND-STREETS/ROADS-AND-SIDEWALKS/APPLY-FOR-A-ROAD-OCCUPANCY-PERMIT/](https://www.mississauga.ca/services-and-programs/transportation-and-streets/roads-and-sidewalks/apply-for-a-road-occupancy-permit/)

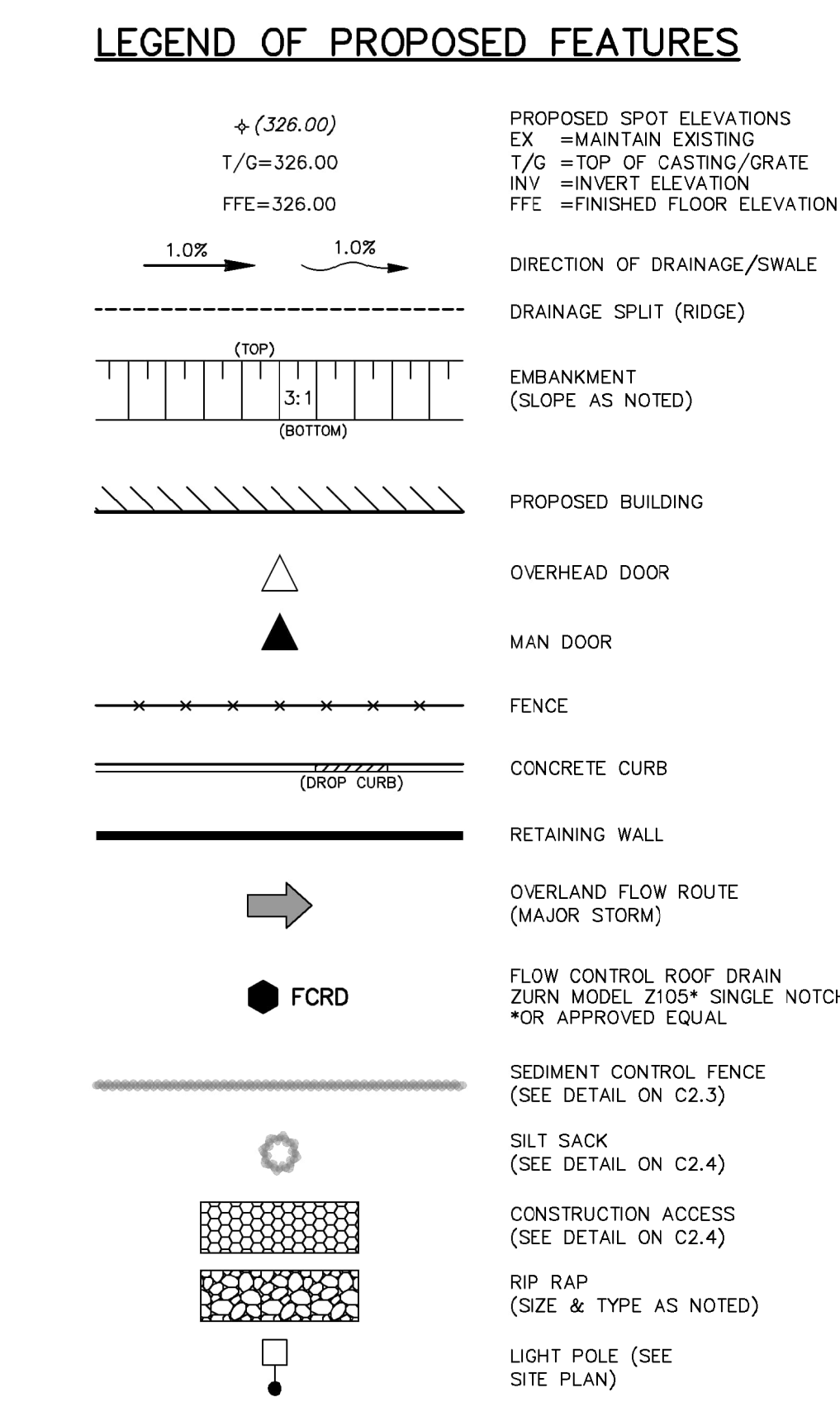
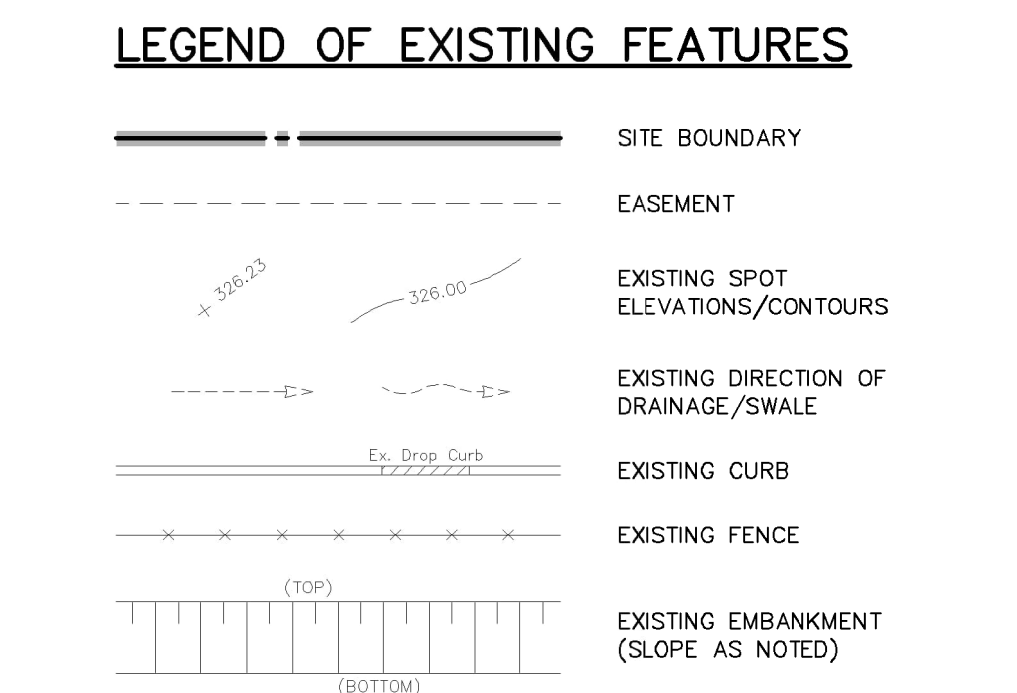

8.		
7.		
6.		
5.	ISSUED FOR SPN RE-SUBMISSION	802 2025-03-04
4.	RE-ISSUED FOR GRADING PERMIT	802 2025-02-08
3.	RE-ISSUED FOR GRADING PERMIT	802 2025-10-28
2.	ISSUED FOR SPN	802 2025-08-08
1.	ISSUED FOR GRADING PERMIT	802 2025-03-30

MTE
Engineers, Scientists, Surveyors
905-639-2552

2026-03-04
R. ZHOU
1006/167
PROFESSIONAL ENGINEER
PROVINCE OF ONTARIO

NOT FOR CONSTRUCTION

PETROFF PARTNERSHIP ARCHITECTS
CLIENT: 10 ALVIA WAY SUITE 400 MARKHAM

PROLOGIS MEADOWVALE DISTRIBUTION CENTRE
PROJECT: 7564 TENTH LINE WEST MISSISSAUGA

SITE GRADING PLAN 3
DRAWING

Project Manager	R. ZHOU	Job No.	60549_001
Design By	NZR	Checked By	RDZ
Drawn By	AXG	Checked By	NZR
Surveyed By	Others	Drawing No.	
Date	Jun. 11 / 25	C2.1C	
Scale	1:400	Sheet	5 of 9