

TREE INVENTORY NOTES

Tree #	Common Name	Botanical Name	DBH (CM)	Condition	Comments	Recommendation
541	Red Oak	Quercus rubra	12	F	Minor deadwood in canopy	Retain
542	Red Oak	Quercus rubra	14	F	Minor deadwood in canopy	Retain
543	Red Oak	Quercus rubra	14	F	Moderate deadwood in canopy	Remove due to construction
544	Red Oak	Quercus rubra	16	F	Minor to moderate deadwood in canopy	Remove due to construction
545	Ash Sp.	Fraxinus Sp.	14	F		Remove due to construction
546	Ash Sp.	Fraxinus Sp.	6	F	2 stem at base	Remove due to construction
547	Black Walnut	Juglans nigra	40	F	Minor deadwood in canopy	Retain
548	Manitoba Maple	Acer negundo	64	F	Minor deadwood in canopy	Retain
549	Common Buckthorn	Rhamnus cathartica	26	F	Minor to moderate deadwood in canopy	Remove due to construction
550	Common Buckthorn	Rhamnus cathartica	27	F	Multi-stem at base, minor to moderate deadwood throughout	Remove due to construction
551	Common Buckthorn	Rhamnus cathartica	15	F	Multi-stem at 0.7 metres, minor deadwood in canopy	Remove due to construction
552	Common Buckthorn	Rhamnus cathartica	27	F	Multi-stem at base, minor deadwood in canopy	Remove due to construction
553	Common Buckthorn	Rhamnus cathartica	21	F	Multi-stem at base, minor to moderate deadwood in canopy	Remove due to construction
554	Common Buckthorn	Rhamnus cathartica	20	F	Minor deadwood in canopy	Remove due to construction
555	Common Buckthorn	Rhamnus cathartica	21	F	Minor deadwood in canopy	Remove due to construction
556	Flowering Crabapple Tree	Malus Sp.	26	F	Mild lean, bow at top, minor deadwood in canopy	Remove due to construction
557	Flowering Crabapple Tree	Malus Sp.	31	F/P	Multiple bows throughout, contorted form, moderate deadwood in canopy	Remove due to construction
558	Flowering Crabapple Tree	Malus Sp.	47	F	Mild lean, minor deadwood in canopy	Remove due to construction
559	Shagbark Hickory	Carya ovata	34	F	Minor deadwood in canopy	Remove due to construction
560	Shagbark Hickory	Carya ovata	45	F/P	Moderate deadwood in canopy	Remove due to construction
561	Shagbark Hickory	Carya ovata	22	F	Minor deadwood throughout	Remove due to construction
562	Shagbark Hickory	Carya ovata	47	F	Moderate deadwood in canopy	Remove due to construction
563	Basswood	Tilia americana	15	F		Remove due to construction
564	Common Buckthorn	Rhamnus cathartica	19	F	3 stem at base, minor deadwood in canopy	Remove due to construction
565	Common Buckthorn	Rhamnus cathartica	21	F	Minor to moderate deadwood in canopy	Remove due to construction
566	Common Buckthorn	Rhamnus cathartica	22	F	Multi-stem at base, minor to moderate deadwood in canopy	Remove due to construction
567	Shagbark Hickory	Carya ovata	22	F	Minor deadwood in canopy	Remove due to construction
568	American Elm	Ulmus americana	18	F		Remove due to construction
569	Common Buckthorn	Rhamnus cathartica	14	F	2 stem at base, minor deadwood in canopy	Remove due to construction
570	Shagbark Hickory	Carya ovata	59	F		Remove due to construction
571	Shagbark Hickory	Carya ovata	47	F	Mild lean	Remove due to construction
572	Shagbark Hickory	Carya ovata	22	F	Mild lean, minor deadwood throughout	Remove due to construction
573	Shagbark Hickory	Carya ovata	38	F	2 stem at 1.1 metres	Remove due to construction
574	Shagbark Hickory	Carya ovata	47	F		Remove due to construction
575	Shagbark Hickory	Carya ovata	48	F		Remove due to construction
576	Shagbark Hickory	Carya ovata	50	F	Minor deadwood in canopy	Remove due to construction
577	Burr Oak	Quercus macrocarpa	63	F	Minor deadwood throughout	Remove due to construction
578	Basswood	Tilia americana	23	F	Mild to moderate lean, 2 stem at 0.3 metres	Remove due to construction
579	Basswood	Tilia americana	18	F		Remove due to construction
580	Burr Oak	Quercus macrocarpa	19	F		Remove due to construction
581	Shagbark Hickory	Carya ovata	19	F		Remove due to construction
582	Shagbark Hickory	Carya ovata	31	F		Remove due to construction
583	Shagbark Hickory	Carya ovata	46	F		Remove due to construction
584	Shagbark Hickory	Carya ovata	43	F		Remove due to construction
585	Shagbark Hickory	Carya ovata	34	F	Minor deadwood throughout	Remove due to construction
586	Shagbark Hickory	Carya ovata	52	F	Minor deadwood throughout, 3 stem at base	Remove due to construction
587	Shagbark Hickory	Carya ovata	67	F	Minor deadwood throughout	Remove due to construction
588	Shagbark Hickory	Carya ovata	43	F/P	Minor deadwood throughout, previous limb failures evident, 2 stem at 1.0 metre	Retain (injure)
589	Basswood	Tilia americana	19	F		Remove due to construction
590	Shagbark Hickory	Carya ovata	18	F		Remove due to construction
591	Shagbark Hickory	Carya ovata	15	F		Remove due to construction
592	Basswood	Tilia americana	15	F		Remove due to construction
593	Burr Oak	Quercus macrocarpa	23	F	Minor to moderate deadwood throughout	Remove due to construction
594	Shagbark Hickory	Carya ovata	31	F		Remove due to construction
595	Shagbark Hickory	Carya ovata	39	F	2 stem at 0.5 metres	Remove due to construction
596	Shagbark Hickory	Carya ovata	33	F		Retain
597	Shagbark Hickory	Carya ovata	44	F	Minor deadwood throughout	Remove due to construction
O1	Black Walnut	Juglans nigra	~48	F	Minor deadwood in canopy	Retain
O2	Black Walnut	Juglans nigra	~26	F	Minor deadwood in canopy	Retain
O3	Black Walnut	Juglans nigra	~22	F	Minor to moderate deadwood in canopy	Retain
O4	Black Walnut	Juglans nigra	~33	F	Minor to moderate deadwood in canopy	Retain
O5	Black Walnut	Juglans nigra	~35	F	Minor to moderate deadwood in canopy	Retain
O6	Basswood	Tilia americana	~78	P	Suckers throughout, main leader previously failed, minor deadwood throughout	Retain (injure)
O7	Basswood	Tilia americana	18	F		Retain
O8	Burr Oak	Quercus macrocarpa	~72	F	Minor deadwood throughout	Retain (injure)
O9	Burr Oak	Quercus macrocarpa	~58	F/P	Moderate deadwood throughout	Retain (injure)
O10	Shagbark Hickory	Carya ovata	37	F		Retain
O11	Burr Oak	Quercus macrocarpa	84	F	Minor to moderate deadwood throughout, cavity at base on northwest side of tree	Retain (injure)
O12	Shagbark Hickory	Carya ovata	57	F	Minor to moderate deadwood throughout	Remove due to construction

02830-6

Hoarding  
Framed Protective Construction Hoarding  
Solid Board- Plastic Snow Fence

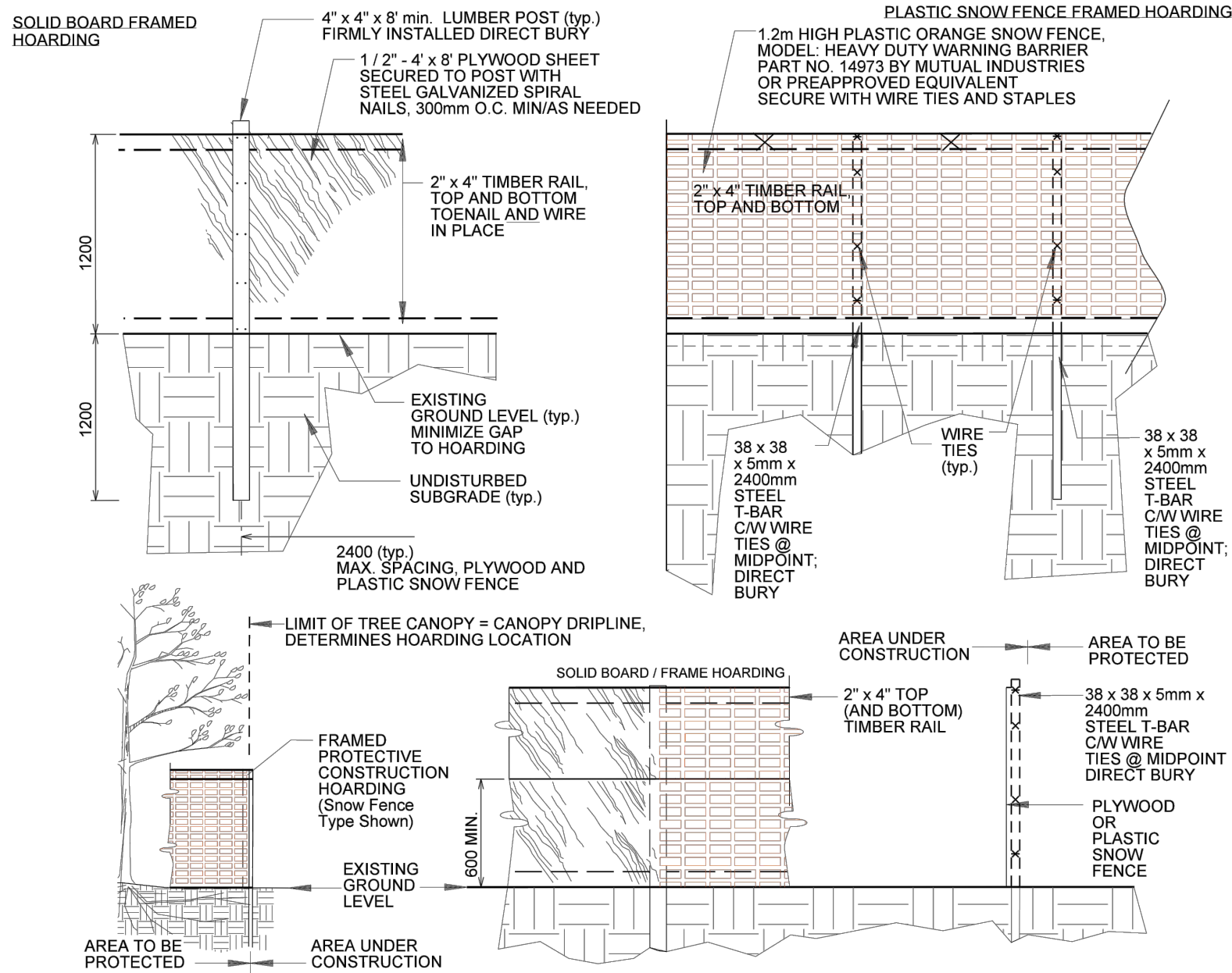

- NOTES:
1. HOARDING LOCATION AS PER DRAWINGS. HOARDING INSTALLATIONS ARE TO INCLUDE WOVEN GEOTEXTILE FABRIC FOR SEDIMENT CONTROL.
  2. NO MOBILIZATION OR CONSTRUCTION WORK TO OCCUR UNTIL HOARDING HAS BEEN INSPECTED AND APPROVED BY COMMUNITY SERVICES PROJECT MANAGER (CSPM). CONTRACTOR TO ARRANGE FOR A HOARDING INSPECTION WITH (CSPM). 48 HOUR NOTICE REQUIRED.
  3. HOARDING TO BE SUPPLIED, INSTALLED AND MAINTAINED BY THE CONTRACTOR THROUGH ALL PHASES OF WORK ON SITE.
  4. THE CONTRACTOR IS TO REMOVE AND DISPOSE THE HOARDING OFF SITE WHEN DIRECTED BY THE (CSPM).
  5. ALL WOOD PRODUCTS TO BE NEW AND LUMBER KILN DRIED SPF.
  6. ALL FASTENERS TO BE NEW GALVANIZED STEEL AND SECURELY INSTALLED. WIRE TIES MIN 3.5mm DIA. GALVANIZED STEEL.
  7. DO NOT ALLOW WATER TO COLLECT AND/OR POND ON EITHER SIDE OF THE HOARDING.
  8. WHEN INSTALLING DIRECT BURY TIMBER POSTS AND T-BARS, TAKE CARE TO AVOID VISIBLE AND ASCERTAINABLE TREE ROOTS.
  9. PLACE HOARDING AT LIMIT OF TREE CANOPY DRIP LINE OR BEYOND (E.G. FURTHER AWAY FROM TRUNK) OF TREE.
  10. HOARDED OFF AREA TO REMAIN UNDISTURBED. NO STOCKPILING, STAGING OR MOVEMENT OF VEHICLES TO OCCUR WITHIN PROTECTED AREA.
  11. FOR PROTECTION OF TREE'S AND ROOT SYSTEM, CONTRACTOR MAY BE REQUIRED TO PROVIDE WATERING, MULCHING, FERTILIZING, PRUNING OR OTHER ACTIVITIES TO ENSURE THE HEALTH OF THE TREE(S).
  12. ALL MEASUREMENTS IN MILLIMETRES UNLESS NOTED OTHERWISE (E.G. DIMENSIONAL LUMBER).
  13. CONTRACTOR RESPONSIBLE FOR LOCATES

N.T.S.

Detail: 02830-6

ORIGINAL DATE: Mar 08/18  
REVISION DATE: Mar 08/18



1  
TI-6  
TREE PROTECTION DETAIL  
CITY OF MISSISSAUGA STANDARD

Tree Protection Note:

The applicant is responsible for ensuring that tree protection hoarding is maintained throughout all phases of demolition and construction in the location and condition as approved by the Planning and Building Department. No materials (building materials, soil, etc.) may be stockpiled within the area of hoarding. Failure to maintain the hoarding as originally approved or the storage of materials within the hoarding will be cause for the Letter of Credit to be held for two years following completion of all site works. Hoarding must be inspected prior to the removal of any tree hoarding from the site.

Owner's Signature: \_\_\_\_\_

Date: \_\_\_\_\_

2  
TI-6  
TREE PROTECTION NOTE

LEGEND

KEY PLAN

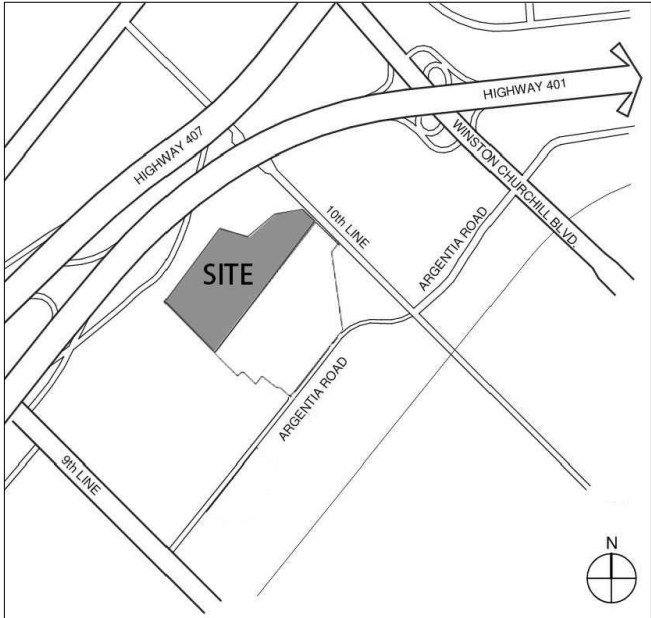

GENERAL NOTES

1. Do not scale the drawings. All dimensions are in millimetres unless noted otherwise.
2. This drawing is to be read in conjunction with the overall master plan and engineering drawings prepared by the project engineer and site plans prepared by the project architect.
3. The contractor shall check and verify all existing and proposed grading and conditions on the project and immediately report any discrepancies to the consultant before proceeding with any work.
4. The contractor is to be aware of all existing and proposed services and utilities. The contractor is responsible for having all underground services and utility lines staked by each agency having jurisdiction prior to commencing work.
5. This drawing is to be used for development approval only. For layout of all work refer to construction drawings.
6. Plant quantities indicated on the plan supercede the quantities from the plant list (report any discrepancies to the landscape architect).
7. Do not leave any holes open overnight.
8. Keep area outside construction zone clean and useable by others at all times. Contractor shall thoroughly clean areas surrounding the construction zone at the end of each work day.
9. Contractor to make good any and all damages outside of the development area that may occur as a result of construction at no extra cost.
10. This drawing is Copyright MHBC 2025

1.	AUGUST 14, 2025	ISSUED FOR SPA	NV
REVISION NO.	DATE	ISSUED / REVISION	BY

PLANNING  
URBAN DESIGN  
& LANDSCAPE  
ARCHITECTURE

230-7050 WESTON ROAD WOODBRIDGE, ON, L4L 8G7 | P: 905 761 5588 F: 905 761 5589 | WWW.MHBCPLAN.COM

STAMP	DATE AUGUST 2025
	DRAWN BY NV
ISSUED FOR SPA ONLY NOT FOR CONSTRUCTION	PLAN SCALE -
All drawings and specifications are instruments of service and will remain the property of MHBC Planning and must be returned at the completion of the work. This drawing shall not be used for construction purposes unless the drawings are marked 'Issued for Construction' and the professional seal is signed and dated by the landscape architect.	FILE NO. 12212BK
CHECKED BY N.M.	
OWNER PROLOGIS 185 THE WEST MALL SUITE 700, TORONTO, ON	
PROJECT  7564 TENTH LINE WEST MISSISSAUGA, ON	
FILE NAME TREE INVENTORY, PROTECTION, AND REMOVALS	DWG NO. TI-6