

**NOTES:**

1. Hoarding details to be determined following initial site inspection.
2. Plywood hoarding to be approved by Development & Design.
3. Hoarding must be installed and maintained to the standard throughout all phases of construction.
4. Plywood must be installed and maintained to the standard throughout all phases of construction.
5. Hoarding must be installed and maintained to the standard throughout all phases of construction.
6. Plywood must be installed and maintained to the standard throughout all phases of construction.
7. Plywood must be installed and maintained to the standard throughout all phases of construction.

**TREE PRESERVATION HOARDING**

**TREE PROTECTION HOARDING**

EXISTING TREE INVENTORY									
Map	Tree Species	Number	Size	Health	Location	Comments	Preservation	Notes	Remarks
1	Maple	1	100	Good	100	100	100	100	100
2	Maple	1	100	Good	100	100	100	100	100

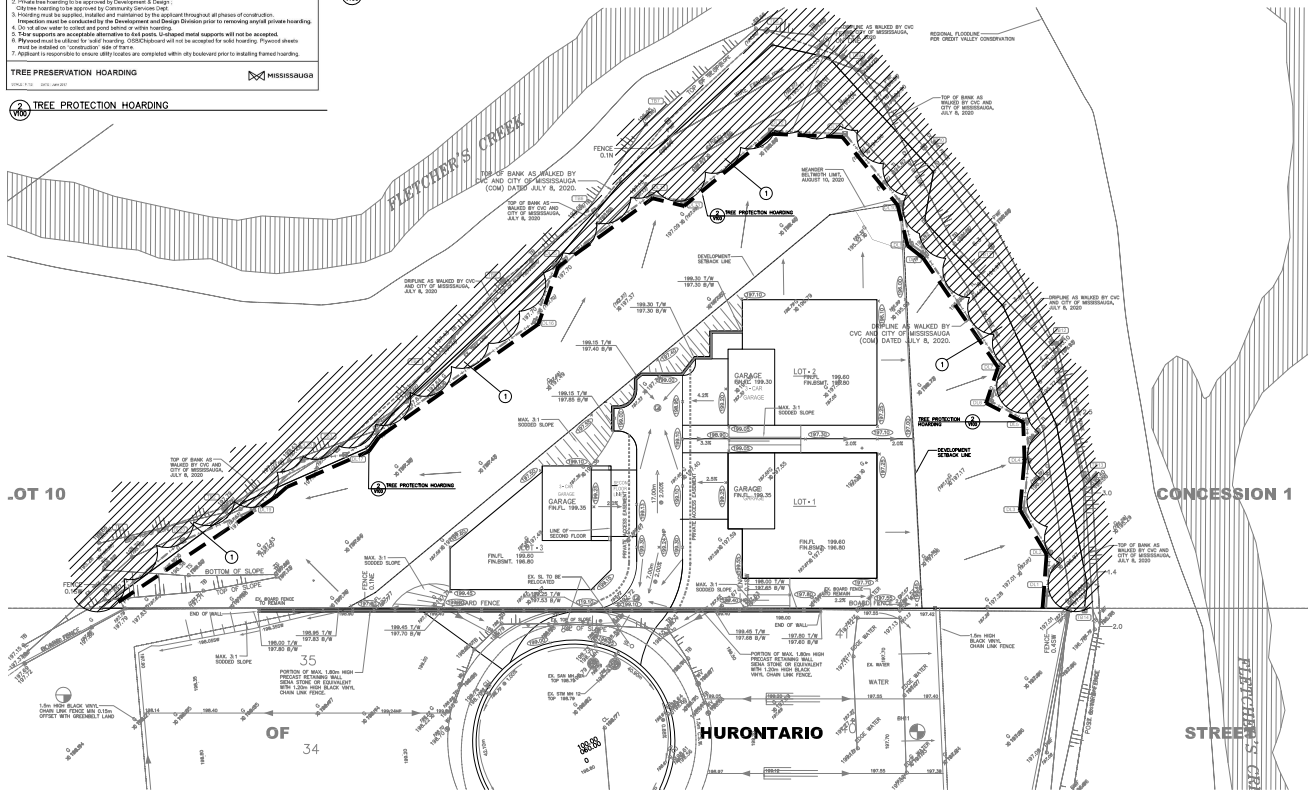

**GENERAL NOTES**

- 1. VERIFY ALL DIMENSIONS.
- 2. DO NOT SCALE DRAWINGS.
- 3. REPORT ANY DISCREPANCIES TO THE LANDSCAPE ARCHITECT BEFORE PROCEEDING.
- 4. IT IS THE RESPONSIBILITY OF THE CONTRACTOR TO OBTAIN ALL NECESSARY PERMITS AND APPROVALS PRIOR TO CONSTRUCTION.
- 5. THE LANDSCAPE ARCHITECT'S DRAWINGS AND SPECIFICATIONS ARE THE PROPERTY OF THE LANDSCAPE ARCHITECT.

**KEY MAP**

**LEGEND**

- EXISTING HOARDING TO BE PRESERVED
- NEW PROTECTION HOARDING
- DEVELOPMENT SETBACK LINE

**PROPOSED A NEW HOUSES**

44-45 LONGVIEW PLACE, MISSISSAUGA, ON

**EXISTING TREE INVENTORY AND PRESERVATION PLAN**

PROJECT NO: 21-5553

DRAWN BY: V100