

E:\BRM\BRM-23002042-U0160 Execution\65 Drawings\01-30088-C400-RA.dwg  
27 February 2026

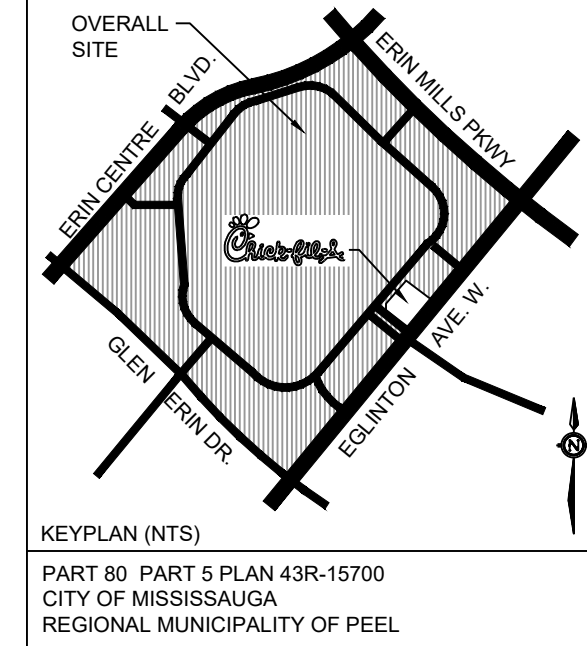

- LEGEND:**
- PROPERTY LINE
  - EX. CONC. CURB
  - CATCHMENT I.D.
  - RUN-OFF COEFFICIENT | AREA (ha)
  - OVERLAND FLOW DIRECTION
  - STORM SEWER CATCHMENT BOUNDARY
  - MAIN ENTRANCE
  - SECONDARY ENTRANCE
  - NEW STORM CB
  - NEW STORM CBMH
  - EX. STORM MH
  - EX. SANITARY MH
  - EX. CONC. CURB
  - NEW CONC. CURB
  - NEW CURB CUT/DEPRESSED CURB
  - PROP. LIMIT OF DEVELOPMENT
  - TREE PROTECTION FENCE
  - PROP. UNDERGROUND HYDRO
  - EX. STORM SEWER
  - EX. SANITARY SEWER
  - EX. WATER MAINS
  - EX. UNDERGROUND HYDRO
  - EX. UNDERGROUND BELL
  - EX. GAS
  - PROP. STORM SEWER
  - PROP. SANITARY SEWER
  - PROP. WATER SERVICE
  - PROP. GAS SERVICE
  - PROP. FIRE LINE

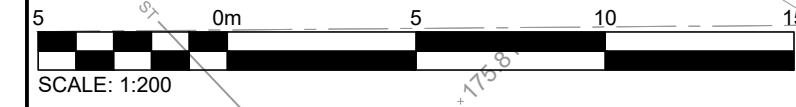
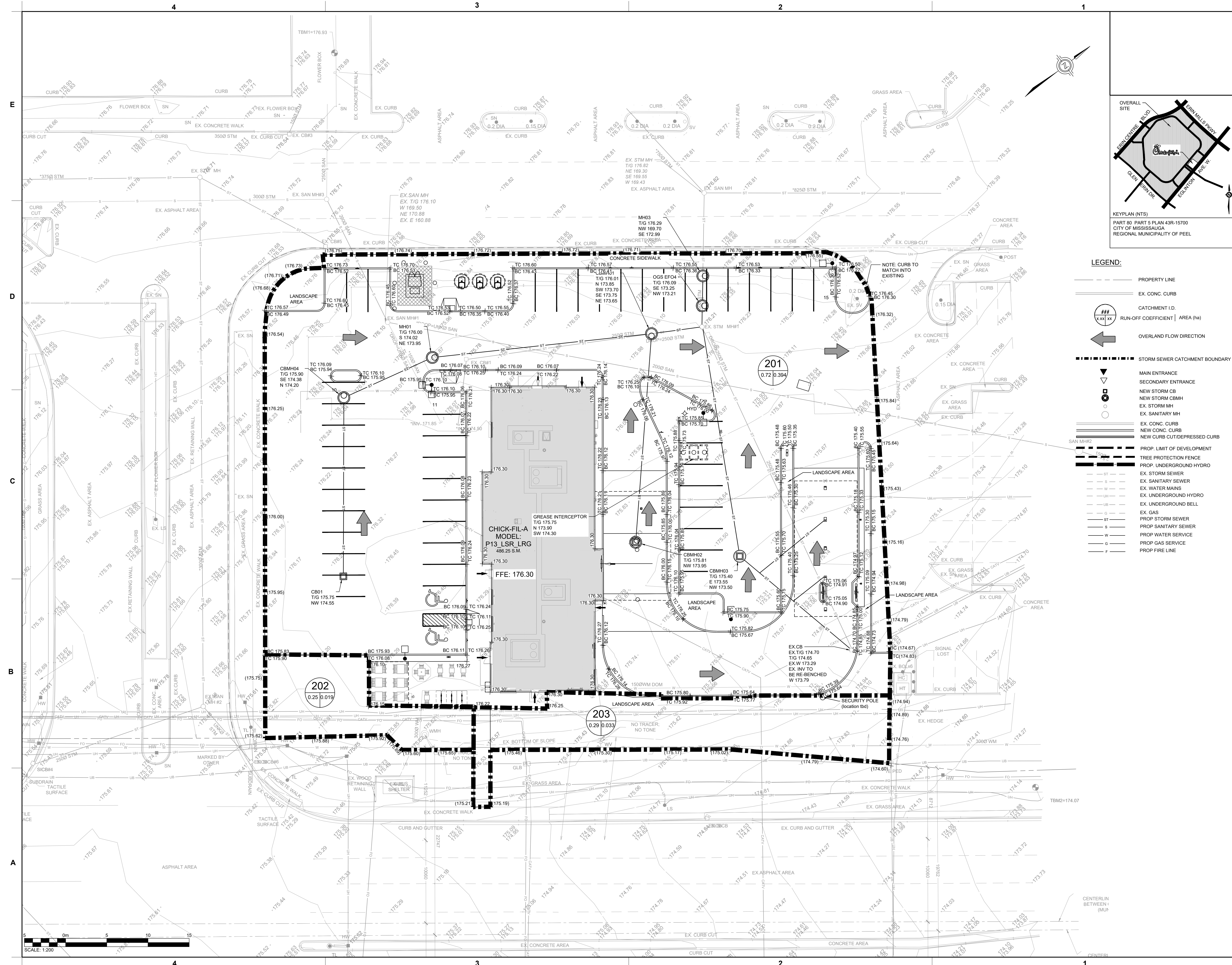
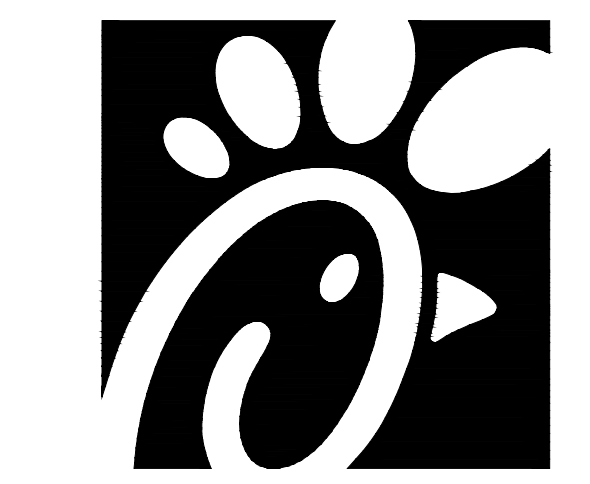

**Chick-fil-A**

**Chick-fil-A**  
5200 Buffington Road  
Atlanta, Georgia 30349-2998

exp Services Inc.  
t: +1 905.793.9800 | f: +1 905.793.0641  
1595 Clark Boulevard  
Brampton, ON L6T 4V1  
Canada  
www.exp.com



- BUILDINGS • EARTH & ENVIRONMENT • ENERGY •
- INDUSTRIAL • INFRASTRUCTURE • SUSTAINABILITY •



# CHICK-FIL-A

## CENTRE

5100 Erin Mills Parkway  
Mississauga, ON

**FSR#30088**

BUILDING TYPE / SIZE: IP02  
RELEASE: XXXXXXXXX

**REVISION SCHEDULE**

NO.	DATE	DESCRIPTION
A	2025-06-06	FOR REVIEW
B	2025-01-07	FOR REVIEW
C	2026-03-02	ZBA/SPA SUBMISSION

**PROJECT INFORMATION**

CITY #	PAM 25-03	REGION #	Cox
CONSULTANT PROJECT #	BRM0023002042-U0		
PROJECT STATUS	ZBA/SPA		
DATE	MARCH 2026		
DRAWN BY	J.K.		

Information contained on this drawing and in all digital files produced for above named project may not be reproduced in any manner without express written or verbal consent from authorized project representatives.

SHEET  
POST DEVELOPMENT  
DRAINAGE PLAN

SHEET NUMBER

**C400**

Issued for ZBA/SPA