

Tree Protection Zone (TPZ)

BY-LAW #

No construction activities, including grade changes, storage of materials or equipment, dumping, excavation is permitted within this TPZ

This tree protection barrier must remain in good condition and must not be removed or altered without the authorization of City of Mississauga, Urban Forestry.

Concerns or inquires regarding this TPZ can be directed to:

(3-1-1) Dial 3-1-1 905-615-4311 outside city limits

02830-6

Hoarding
Framed Protective Construction Hoarding
Solid Board-Plastic Snow Fence

NOTE:
TO BE USED AS A GUIDELINE ONLY
NOT TO SCALE. REMOVE TITLE BLOCK
AND RETURN TO RESPONDENT SITE SERVICES
CONTRACTORS TO BE CONFIRMED BY THE PROJECT
CONSULTANT.

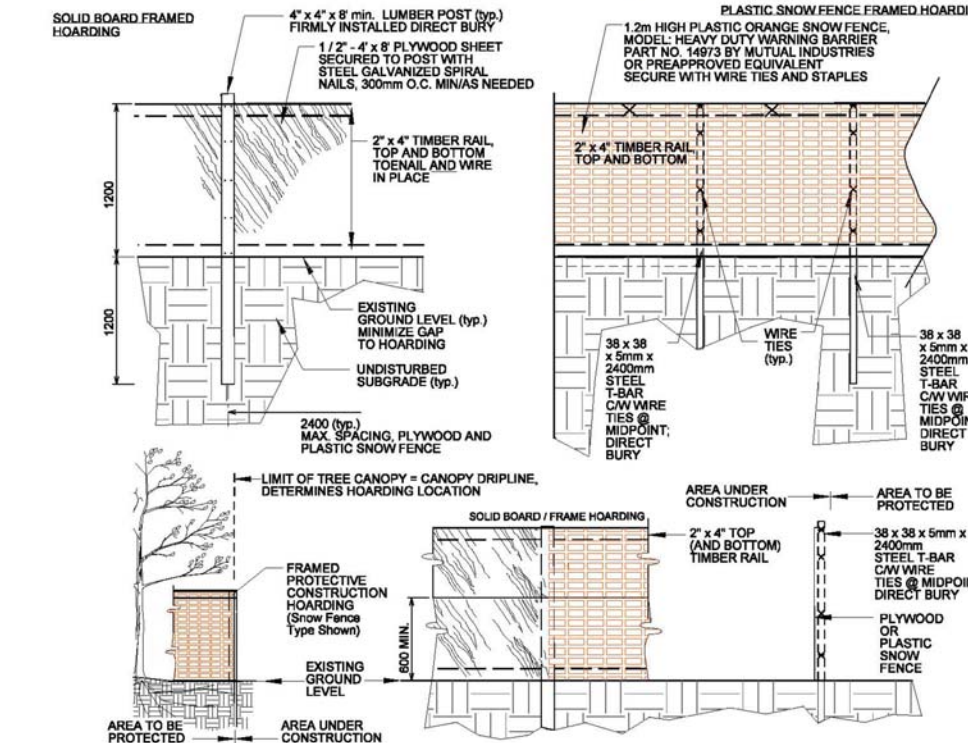

- HOARDING LOCATION AS PER DRAWINGS. HOARDING INSTALLATIONS ARE TO INCLUDE WOVEN GEOTEXTILE FABRIC FOR EROSION CONTROL.
- NO HOARDING OR CONSTRUCTION WORK TO OCCUR UNTIL HOARDING HAS BEEN INSPECTED AND APPROVED BY COMMUNITY SERVICES PROJECT MANAGER (CSPM). CONTRACTOR TO ADVANCE FOR A HOARDING INSPECTION WITH CSPM, 48 HOUR NOTICE REQUIRED.
- HOARDING TO BE SUPPORTED, INSTALLED AND MAINTAINED BY THE CONTRACTOR THROUGHOUT ALL PHASES OF WORK ON SITE.
- ALL HOARDING TO BE NEW UNPAINTED STEEL AND SECURELY INSTALLED. WIRE THE MAX 3.0m DIA. GALVANIZED STEEL.
- ALL WOOD PRODUCTS TO BE NEW AND LARGER KILN DRIED SPF.
- ALL FASTENERS TO BE NEW UNPAINTED STEEL AND SECURELY INSTALLED. WIRE THE MAX 3.0m DIA. GALVANIZED STEEL.
- DO NOT ALLOW WATER TO COLLECT AND/OR POND ON EITHER SIDE OF THE HOARDING.
- WIRE HOARDING AT TOP OF FREE CANTILEVER OR BEYOND (3.0m) FURTHER AWAY FROM FEET OF TREE.
- HOARDING TO REMAIN UNPAINTED. NO STOPPING, STANDING OR MOVEMENT OF VEHICLES TO OCCUR WITHIN PROTECTED AREA.
- FOR PROTECTION OF TREE AND ROOT SYSTEMS, CONTRACTOR MAY BE REQUIRED TO PROVIDE WATERING, MULCHING, FERTILIZING, PRUNING OR OTHER ACTIVITIES TO ENSURE THE HEALTH OF THE TREES.
- ALL MEASUREMENTS IN METRES UNLESS NOTED OTHERWISE (i.e. DIMENSIONAL LAMBERS).
- CONTRACTOR RESPONSIBLE FOR LOCALS.

Detail: 02830-6 ORIGINAL DATE: May 08/18 REVISION DATE: Mar 08/18 MISSISSAUGA N.T.S.

LEGEND

- Tree Inventory**
Refer to Table 1 of the report dated 10 April 2026 for the complete tree inventory information. Private tree resources measuring 10cm DBH and greater on and within six metres of the subject property and public tree resources of all sizes within the adjacent road right-of-way were included in the inventory.
- Tree Removals**
The removal of 53 trees and one polygon will be required to accommodate the proposed development, as indicated with RED labels.
- Tree Preservation**
The preservation of the remaining trees will be possible with the use of appropriate tree protection measures. Trees identified for preservation are indicated with GREEN labels. Tree protection measures must be implemented prior to the commencement of works associated with the proposed development. The locations of the prescribed tree preservation fencing are indicated in MAGENTA. Refer to the tree preservation fence detail and the general Specifications of the Protection and Preservation of Existing Vegetation for further information.
- Tree Label (GREEN), Preservation Recommended #
 - Tree Label (RED), Removal Required #
 - Minimum Tree Protection Zone (mTPZ) of Tree Identified for Preservation (MAGENTA circle)
 - Minimum Tree Protection Zone (mTPZ) of Tree Identified for Removal (RED circle)
 - Tree Location Estimated by KFCI (GREEN circle)
 - Estimated Extent of Polygon Identified for Removal (RED line)
 - Location of Prescribed Solid Tree Preservation Fencing (solid thick MAGENTA line) (Refer to Detail: 02830-6)
 - Location of Prescribed Framed Tree Preservation Fencing (dashed thick MAGENTA line) (Refer to Detail: 02830-6)
 - Surveyed Tree Absent During Field Assessments X

- Specifications for the Protection and Preservation of Existing Vegetation**
- The following notes are to be included on all tree preservation plans:
- All existing trees, which are to remain, shall be fully protected with hoarding to City standards, erected beyond their "drip line" prior to the issuance of the Erosion and Sediment Control Permit, to the satisfaction of the Community Services Department. Groups of trees and other existing plantings to be protected, shall be treated in a like manner with hoarding around the entire clump(s). Areas within the protective fencing shall remain undisturbed and shall not be used for the storage of building materials or equipment.
 - No rigging cables shall be wrapped around or installed in trees. Surplus soil, equipment, debris or materials shall not be placed over root systems of the trees within the protective fencing. No contaminants will be dumped or flushed where feeder roots of trees exist.
 - The developer or his/her agents shall take every precaution necessary to prevent damage to trees or shrubs to be retained.
 - Where limbs or portions of trees are removed to accommodate construction work, they will be removed carefully in accordance with accepted arboricultural practices.
 - Where root systems of trees are exposed directly adjacent to or damaged by construction work, they shall be trimmed neatly and the area backfilled with appropriate material to prevent desiccation.
 - Where necessary, the trees will be given an overall pruning to restore the balance between roots and top growth or to restore the appearance of the trees.
 - Trees that have died or have been damaged beyond repair, shall be removed and replaced by the owner at the developer's own expense with trees of a size and species as approved by the Community Services Department.
 - If grades around trees to be protected are likely to change, the owner shall be required to take such precautions as dry walling, retaining walls and root feeding, to the satisfaction of the Community Services Department.

No.	Issue / Revision	Date	By
1	Report Submission	10 Apr. '26	KNH

Base Data: Saina Surveying (survey), Dumper (site)

kfci
KUNTZ FORESTRY CONSULTING INC.

kuntzforestry.ca
consult@kuntzforestry.ca
289.837.1871

PO Box 1267 Lakeshore W
Oakville, Ontario L6K 0B3

Client
1000293648 Ontario Inc.
105 Six Points Road
Etobicoke, Ontario M8Z 2X3

Property
2155 Leanne Boulevard
Mississauga, Ontario

Tree Inventory and Preservation Plan

Project	P4969	Drawing No.	L100
Date	10 April 2026		
Scale	1:400		

