

TYPICAL PARKING SPACE

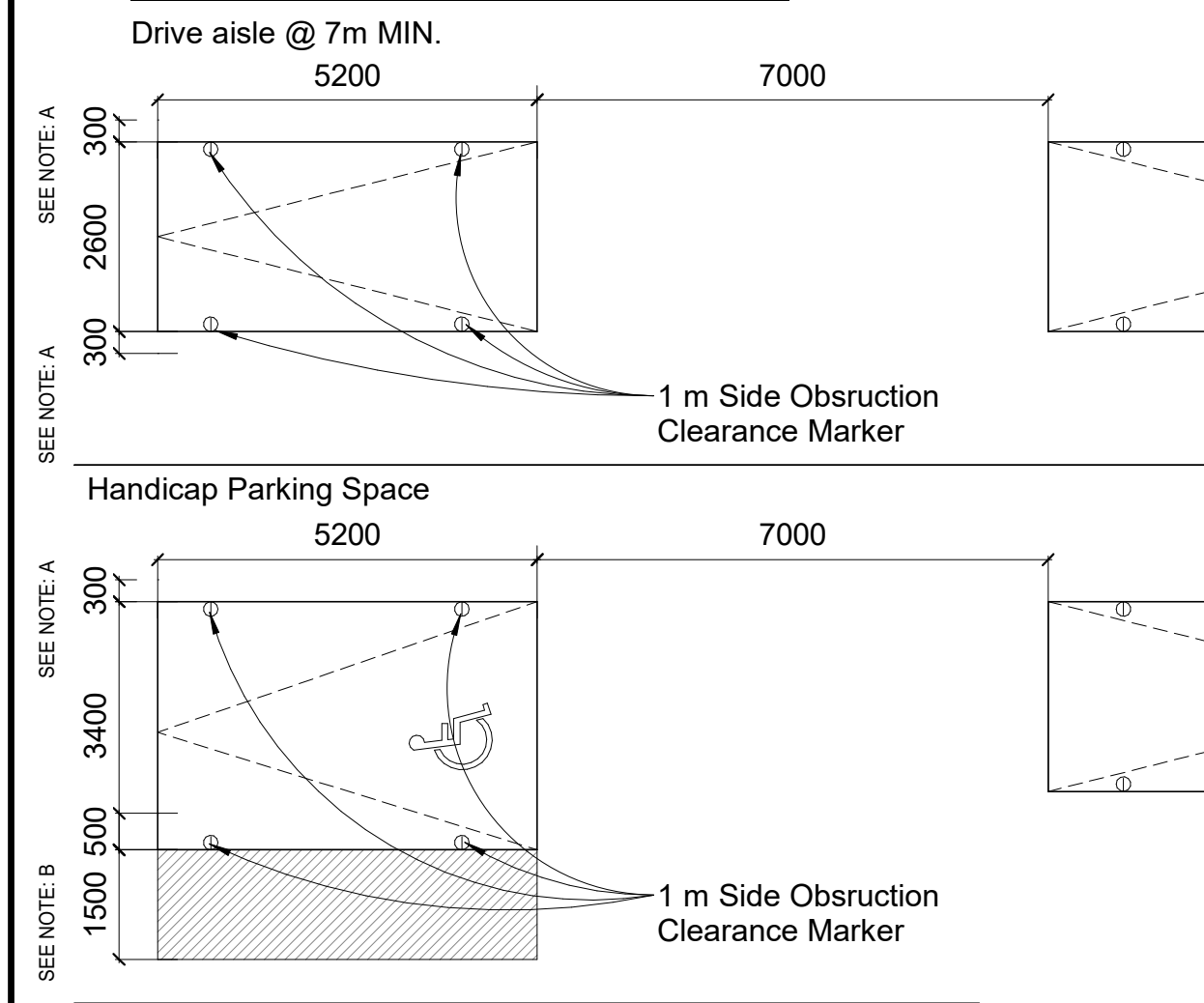

TYPICAL BICYCLE PARKING SPACE

WALKWAY: MINIMUM 1800mm
 VERTICAL PARKING SPACE: 1200mm (L) x 600mm (W) x 1900mm (H)
 HORIZONTAL PARKING SPACE: 1800mm (L) x 600mm (W) x 1900mm (H)
 STACKED PARKING SPACE:(Zoning) 1800mm (L) x 600mm (W) x 1200 mm (H)
 STACKED PARKING SPACE:(Proposed) 1930mm (L) x 460mm (W)

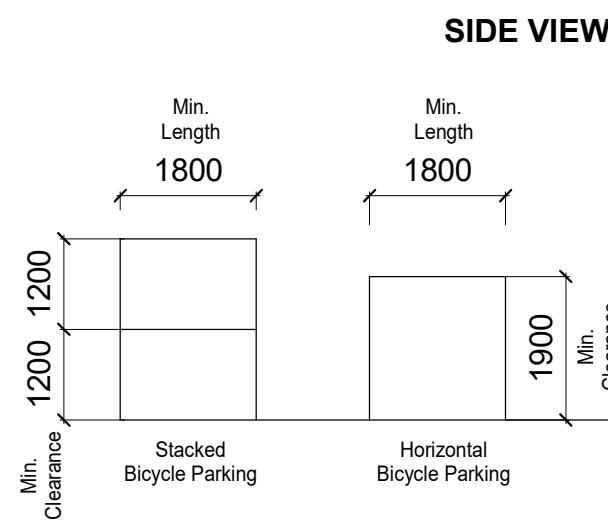
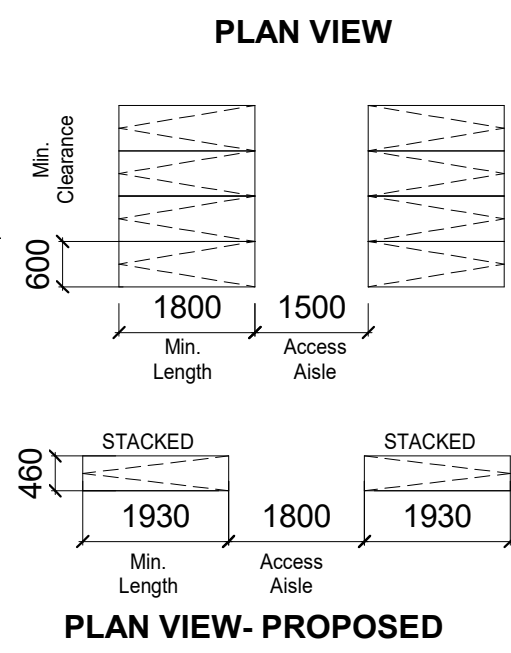

NOTES:
 A - PROVIDE AND ADDITIONAL 300mm FOR PARKINGS SPACE WIDTH WHEN OBSTRUCTIONS OCCUR BETWEEN THE FRONT AND REAR 1000mm.
 B - PROVIDE A 1500mm WALKWAY ON AT LEAST ONE SIDE OF A HANDICAP PARKING STALL. THIS WALKWAY MAY BE SHARED WITH ADJOINING HANDICAP SPACE.

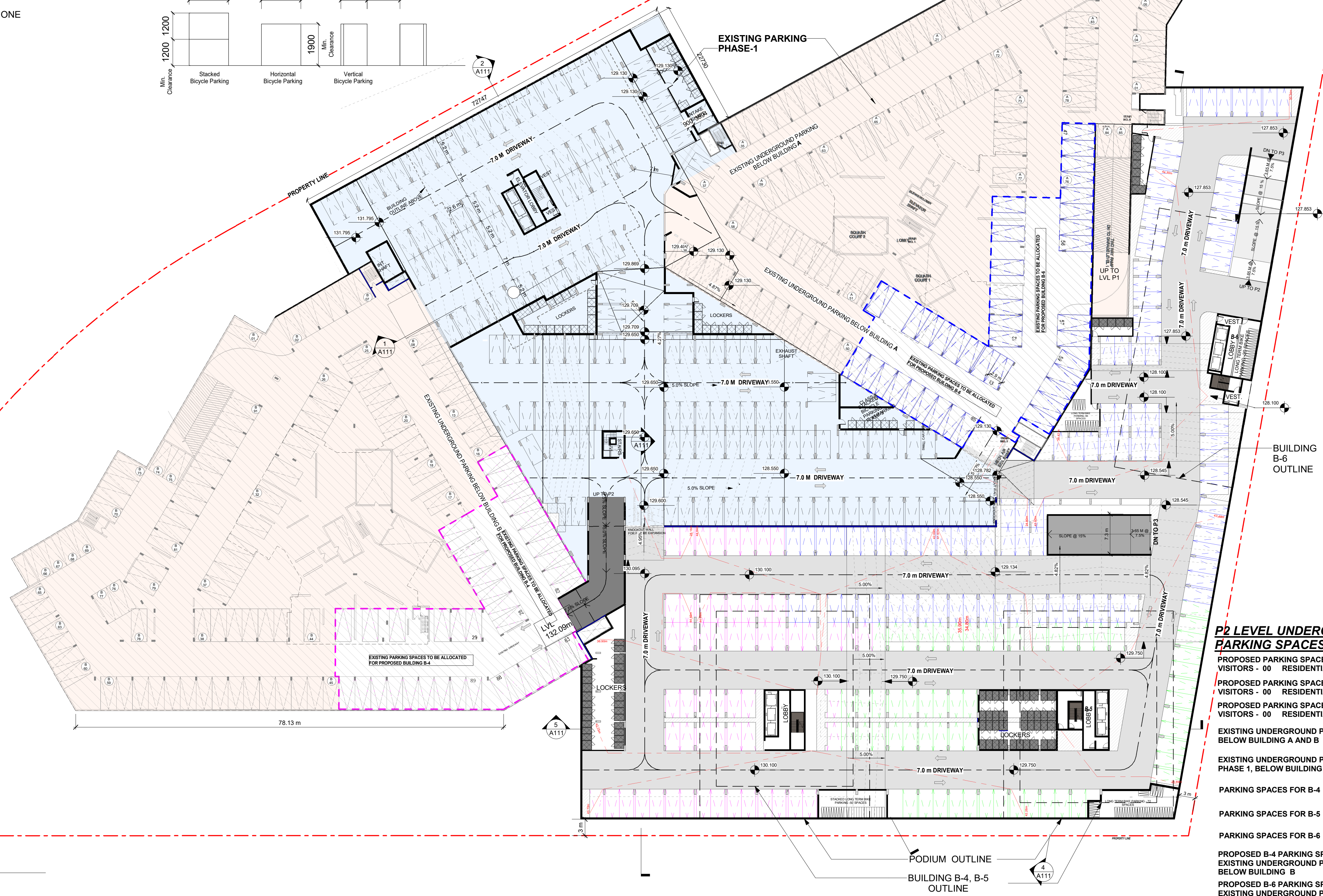

1 OVERALL PARKING LEVEL 2
 1 : 400

P2 LEVEL UNDERGROUND PARKING SPACES COUNT.

PROPOSED PARKING SPACES FOR PH-2 B-4
 VISITORS - 00 RESIDENTIAL - 96

PROPOSED PARKING SPACES FOR PH-2 B-5
 VISITORS - 00 RESIDENTIAL - 56

PROPOSED PARKING SPACES FOR PH-2 B-6
 VISITORS - 00 RESIDENTIAL - 135

EXISTING UNDERGROUND PARKING BELOW BUILDING A AND B

EXISTING UNDERGROUND PARKING PHASE 1, BELOW BUILDING B-3

PARKING SPACES FOR B-4

PARKING SPACES FOR B-5

PARKING SPACES FOR B-6

PROPOSED B-4 PARKING SPACES IN EXISTING UNDERGROUND PARKING BELOW BUILDING B

PROPOSED B-6 PARKING SPACES IN EXISTING UNDERGROUND PARKING BELOW BUILDING A

APPLICATION NUMBER:
 APPLICATION NUMBER:

NOTES:
 DRAWINGS ARE NOT TO BE SCALED.
 THIS DRAWING IS AN INSTRUMENT OF SERVICE, IS PROVIDED BY AND IS THE PROPERTY OF 4 ARCHITECTURE INC.
 THE CONTRACTOR MUST VERIFY AND ACCEPT RESPONSIBILITY FOR ALL DIMENSIONS AND CONDITIONS ON SITE, AND MUST NOTIFY 4 ARCHITECTURE INC. OF ANY VARIATION FROM THE SUPPLIED INFORMATION.
 4 ARCHITECTURE INC. IS NOT RESPONSIBLE FOR THE ACCURACY OF SURVEY, STRUCTURAL, MECHANICAL, ELECTRICAL, ETC., ENGINEERING INFORMATION SHOWN ON THIS DRAWING. REFER TO THE PROPER ENGINEERING DRAWINGS BEFORE PROCEEDING WITH THE WORK.
 CONSTRUCTION MUST CONFORM TO ALL APPLICABLE CODES AND REQUIREMENTS OF AUTHORITIES HAVING JURISDICTION.
 ALL ARCHITECTURAL SYMBOLS INDICATED ARE GRAPHIC REPRESENTATIONS ONLY.

REVISIONS

ISSUED FOR ZBA SUBMISSION

1		2025.12.19	EM

CLIENT: FOREST PARK CIRCLE

NORTH PROJECT NORTH

4 ARCHITECTURE INC.
 WWW.4ARCHITECTURE.CA
 8966 Woodbine Avenue, Suite 900, Markham, ON L3R 0J7
 T: (905) 470 7212 // email: mail@4architecture.ca

FOREST PARK CIRCLE - 425030
 4100 PONYTRAIL DRIVE AND 1850 RATHBURN RD EAST, MISSISSAUGA
OVERALL SITE U.G. PARKING - LEVEL P2
 2025.12.19
 As indicated S/V/D/S EM
A107

C:\Users\jeung\Documents\425030_Lorrel - Missi Op 2 RV12024_Host_jeung7v8DE.rvt 2025-12-19 10:51:52 AM

All drawings specifications related documents and design are the copyright property of 4 Architecture Inc. (4 Arch). Reproduction of this property in whole or in part is strictly prohibited without 4 Arch's written permission (4 Arch assumes no responsibility or liability for this property unless it bears the original architectural seal and original signature).