

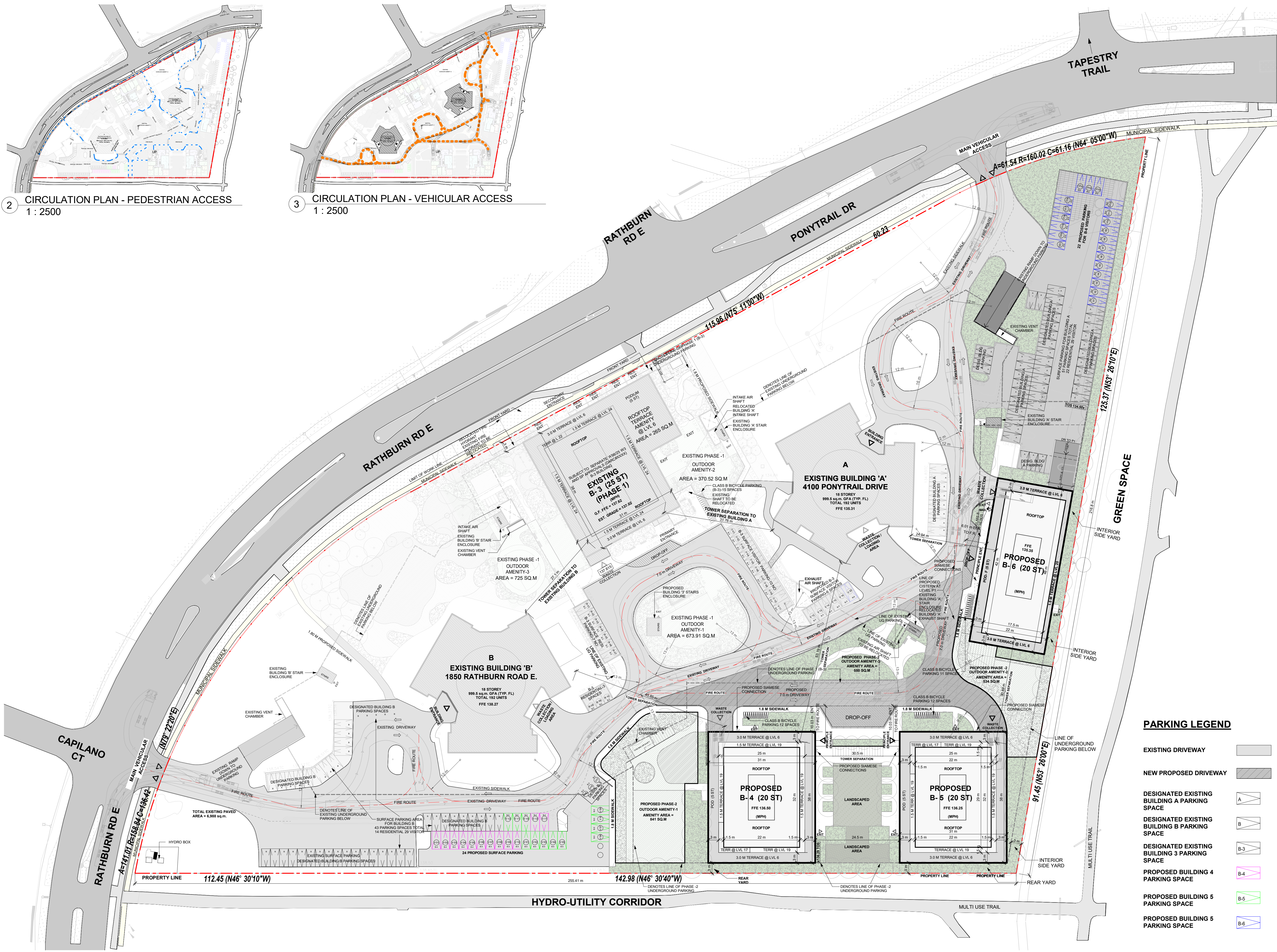

2 CIRCULATION PLAN - PEDESTRIAN ACCESS
1 : 2500



3 CIRCULATION PLAN - VEHICULAR ACCESS
1 : 2500



1 PHASE 2 - OVERALL SITE PLAN
1 : 500

PARKING LEGEND

- EXISTING DRIVEWAY
- NEW PROPOSED DRIVEWAY
- DESIGNATED EXISTING BUILDING A PARKING SPACE
- DESIGNATED EXISTING BUILDING B PARKING SPACE
- DESIGNATED EXISTING BUILDING C PARKING SPACE
- PROPOSED BUILDING 4 PARKING SPACE
- PROPOSED BUILDING 5 PARKING SPACE
- PROPOSED BUILDING 6 PARKING SPACE

APPLICATION NUMBER:
APPLICATION NUMBER:

NOTES:
DRAWINGS ARE NOT TO BE SCALED.
THIS DRAWING IS AN INSTRUMENT OF SERVICE, IS PROVIDED BY AND IS THE PROPERTY OF 4 ARCHITECTURE INC.
THE CONTRACTOR MUST VERIFY AND ACCEPT RESPONSIBILITY FOR ALL DIMENSIONS AND CONDITIONS ON SITE, AND MUST NOTIFY 4 ARCHITECTURE INC. OF ANY VARIATION FROM THE SUPPLIED INFORMATION.
4 ARCHITECTURE INC. IS NOT RESPONSIBLE FOR THE ACCURACY OF SURVEY, STRUCTURAL, MECHANICAL, ELECTRICAL, ETC. ENGINEERING INFORMATION SHOWN ON THIS DRAWING. REFER TO THE PROPER ENGINEERING DRAWINGS BEFORE PROCEEDING WITH THE WORK.
CONSTRUCTION MUST CONFORM TO ALL APPLICABLE CODES AND REQUIREMENTS OF AUTHORITIES HAVING JURISDICTION.
ALL ARCHITECTURAL SYMBOLS INDICATED ARE GRAPHIC REPRESENTATIONS ONLY.

REVISIONS

No.	Description	Date	By
1	ISSUED FOR ZBA SUBMISSION	2025.12.19	EM

CLIENT: FOREST PARK CIRCLE

SUBMITTALS

No.	Description	Date	By
1	ISSUED FOR ZBA SUBMISSION	2025.12.19	EM

CLIENT: FOREST PARK CIRCLE

PROJECT NORTH

TRUE NORTH

STAMP:

4 ARCHITECTURE INC.
WWW.ARCHITECTURE.CA
8966 Woodbine Avenue, Suite 900, Markham, ON L3R 0J7
T: (905) 470-7212 / email: mail@4architecture.ca

FOREST PARK CIRCLE - 425030
4100 PONYTRAIL DRIVE AND 1850 RATHBURN RD EAST, MISSISSAUGA

PHASE 2 - SITE PLAN
2025.12.19
As Indicated SV, JL EM

All drawings specifications related documents and design are the copyright property of 4 Architecture Inc. (4 Arch). Reproduction of this property in whole or in part is strictly prohibited without 4 Arch's written permission (4 Arch, assumes no responsibility or liability for this property unless it bears the original architectural seal and original signature).