

TYPICAL PARKING SPACE

Drive aisle @ 7m MIN.

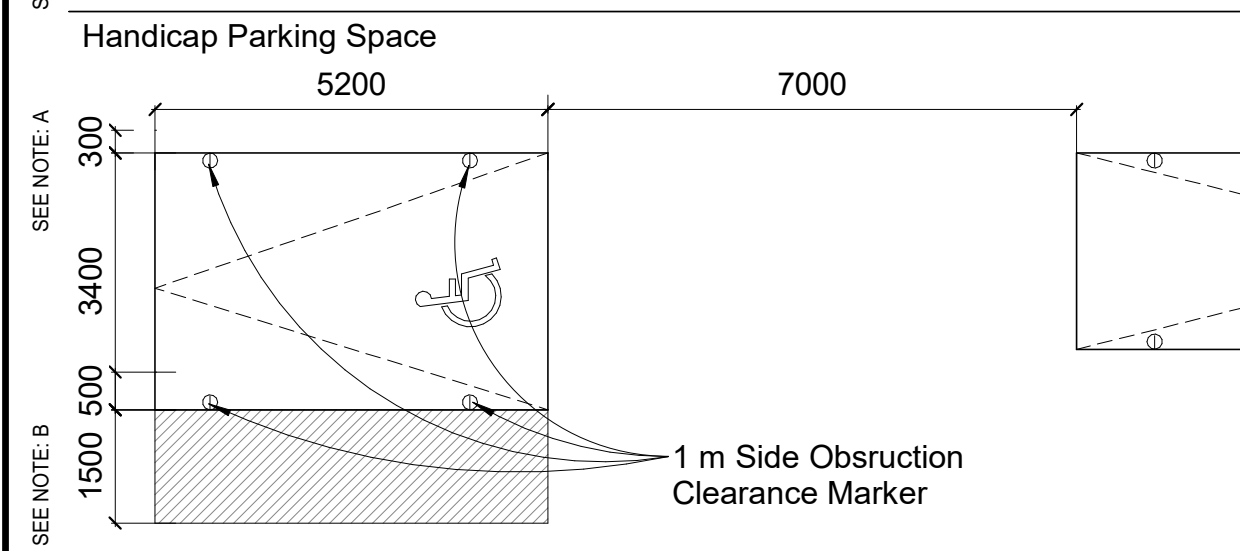
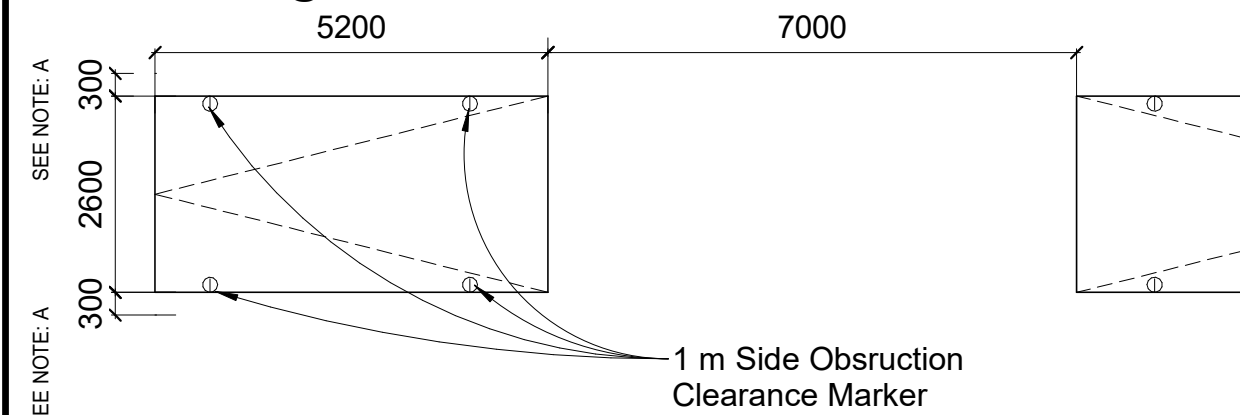

PARKING TAG LEGEND

- R** RESIDENT PARKING SPACE
- AR-A** ACCESSIBLE RESIDENT SPACE TYPE A
- AR-B** ACCESSIBLE RESIDENT SPACE TYPE B
- V** VISITOR PARKING SPACE
- AV-A** ACCESSIBLE VISITOR SPACE TYPE A
- R EV** RESIDENT ELECTRIC VEHICLE PARKING

NOTES:
 A - PROVIDE AND ADDITIONAL 300mm FOR PARKINGS SPACE WIDTH WHEN OBSTRUCTIONS OCCUR BETWEEN THE FRONT AND REAR 1000mm.
 B - PROVIDE A 1500mm WALKWAY ON AT LEAST ONE SIDE OF A HANDICAP PARKING STALL. THIS WALKWAY MAY BE SHARED WITH ADJOINING HANDICAP SPACE.

TYPICAL BICYCLE PARKING SPACE

WALKWAY: MINIMUM 1800mm
VERTICAL PARKING SPACE: 1200mm (L) x 600mm (W) x 1900mm (H)
HORIZONTAL PARKING SPACE: 1800mm (L) x 600mm (W) x 1900mm (H)
STACKED PARKING SPACE:(Zoning) 1800mm (L) x 600mm (W) x 1200 mm (H)
STACKED PARKING SPACE:(Proposed) 1930mm (L) x 460mm (W)

PLAN VIEW

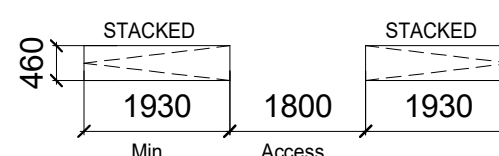
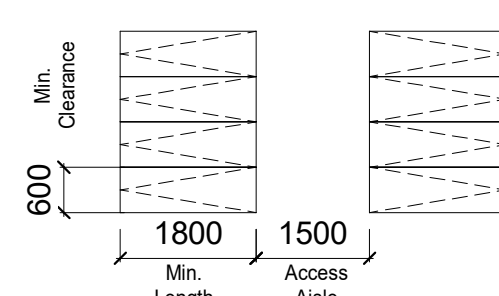

PLAN VIEW - PROPOSED

SIDE VIEW

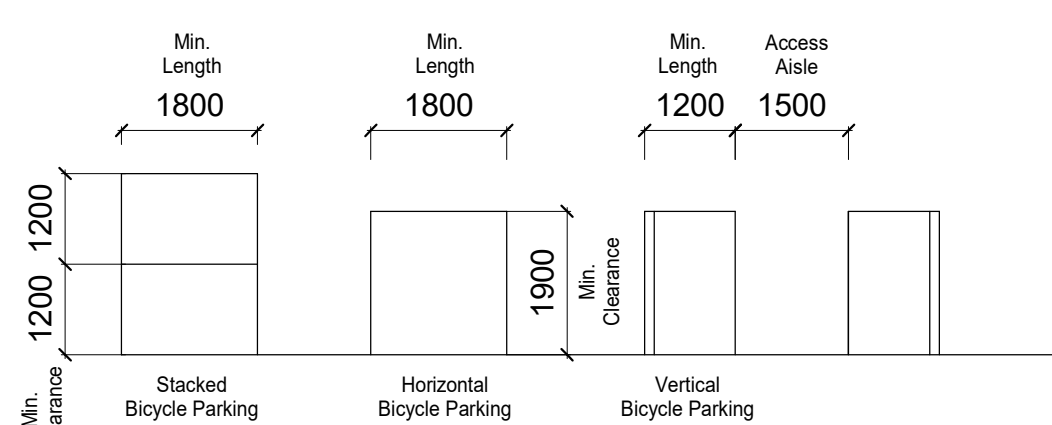

Stack Rack

Spacing and Dimensions

For a full list of dimensions and spacing requirements and recommendations, please see our technical specification document or installation manual.

A	B	C	D	E	F	G
104"	76.5"	48"	26.5"	42"	37"	37"
for 24" spacing (US)		48" Rec.	30.5" Rec.	42" Rec.	37" Rec.	37" Rec.

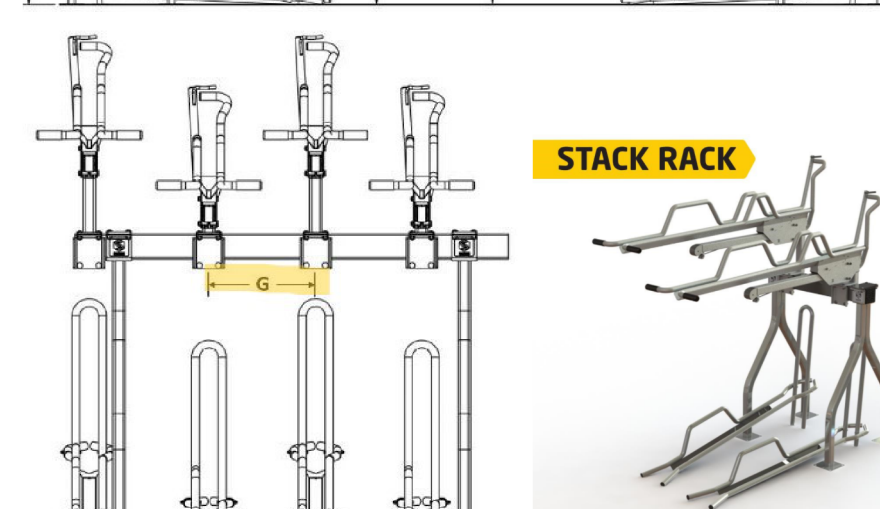
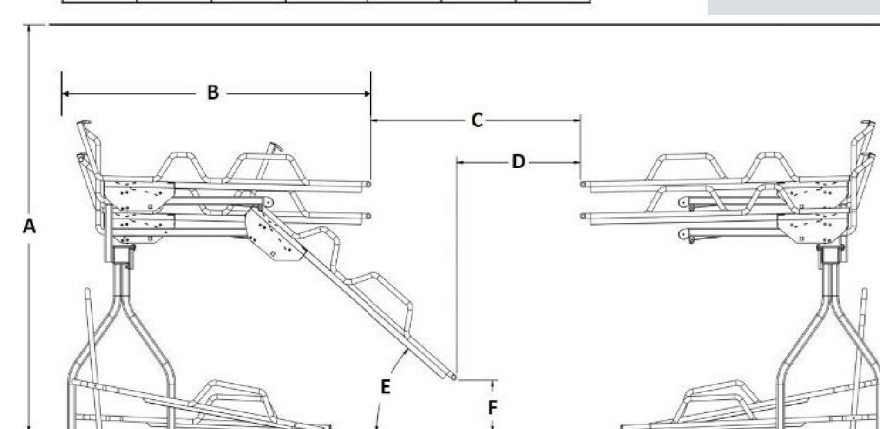

Design files and additional product resources available online at sansinfracture.com

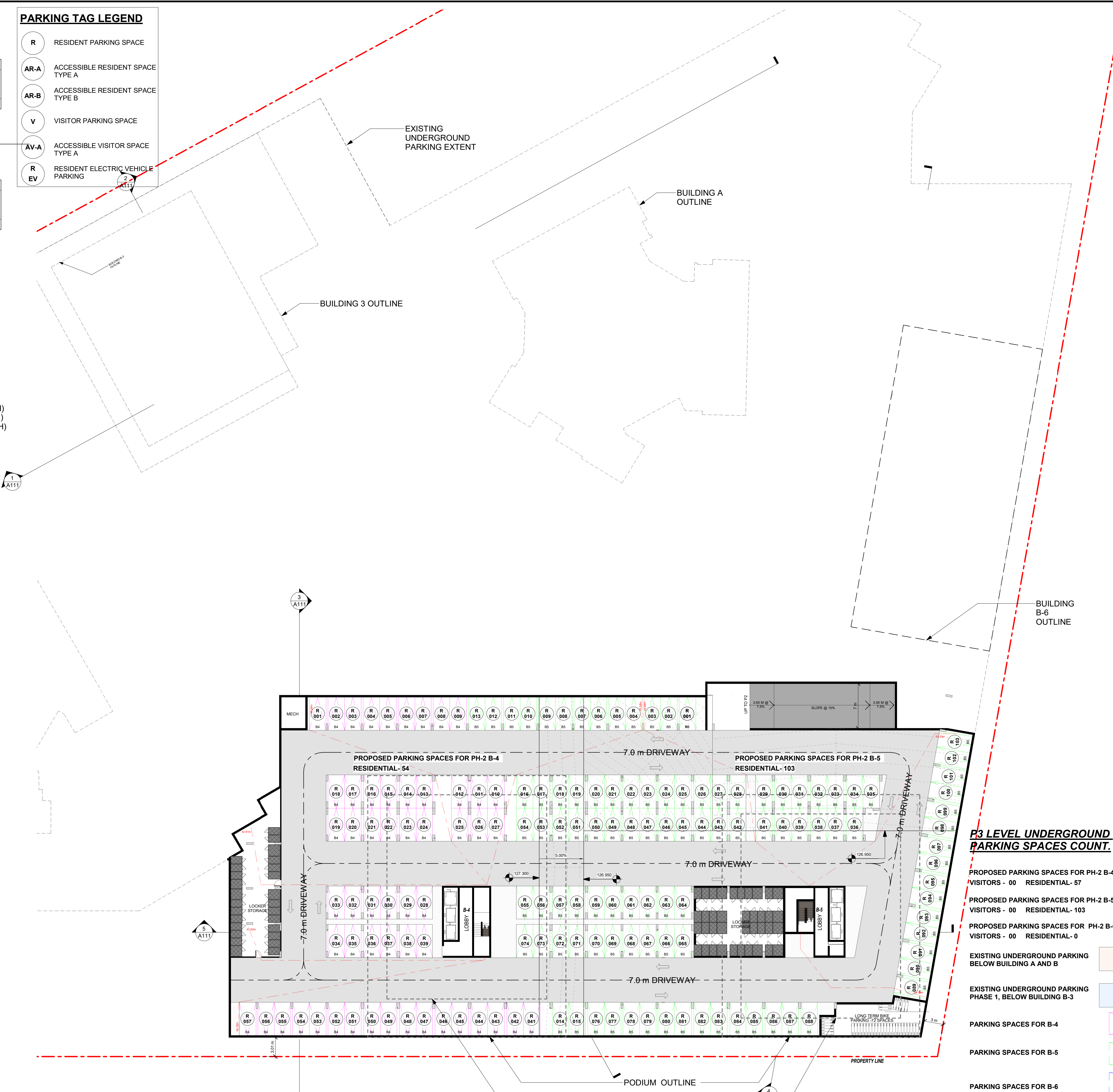

1 PARKING LEVEL 3 (PHASE-2)
1 : 300

C:\Users\jeung\Documents\425030_Lorrie - Missi Op 2 RV12024_Host_jeung7V8DE.rvt 2025-12-19 10:51:48 AM

APPLICATION NUMBER:

APPLICATION NUMBER:

NOTES:
 THIS DRAWING IS AN INSTRUMENT OF SERVICE, IS PROVIDED BY AND IS THE PROPERTY OF 4 ARCHITECTURE INC.
 THE CONTRACTOR MUST VERIFY AND ACCEPT RESPONSIBILITY FOR ALL DIMENSIONS AND CONDITIONS ON SITE AND MUST NOTIFY 4 ARCHITECTURE INC. OF ANY VARIATION FROM THE SUPPLIED INFORMATION.
 4 ARCHITECTURE INC. IS NOT RESPONSIBLE FOR THE ACCURACY OF SURVEY, STRUCTURAL, MECHANICAL, ELECTRICAL, ETC. ENGINEERING INFORMATION SHOWN ON THIS DRAWING. REFER TO THE PROPER ENGINEERING DRAWINGS BEFORE PROCEEDING WITH THE WORK.
 CONSTRUCTION MUST CONFORM TO ALL APPLICABLE CODES AND REQUIREMENTS OF AUTHORITIES HAVING JURISDICTION.
 ALL ARCHITECTURAL SYMBOLS INDICATED ARE GRAPHIC REPRESENTATIONS ONLY.

REVISIONS	DATE	DESCRIPTION

NO.	DESCRIPTION	DATE	BY
1	ISSUED FOR ZBA SUBMISSION	2025.12.19	EM

CLIENT: FOREST PARK CIRCLE

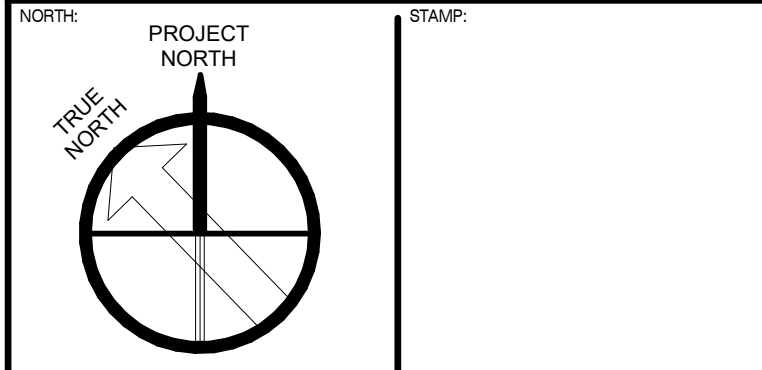

4 ARCHITECTURE INC.
 WWW.ARCHITECTURE.CA
 8966 Woodbine Avenue, Suite 900, Markham, ON L3R 0J7
 T: (905) 470 7212 // email: mail@4architecture.ca

FOREST PARK CIRCLE - 425030
 4100 PONYTRAIL DRIVE AND 1850 RATHBURN RD EAST, MISSISSAUGA

ENLARGED PHASE-2 U.G. PARKING - LEVEL P3
 2025.12.19

As indicated
 SVDS EM
A106

P3 LEVEL UNDERGROUND PARKING SPACES COUNT.

- PROPOSED PARKING SPACES FOR PH-2 B-4 VISITORS - 00 RESIDENTIAL- 57
- PROPOSED PARKING SPACES FOR PH-2 B-5 VISITORS - 00 RESIDENTIAL- 103
- PROPOSED PARKING SPACES FOR PH-2 B-6 VISITORS - 00 RESIDENTIAL- 0
- EXISTING UNDERGROUND PARKING BELOW BUILDING A AND B
- EXISTING UNDERGROUND PARKING PHASE 1, BELOW BUILDING B-3
- PARKING SPACES FOR B-4
- PARKING SPACES FOR B-5
- PARKING SPACES FOR B-6

All drawings specifications related documents and design are the copyright property of 4 Architecture Inc. (4 Arch). Reproduction of this property in whole or in part is strictly prohibited without 4 Arch's written permission (4 Arch. assumes no responsibility or liability for this property unless it bears the original architectural seal and original signature).