

1 LEVEL 6
1:200

LEVEL 6 - UNIT COUNT	
Name	Count
1BR	4
1BR+D	1
2BR	3
2BR(IN)	2
Grand total:	10

TOTAL = 10 UNITS

LEVEL 6 - UNIT SCHEDULE	
Name	Area
1BR	51.45 m ²
1BR	46.57 m ²
1BR	49.12 m ²
1BR	49.12 m ²
1BR+D	52.96 m ²
2BR	69.56 m ²
2BR	67.47 m ²
2BR	69.50 m ²
2BR(IN)	58.29 m ²
2BR(IN)	60.35 m ²
Grand total:	574.38 m²

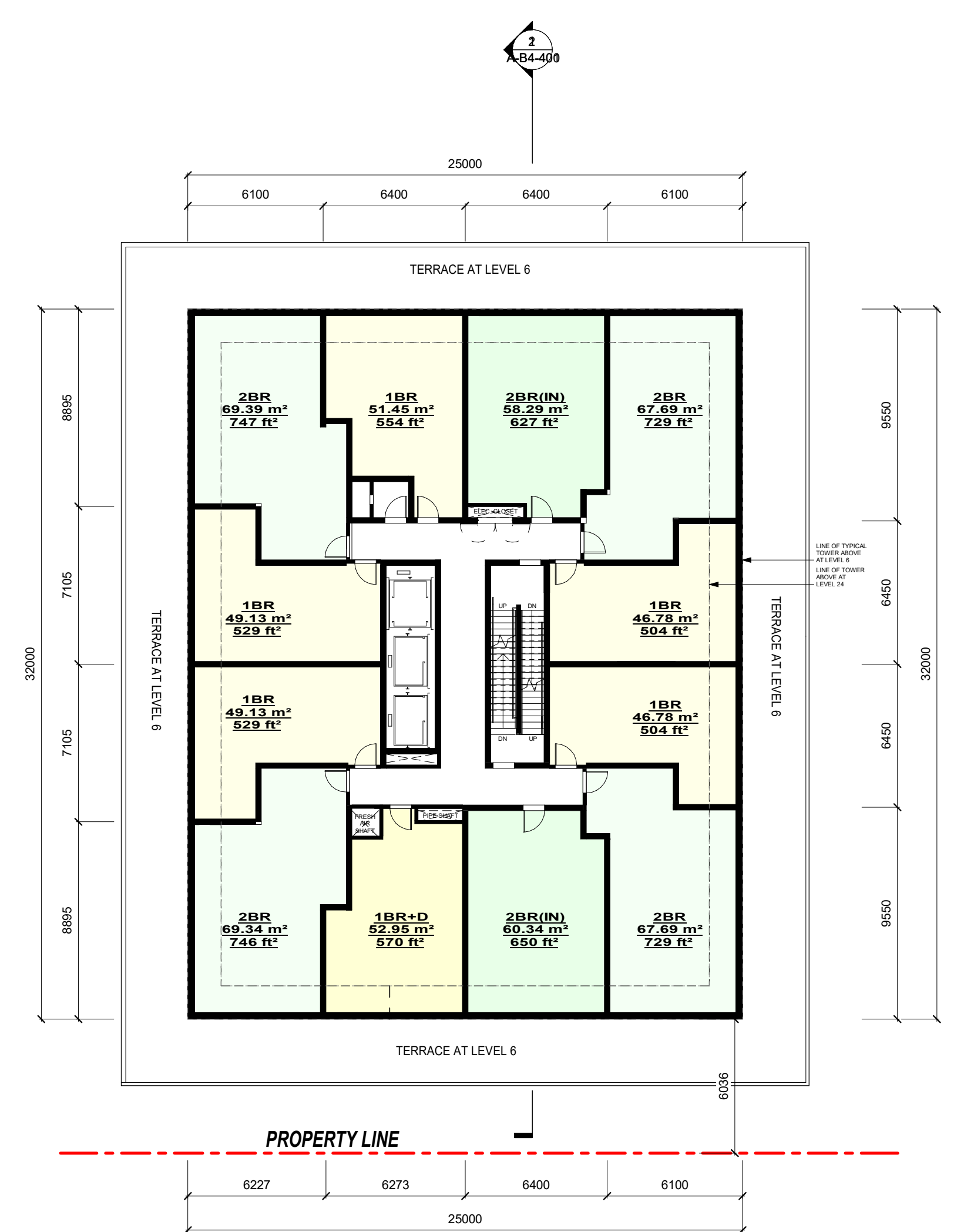

2 LEVEL 7-16
1:200

LEVEL 7-16 (TYP) UNIT COUNT	
Name	Unit Count
1BR	5
1BR+D	1
2BR	4
2BR(IN)	2
Grand Total	12

TOTAL = 12 UNITS

LEVEL 7-16 (TYP) UNIT SCHEDULE	
Name	Unit Count
2BR	69.34 m ²
1BR+D	52.94 m ²
2BR(IN)	60.34 m ²
2BR	67.69 m ²
2BR(IN)	58.29 m ²
1BR	51.45 m ²
2BR	69.39 m ²
1BR	49.13 m ²
1BR	49.14 m ²
Grand Total:	527.70 m²

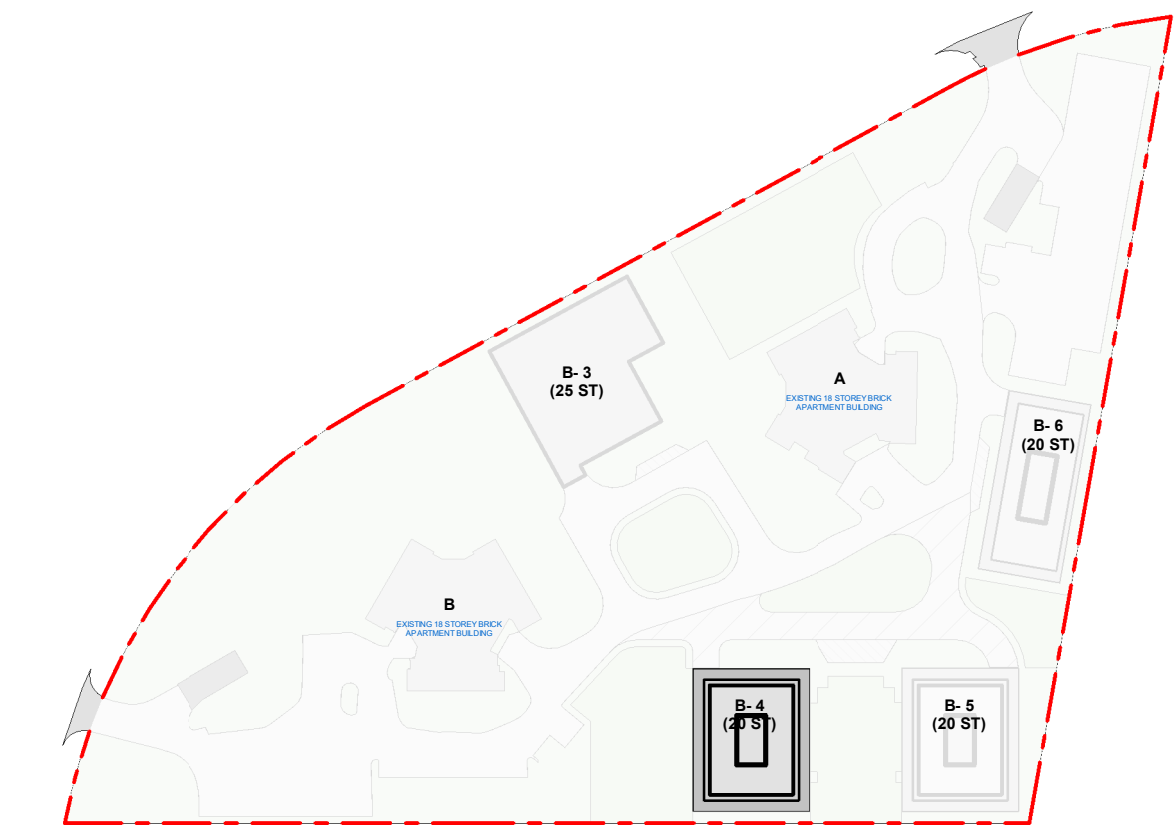

Key Plan

BUILDING B-4

C:\Users\svvarade\Documents\425030_Lorral-Milal_B-4_RV72024_SVarade.rvt 2025-12-18 10:26:07 AM

APPLICATION NUMBER:

APPLICATION NUMBER:

DRAWINGS ARE NOT TO BE SCALED.
NOTES:
 THIS DRAWING IS AN INSTRUMENT OF SERVICE, IS PROVIDED BY AND IS THE PROPERTY OF 4 ARCHITECTURE INC.
 THE CONTRACTOR MUST VERIFY AND ACCEPT RESPONSIBILITY FOR ALL DIMENSIONS AND CONDITIONS ON SITE AND MUST NOTIFY 4 ARCHITECTURE INC. OF ANY VARIATION FROM THE SUPPLIED INFORMATION.
 4 ARCHITECTURE INC. IS NOT RESPONSIBLE FOR THE ACCURACY OF SURVEY, STRUCTURAL, MECHANICAL, ELECTRICAL, ETC. ENGINEERING INFORMATION SHOWN ON THIS DRAWING. REFER TO THE PROPER ENGINEERING DRAWINGS BEFORE PROCEEDING WITH THE WORK.
 CONSTRUCTION MUST CONFORM TO ALL APPLICABLE CODES AND REQUIREMENTS OF AUTHORITIES HAVING JURISDICTION.
 ALL ARCHITECTURAL SYMBOLS INDICATED ARE GRAPHIC REPRESENTATIONS ONLY.

REVISIONS		
No.	Description	By

SUBMITTALS		
No.	Description	By

CLIENT: **FOREST PARK CIRCLE**

NORTH: PROJECT NORTH
TRUE NORTH

STAMP:

4 ARCHITECTURE INC.
 WWW.4ARCHITECTURE.CA
 8966 Woodbine Avenue, Suite 300, Markham, ON L3R 0J7
 T: (905) 470 7212 // email: mail@4architecture.ca

FOREST PARK CIRCLE - 425030
 4100 PONYTRAIL DRIVE, MISSISSAUGA, ON

TYP. TOWER LVL 6 & LVL 7-16 FLR PLAN
 2025.12.19

As indicated
 SV/DS EM
A-B4-304

All drawings specifications related documents and design are the copyright property of 4 Architecture Inc. (4 Arch). Reproduction of this property in whole or in part is strictly prohibited without 4 Arch's written permission (4 Arch. assumes no responsibility or liability for this property unless it bears the original architectural seal and original signature).